

MUN. ST.	SECTION	COUNTY	TOTAL SHEETS	SHEET NO.
1045	08-00093-00-BR	WILL	41	1
STA.	TO STA.			
FED. ROAD DIST. NO.	ILLINOIS	FED. AID PROJECT BRM-9003(103)		

CONTRACT NO. 63755

FOR INDEX OF SHEETS, SEE SHEET NO. 2

FOR INDEX OF HIGHWAY STANDARDS, SEE SHEET NO. 2

PROJECT LOCATED IN THE VILLAGE OF PARK FOREST

STATE OF ILLINOIS
DEPARTMENT OF TRANSPORTATION
DIVISION OF HIGHWAYS

PLANS FOR PROPOSED
FEDERAL AID PROJECT

THORN CREEK DRIVE OVER THORN CREEK
SECTION: 08-00093-00-BR
PROJECT: BRM-9003(103)
VILLAGE OF PARK FOREST
WILL COUNTY
JOB: C-91-102-09



TRAFFIC DATA
THORN CREEK DRIVE
POSTED SPEED LIMIT = 25 MPH
DESIGN SPEED LIMIT = 25 MPH
2009 ADT = 353 VPD
2040 ADT = 415 VPD

DESIGN DESIGNATION
THORN CREEK DR: LOCAL ROAD

THORN CREEK DRIVE
IMPROVEMENT ENDS
STA. 29 + 91

THORN CREEK DRIVE
IMPROVEMENT BEGINS
STA. 27 + 66

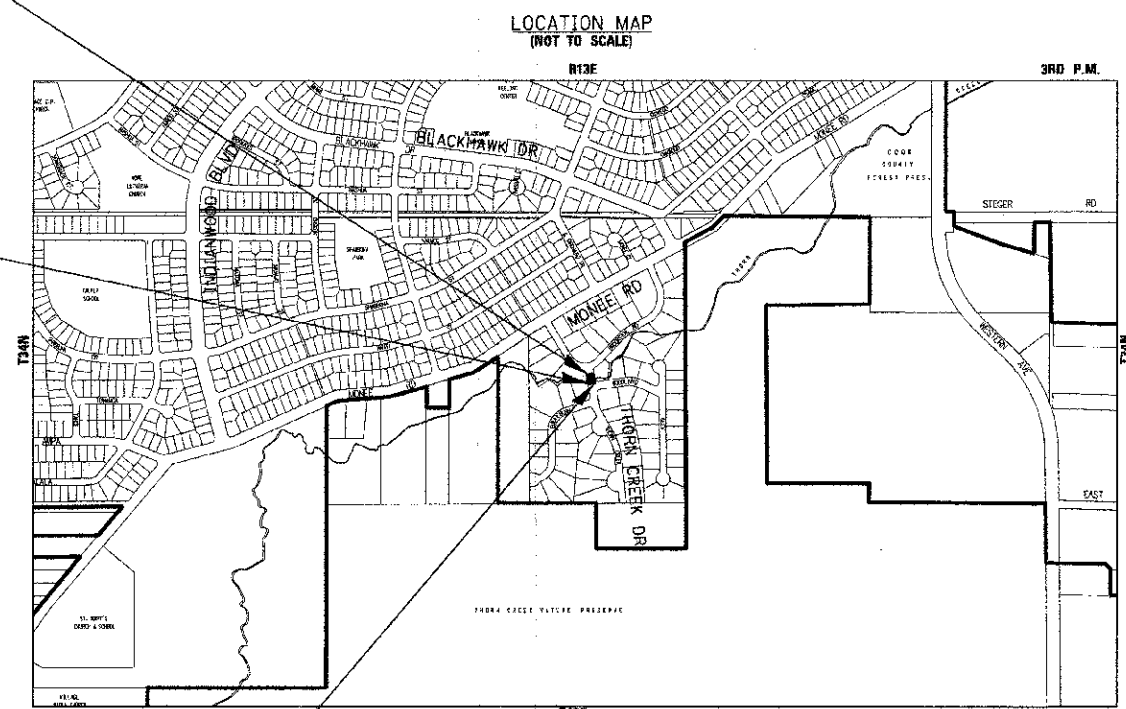
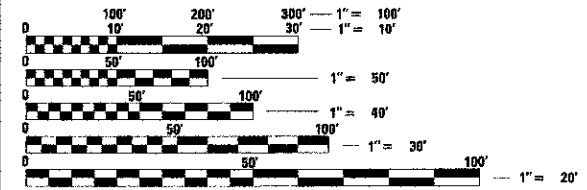

FULL SIZE PLANS HAVE BEEN PREPARED USING STANDARD ENGINEERING SCALES. REDUCED SIZED PLANS WILL NOT CONFORM TO STANDARD SCALES. IN MAKING MEASUREMENTS ON REDUCED PLANS, THE ABOVE SCALES MAY BE USED.

BRIDGE REPLACEMENT
STA. 28 + 96.75
EXISTING SN 099-6750
PROPOSED SN 099-6753

MONEE TOWNSHIP
GROSS LENGTH OF IMPROVEMENT = 225 LF OR 0.043 MILES
NET LENGTH OF IMPROVEMENT = 225 LF OR 0.043 MILES

JULIE, I.E. DESIGN STAGE REQUEST
DIG. No. A1792216

Call Before You Dig
JULIE
ILLINOIS
800-CALL SYSTEM

CONTACT JULIE AT 811 OR 800-892-0123 WITH THE FOLLOWING:
COUNTY = WILL
CITY-TOWNSHIP = MONEE
SEC. & 1/4 SEC. NO. = 1
48 HOURS (2 working days) BEFORE YOU DIG

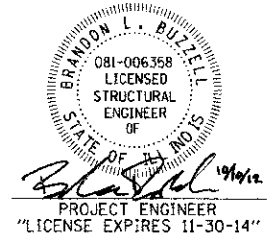
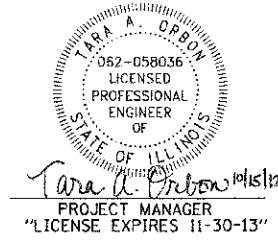

PRINTED BY THE AUTHORITY OF THE STATE OF ILLINOIS

STATE OF ILLINOIS
DEPARTMENT OF TRANSPORTATION
DIVISION OF HIGHWAYS

APPROVED: October 15, 2012
Kenneth A. Ryan
VILLAGE OF PARK FOREST, DIRECTOR OF PUBLIC WORKS

PASSED: NOVEMBER 9, 2012
C. Holt C. Holt
DISTRICT 1 ENGINEER, LOCAL ROADS AND STREETS

RELEASING FOR BID BASED ON LIMITED REVIEW: November 9, 2012
John Fontana
DEPUTY DIRECTOR OF HIGHWAYS, REGION 1 ENGINEER

CONTRACT NO. 63755

B&W PROJECT NO.: 080286 DATE: 10-12-12

COPYRIGHT © 2012 BY BAXTER & WOODMAN, INC.
 LICENSE NO. 081-006358 EXPIRES 11/30/14
 388800 IL 811 CALL SYSTEM 430/202
 10/17/2012
 PROGRAM AND OFFICE ENGINEER: CHARLES F. RIDDLE, P.E. (947)705-4406 SCHAUMBURG, IL