

STORM STRUCTURES						
NO.	STATION	OFFSET	TYPE	FRAME	RIM/EP	INVERTS
EX CB-19	302+88	14.4 RT	EX CATCH BASIN	TY 1 FR, CLID	-	632.69 12" N (EX); 632.80 12" S
CB-28	302+88	22' RT	CATCH BASIN, TYPE C	TY 24 F&G	635.48 EP	632.87 12" N
EX CB-20	305+03	29' LT	EX CATCH BASIN	EXISTING	-	635.75 12" SE (EX); 637.30 12" S
IN-3	305+05	23.5' LT	INLET, TYPE A	TY 24 F&G	640.33 EP	637.50 12" N

NOTES:
 1. THE GENERAL CONTRACTOR IS REQUIRED TO HIRE AN ENVIRONMENTAL FIRM WITH AT LEAST (5) FIVE DOCUMENTED LEAKING UNDERGROUND STORAGE TANK CLEANUPS OR THAT IS PRE-QUALIFIED IN HAZARDOUS WASTE BY THE DEPARTMENT TO REMEDIATE THE SOIL CONTAMINATION AND MONITOR FOR WORKER PROTECTION.

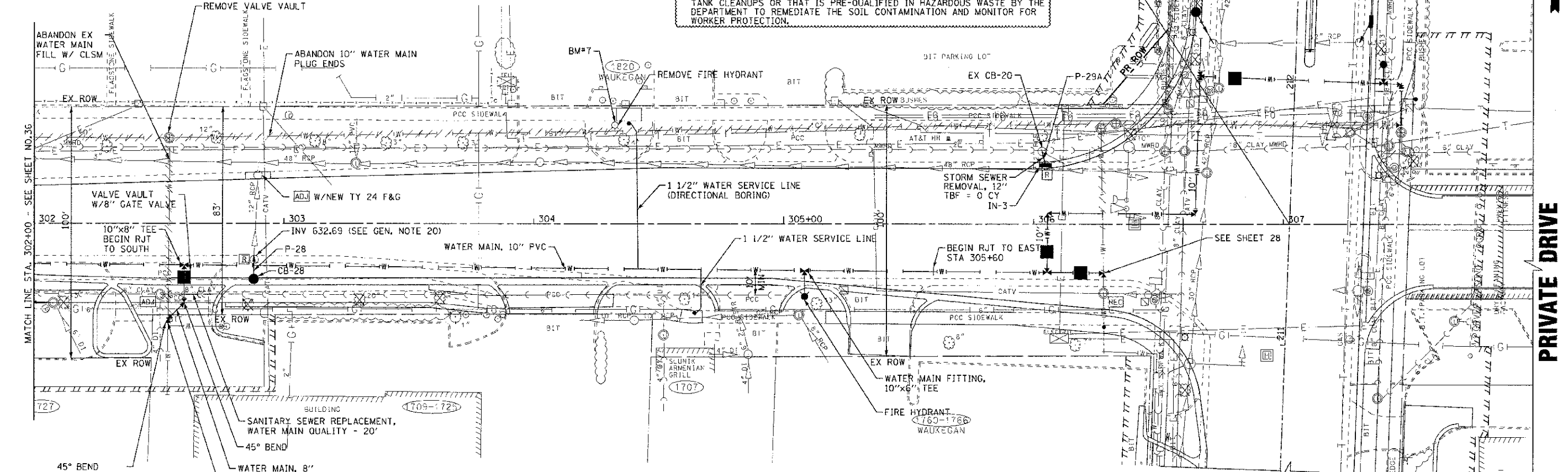

CHESTNUT AVENUE

STORM PIPES					
NO.	TYPE	LENGTH (LF)	DIA (IN)	SLOPE	TBF (CY)
P-28	SS (WATER MAIN REQUIREMENTS)	7	12	1.00%	1.3
P-29A	SS, CL A, TYPE 1	5	12	4.00%	0.8

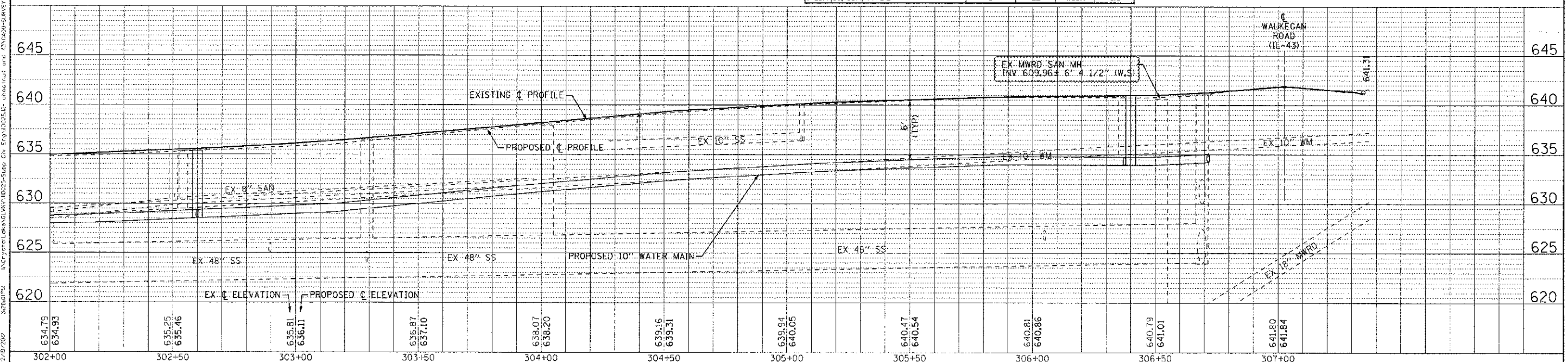

DESIGNED - DSH	REVISED - 10-12-12 PER VILLAGE
DRAWN - MAC	REVISED - 12-19-12 ADDENDUM 1
CHECKED - TLF	REVISED -
DATE - 8/23/12	FILE 110025-12-DU6.sht

STATE OF ILLINOIS
 DEPARTMENT OF TRANSPORTATION

DRAINAGE AND UTILITY
 CHESTNUT AVENUE

F.A.P./F.A.U. RTE.	SECTION	COUNTY	TOTAL SHEETS	SHEET NO.
0348/1362	05-00160-00-CH	COOK	109	37
C-91-070-06		CONTRACT NO. 63756		
FED. ROAD DIST. NO. 1 (ILLINOIS)		FED. AID PROJECT F-0348/36		

COPYRIGHT © 2012 BY BAXTER & WOODMAN, INC.
 STATE OF ILLINOIS - PROFESSIONAL DESIGN FIRM
 2/19/2012
 110025-12-DU6.sht