

☉ CHESTNUT AVENUE STA 297+70.89
 ☉ RIVERSIDE COURT

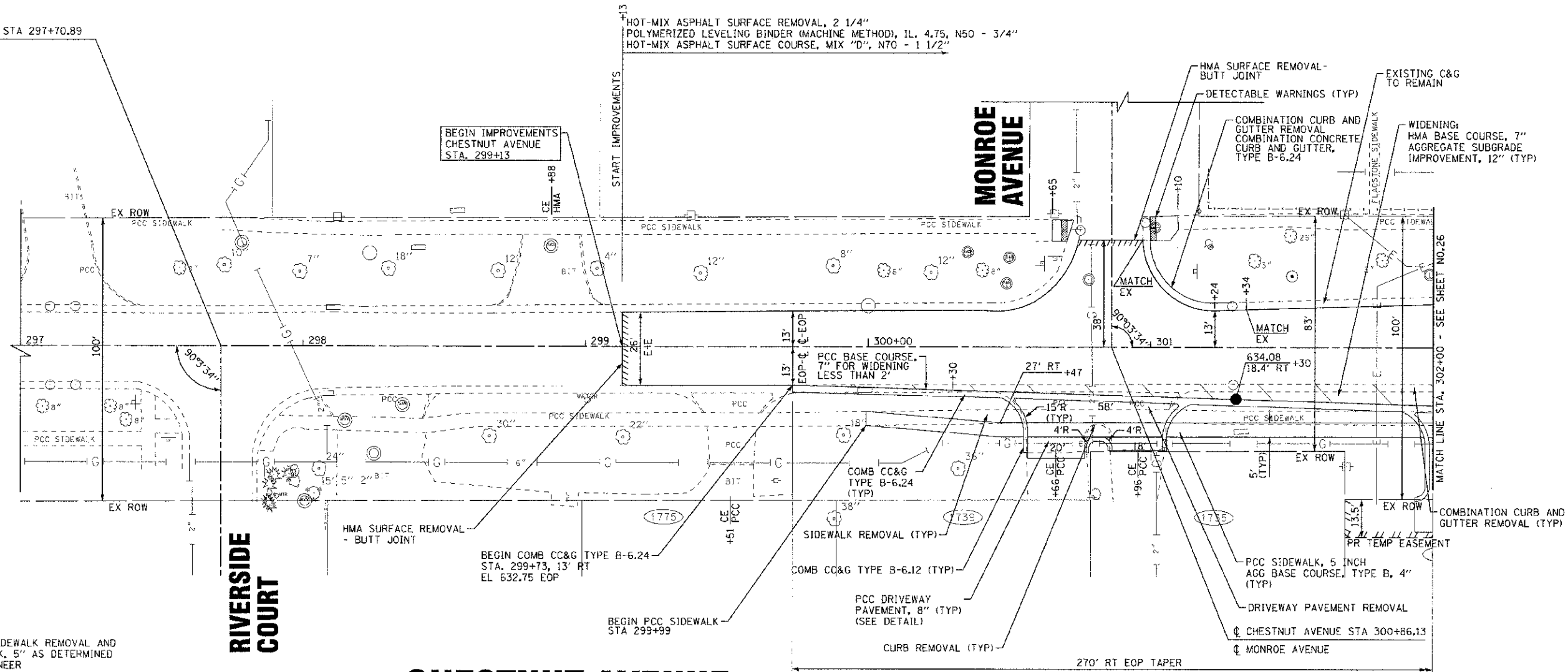

NOTE:
 LIMITS OF SIDEWALK REMOVAL AND
 PCC SIDEWALK, 5" AS DETERMINED
 BY THE ENGINEER

CHESTNUT AVENUE

PAVEMENT WIDENING

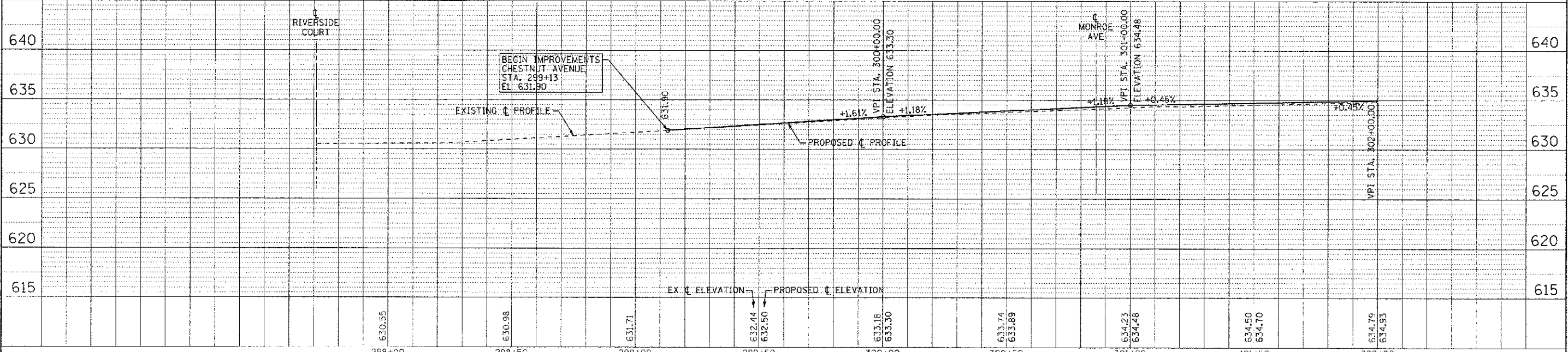

DESIGNED - DSH	REVISED - 10-12-12 PER ID07
DRAWN - MAC	REVISED -
CHECKED - 7LH	REVISED -
DATE - 8/23/12	FILE - 110025-12-PF5.sht

STATE OF ILLINOIS
 DEPARTMENT OF TRANSPORTATION

GEOMETRIC PLAN AND PROFILE
 CHESTNUT AVENUE

SCALE: H: 1"=20' V: 1"=5'
 STA. 297+00 TO STA. 302+00

F.A.P./T.A.U. R.T.E.	SECTION	COUNTY	TOTAL SHEETS	SHEET NO.
0348/1352	05-00160-00-CH	COOK	109	25
C-91-070-05		CONTRACT NO. 63756		
FED. ROAD DIST. NO. 1		ILLINOIS		
		FED. AID PROJECT F-0348(1352)		

COMMENT: 2012 BY: BAXTER & WOODMAN, INC.
 STATE OF ILLINOIS
 3300 E. MONROE AVENUE
 CHICAGO, IL 60605
 TEL: 312.771.1100
 FAX: 312.771.1101
 WWW.BAXTERANDWOODMAN.COM