

# CHESTNUT AVENUE

STORM PIPES					
NO.	TYPE	LENGTH (LF)	DIA (IN)	SLOPE	TBF (CY)
P-28A	SS (WATER MAIN REQUIREMENTS)	5	12	2.00%	0.7
P-28B	SS, CL B, TYPE 1	75	15	EX	13.4

STORM STRUCTURES						
NO.	STATION	OFFSET	TYPE	FRAME	RIM/FP	INVERTS
EX CB-18	301+29	13.2' RT	EX CATCH BASIN	TY 1 FR, CLID	-	631.29 12" N (EX); 631.30 12" S
CB-27	301-30	18.3' RT	CATCH BASIN, TYPE C	TY 24 F&G	634.25 EP	631.65± 12" S (EX); 631.40 12" N
MH-4	301+50	25' LT	MANHOLE, TYPE A, 7'-DIA, RESTRICTOR PLATE	TY 1 FR, CLID	634.81 RIM	621.64 48" E & W (EX); RESTRICTOR 622.50 32"

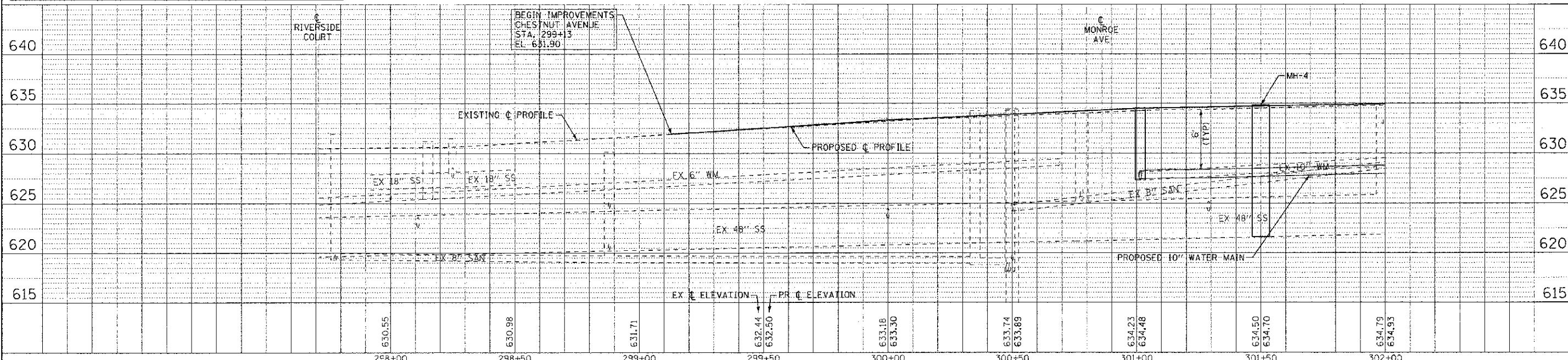

	DESIGNED - DSH	REVISED -	<b>STATE OF ILLINOIS</b> <b>DEPARTMENT OF TRANSPORTATION</b>	<b>DRAINAGE AND UTILITY</b> <b>CHESTNUT AVENUE</b>	F.A.P./F.A.U. RITE	SECTION	COUNTY	TOTAL SHEETS	SHEET NO.
	DRAWN - MAC	REVISED -			0348/1352	05-00160-00-CH	COOK	109	36
	CHECKED - TLH	REVISED -			C-91-070-06		CONTRACT NO. 63756		
	DATE - 8/23/12	FILE - 110025-12-Du5.sht			FED. ROAD DIST. NO. 1 ILLINOIS		FED. AID PROJECT F-0348(35)		

COPYRIGHT © 2012 BY BAKER & WOODMAN, INC. STATE OF ILLINOIS - PROFESSIONAL ENGINEERING DRAWING. ALL RIGHTS RESERVED. PROJECT NO. 05-00160-00-CH. SHEET NO. 109 OF 36. DATE: 8/23/12. FILE: 110025-12-Du5.sht.