

STORM STRUCTURES						
NO.	STATION	OFFSET	TYPE	FRAME	RIM/EP	INVERTS
EX MH-5	16+56	15.9' RT	EX MANHOLE	EXISTING	-	632.87 12" N (EX); 632.87 12" W (EX); 634.87 12" E
CB-29	18+43	12.5' RT	CATCH BASIN, TYPE A, 4' DIA	TY 11 F&G	640.66 EP	636.55 12" N; 637.30 12" S; 635.35 12" W
CB-30	17+50	12.5' RT	CATCH BASIN, TYPE C	TY 11 F&G	639.70 EP	635.90 12" E; 635.80 12" W
IN-31	18+43	12.5' LT	INLET, TYPE A	TY 11 F&G	640.32 EP	637.30 12" S
IN-32	18+47	29.5' RT	INLET, TYPE A	TY 11 F&G	640.53 EP	638.15 12" N

STORM PIPES					
NO.	TYPE	LENGTH (LF)	DIA (IN)	SLOPE	TBF (CY)
P-29	SS, CL B, TYPE 1	94	12	1.00%	26.2
P-30	SS, CL B, TYPE 1	91	12	0.50%	24.4
P-31	SS, CL B, TYPE 1	25	12	3.00%	5.4
P-32	SS, CL B, TYPE 1	17	12	5.00%	4.7

BEGIN NON-PARTICIPATING IMPROVEMENTS JEFFERSON AVENUE STA. 16+37

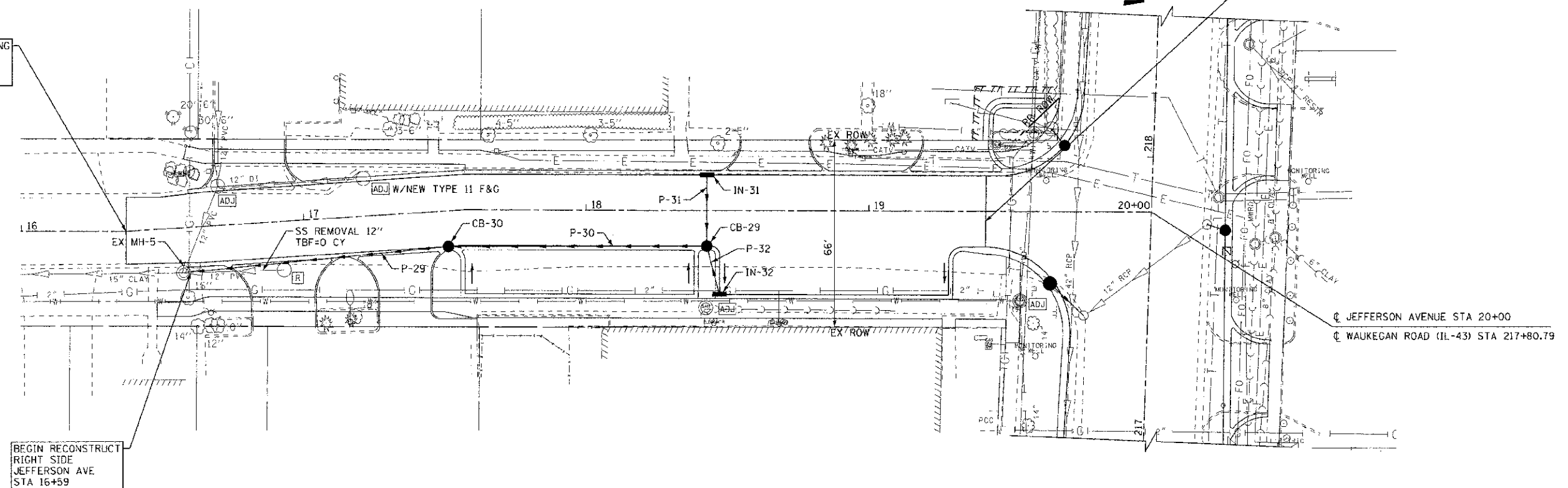

BEGIN RECONSTRUCT RIGHT SIDE JEFFERSON AVE STA 16+59

END NON-PARTICIPATING IMPROVEMENTS  
BEGIN PARTICIPATING IMPROVEMENTS  
END RECONSTRUCTION RIGHT  
JEFFERSON AVENUE  
STA. 19+41.5

JEFFERSON AVENUE STA 20+00  
WAUKEGAN ROAD (IL-43) STA 217+80.79

# JEFFERSON AVENUE

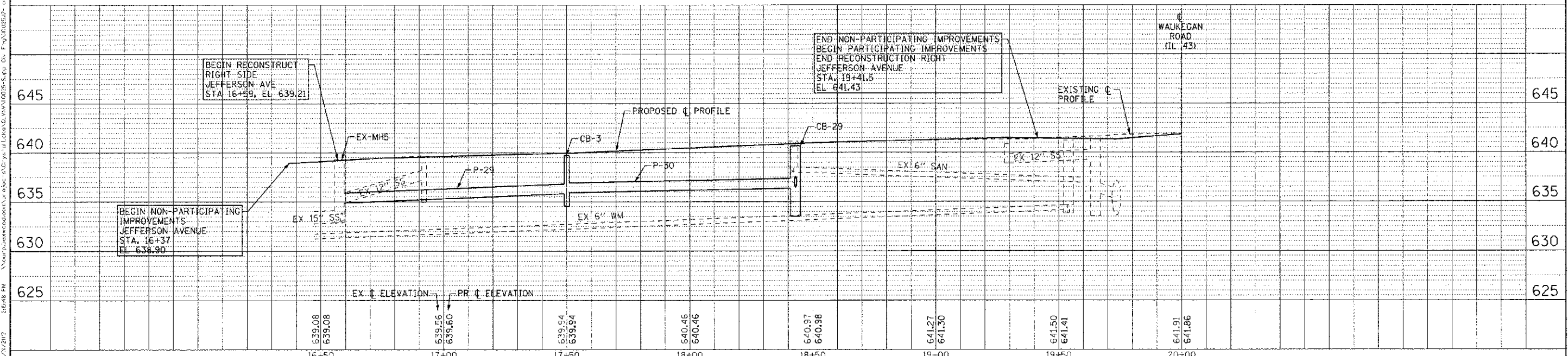

COPYRIGHT © 2012 BY BAXTER & WOODMAN, INC.  
 STATE OF ILLINOIS PROFESSIONAL ENGINEERING  
 12/12/2017 2:08 PM



DESIGNED - DSH	REVISED - 10-12-12 PER VILLAGE
DRAWN - MAC	REVISED -
CHECKED - TLH	REVISED -
DATE - 8/23/12	FILE - 110025-12-DU7.shx

STATE OF ILLINOIS  
DEPARTMENT OF TRANSPORTATION

DRAINAGE AND UTILITY  
JEFFERSON AVENUE

SCALE: HORIZ 1"=20' VERT 1"=5'  
STA. 16+59 TO STA. 19+41.5

F.A.P./F.A.U. R.E.	SECTION	COUNTY	TOTAL SHEETS	SHEET NO.
0348/1352	05 00160-00 CH	COOK	109	38
C-91-070-06		CONTRACT NO. 63756		
FED. ROAD DIST. NO. 1 ILLINOIS		FED. AID PROJECT F-03481351		