

- LEGEND**
- CLASS B OR D PATCHES
 - HOT-MIX ASPHALT SURFACE REMOVAL - BUTT JOINT
 - HOT-MIX ASPHALT SURFACE REMOVAL, 2" SPECIAL OR VARIABLE DEPTH
 - EXISTING CONCRETE SIDEWALK OR DRIVEWAY TO REMAIN IN PLACE
 - SIDEWALK OR PCC DRIVEWAY REMOVAL AND REPLACEMENT
 - HOT-MIX ASPHALT DRIVEWAY REMOVAL AND REPLACEMENT
 - STRUCTURE TO BE ADJUSTED
 - NEW F&G/LID TYPE (WHERE SHOWN)
 - STRUCTURE TO BE REMOVED

NOTES:
 1. SEE "PAVEMENT MARKING, SIGNING, SIDEWALK AND DRIVEWAY PLAN" FOR SIDEWALK AND DRIVEWAY INFORMATION.

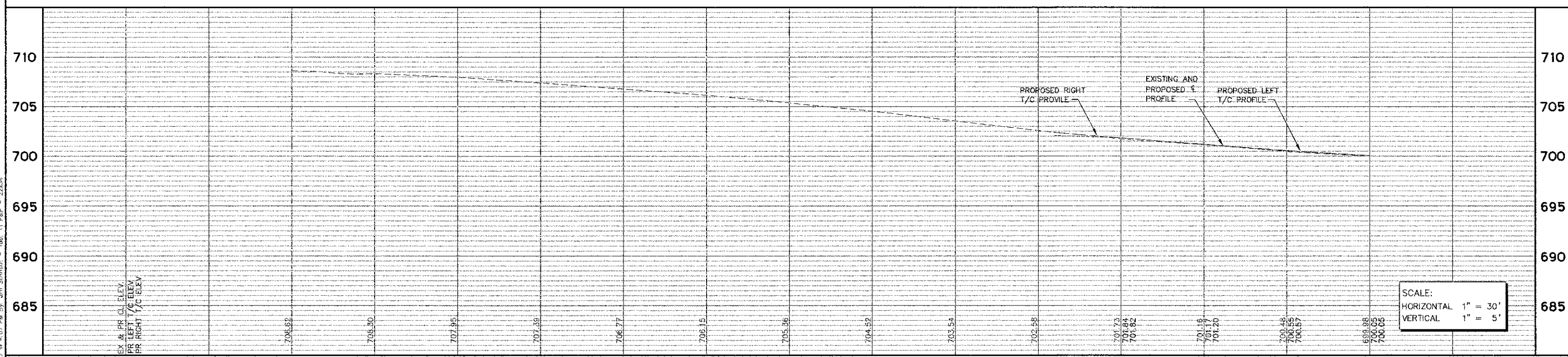

SCALE:
 HORIZONTAL 1" = 30'
 VERTICAL 1" = 5'

Engineering Enterprises, Inc. CONSULTING ENGINEERS 52 Wheeler Road Sugar Grove, Illinois 60554 630.466.6700 / www.eeiweb.com		USER NAME = PLOT SCALE = PLOT DATE =	DESIGNED - SWM/TWV DRAWN - KKP/CLN/JPS CHECKED - JRL DATE - 8/24/12	REVISED - REVISED - REVISED - REVISED -	STATE OF ILLINOIS DEPARTMENT OF TRANSPORTATION		BATAVIA ROAD PLAN AND PROFILE		F.A.U. RTE. 3553	SECTION 10-00031-00-RS	COUNTY DUPAGE	TOTAL SHEETS 29	SHEET NO. 11	CONTRACT NO. 63758
Copyright © 2012 Engineering Enterprises, Inc.		SCALE: 1"=30'		SHEET NO. 1 OF 5 SHEETS		STA. 2042+50 TO STA. 2050+50		FED. ROAD DIST. NO. 1 ILLINOIS FED. AID PROJECT - M-9003(R66)						

Plotted: October 18, 2012 @ 4:07 PM By: Jim Schmidt - Tab: 11 P&P - 22x36

Path: \\S05P000\work\006\low\final\BATAVIA\BATAVIA.PDF