

- (A) STONE RIPRAP CLASS B4 L20' X W20'
- (B) STONE RIPRAP CLASS B4 L100' X W10'
- (C) STONE RIPRAP CLASS B5 L28' X W20'
- (D) STONE RIPRAP CLASS B4 L520' X W12'
- (E) STONE RIPRAP CLASS B4 L130' X W10'
- (F) STONE RIPRAP CLASS B4 EROSION PROTECTION L32' X W20'
- (G) STONE RIPRAP CLASS B4 L80' X W10'
- (H) STONE RIPRAP CLASS B4 L32' X W20'
- (I) STONE RIPRAP CLASS B4 L255' X W10'

PLAN	SURVEYED	DATE
	PLOTTED	
	ALIGNED	
	CHECKED	
	FILED	
	NO.	

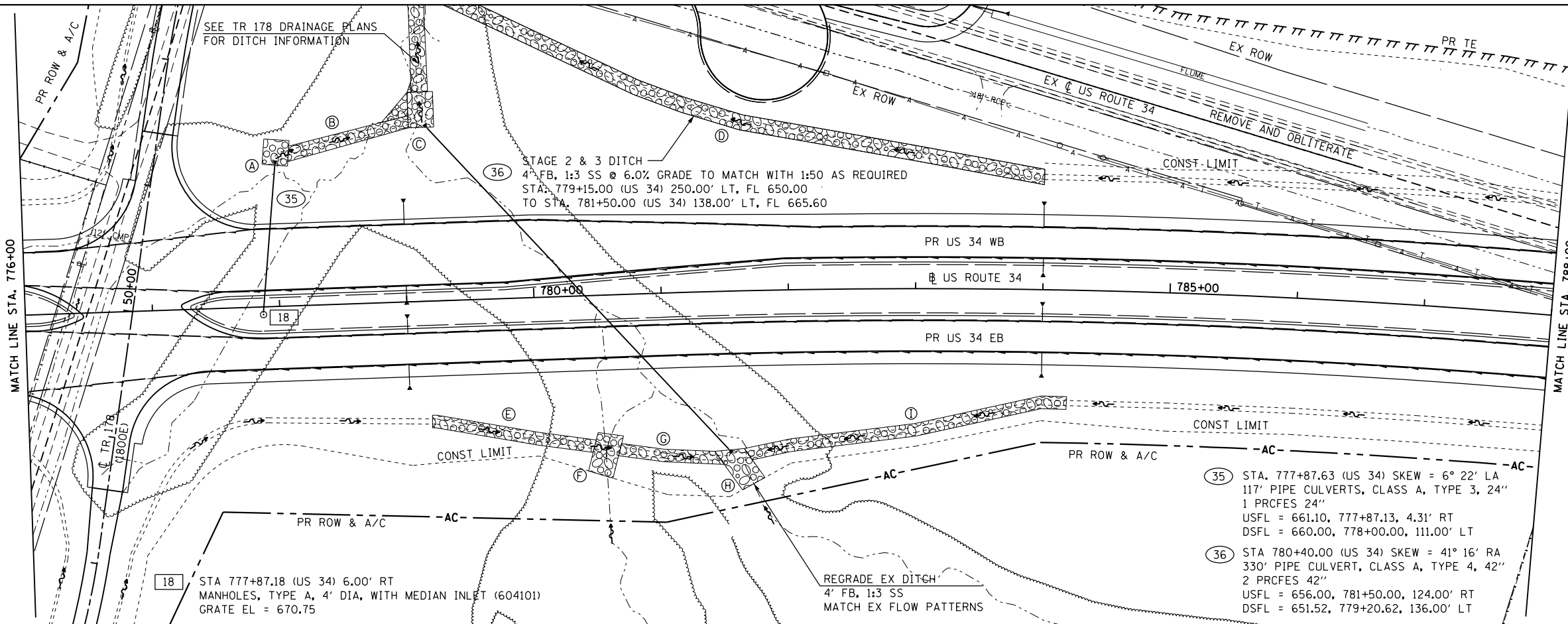

SEE SCHEDULE OF QUANTITIES FOR PIPE UNDERDRAIN OUTLETS LOCATION, OFFSET, AND ELEVATION

SEE PIPE UNDERDRAIN SHEETS FOR UNDERDRAIN PROFILES AND INVERTS AT EDGE OF PAVEMENT

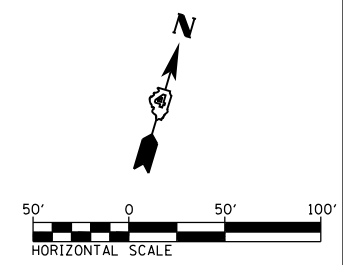

PROFILE	SURVEYED	DATE
	PLOTTED	
	GRADES CHECKED	
	STRUCTURE NOTATIONS CHECKED	
	NO.	

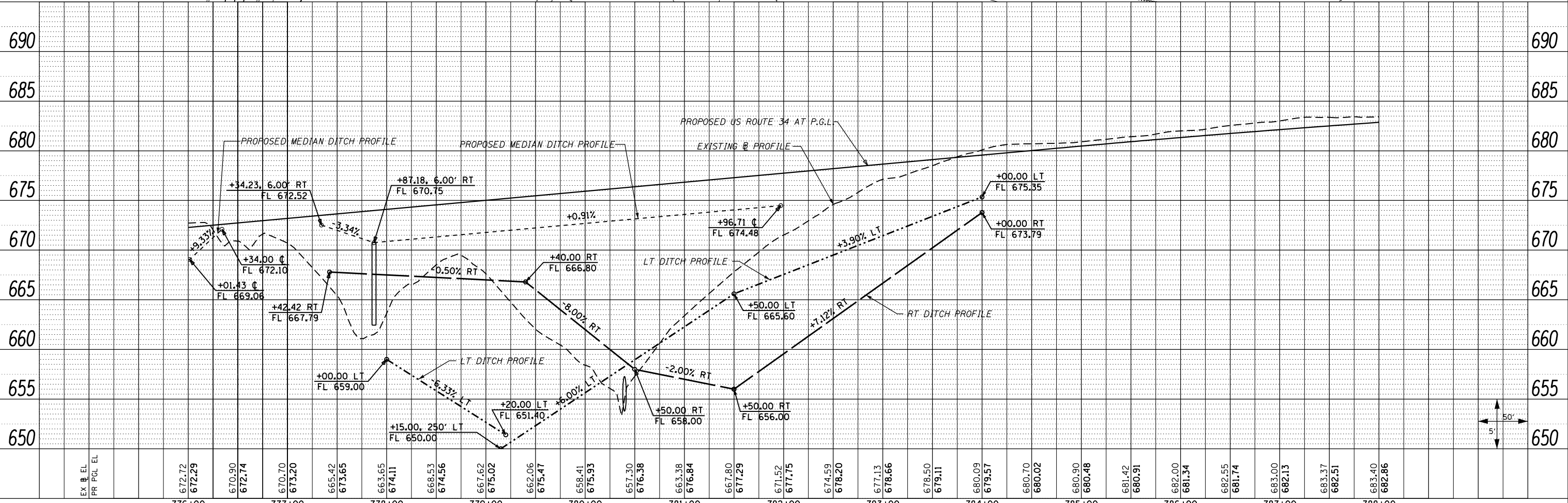

FILE NAME =	USER NAME = zechl	DESIGNED - DBS	REVISED -	<b>STATE OF ILLINOIS DEPARTMENT OF TRANSPORTATION</b>	<b>DRAINAGE PLAN AND PROFILE US ROUTE 34</b>	F.A.P. RTE. 313	SECTION 7-2 ; 6-1	COUNTY HENDERSON	TOTAL SHEETS 976	SHEET NO. 298
D468409-shd-23-drain-US34-23.dgn	PLOT SCALE = 100.0000' / 1"	DRAWN - PSBA	REVISED -			SCALE: 1"=50'	SHEET NO. 23 OF 61 SHEETS	STA. 776+00 TO STA. 788+00	CONTRACT NO. 68409	
	PLOT DATE = 10/16/2012	CHECKED - CSB	REVISED -			ILLINOIS FED. AID PROJECT				
		DATE - 10/2012	REVISED -							