

STATE OF ILLINOIS
DEPARTMENT OF TRANSPORTATION
DIVISION OF HIGHWAYS

**PROPOSED
HIGHWAY PLANS**

FAP ROUTE 322 (US 51)

SECTION 11-13

PROJECT ACNHF-0322(096)

**FOUR LANE EXPRESSWAY - PARTIAL ACCESS CONTROL
CHRISTIAN COUNTY**

C-96-501-09

F.A.P. RTE	SECTION	COUNTY	TOTAL SHEETS	SHEET NO.
322	11-13	CHRISTIAN	437	1

D-96-513-05

437 + 4 = 441

CONTRACT # 72961

FOR INDEX OF SHEETS, SEE SHEET NO. 2

DESIGN DESIGNATION:

FAP 322 (ARTERIAL)
ADT=3,950 (2005)
% SU=3
% MU=13

TR 268 (LOCAL ROAD)
ADT = 25 (2005)

TR 273 (LOCAL ROAD)
ADT = 75 (2005)

TR 255 (LOCAL ROAD)
ADT = 25 (2005)

TR 257 (LOCAL ROAD)
ADT = 50 (2005)

TR 243 (LOCAL ROAD)
ADT = 250 (2005)

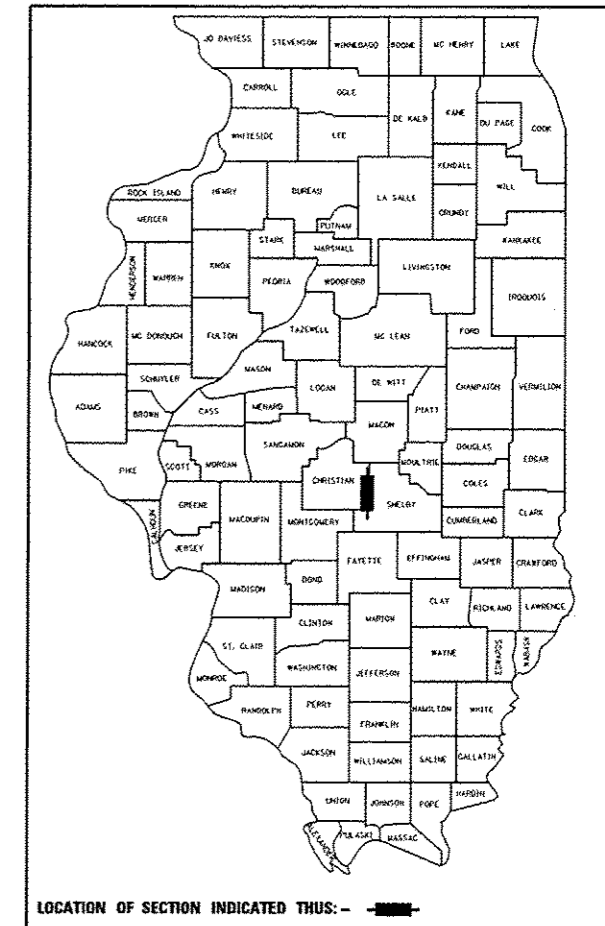
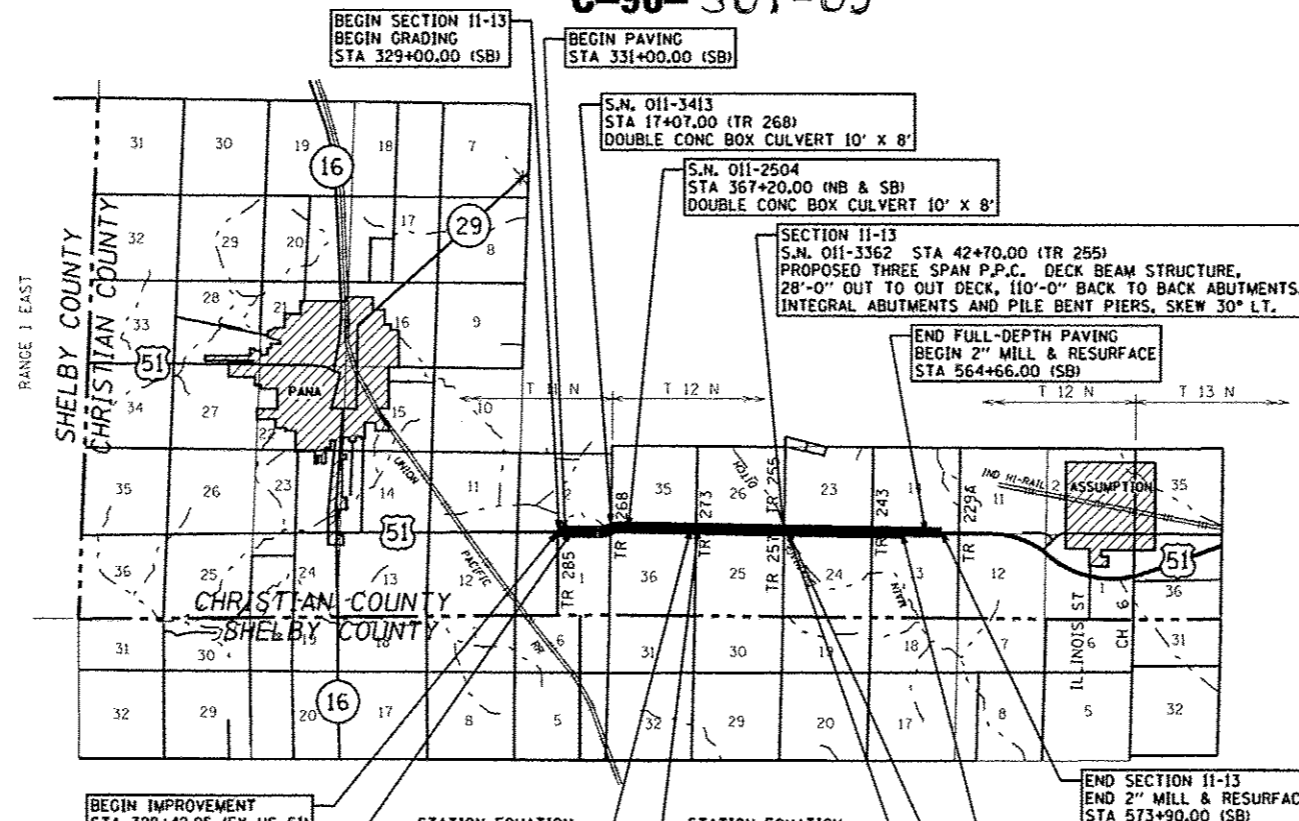

STATE OF ILLINOIS
DEPARTMENT OF TRANSPORTATION
DIVISION OF HIGHWAYS

SUBMITTED October 16, 2012
John D. Baranzelli, PE, Inc.
DEPUTY DIRECTOR OF HIGHWAYS, REGION ENGINEER

Dec 7, 2012
John D. Baranzelli, PE, Inc.
ENGINEER OF DESIGN AND ENVIRONMENT

Dec 7, 2012
William R. Frey, Inc.
DIRECTOR OF HIGHWAYS, CHIEF ENGINEER

STEVE E. BANGE
062-053338
LICENSED PROFESSIONAL ENGINEER
ILLINOIS

Steve E. Bange 8/10/12
STEVE E. BANGE DATE
REGISTERED PROFESSIONAL ENGINEER
STATE OF ILLINOIS NO. 062-053338
LICENSE EXPIRES NOVEMBER 30, 2013



FULL SIZE PLANS HAVE BEEN PREPARED USING STANDARD ENGINEERING SCALES, REDUCED SIZED PLANS WILL NOT CONFORM TO STANDARD SCALES, IN MAKING MEASUREMENTS ON REDUCED PLANS, THE ABOVE SCALES MAY BE USED.

J.U.L.I.E.
JOINT UTILITY LOCATION INFORMATION FOR EXCAVATION
1-800-892-0123

CONTRACT NO. 72961

PLANS PREPARED BY
KLINGNER & ASSOCIATES, P.C.

Engineers / Architects
616 North 24th Street (217) 223-3670
Quincy, Illinois 62301 FAX: 223-3603
Internet Address: www.klingner.com
STATE OF ILLINOIS DESIGN FIRM # 1842738

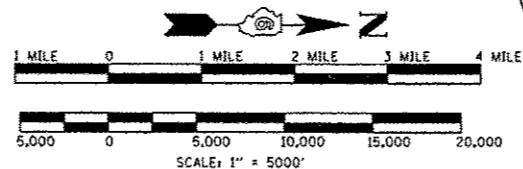

LOCATION MAP

GROSS LENGTH OF SECTION 11-13 = 23,819 ft = 4.511 miles
NET LENGTH OF SECTION 11-13 = 23,695 ft = 4.488 miles

PROJECT ENGINEER: JEFF MYERS (217) 782-4761
TEAM LEADER: EMMY REED
STATE OF ILLINOIS DESIGN FIRM # 1842738