

F.A.P. RTE.	SECTION	COUNTY	TOTAL SHEETS	SHEET NO.
322	11-13	CHRISTIAN	437	60
STA.		TO STA.		
FED. ROAD DIST. NO.	ILLINOIS	FED. AID PROJECT		

FAP 322 (US 51)

EX US 51 CURVE #617 DATA

010 PI STA = 329+99.19  
 $\Delta = 0^\circ 27' 58''$  (RT)  
 D = 0' 2' 48"  
 R = 122,929.92'  
 T = 500.00'  
 L = 999.99'  
 E = 1.02'

011 PC STA = 324+99.19  
 012 PT STA = 334+99.18

FAP 322 CURVE #SMI DATA

418 PI STA = 495+42.92  
 $\Delta = 0^\circ 39' 51''$  (LT)  
 D = 0' 7' 57"  
 R = 43,200.00'  
 T = 250.40'  
 L = 500.80'  
 E = 0.73'

417 PC STA = 492+92.51  
 419 PT STA = 497+93.31

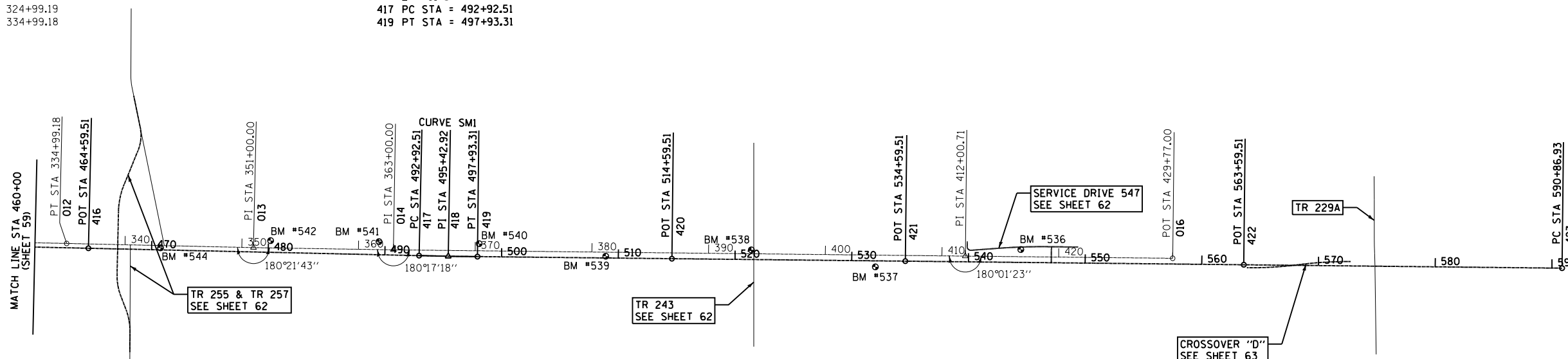

BENCHMARKS		
MARK	ELEVATION	DESCRIPTION
BM #544	647.33	CHSLD " □ " IN NORTHEAST WINGWALL OF S.N. 011-0037 STA 470+76.00, 17.00' LT (PR US 51) STA 343+03.50, 20.00' RT (EX US 51)
BM #542	649.51	60d NAIL IN PP - 3.32 MILES SOUTH OF JCT ILLINOIS ST / US 51 STA 480+17.91, 99.85' LT (PR US 51) STA 352+45.80, 61.90' LT (EX US 51)
BM #541	661.21	CHSLD " □ " IN NORTHEAST CORNER OF CONCRETE WELL FOUNDATION - 3.14 MILES SOUTH OF JCT ILLINOIS ST / US 51 STA 489+46.85, 112.25' LT (PR US 51) STA 361+74.80, 68.45' LT (EX US 51)
BM #540	652.44	60d NAIL IN PP - 2.97 MILES SOUTH OF JCT ILLINOIS ST / US 51 STA 498+06.74, 110.70' LT (PR US 51) STA 370+33.70, 60.85' LT (EX US 51)
BM #539	645.77	CHSLD " □ " IN SOUTH END OF EAST HW 2.77 MILES SOUTH OF JCT ILLINOIS ST / US 51 STA 508+92.31, 15.00' LT (PR US 51) STA 381+19.30, 34.60' RT (EX US 51)
BM #538	649.76	CHSLD " □ " IN CENTER OF SOUTH HW - 2.53 MILES SOUTH OF JCT ILLINOIS ST / US 51 STA 521+38.73, 82.60' LT (PR US 51) STA 393+65.70, 33.30' LT (EX US 51)
BM #537	651.40	CHSLD " □ " WEST EDGE OF NORTH CONCRETE BIN FOUNDATION - 2.33 MILES SOUTH OF JCT ILLINOIS ST / US 51 STA 532+02.80, 52.00' RT (PR US 51) STA 404+29.80, 101.00' RT (EX US 51)
BM #536	648.49	60d NAIL IN PP - 2.09 MILES SOUTH OF JCT ILLINOIS ST / US 51 STA 544+47.21, 109.75' LT (PR US 51) STA 416+74.20, 60.85' LT (EX US 51)

	CONTROL POINTS		
	POINT	NORTHING	EASTING
EX US 51	012	1,020,272.39	2,613,439.93
	013	1,021,873.01	2,613,465.40
	014	1,023,072.95	2,613,476.92
	015	1,027,973.62	2,613,499.29
	016	1,029,749.89	2,613,506.68

	CONTROL POINTS		
	POINT	NORTHING	EASTING
MAINLINE FAP 322 (US 51)	416	1,020,459.61	2,613,479.91
	417	1,023,292.25	2,613,524.99
	418	1,023,542.62	2,613,528.98
	419	1,023,793.02	2,613,530.06
	420	1,025,459.21	2,613,537.26
	421	1,027,459.19	2,613,545.90
	422	1,030,359.16	2,613,558.43
	423	1,033,086.55	2,613,570.21

REVISIONS	
NAME	DATE

ILLINOIS DEPARTMENT OF TRANSPORTATION  
 ALIGNMENT & BENCHMARK DATA  
 SHEET 2 OF 5  
 FAP 322 (US 51)  
 SECTION 11-13  
 CHRISTIAN COUNTY  
 SCALE: 1"=500'  
 DATE: \_\_\_\_\_ DRAWN BY: SEB  
 CHECKED BY: \_\_\_\_\_

10/5/2012

D:\01Files\010325\1 SOUTH PLANS NEW\CA00 - Sheets\06\2961-sh1-rd-alignment\02.dgn