

F.A.P. RTE.	SECTION	COUNTY	TOTAL SHEETS	SHEET NO.
322	11-13	CHRISTIAN	437	62
STA.		TO STA.		
FED. ROAD DIST. NO.		ILLINOIS FED. AID PROJECT		

POINT	CONTROL POINTS	
	NORTHING	EASTING
600	1,026,157.23	2,612,949.36
601	1,026,158.13	2,613,090.30
602	1,026,160.68	2,613,491.01
603	1,026,160.99	2,613,540.29
604	1,026,162.96	2,613,850.28
605	1,026,165.74	2,614,285.89

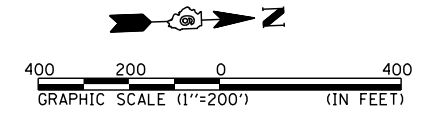
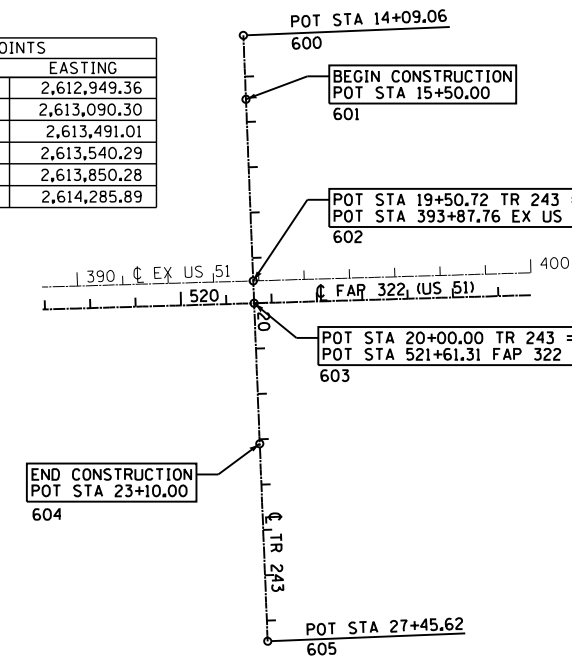

POINT	CONTROL POINTS	
	NORTHING	EASTING
560	1,020,812.75	2,611,423.65
561	1,020,813.67	2,612,001.52
562	1,020,813.75	2,612,048.22
563	1,020,823.37	2,612,093.91
564	1,021,109.50	2,613,453.25

EX TR 255 CURVE #809 DATA
 562 PI STA = 15+64.51
 $\Delta = 11^\circ 47' 42''$ (LT)
 $D = 12^\circ 40' 31''$
 $R = 452.03'$
 $T = 46.69'$
 $L = 93.06'$
 $E = 2.41'$
 561 PC STA = 15+17.82
 563 PT STA = 16+10.87

POINT	CONTROL POINTS	
	NORTHING	EASTING
570	1,020,865.59	2,612,294.47
571	1,020,896.06	2,612,439.24
572	1,020,917.96	2,612,543.29
573	1,020,878.28	2,612,641.94
574	1,020,761.54	2,612,932.18
575	1,020,716.58	2,613,043.94
576	1,020,714.66	2,613,164.40
577	1,020,710.17	2,613,446.89
578	1,020,709.58	2,613,483.89
579	1,020,706.08	2,613,703.84
580	1,020,704.61	2,613,796.16
581	1,020,737.83	2,613,882.31
582	1,020,786.04	2,614,007.33
583	1,020,819.31	2,614,093.59
584	1,020,819.53	2,614,186.04
585	1,020,819.70	2,614,256.84

TR 255 CURVE #2 DATA
 575 PI STA = 45+62.70
 $\Delta = 21^\circ 00' 00''$ (LT)
 $D = 8^\circ 48' 53''$
 $R = 650.00'$
 $T = 120.47'$
 $L = 238.24'$
 $E = 11.07'$
 574 PC STA = 44+42.23
 576 PT STA = 46+80.47

TR 255 CURVE #1 DATA
 572 PI STA = 40+29.27
 $\Delta = 33^\circ 47' 56''$ (RT)
 $D = 16^\circ 22' 13''$
 $R = 350.00'$
 $T = 106.33'$
 $L = 206.47'$
 $E = 15.80'$
 571 PC STA = 39+22.94
 573 PT STA = 41+29.40

POINT	CONTROL POINTS	
	NORTHING	EASTING
590	1,020,817.76	2,613,448.61
591	1,020,820.10	2,614,425.45

POT STA 49+63.00 PR TR 255 =
 POT STA 339+37.01 EX US 51
 577

POT STA 50+00.00 PR TR 255 / TR 257 =
 POT STA 467+09.51 FAP 322
 578

TR 257 CURVE #1 DATA
 580 PI STA = 53+12.31
 $\Delta = 22^\circ 00' 00''$ (LT)
 $D = 12^\circ 03' 44''$
 $R = 475.00'$
 $T = 92.33'$
 $L = 182.39'$
 $E = 8.89'$
 579 PC STA = 52+19.98
 581 PT STA = 54+02.37

TR 257 CURVE #2 DATA
 575 PI STA = 56+28.82
 $\Delta = 20^\circ 57' 04''$ (RT)
 $D = 11^\circ 27' 33''$
 $R = 500.00'$
 $T = 92.45'$
 $L = 182.83'$
 $E = 8.48'$
 574 PC STA = 55+36.37
 576 PT STA = 57+19.20

END CONSTRUCTION
 POT STA 57+90.00 PR TR 257 =
 POT STA 28+08.24 EX TR 257
 585

TR 255 / TR 257

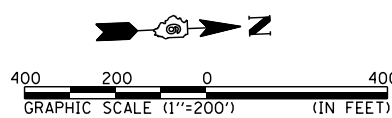

SD 547 CURVE #1 DATA
 612 PI STA = 2+92.42
 $\Delta = 94^\circ 51' 13''$ (LT)
 $D = 190^\circ 59' 09''$
 $R = 30.00'$
 $T = 32.66'$
 $L = 49.67'$
 $E = 14.34'$
 611 PC STA = 2+59.77
 613 PT STA = 3+09.43

SD 547 CURVE #2 DATA
 615 PI STA = 7+59.36
 $\Delta = 4^\circ 51' 12''$ (RT)
 $D = 1^\circ 08' 45''$
 $R = 5000.00'$
 $T = 211.89'$
 $L = 423.53'$
 $E = 4.49'$
 614 PC STA = 5+47.47
 616 PT STA = 9+71.00

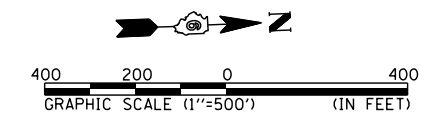
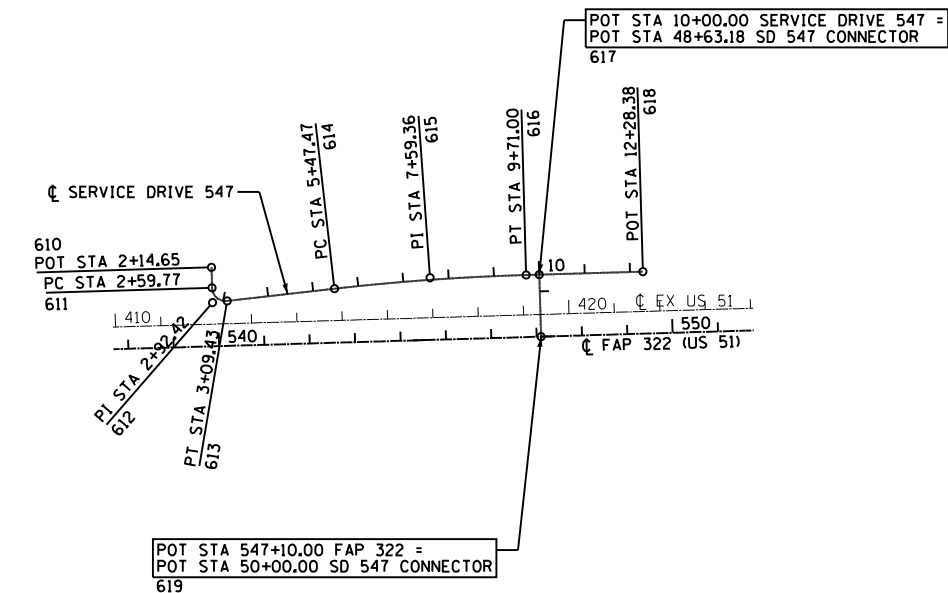

POINT	CONTROL POINTS	
	NORTHING	EASTING
610	1,027,988.69	2,613,374.05
611	1,027,988.48	2,613,419.17
612	1,027,988.32	2,613,451.82
613	1,028,020.87	2,613,449.22
614	1,028,258.15	2,613,430.22
615	1,028,469.36	2,613,413.32
616	1,028,681.25	2,613,414.34
617	1,028,710.25	2,613,414.48
618	1,028,938.63	2,613,415.58
619	1,028,709.66	2,613,551.30

SERVICE DRIVE 547

REVISIONS	
NAME	DATE

ILLINOIS DEPARTMENT OF TRANSPORTATION
 ALIGNMENT & BENCHMARK DATA
 SHEET 4 OF 5
 FAP 322 (US 51)
 SECTION 11-13
 CHRISTIAN COUNTY
 SCALE: 1"=200'
 DATE: _____
 DRAWN BY: SEB
 CHECKED BY: _____

D:\01\files\010325\1\SO\114 PLANS NEW\CA00 - Sheets\06\2961-sh1-tr-alignment\04.dgn 10/5/2012