

F.A.P. RTE.	SECTION	COUNTY	TOTAL SHEETS	SHEET NO.
322	11-13	CHRISTIAN	437	82
STA.		TO STA.		
FED. ROAD DIST. NO.		ILLINOIS FED. AID PROJECT		

FAP 322 CURVE #SC02 DATA
 PI STA = 366+64.75
 $\Delta = 21^\circ 21' 09''$ (RT)
 $D = 2^\circ 36' 16''$
 $R = 2,200.00'$
 $T = 414.75'$
 $L = 819.87'$
 $E = 38.75'$
 $SE = 5.9\%$
 PC STA = 362+50.01
 PT STA = 370+69.88
 SE ATTAINED STA 360+34 TO 363+39
 (TR STA 360+34 TO STA 360+73)
 SE REMOVED STA 369+80 TO STA 372+85
 (TR STA 372+46 TO STA 372+85)

EX S 51 CURVE #608 DATA
 PI STA = 1237+93.56
 $\Delta = 21^\circ 22' 15''$ (RT)
 $D = 03^\circ 29' 55''$
 $R = 1,637.68'$
 $T = 309.01'$
 $L = 610.84'$
 $E = 28.90'$
 $SE = 5.9\%$
 PC STA = 1234+84.54
 PT STA = 1240+95.38

STATION EQUATION:
 PT STA 1240+95.38 BK =
 PT STA 241+34.25 AH

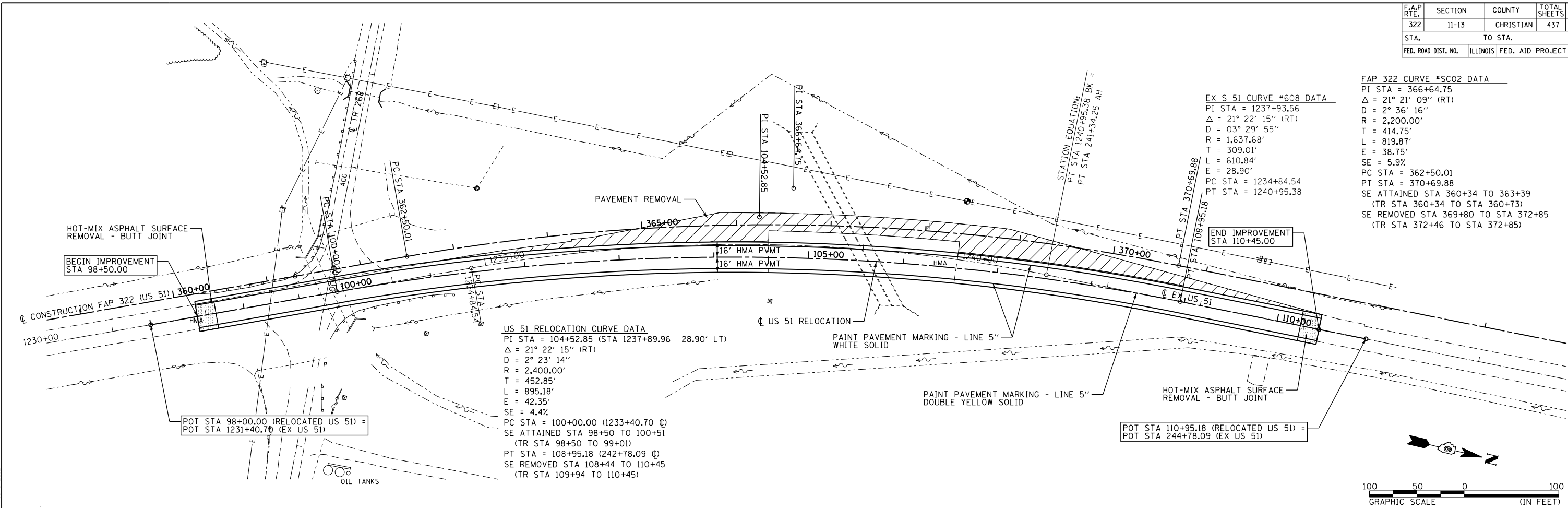

US 51 RELOCATION CURVE DATA
 PI STA = 104+52.85 (STA 1237+89.96 28.90' LT)
 $\Delta = 21^\circ 22' 15''$ (RT)
 $D = 2^\circ 23' 14''$
 $R = 2,400.00'$
 $T = 452.85'$
 $L = 895.18'$
 $E = 42.35'$
 $SE = 4.4\%$
 PC STA = 100+00.00 (1233+40.70 ϕ)
 SE ATTAINED STA 98+50 TO 100+51
 (TR STA 98+50 TO 99+01)
 PT STA = 108+95.18 (242+78.09 ϕ)
 SE REMOVED STA 108+44 TO 110+45
 (TR STA 109+94 TO 110+45)

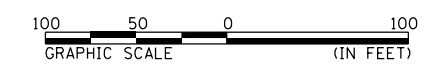

PLAN	DATE
SURVEYED	
ALIGNED	
CHECKED	
BY	
NOTE BOOK NO.	

PROFILE	DATE
SURVEYED	
GRADES CHECKED	
BY	
NOTE BOOK NO.	

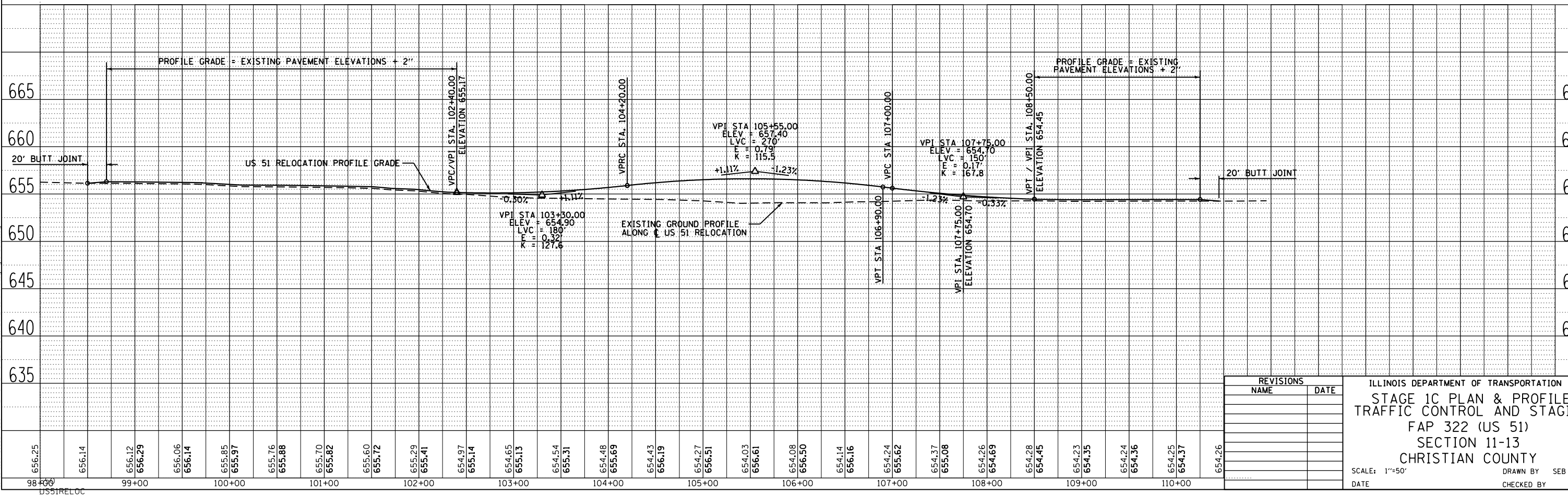

REVISIONS	
NAME	DATE

ILLINOIS DEPARTMENT OF TRANSPORTATION
 STAGE 1C PLAN & PROFILE
 TRAFFIC CONTROL AND STAGING
 FAP 322 (US 51)
 SECTION 11-13
 CHRISTIAN COUNTY
 SCALE: 1"=50'
 DATE: _____ DRAWN BY: SEB
 CHECKED BY: _____

10/9/2012
 G:\Files\010324\South Plans\New\CAD\Sheets\06\2961-sh-staging\5-detailed.dwg