

TR 268 / TR 304 CONNECTOR STRIPING AND SIGNAGE

TR 304 CONNECTOR

F.A.P. RTE.	SECTION	COUNTY	TOTAL SHEETS	SHEET NO.
322	11-13	CHRISTIAN	437	84
STA.		TO STA.		
FED. ROAD DIST. NO.	ILLINOIS	FED. AID PROJECT		

- - INSTALL FOR STAGE 1-B
- REPLACE WITH W2-1(4848)0 ONCE WEST LEG OF TR 268 IS OPEN

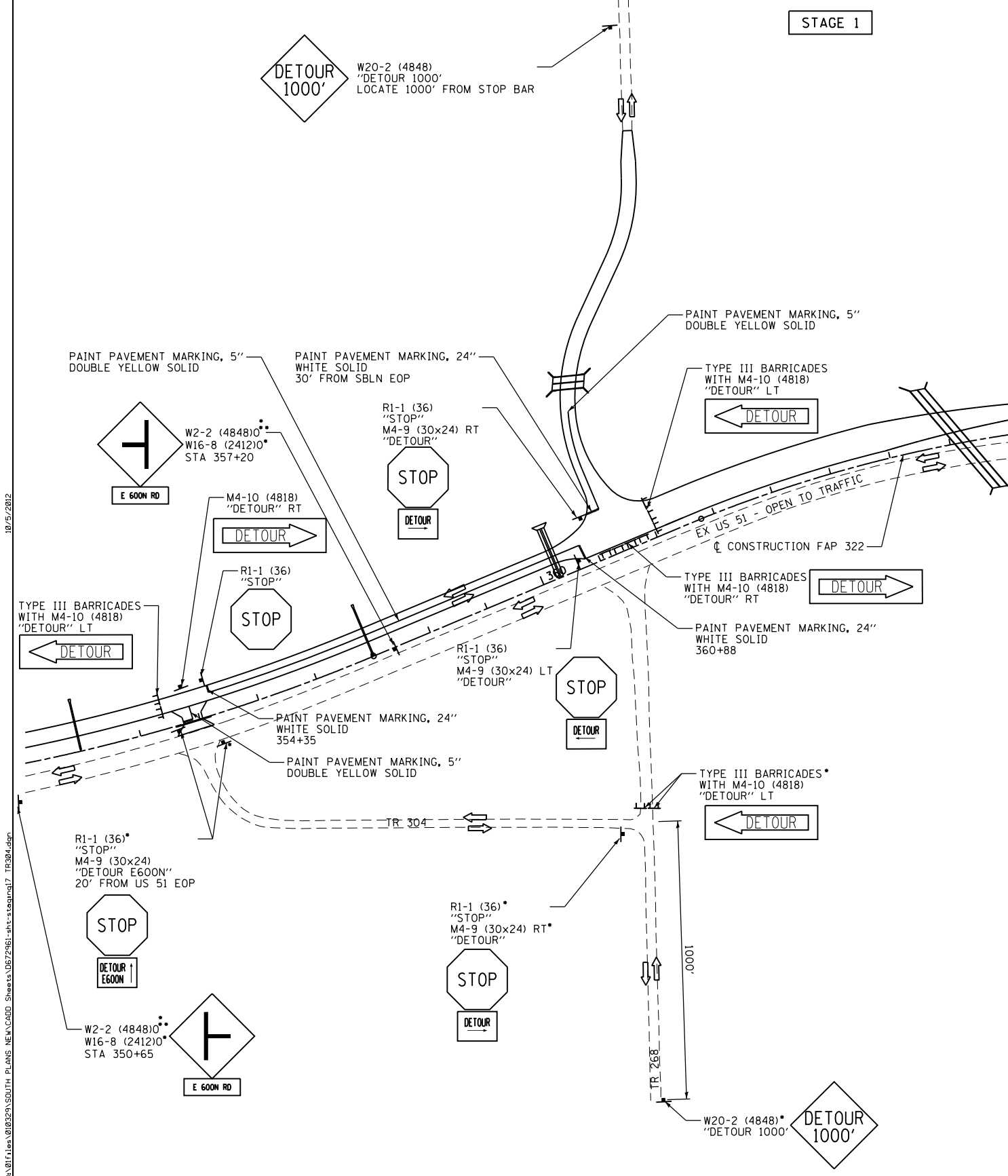

TRAFFIC CONTROL SET UP FOR THIS DETAIL WILL NOT BE MEASURED AND PAID FOR SEPARATELY. THE COST WILL BE CONSIDERED TO BE INCLUDED IN THE CONTRACT UNIT BID PRICES OF THE TRAFFIC CONTROL AND PAY ITEMS INCLUDED IN THE CONTRACT. THE TEMPORARY SIGNS, BARRICADES, AND DRUMS WILL REMAIN THE PROPERTY OF THE CONTRACTOR. TEMPORARY PAVEMENT STRIPING SHALL BE PAID FOR SEPARATELY.

STAGE 2 TRAFFIC CONTROL SHOWN

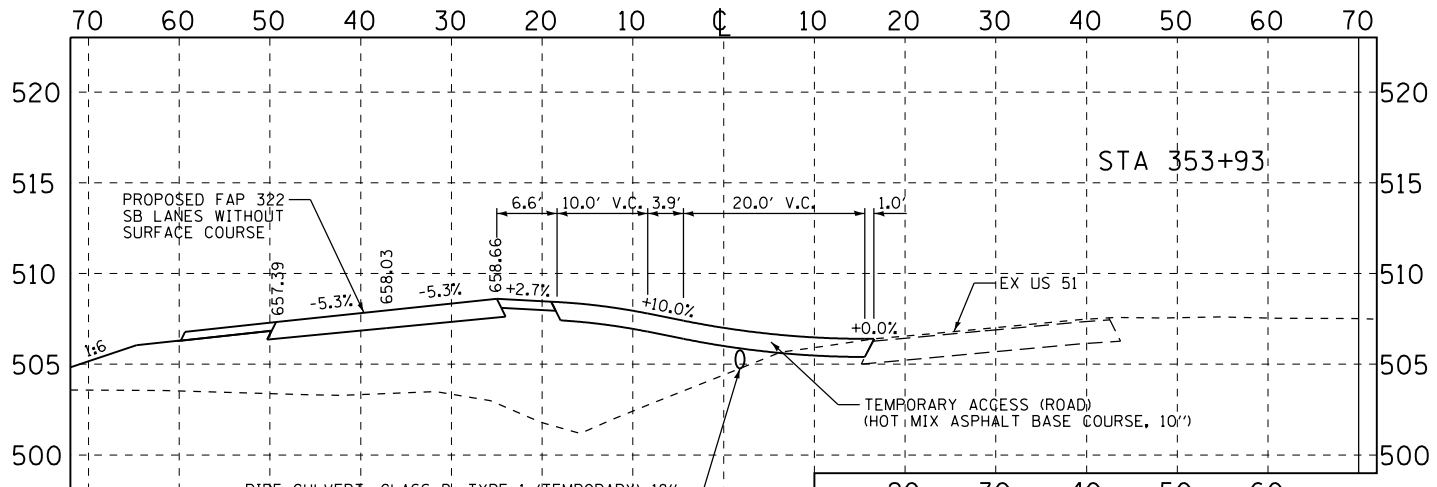
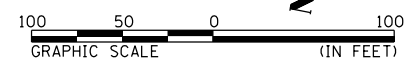
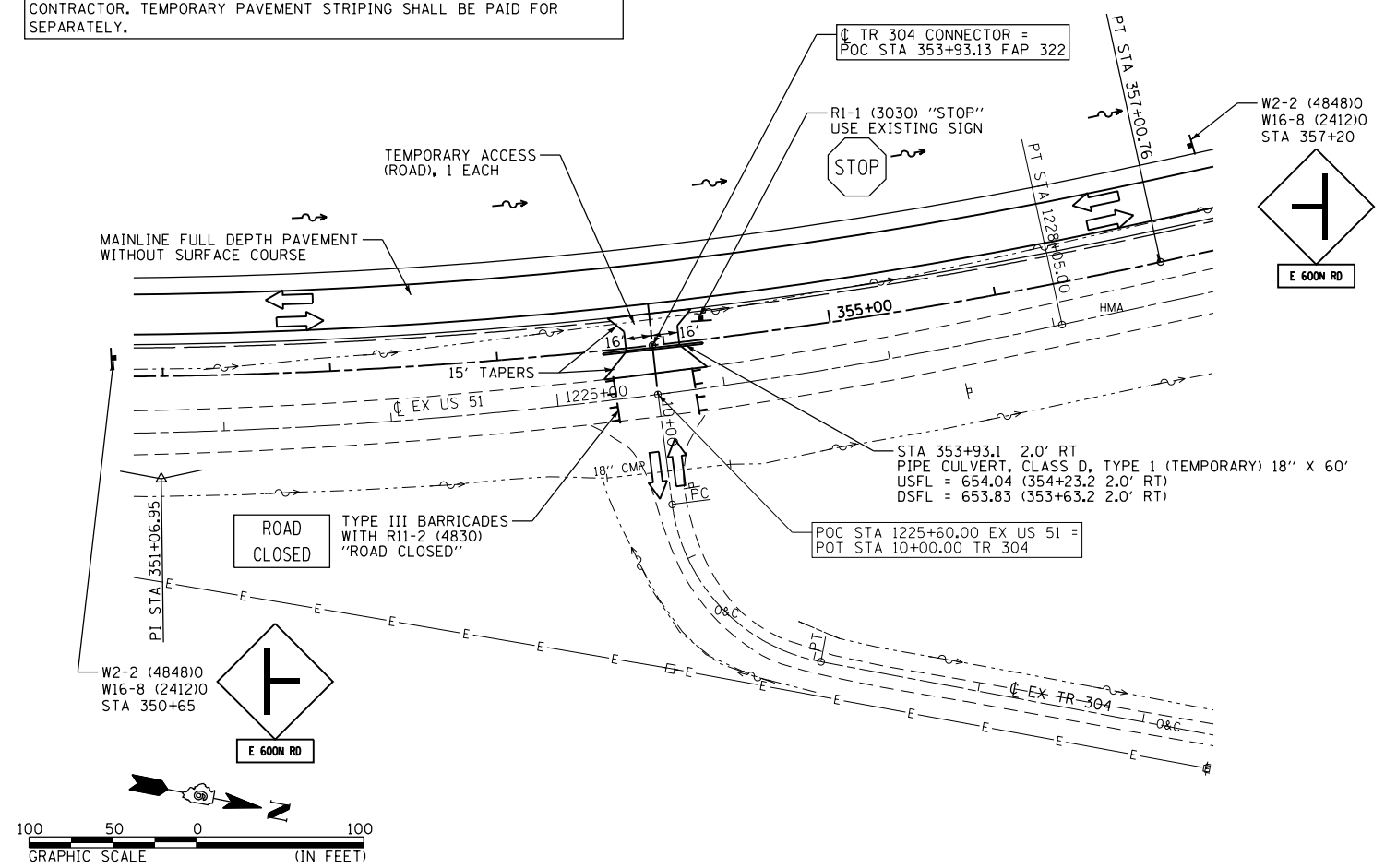

REVISIONS	
NAME	DATE

ILLINOIS DEPARTMENT OF TRANSPORTATION
 TR 268 / TR 304 DETAILS
 TRAFFIC CONTROL AND STAGING
 FAP 322 (US 51)
 SECTION 11-13
 CHRISTIAN COUNTY
 SCALE: VAR.
 DATE: _____
 DRAWN BY: SEB
 CHECKED BY: _____

10/5/2012
 G:\01Files\010325\PLANS\NEW\CA00 - Sheets\06\2961-ans\stage1.dgn TR 304.dgn