

STATE OF ILLINOIS
DEPARTMENT OF TRANSPORTATION

SE 1/4 SEC 35, T12N, R1E, 3RD PM

F.A.P. RTE.	SECTION	COUNTY	TOTAL SHEETS	SHEET NO.
322	11-1	CHRISTIAN	437	122
STA.		TO STA.		
FED. ROAD DIST. NO.		ILLINOIS	FED. AID PROJECT	

PARCEL NO 6069110
 DON E. METSKER &
 MARGARET S. METSKER CO-TRUSTEES
 OF THE DON E. METSKER TRUST AND
 MARGARET S. METSKER AND DON E.
 METSKER CO-TRUSTEES OF THE
 MARGARET S. METSKER TRUST
 SEE TABULATIONS ON SHEET 3

PARCEL NO 6069112
 GERALD D. HANDEGAN JR.
 AND NANCY M. HANDEGAN
 TOTAL AREA = 40.195 ACRES
 REQUIRED ROW AREA = 3.576 ACRES
 EXISTING ROW AREA = 1.968 ACRES
 TOTAL ROW AREA = 5.544 ACRES
 REMAINING AREA = 34.651 ACRES

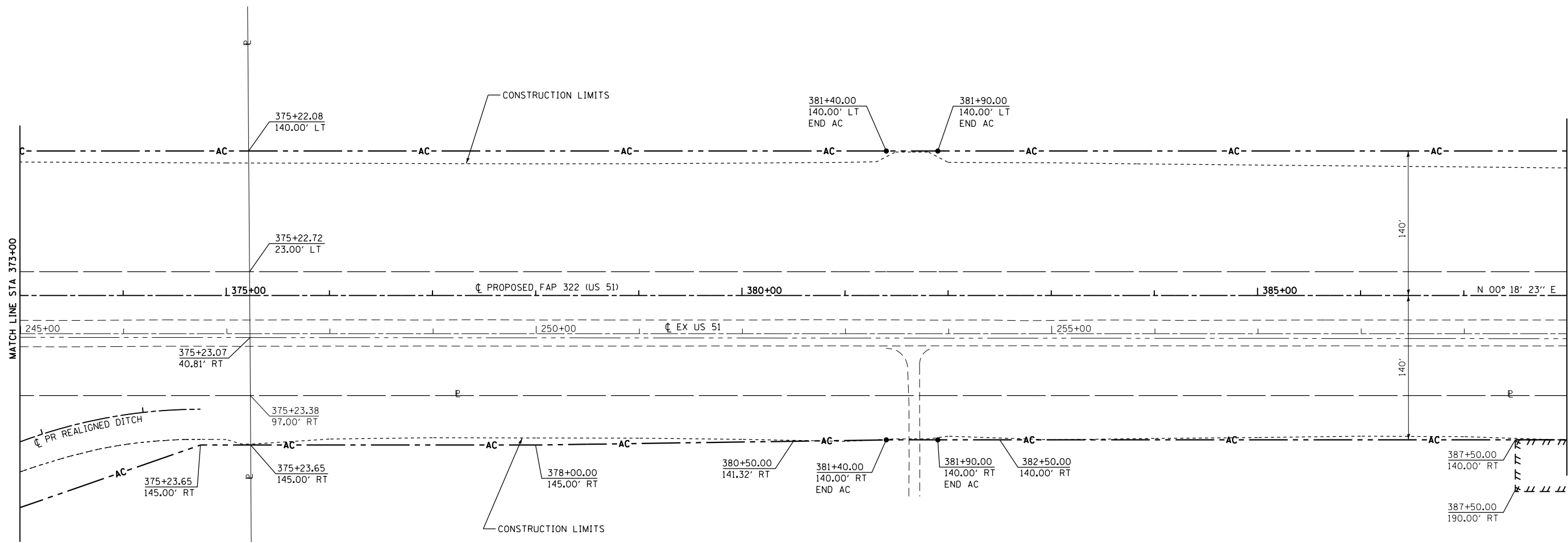

PARCEL NO 6069109 & TE
 LIFE ESTATE IN REX ALLEN DOTY, ET AL
 SEE TABULATIONS ON SHEET 3

PARCEL NO 6069111 & TE
 MUNZ, INC.
 TOTAL AREA = 158.044 ACRES
 REQUIRED ROW AREA = 1.365 ACRES
 EXISTING ROW AREA = 0.000 ACRES
 TOTAL ROW AREA = 1.365 ACRES
 REMAINING AREA = 156.679 ACRES
 TEMPORARY EASEMENT TE = 0.052 ACRES
 T.T. PURPOSE: DITCG GRADING

SW 1/4 SEC 36, T12N, R1E, 3RD PM

NOTES:
 BEARINGS ARE BASED ON THE ILLINOIS STATE PLANE
 COORDINATE SYSTEM, NAD83 1986 - WEST ZONE
 SURVEYED IN ENGLISH.

PLAT DISTANCES AND STATIONING ARE IN GRID ENGLISH.
 TO CONVERT TO GROUND DIVIDE BY GRID FACTOR.
 GRID FACTOR = 1.00003150

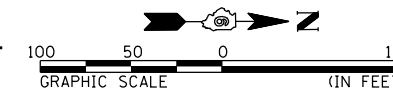

RIGHT OF WAY PLANS

ROUTE F.A.P. 322 (US 51)
 SECTION 11-1
 PROJECT
 COUNTY CHRISTIAN
 JOB NO. R-96-008-95
 STA 373+00 TO STA 388+00
 SCALE 1" = 50'

4/4/13 PM 10/5/2012 G:\01\res\010329\1 SOUTH NEW VACDD Sheets\05\2961-sh-rd\p1.dwg