

F.A.P. RTE.	SECTION	COUNTY	TOTAL SHEETS	SHEET NO.
322	11-13	CHRISTIAN	437	159
STA.		TO STA.		
FED. ROAD DIST. NO.		ILLINOIS FED. AID PROJECT		

10/5/2012  
D:\01\11es\010329\1 SOUTH PLANS NEW\CA00 Sheets\06\2961-shr-signing-str-11-13.dwg

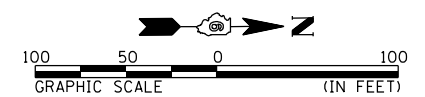
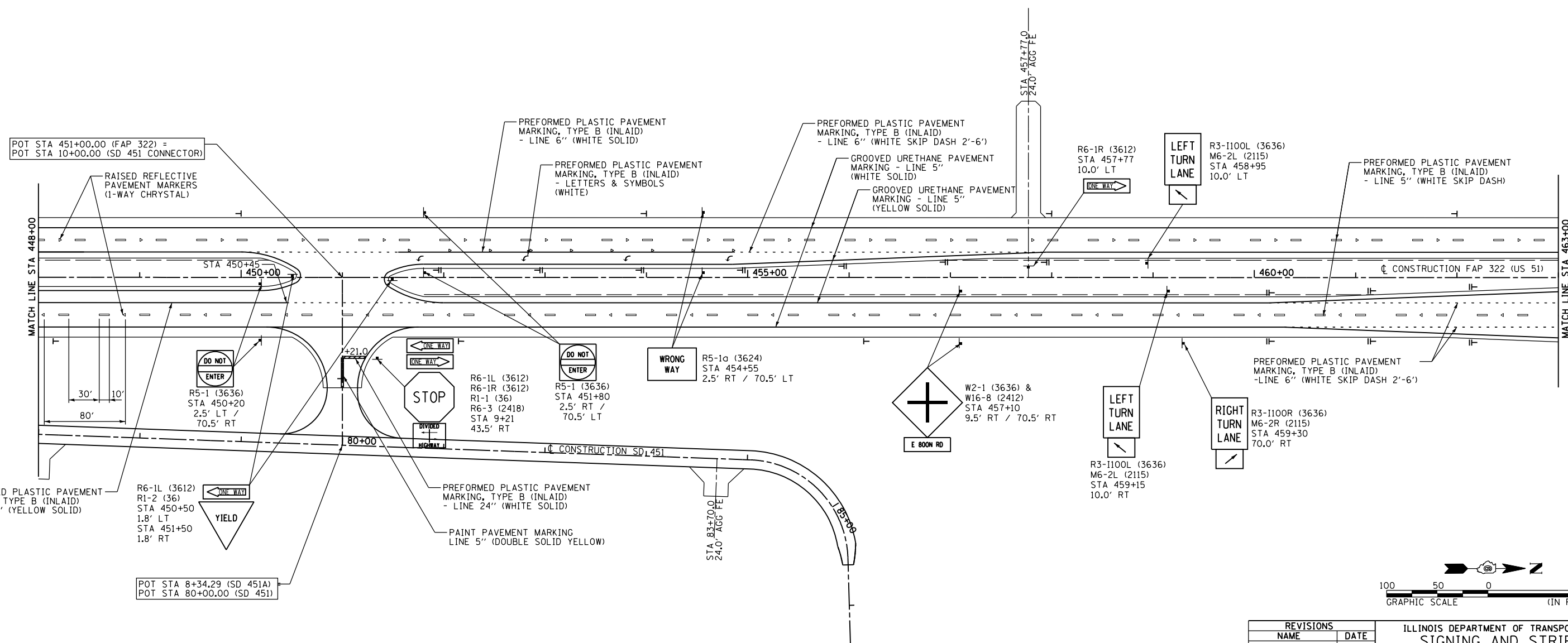

**DELINEATOR SYMBOLS:**  
 I - SINGLE  
 II - DOUBLE  
 LOCATE 4' OFF EDGE OF PAVED SHOULDER. SEE STANDARD 635001 FOR SPACING.

REVISIONS	
NAME	DATE

ILLINOIS DEPARTMENT OF TRANSPORTATION  
**SIGNING AND STRIPING PLAN**  
 FAP 322 (US 51)  
 SECTION 11-13  
 CHRISTIAN COUNTY  
 SCALE: 1"=50'  
 DATE: \_\_\_\_\_ DRAWN BY SEB  
 CHECKED BY \_\_\_\_\_  
 FAP 322 (US 51) STA 448+00 TO STA 463+00