

Notes:
 See sheet 9 of 16 for Sections B-B & C-C.
 See sheet 7 of 16 for Railing and Railing Connection details.
 Anchor assembly in approach slab is included with the cost of Steel Railing, Type SM.
 $a_1(E)$ and $a_2(E)$ bar spacings measured along ϕ Rdwy.

*** Cost included with Concrete Superstructure.

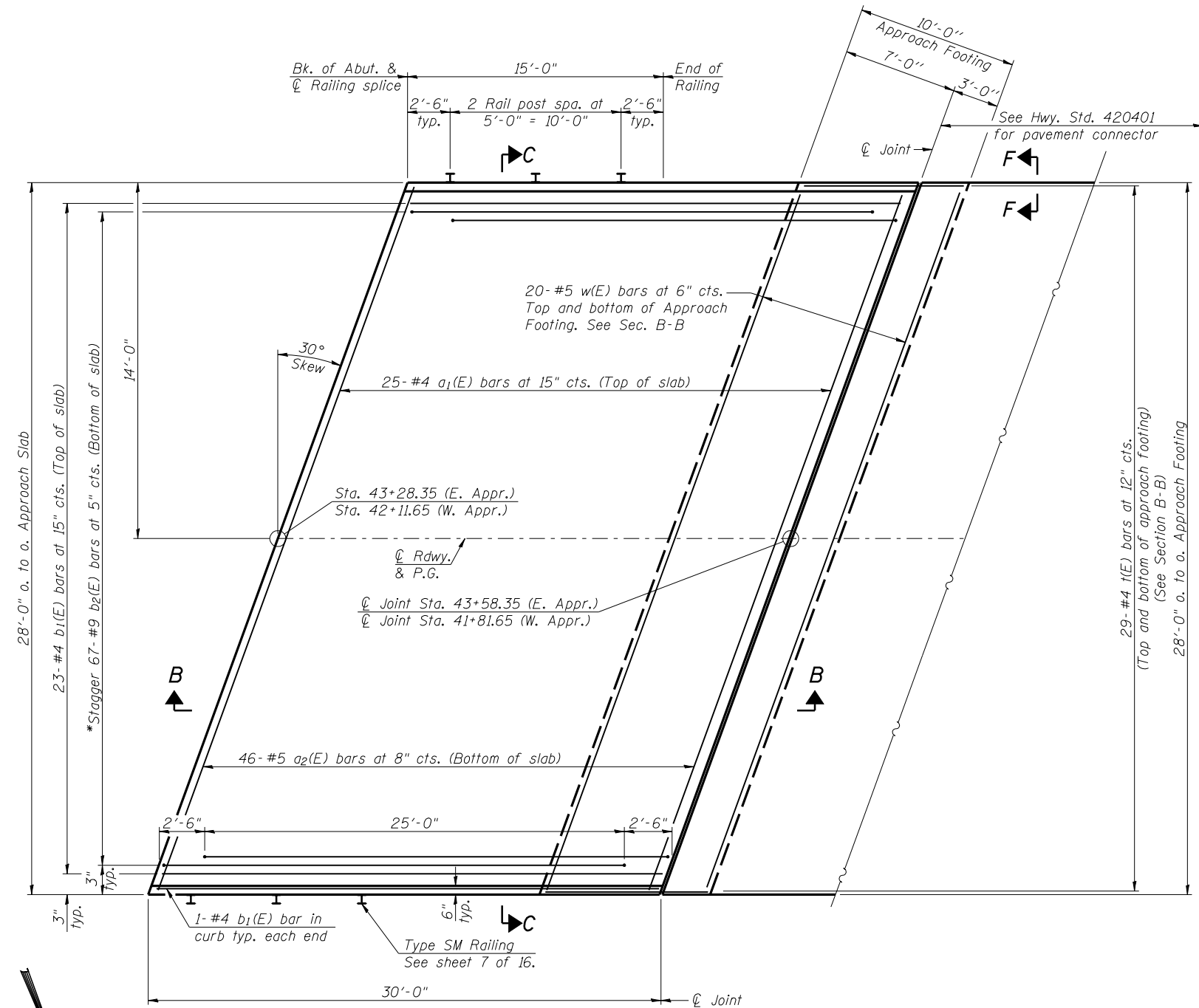

PLAN

* Tilt #9 $b_2(E)$ bars as required to maintain clearance.

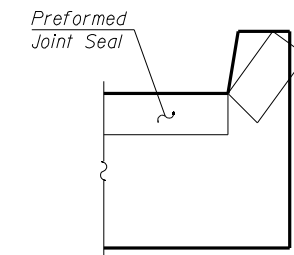
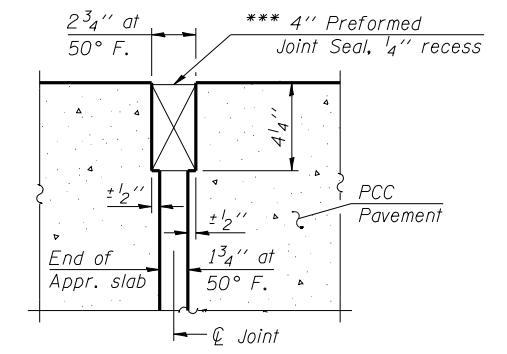

Angle Preformed Joint Seal at 45° at curbs when req'd for drainage.

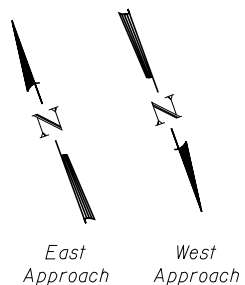
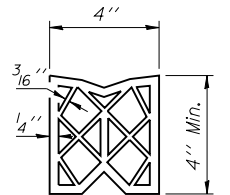

(Sheet 1 of 2)



USER NAME =	DESIGNED - MTH	REVISED -
FILE NAME =	CHECKED - TBP	REVISED -
PLOT SCALE =	DRAWN - AJF	REVISED -
PLOT DATE =	CHECKED - MTH	REVISED -

STATE OF ILLINOIS
 DEPARTMENT OF TRANSPORTATION

BRIDGE APPROACH SLAB DETAILS
 STRUCTURE NO. 011-3362

SHEET NO. 8 OF 16 SHEETS

F.A.P. RTE.	SECTION	COUNTY	TOTAL SHEETS	SHEET NO.
322	11-13	CHRISTIAN	437	242
CONTRACT NO. 72961				

ILLINOIS FED. AID PROJECT