

F.A.P. RTE.	SECTION	COUNTY	TOTAL SHEETS	SHEET NO.
322	11-13	CHRISTIAN	437	276
STA.	TO STA.			
FED. ROAD DIST. NO.	ILLINOIS	FED. AID PROJECT		

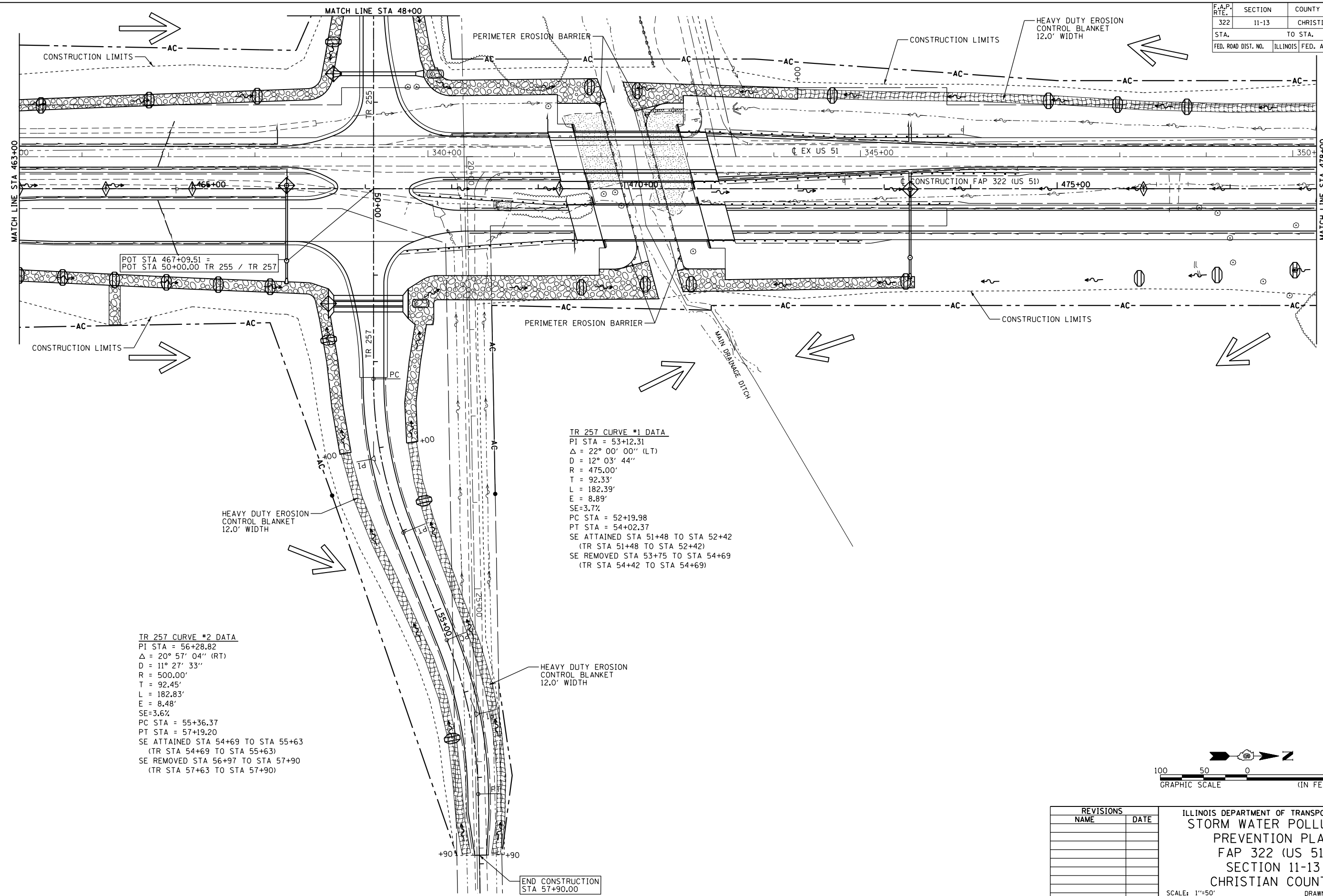

TR 257 CURVE #1 DATA
 PI STA = 53+12.31
 $\Delta = 22^\circ 00' 00''$ (LT)
 $D = 12^\circ 03' 44''$
 $R = 475.00'$
 $T = 92.33'$
 $L = 182.39'$
 $E = 8.89'$
 $SE = 3.7\%$
 PC STA = 52+19.98
 PT STA = 54+02.37
 SE ATTAINED STA 51+48 TO STA 52+42
 (TR STA 51+48 TO STA 52+42)
 SE REMOVED STA 53+75 TO STA 54+69
 (TR STA 54+42 TO STA 54+69)

TR 257 CURVE #2 DATA
 PI STA = 56+28.82
 $\Delta = 20^\circ 57' 04''$ (RT)
 $D = 11^\circ 27' 33''$
 $R = 500.00'$
 $T = 92.45'$
 $L = 182.83'$
 $E = 8.48'$
 $SE = 3.6\%$
 PC STA = 55+36.37
 PT STA = 57+19.20
 SE ATTAINED STA 54+69 TO STA 55+63
 (TR STA 54+69 TO STA 55+63)
 SE REMOVED STA 56+97 TO STA 57+90
 (TR STA 57+63 TO STA 57+90)

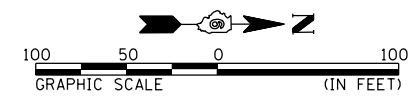

REVISIONS	
NAME	DATE

ILLINOIS DEPARTMENT OF TRANSPORTATION
 STORM WATER POLLUTION
 PREVENTION PLAN
 FAP 322 (US 51)
 SECTION 11-13
 CHRISTIAN COUNTY
 SCALE: 1"=50'
 DATE: _____ DRAWN BY: SEB
 CHECKED BY: _____

END CONSTRUCTION
 STA 57+90.00

10/5/2012
 G:\01\res\010325\1\SO\TH PLANS NEW\CA00 - Sheets\06\2\061-sh1-erosion_control\14.dgn