

DATE	
BY	
FINAL SURVEY	
SURVEYED	
PLOTTED	
TEMPLATE	
NOTE BOOK	
AREAS CHECKED	
NO.	

DATE	
BY	
ORIGINAL SURVEY	
SURVEYED	
PLOTTED	
TEMPLATE	
NOTE BOOK	
AREAS CHECKED	
NO.	

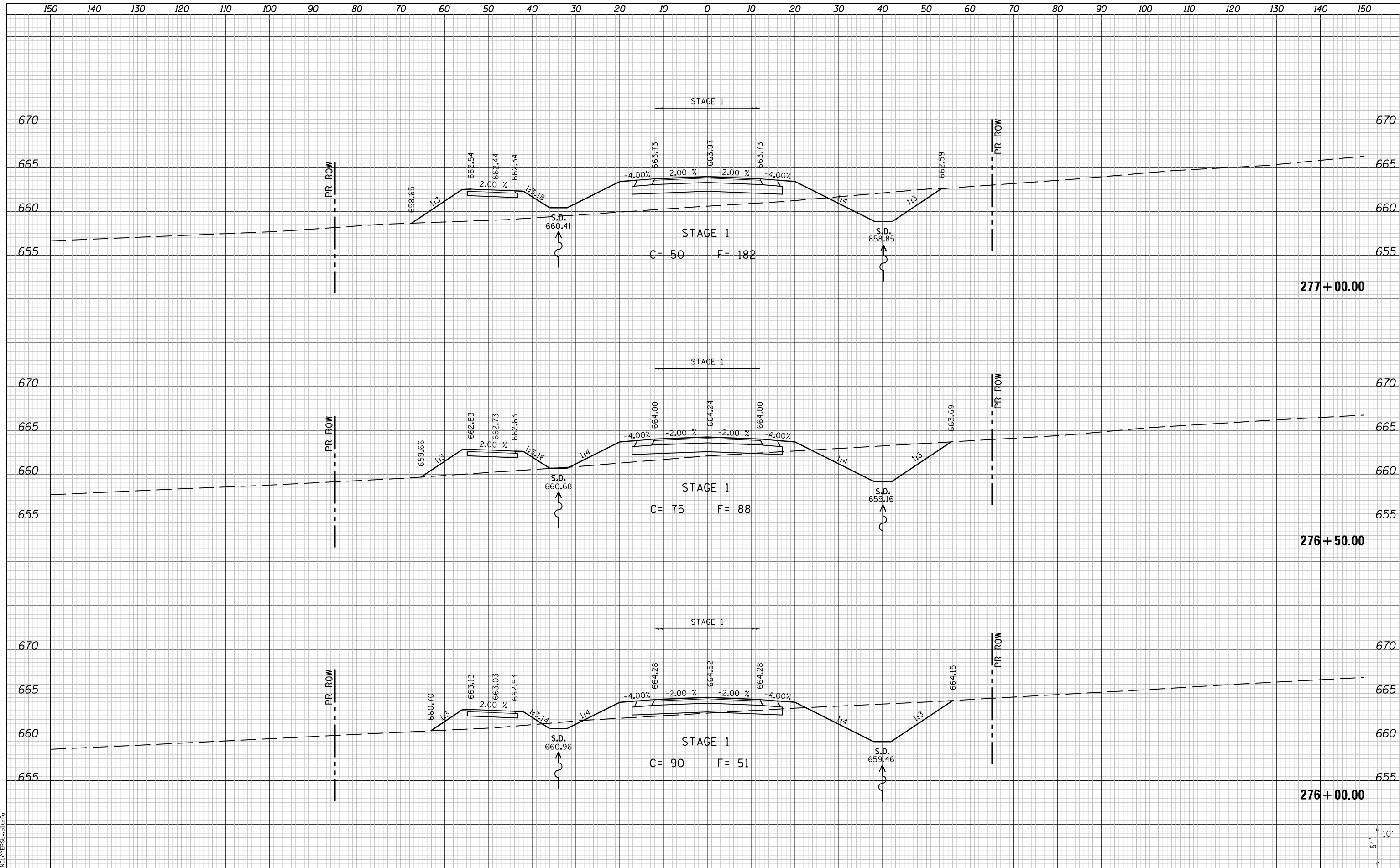

LAST SAVED = 10/3/2012  
 PEN TABLE = VBI-H&I.rdl  
 PLOT DRIVER = PdfPlotterSpw.bat

FILE NAME =	USER NAME = jepettibone	DESIGNED -	REVISED -
I:\10011001\Phase II - 76F51\Cad\T\Plans\100.0876F51-sht-Relocated.Vandebrook-Dr-xssht.dgn		DRAWN -	REVISED -
		CHECKED -	REVISED -
		DATE -	REVISED -
PLOT SCALE = 20.0000' / in.			
PLOT DATE = 10/4/2012 5:11:44 PM			

STATE OF ILLINOIS  
 DEPARTMENT OF TRANSPORTATION



CROSS SECTIONS  
 RELOCATED VANDEBROOK DRIVE  
 SCALE: 10H:5V  
 SHEET NO. 9 OF 31 SHEETS  
 STA. 276+00.00 TO STA. 277+00.00

F.A.U. RTE.	SECTION	COUNTY	TOTAL SHEETS	SHEET NO.
9324	68-R-1	MONROE	192	118
				CONTRACT NO. 76F51
ILLINOIS FED. AID PROJECT				