

DATE	
BY	
FINAL SURVEY	
SURVEYED	
PLOTTED	
TEMPLATE	
AREAS	
CHECKED	
NO.	

DATE	
BY	
ORIGINAL SURVEY	
SURVEYED	
PLOTTED	
TEMPLATE	
AREAS	
CHECKED	
NO.	

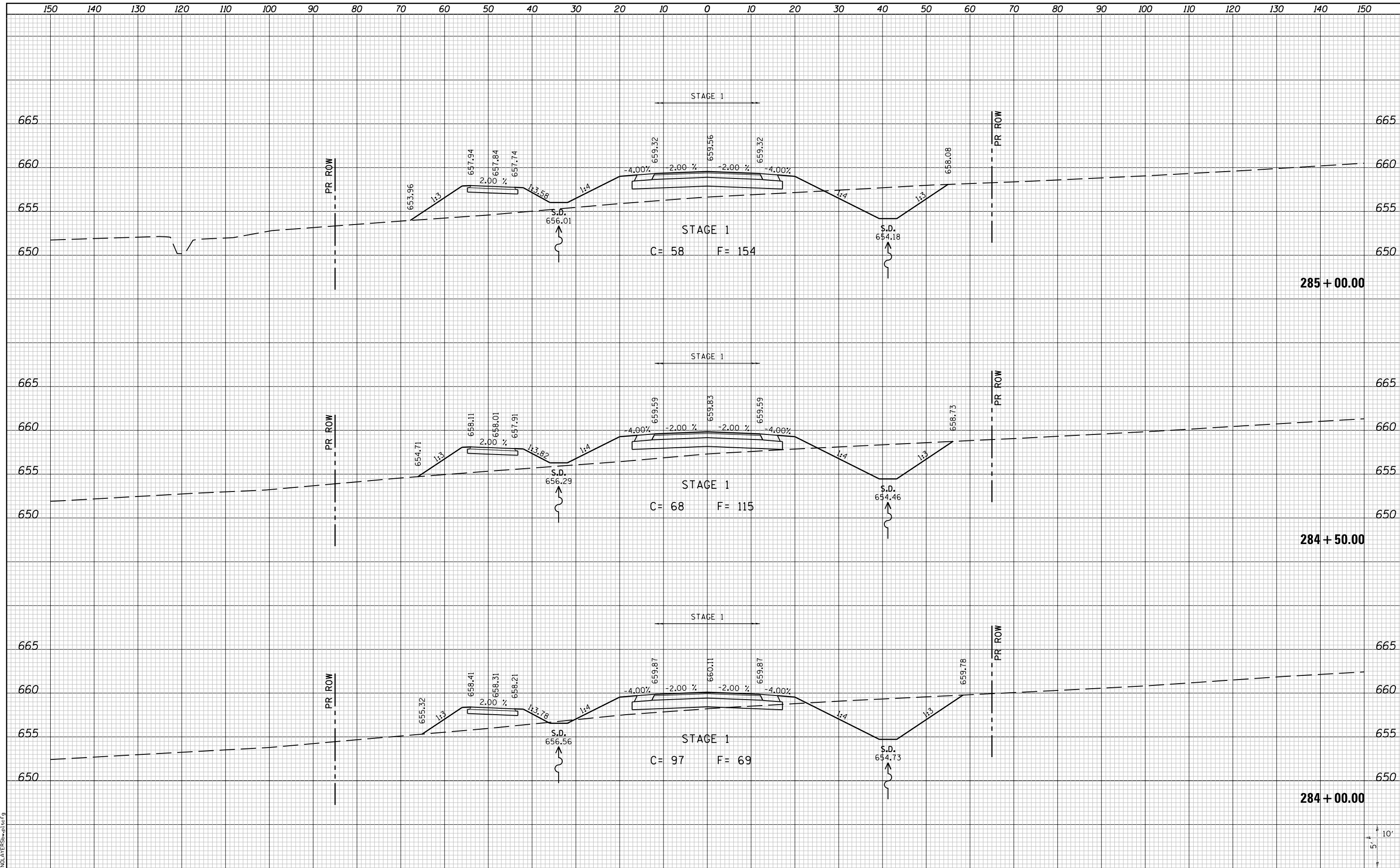

LAST SAVED = 10/3/2012
 PEN TABLE = VBI-Half.tbl
 PLOT DRIVER = PdfPlotterSpw.bat

FILE NAME = I:\10011001\Phase II - 76F51\Cad\T\Plans\100.0876F51-shr-Relocated_Vandebrook_Dr-xssht.dgn	USER NAME = jepettibone	DESIGNED -	REVISIED -	STATE OF ILLINOIS DEPARTMENT OF TRANSPORTATION		CROSS SECTIONS RELOCATED VANDEBROOK DRIVE		F.A.U. RTE. 9324	SECTION 68-R-1	COUNTY MONROE	TOTAL SHEETS 192	SHEET NO. 125
PLOT SCALE = 20.0000' / in.	CHECKED -	REVISIED -	CONTRACT NO. 76F51									
PLOT DATE = 10/4/2012 5:11:50 PM	DATE -	REVISIED -	ILLINOIS FED. AID PROJECT									
			SCALE: 10H:5V					SHEET NO. 16 OF 31 SHEETS	STA. 284+00.00 TO STA. 285+00.00			