

DATE	
BY	
FINAL SURVEY	
SURVEYED	
PLOTTED	
TEMPLATE	
NOTE BOOK	
AREAS	
CHECKED	
NO.	

DATE	
BY	
ORIGINAL SURVEY	
SURVEYED	
PLOTTED	
TEMPLATE	
NOTE BOOK	
AREAS	
CHECKED	
NO.	

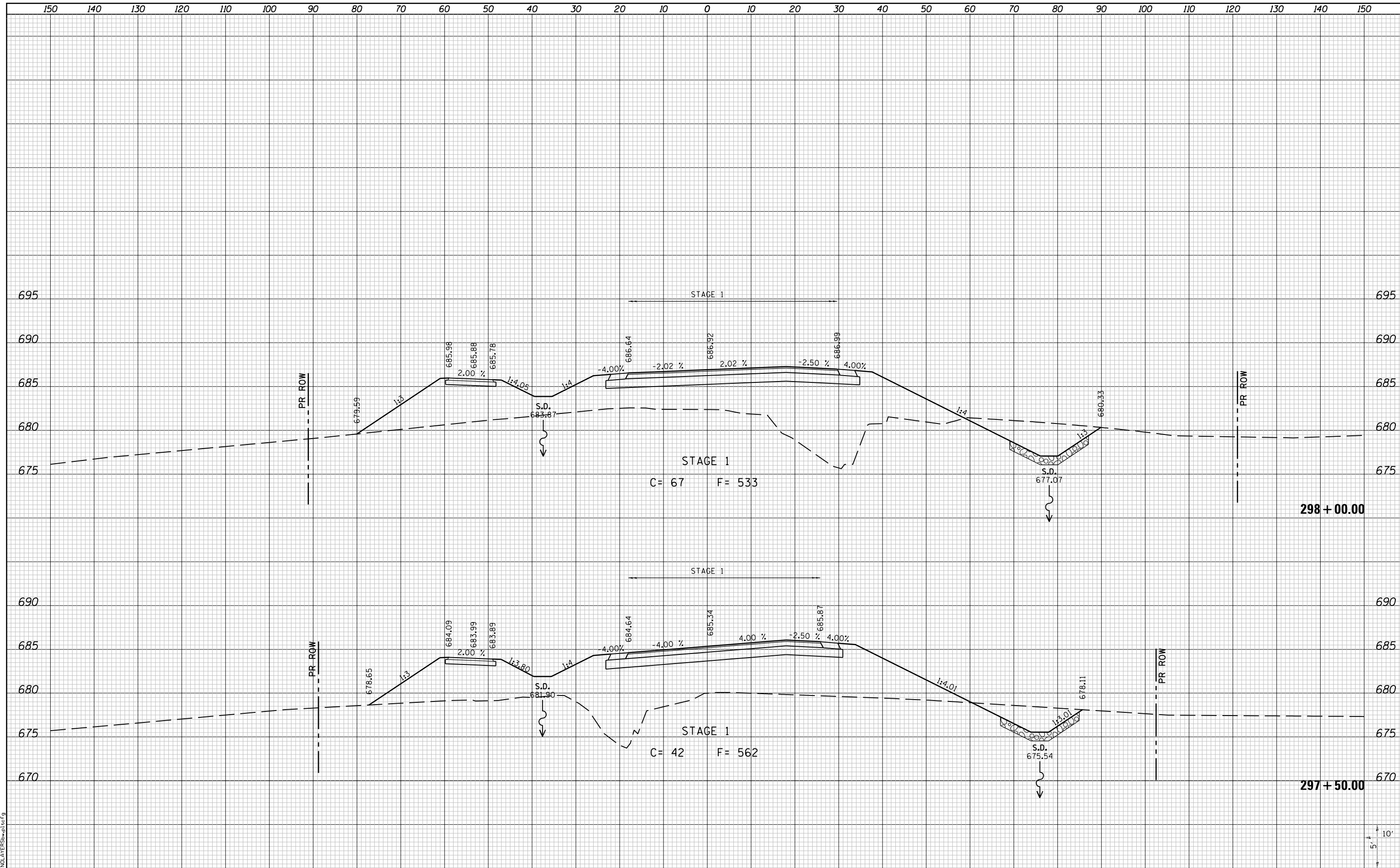

LAST SAVED = 10/3/2012
 PEN TABLE = 181-Half.tbl
 PLOT DRIVER = PdfPlotterSpwtbf9

FILE NAME = I:\1001100\Phase II - 76F51\Cad\T\Plans\100.0876F51-sht-Relocated.Vandebrook-Dr-xssht.dgn	USER NAME = jepettibone	DESIGNED -	REVISED -
PLOT SCALE = 20.0000' / in.	PLOT DATE = 10/4/2012 5:12:01 PM	DRAWN -	REVISED -
		CHECKED -	REVISED -
		DATE -	REVISED -

**STATE OF ILLINOIS
DEPARTMENT OF TRANSPORTATION**



CROSS SECTIONS
RELOCATED VANDEBROOK DRIVE

SCALE: 10H:5V SHEET NO. 29 OF 31 SHEETS STA. 297+50.00 TO STA. 298+00.00

F.A.U. RTE.	SECTION	COUNTY	TOTAL SHEETS	SHEET NO.
9324	68-R-1	MONROE	192	138
CONTRACT NO. 76F51			ILLINOIS FED. AID PROJECT	