

DATE	
BY	
SURVEYED	
PLOTTED	
TEMPLATE	
AREAS	
CHECKED	
FINAL SURVEY	
NOTE BOOK	
NO.	

DATE	
BY	
SURVEYED	
PLOTTED	
TEMPLATE	
AREAS	
CHECKED	
ORIGINAL SURVEY	
NOTE BOOK	
NO.	

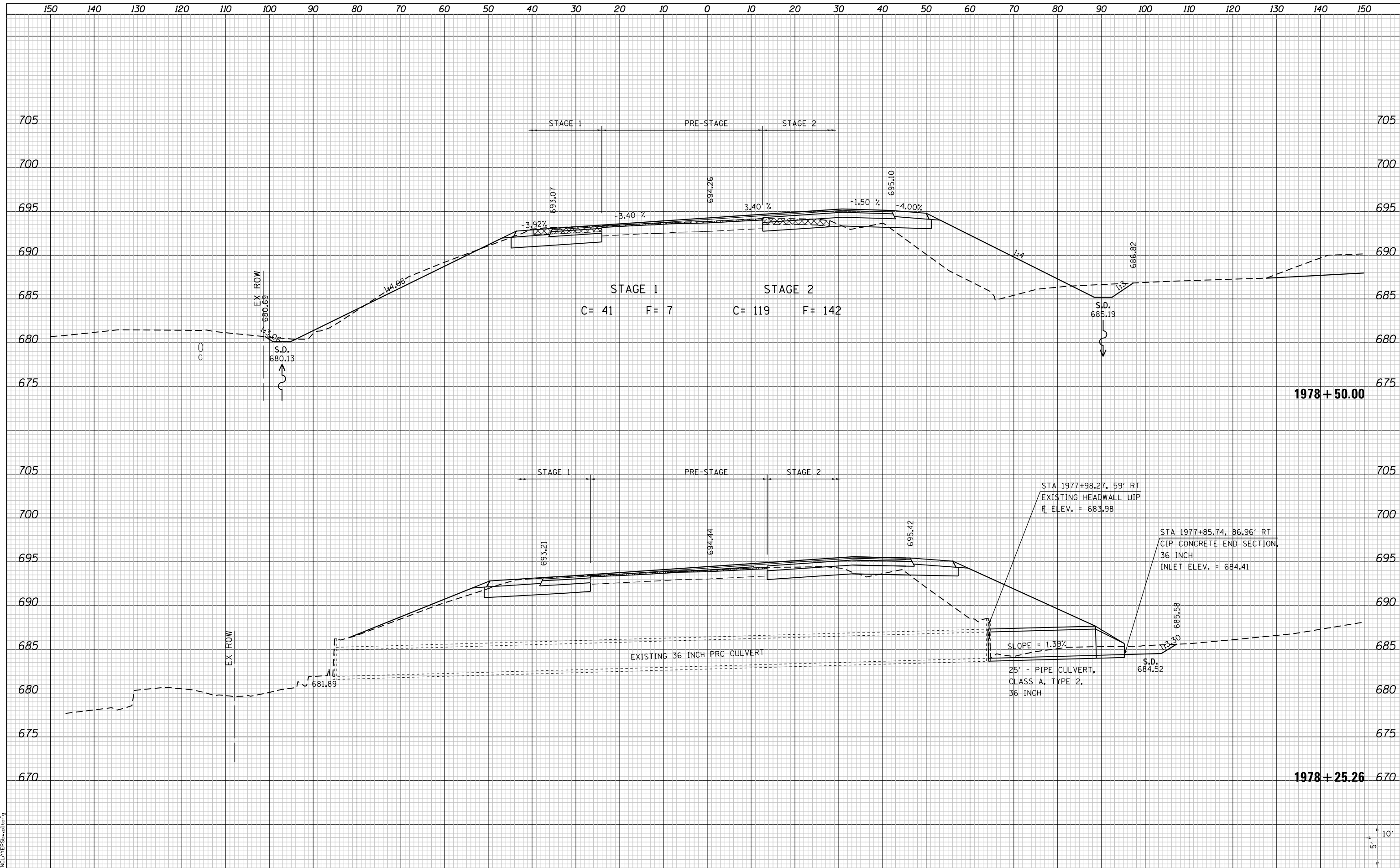

LAST SAVED = 10/18/2012
 PEN TABLE = 161-hat.tbl
 PLOT DRIVER = PdfPlotterSpwt.ctb

FILE NAME =	USER NAME = jepettibone	DESIGNED -	REVISED -
I:\10011001_Phase II - 76F5\IN\Cad\T\Plans\105.0876F51-sh1-1L3-xssh.t.dgn		DRAWN -	REVISED -
PLOT SCALE = 20.0000' / in.		CHECKED -	REVISED -
PLOT DATE = 10/18/2012 2:46:26 PM		DATE -	REVISED -

STATE OF ILLINOIS
 DEPARTMENT OF TRANSPORTATION



CROSS SECTIONS
 IL ROUTE 3
 SCALE: 10H:5V
 SHEET NO. 13 OF 30 SHEETS
 STA. 1978+25.26 TO STA. 1978+50.00

F.A.U. RTE.	SECTION	COUNTY	TOTAL SHEETS	SHEET NO.
9234	68-R-1	MONROE	192	165
				CONTRACT NO. 76F51
ILLINOIS FED. AID PROJECT				