

**CONCRETE REPLACEMENT**  
(W. Abut.)

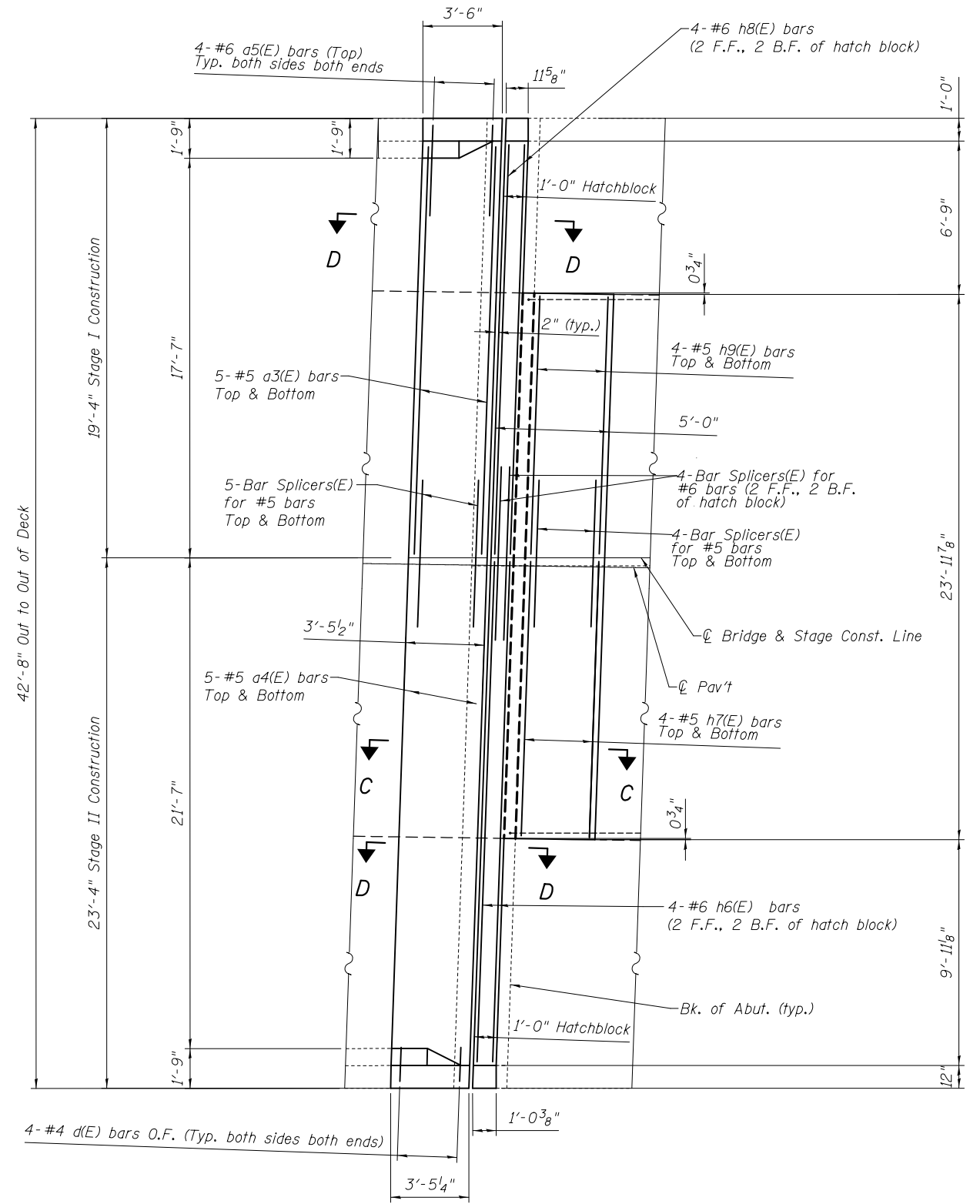

**CONCRETE REPLACEMENT**  
(E. Abut.)

Note:  
Existing reinforcement bars extending into removal area shall be cleaned, straightened and incorporated into the new construction. Any reinforcement bars that are damaged during concrete removal shall be replaced with an approved bar splicer or anchorage system. Cost included with Concrete Removal.  
See sheet 8 of 16 for Section C-C & D-D.

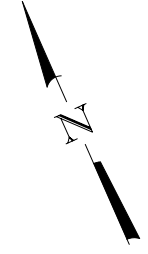

DESIGNED - AYV	EXAMINED	DATE -
CHECKED -	ENGINEER OF STRUCTURAL SERVICES	
DRAWN - AYV	PASSED	REVISED
CHECKED -	ENGINEER OF BRIDGES AND STRUCTURES	REVISED

**STATE OF ILLINOIS**  
**DEPARTMENT OF TRANSPORTATION**

**JOINT REPLACEMENT (EB)**  
**SN 060-0192**

SHEET NO. 7 OF 16 SHEETS

F.A.P. RTE.	SECTION	COUNTY	TOTAL SHEETS	SHEET NO.
789	125-1HB-1	MADISON		
CONTRACT NO. 76F54				
ILLINOIS FED. AID PROJECT				