

**REMOVAL LEGEND**

	PAVEMENT REMOVAL		RELOCATE EXISTING MAILBOX
	HOT-MIX ASPHALT SURFACE REMOVAL-BUTT JOINT		TREE REMOVAL
	DRIVEWAY PAVEMENT REMOVAL		TREE REMOVAL, ACRES
	SIDEWALK REMOVAL		COMBINATION CURB AND GUTTER REMOVAL

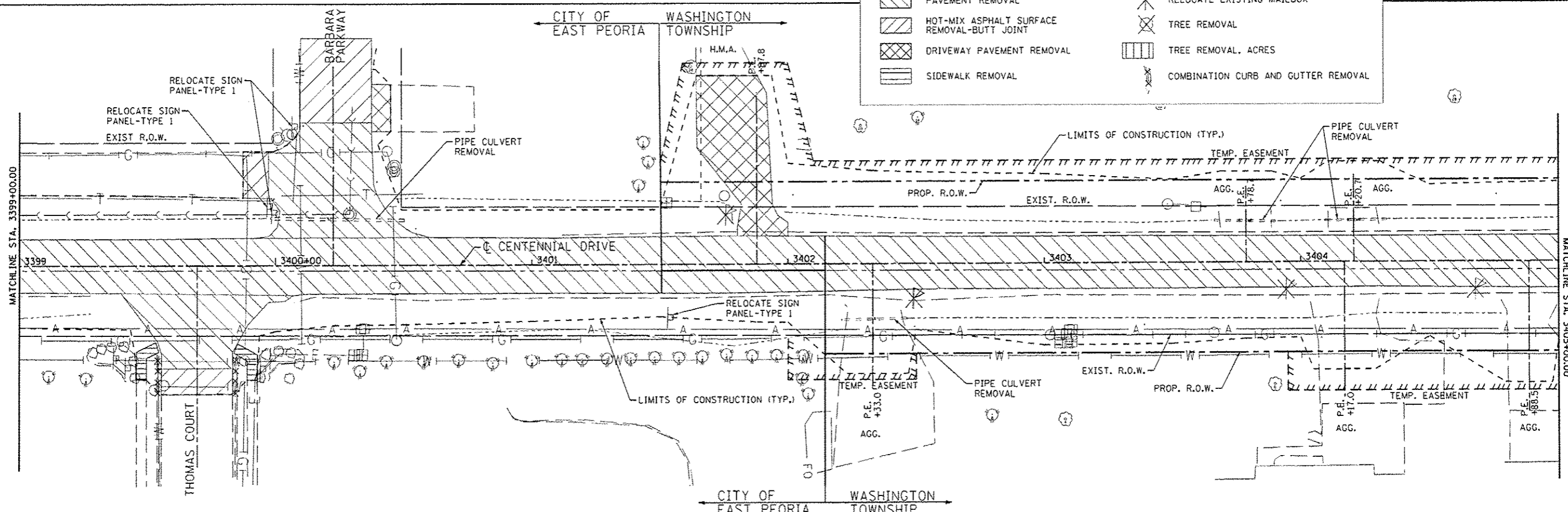
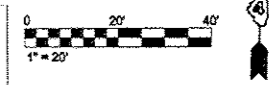

FILE NAME	USER NAME	DESIGNED	REVISED	<b>CITY OF EAST PEORIA WASHINGTON TOWNSHIP</b>	<b>CENTENNIAL DRIVE - PHASE V (GRANGE RD TO SPRING CREEK RD) REMOVAL PLAN</b>	F.A.U. RTE.	SECTION	COUNTY	TOTAL SHEETS	SHEET NO.	
		DRAWN	REVISED			6745	07-00069-00-WR	TAZEWELL	98	16	
		CHECKED	REVISED			CONTRACT NO. 89492					
		DATE	REVISED			ILLINOIS FED. AID PROJECT					
MAURER-STUTZ ENGINEERS SURVEYORS						SCALE: 1"=20'		SHEET 2 OF 5 SHEETS		STA. 3393+00.00 TO STA. 3405+00.00	