

•MUST INSTALL STRUCTURES 1-4 AND PIPES A-C PRIOR TO ROAD CLOSURE.  
 •STRUCTUE 3 SHOULD BE PLATED WITH HMA PATCH DURING STAGE 1

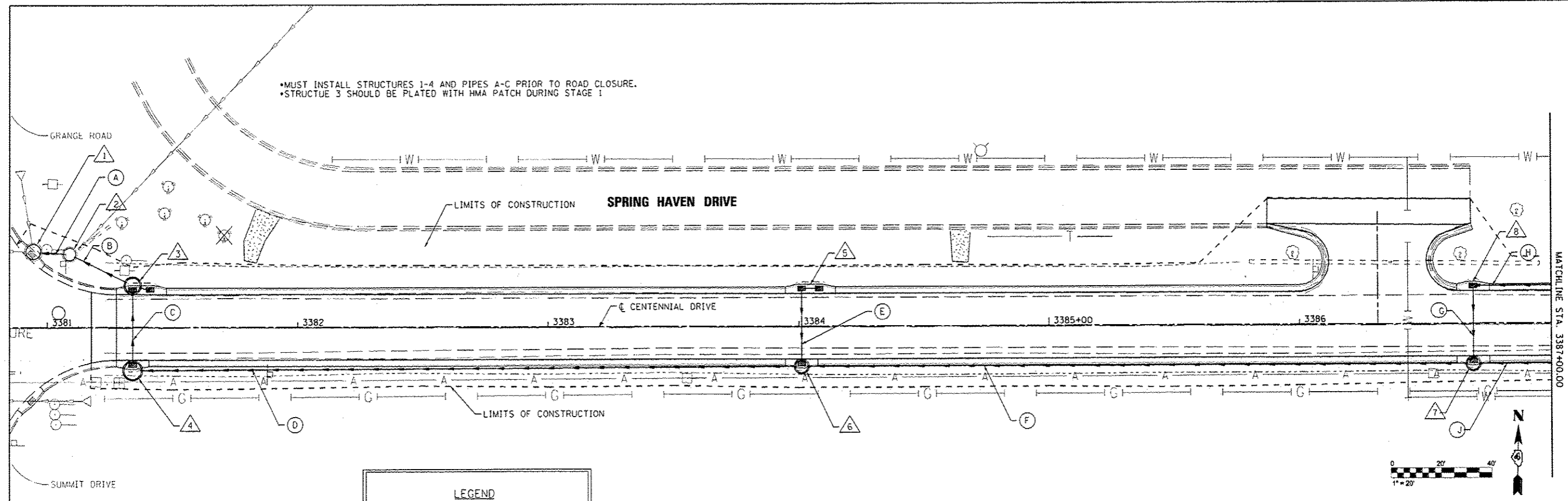

**LEGEND**

△ STRUCTURE NUMBER

○ PIPE NUMBER

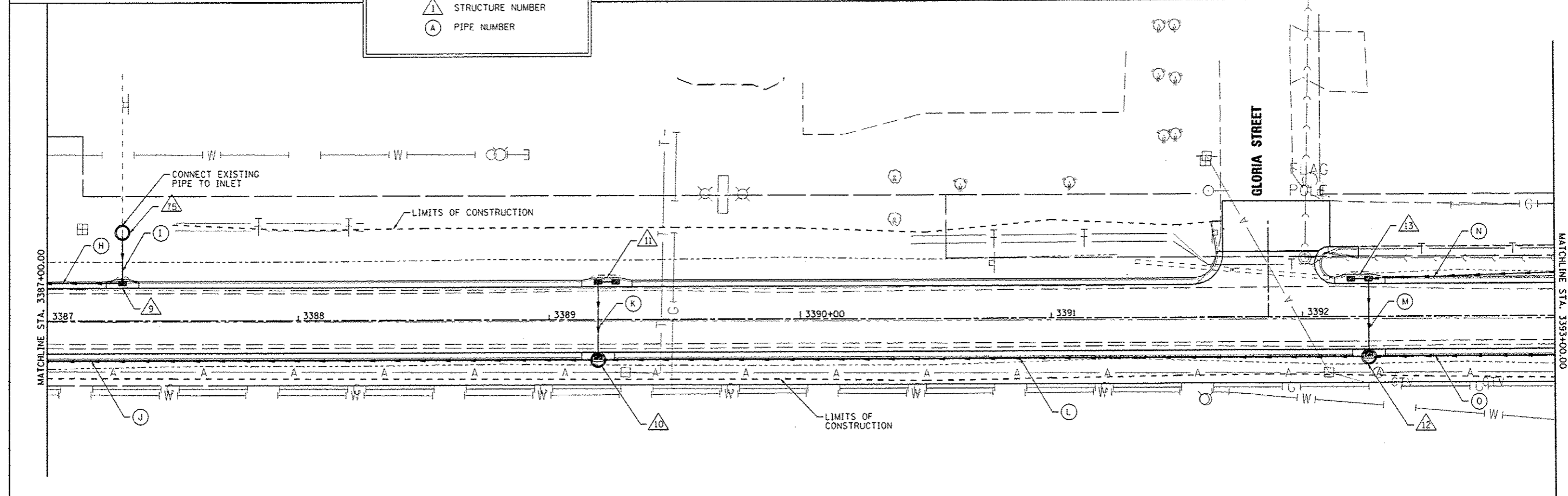
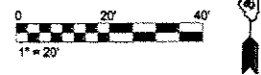

FILE NAME: \\237\2089\23789286\CentennialDrivePhaseV\PHVCADD\CADD Sheets\0489492-sh.drain.dwg <b>MAURER-STUTZ</b> ENGINEERS SURVEYORS	USER NAME: wllows DRAWN: PHVCADD\CADD Sheets\0489492-sh.drain.dwg PLOT SCALE: 40.8960 / IN. PLOT DATE: 11/26/2012	DESIGNED: - CHECKED: - DATE: -	REVISED: - RJA 11/28/12 REVISED: - REVISED: - REVISED: -	<b>CITY OF EAST PEORIA          WASHINGTON TOWNSHIP</b>	<b>CENTENNIAL DRIVE - PHASE V (GRANGE RD TO SPRING CREEK RD)          STORM DRAINAGE</b>		F.A.U. RTE.: 6745 SECTION: 07-00069-00-WR COUNTY: TAZEWELL CONTRACT NO.: 89492	TOTAL SHEETS: 98 SHEET NO.: 41
	SCALE: SHEET OF SHEETS STA. TO STA.				ILLINOIS FED. AID PROJECT			