

STATE OF ILLINOIS  
DEPARTMENT OF TRANSPORTATION  
DIVISION OF HIGHWAYS

CONTRACT NO.	SECTION	COUNTY	TOTAL SHEETS	SHEET NO.
89585	*	MARSHALL COUNTY	16	1
SECTION 10-00001-00-SW		ILLINOIS		

INDEX OF SHEETS

- COVER SHEET, INDEX OF SHEETS & HIGHWAY STANDARDS
- GENERAL NOTES
- SUMMARY OF QUANTITIES
- SCHEDULE OF QUANTITIES
- SHEET INDEX MAP
- 15. SIDEWALK/CROSSWALK PLAN SHEETS
- DETAILS

HIGHWAY STANDARDS

- 000001-06 STANDARD SYMBOLS, ABBREVIATIONS AND PATTERNS
- 424006-01 DIAGONAL CURB RAMPS FOR SIDEWALKS
- 424011-01 CORNER PARALLEL CURB RAMPS FOR SIDEWALKS
- 424016-01 MID-BLOCK CURB RAMPS FOR SIDEWALKS
- 424021-01 DEPRESSED CORNER FOR SIDEWALKS
- 424026-01 ENTRANCE / ALLEY PEDESTRIAN CROSSINGS
- 606001-05 CONCRETE CURB TYPE B AND COMBINATION CONCRETE CURB AND CUTTER
- 701301-04 LANE CLOSURE, 2L, 2W, SHORT TIME OPERATIONS
- 701501-06 URBAN LANE CLOSURE, 2L, 2W, UNDIVIDED
- 701801-05 SIDEWALK, CORNER OR CROSSWALK CLOSURE
- 701901-02 TRAFFIC CONTROL DEVICES
- 720001-01 SIGN PANEL MOUNTING DETAILS
- 720011-01 METAL POSTS FOR SIGNS, MARKERS & DELINEATORS
- 720006-03 SIGN PANEL ERECTION DETAILS
- 780001-03 TYPICAL PAVEMENT MARKINGS
- 878001-09 CONCRETE FOUNDATION DETAILS
- 424001-07 PERPENDICULAR CURB RAMPS FOR SIDEWALKS

DRAWING SCALES

PLAN: 1" = 20'



FULL SIZE PLANS HAVE BEEN PREPARED USING STANDARD ENGINEERING SCALES. REDUCED SIZED PLANS WILL NOT CONFORM TO STANDARD SCALES. IN MAKING MEASUREMENTS ON REDUCED PLANS, THE ABOVE SCALES MAY BE USED.

J.U.L.I.E.  
JOINT UTILITY LOCATION INFORMATION FOR EXCAVATION  
1-800-892-0123  
OR 811

PROPOSED  
SAFE ROUTES TO SCHOOL

SECTION 10-00001-00-SW  
PROJECT SRTS - 4009 (236)  
CITY OF WENONA  
MARSHALL COUNTY  
C-40-075-09

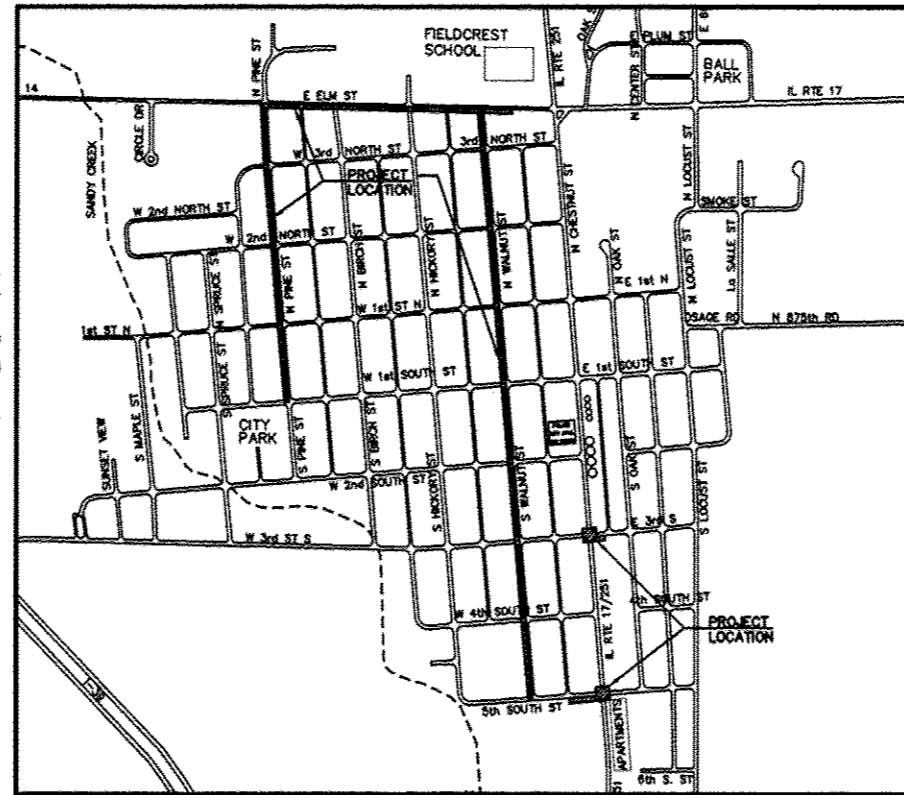

R 1 E OF THE 3rd P.M.

LOCATION MAP  
SCALE: N.T.S.

PROJECT LENGTH  
6330 FEET (1.01 MILES)

THIS PROJECT INCLUDES THE CONSTRUCTION OF A CONCRETE SIDEWALK AND ASSOCIATED IMPROVEMENTS WITHIN THE CITY OF WENONA ON THE WEST SIDE OF PINE ST., SOUTH SIDE OF ELM ST., THE WEST SIDE OF WALNUT ST AND TWO LOCATIONS ON IL RTE 17/251.

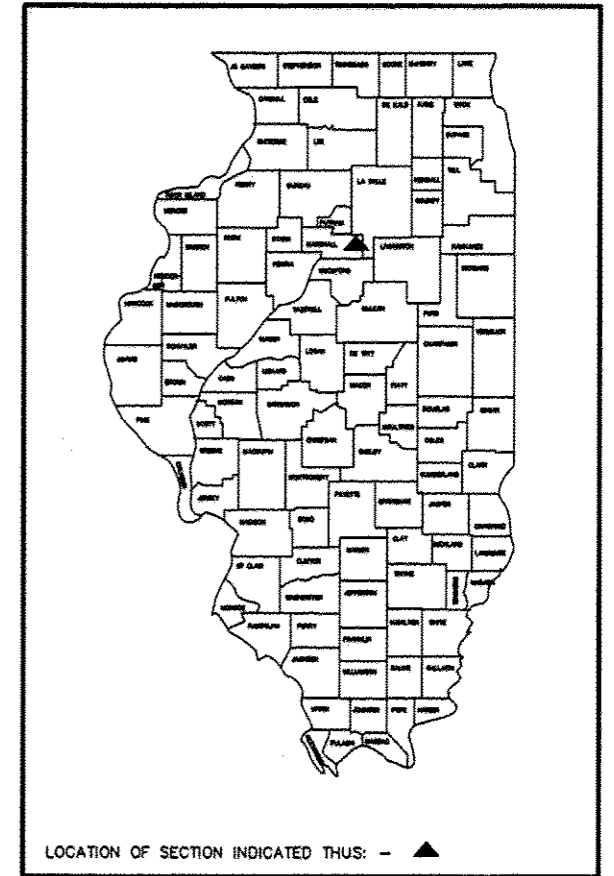

LOCATION OF SECTION INDICATED THUS: - ▲

APPROVED William Simmons 20 12  
City Administrator  
LOCAL AGENCY OFFICIAL

PASSED 11/09/12 20 12  
[Signature]  
REGIONAL ENGINEER

RELEASING FOR BID BASED ON LIMITED REVIEW  
[Signature] 20 12  
DEPUTY DIRECTOR OF HIGHWAYS,  
REGION THREE ENGINEER  
STATE OF ILLINOIS  
DEPARTMENT OF TRANSPORTATION

J.R. NOYENBY, JR., P.E., P.L.S.  
ILLINOIS REGISTERED PROFESSIONAL ENGINEER  
No. 062544116  
EXPIRATION DATE 11/30/13

[Signature] DATE 11/8/12

**McClure**  
Engineering Associates, Inc.  
1138 Columbus Street  
Ocala, Illinois 61302  
(815) 433-2000 FAX (815) 433-9600  
Design Firm License: Illinois 164-000816  
Copyright 2011 by McClure Engineering Associates, Inc.  
C:\Drawings\Wenona\10-000 Safe Routes\01 COVER.dwg

PRINTED BY THE AUTHORITY  
OF THE STATE OF ILLINOIS

CONTRACT NO.	SECTION	COUNTY	TOTAL SHEETS	SHEET NO.
89585	*	MARSHALL COUNTY	16	2
* SECTION 10-00001-00-SW		ILLINOIS		

**GENERAL NOTES**

- LOCATION OF EXISTING UNDERGROUND UTILITIES ARE SHOWN ON PLANS FOR THE CONVENIENCE OF THE BIDDER ONLY. THE OWNER OR ENGINEER ASSUMES NO RESPONSIBILITY WHATSOEVER IN RESPECT TO THE ACCURACY OF THE INFORMATION SHOWN ON THE PLANS RELATIVE TO THE LOCATION OR SIZE. IT SHALL BE THE CONTRACTOR'S RESPONSIBILITY TO DETERMINE THE ACTUAL LOCATION OF ALL SUCH FACILITIES.
- ALL WORK SHALL BE IN ACCORDANCE WITH THE "STANDARD SPECIFICATIONS FOR ROAD AND BRIDGE CONSTRUCTION" ADOPTED JANUARY 1, 2012, THE LATEST EDITION OF THE "ILLINOIS MANUAL ON UNIFORM TRAFFIC CONTROL DEVICES FOR STREETS AND HIGHWAYS" IN EFFECT ON THE DATE OF INVITATION FOR BIDS.
- ALL WORK AND MATERIALS SHALL BE IN ACCORDANCE WITH CODE REQUIREMENTS.
- THE CONTRACTOR(S) SHALL COMPLY WITH ALL LOCAL AND STATE SAFETY LAWS, REGULATIONS AND ORDINANCES; AND FEDERAL SAFETY REGULATIONS AS OUTLINED IN THE LATEST REVISIONS OF THE FEDERAL CONSTRUCTION SAFETY STANDARDS AND WITH ALL PROVISIONS AND REGULATIONS OF THE OSHA STANDARDS. EACH CONTRACTOR IS RESPONSIBLE FOR PROVIDING A SAFE WORKING PLACE FOR HIS EMPLOYEES. THE CONTRACTOR(S) ARE RESPONSIBLE FOR THE SUPERVISION, DIRECTION AND CONDUCT OF THEIR EMPLOYEES, AGENTS, MATERIAL SUPPLIERS AND VENDORS. THE CONTRACTOR(S) BY USING THESE PLANS FOR THEIR WORK, AGREE TO HOLD HARMLESS MCCLURE ENGINEERING ASSOCIATES, INC. (THE ENGINEER), HIS EMPLOYEES AND AGENTS WHILE ACTING WITHIN THE SCOPE OF THEIR DUTIES FROM AND AGAINST ANY AND ALL LIABILITY, CLAIMS, DAMAGES, AND THE COST OF DEFENSE ARISING OUT OF CONTRACTOR(S) PERFORMANCE OF THE WORK DESCRIBED HEREIN, BUT NOT INCLUDING THE SOLE NEGLIGENCE OF THE OWNER, HIS AGENTS, THE ENGINEER, HIS EMPLOYEES AND AGENTS.
- EROSION CONTROL PRACTICES SHALL BE FOLLOWED AT ALL TIMES IN ACCORDANCE WITH THE LATEST "STANDARD AND SPECIFICATIONS FOR SOIL EROSION AND SEDIMENT CONTROL".
- THE CONTRACTOR SHALL PROVIDE TRAFFIC CONTROL IN CONFORMANCE WITH THE MANUAL ON UNIFORM TRAFFIC CONTROL DEVICES FOR STREETS AND HIGHWAYS, STATE OF ILLINOIS, AND SECTION 107.14 OF THE HIGHWAY STANDARDS. BARRICADES AND OTHER REQUIRED TRAFFIC CONTROL SHALL BE CONSIDERED INCIDENTAL TO THE CONTRACT.
- THE CONTRACTOR SHALL EXAMINE THE PLANS AND SPECIFICATIONS, VISIT THE SITE OF WORK AND INFORM HIMSELF FULLY WITH THE WORK INVOLVED, GENERAL AND LOCAL CONDITIONS, ALL FEDERAL, STATE AND LOCAL LAWS, ORDINANCES, RULES AND REGULATIONS AND ALL OTHER PERTINENT ITEMS WHICH MAY AFFECT THE COST AND TIME OF COMPLETION OF THIS PROJECT BEFORE SUBMITTING A PROPOSAL.
- HANDICAP ACCESSIBILITY FEATURES (SIDEWALK SLOPES, CURB RAMPS, ETC.) SHALL NOT DEVIATE FROM THE PLANS AND STANDARDS INCLUDED. CONSTRUCT HANDICAP RAMPS AT ALL SIDEWALK - ROADWAY INTERSECTIONS.
- TREES AND SHRUBS NOT LABELED ON PLANS FOR REMOVAL SHALL BE SAVED UNLESS ENGINEER OR HIS ASSIGNED DETERMINES THAT CONSTRUCTION OPERATIONS PROHIBIT SAVING. SHRUB AND BUSH REMOVAL SHALL BE CONSIDERED INCIDENTAL TO THE CONTRACT.
- WHATEVER OBSTRUCTIONS NOT SHOWN ON THE PLANS ARE ENCOUNTERED DURING CONSTRUCTION AND INTERFERE TO SUCH AN EXTENT THAT AN ALTERATION IN THE PLANS IS REQUIRED, THE ENGINEER SHALL BE NOTIFIED PRIOR TO ANY CHANGES.
- ANY FIELD TILE ENCOUNTERED DURING CONSTRUCTION SHALL BE REPAIRED AND RETURNED TO ITS ORIGINAL INTEGRITY, ROUTE AND FUNCTION, AND SHALL NOT BE CONNECTED INTO THE NEW STORM SEWER SYSTEM UNLESS OTHERWISE APPROVED BY THE CITY.
- THE CONTRACTOR WILL NOT BE ALLOWED TO COMMENCE CONSTRUCTION UNTIL CERTIFICATES OF INSURANCE INDEMNIFYING AND ADDING AS ADDITIONAL INSURED THE CITY OF WENONA AND MCCLURE ENGINEERING ASSOCIATES, INC. AND THEIR OFFICERS, EMPLOYEES AND AGENTS, HAVE BEEN DELIVERED TO AND APPROVED BY THE CITY OF WENONA.  
  
THE INSURANCE REQUIREMENTS SHALL MEET THOSE SPECIFIED IN ARTICLE 107.27 OF THE STANDARD SPECIFICATIONS FOR ROAD AND BRIDGE CONSTRUCTION, LATEST EDITION.

**GENERAL NOTES (CONT'D)**

- THE CITY AND THE CITY ENGINEER SHALL BE NOTIFIED 48 HOURS PRIOR TO COMMENCEMENT OF ANY SITE WORK. THE ENGINEER IS TO BE NOTIFIED BY THE CONTRACTOR A MINIMUM OF 24 HOURS PRIOR TO COVERING ANY EXPOSED SUBGRADE, PLACING ANY FILL, BACKFILLING SANITARY, WATER OR STORM LINES, PLACING BASE COURSE STONE, PLACING CONCRETE, OR PLACING ASPHALT.
- THE LOCATION OF THE SITE IMPROVEMENTS ARE NOT LOCATED WITHIN A FLOODPLAIN OR WETLANDS.
- THE CONTRACTOR SHALL FURNISH RECORD DRAWINGS TO MCCLURE ENGINEERING ASSOCIATES, INC. THAT INCLUDE INFORMATION SHOWING ALL MODIFICATIONS TO PLANS, LOCATIONS OF ALL SERVICE CONNECTIONS AND ANY OTHER INFORMATION DEEMED NECESSARY BY THE ENGINEER.
- THE CONTRACTOR IS RESPONSIBLE FOR HAVING THE MOST RECENT SET OF THE "APPROVED FOR CONSTRUCTION" FINAL ENGINEERING PLANS ON THE JOB SITE PRIOR TO THE START OF CONSTRUCTION.

**ELECTRICAL NOTES**

- THE LOCATION OF ALL UTILITIES AND PRIVATELY OWNED FACILITIES SHALL BE FIELD VERIFIED BY THE CONTRACTOR PRIOR TO THE INSTALLATION OF ANY COMPONENTS.
- RECTANGULAR RAPID FLASHING BEACONS AND SIGNS SHALL BE IN FULL COMPLIANCE WITH THE LATEST PUBLISHED EDITIONS OF THE MANUAL ON UNIFORM TRAFFIC CONTROL DEVICES AND WITH FHWA CONDITIONS FOR INTERIM APPROVAL AND ASSOCIATED INTERPRETATIONS ISSUED BY THE FHWA.
- TRAFFIC SIGNAL POSTS SHALL BE INSTALLED ON ADJACENT SIDES OF THE CROSSWALK.
- PEDESTRIAN PUSHBUTTONS SHALL BE LOCATED WITHIN TWO FEET OF THE SIDEWALK TO PROVIDE UNRESTRICTED ADA ACCESSABILITY.
- RRFB ASSEMBLIES SHALL BE INSTALLED AT LOCATIONS AS SPECIFIED BY THE ENGINEER OF TRAFFIC. THE CONTRACTOR SHALL NOTIFY RANDY LANINGA, AT (309) 671-4477 FOR LOCATION VERIFICATION PRIOR TO INSTALLATION.
- RRFB ASSEMBLIES SHALL BE INSTALLED AT A MINIMUM DISTANCE OF EIGHT FEET FROM THE EDGE OF PAVEMENT.

**EXCAVATION**

- SURPLUS EXCAVATED SOIL MATERIALS SHALL BE REMOVED FROM THE SITE AS ACCEPTABLE TO THE ENGINEER.
- ALL FILLS SHALL BE COMPACTED IN 6-INCH LIFTS TO A MINIMUM OF 95% OF THE STANDARD PROCTOR MAXIMUM DRY DENSITY.
- THE CONTRACTOR SHALL BE RESPONSIBLE FOR MEETING THE REQUIREMENTS OF ALL APPLICABLE SOIL EROSION AND SEDIMENT CONTROL ORDINANCES.
- UPON COMPLETION OF THE WORK, TOPSOIL SHALL BE SPREAD TO A MINIMUM THICKNESS OF 6 INCHES AND GRADED TO MEET SURROUNDING ELEVATIONS.

**LEGEND**

	FOUND IRON PIPE
	RIGHT-OF-WAY MARKER
	DECIDUOUS TREE W/ SIZE
	EVERGREEN TREE
	SIGN
	UTILITY POLE
	DOWN GUY
	PEDESTAL
	EXISTING VALVE AND BOX
	EXISTING VALVE AND BOX
	EXISTING FIRE HYDRANT ASSEMBLY
	EXISTING MANHOLE
	EXISTING INLET
	EXISTING CATCH BASIN
	EXISTING FLARED END SECTION
	EXISTING MAILBOX
	EXISTING PROPERTY LINE
	EXISTING RIGHT-OF-WAY LINE
	EXISTING CONTOUR LINE 1 FOOT INTERVAL
	EXISTING CONTOUR LINE 5 FOOT INTERVAL
	EXISTING UNDERGROUND TV LINE
	EXISTING UNDERGROUND TELEPHONE LINE
	EXISTING OVERHEAD ELECTRIC LINE
	EXISTING UNDERGROUND ELECTRIC LINE
	EXISTING GAS MAIN
	EXISTING WATER MAIN
	EXISTING SANITARY SEWER
	EXISTING STORM SEWER

**McClure**  
Engineering Associates, Inc.  
1135 Columbus Street  
Ottawa, Illinois 61350  
(815) 433-2000  
Fax (815) 433-4920  
Design Firm License: Illinois 184-000816  
Copyright 2011 By McClure Engineering Associates, Inc.

REVISIONS	
NAME	DATE
KED	11/5/12

**GENERAL NOTES AND LEGEND**

SCALE: AS NOTED DRAWN BY: KED  
DATE: 2011 CHECKED BY: SMK  
File: C:\Drawings\Wenona\10-00001-00-SW Revise\02 NOTES.dwg

CONTRACT NO.	SECTION	COUNTY	TOTAL SHEETS	SHEET NO.
89585	*	MARSHALL COUNTY	16	3
* SECTION 10-00001-00-SW		ILLINOIS		

CODE NO.	ITEM	ITEM	TOTAL QUANTITY
20101200	TREE ROOT PRUNING	EACH	5
21101600	TOPSOIL FURNISH AND PLACE, VARIABLE DEPTH	SQ YD	1947
25000110	SEEDING, CLASS 1A	ACRE	0.30
25000400	NITROGEN FERTILIZER NUTRIENT	POUND	30
25000500	PHOSPHORUS FERTILIZER NUTRIENT	POUND	30
25000600	POTASSIUM FERTILIZER NUTRIENT	POUND	30
35101598	AGGREGATE BASE COURSE, TYPE B 3"	SQ YD	2911
35101600	AGGREGATE BASE COURSE, TYPE B 4"	SQ YD	139
42300400	PORTLAND CEMENT CONCRETE DRIVEWAY PAVEMENT, 8 INCH	SQ YD	139
42400200	PORTLAND CEMENT CONCRETE SIDEWALK 5 INCH	SQ FT	22106
42400800	DETECTABLE WARNINGS	SQ FT	232
44000200	DRIVEWAY PAVEMENT REMOVAL	SQ YD	374
44000500	COMBINATION CURB AND GUTTER REMOVAL	FOOT	180
44000600	SIDEWALK REMOVAL	SQ FT	18008
60604400	COMBINATION CONCRETE CURB AND GUTTER, TYPE B-6.18	FOOT	300
6700000	<b>MOBILIZATION</b>	L.SUM	1
70102620	TRAFFIC CONTROL & PROTECTION, STANDARD 701501-05	L.SUM	1
70102640	TRAFFIC CONTROL & PROTECTION, STANDARD 701801-05	L.SUM	1
72000100	SIGN PANEL, TYPE 1	SQ FT	33
* 78000600	THERMOPLASTIC PAVEMENT MARKING - LINE 12"	FOOT	235
* 87502490	TRAFFIC SIGNAL POST, GALVANIZED STEEL, 15 FT	EACH	2
* 87800100	CONCRETE FOUNDATION, TYPE A	FOOT	6
* 88500100	PEDESTRIAN PUSH-BUTTON	EACH	2
* X7830078	GROOVING FOR RECESSED PAVEMENT MARKINGS 13"	EACH	235
* XX007021	PEDESTRIAN ACTIVATED CROSSWALK WARNING SYSTEM	EACH	1

\* SPECIALTY ITEMS

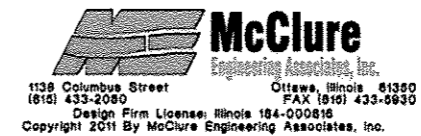

REVISIONS	
NAME	DATE
KED	11/5/12

**SUMMARY OF QUANTITIES**

SCALE: AS NOTED      DRAWN BY: KED  
 DATE: 2011              CHECKED BY: SMK  
 FILE: G:\Drawings\Wenona\10-0001-00-SW Route\03 QTY.dwg

CONTRACT NO.	SECTION	COUNTY	TOTAL SHEETS	SHEET NO.
89585	*	MARSHALL COUNTY	16	4
* SECTION 10-0001-00-SW		ILLINOIS		

	TOPSOIL FURNISH & PLACE, VARIABLE (SQ YD)	AGGREGATE BASE COURSE, TYPE B 3" (SQ YD)	AGGREGATE BASE COURSE, TYPE B 4" (SQ YD)	PCC DRIVEWAY PAVEMENT, 8 INCH (SQ YD)	PCC SIDEWALK, 5 INCH (SQ FT)	DETECTABLE WARNINGS (SQ FT)	DRIVEWAY PAVEMENT REMOVAL (SQ YD)	COMBINATION CURB & GUTTER REMOVAL (FOOT)	SIDEWALK REMOVAL (SQ FT)	COMBINATION CONCRETE CURB & GUTTER, TYPE 9-6.18 (FOOT)	SIGN PANEL TYPE 1 (SQ FT)	THERMOPLASTIC PAVEMENT MARKING LINE 12" (FOOT)	TRAFFIC SIGNAL POST, GALV STEEL, 15 FT (EACH)	CONCRETE FOUNDATION, TYPE A (FOOT)	PEDESTRIAN PUSH-BUTTON (EACH)	GROOVING FOR RECESSED PAVEMENT MARKINGS 33" (FOOT)	PEDESTRIAN ACTIVATED CROSSWALK WARNING SYSTEM (EACH)
<b>PINE STREET</b>																	
P1	1	2			16	8			16								
P2	15	21			164				164								
P3	85	129			1000				1000								
P4	24	40			280			15	280	15							
P5	25					8		20		20							
P6						8											
P7	50	78			600				600								
P8	38	57			440				440								
P9						8											
P10						8											
P11	33	52			400				400								
P12	40	62			480				480								
P13			10	10			10										
P14	10	18			120												
P15	53	83			640												
P16						8											
P17						8											
P18	57	88		8	680												
P19			8	8			8										
P20	23	36		14	265												
P21			14	14			14										
P22	33	52			400												
P23						8											
<b>ELM STREET</b>																	
E1						8											
E2	80	47			360				360								
E3			11	11			11										
E4	33	52			400				400								
E5			11	11			11										
E6	7	8			40												
E7	11	10			80	8			80								
E8	17	26			200	8			200								
E9	10	5			41				41								
E10	10	5			41				41								
E11			11	11			11										
E12	56	101			780				780								
E13						8											
E14						8											
E15	33	52			400				400								
E16			6	6			6										
E17	28	44			340				340								
E18			11	11			11										
E19	49	67			520				520								
E20	11	18			140				140								
E21	20	31			240				240								
<b>WALNUT STREET</b>																	
W1	10	17			120	8			120								
W2						8											
W3	40	63			480				480								
W4			6	6			6										
W5	30	48			360				360								
W6			8	8			8										
W7	37	57			440				440								
W8			6	6			6										
W9	30	48			330				330								
W10	12	18			140				140								
W11	120	187			1340				1340								
W12	87	135			1040				1040								
W13	20	31			240				240								
W14	18	29			220				220								
W15	80	125			960				960								
W16	30	47			360				360								
W17	25	39			300				300								
W18	3	5			40				40								
W19	3	3			32				32								
W20	33	52			400				400								
W21	22	34			260				260								
W22	8	13			100				100								
W23	22	33			260				260								
W24	28	44			340				340								
W25	40	67			480				480								
W26	23	39			280				280								
W27	28	44			340				340								
W28	20	31			240				240								
W29	15	23			180				180								
W30	12	18			140				140								
W31	22	34			260				260								
W32	3	5			40				40								
W33	27	42			320				320								
W34	33	52			400				400								
W35	53	83			640				640								
W36	8	13			100				100								
<b>CROSSWALKS</b>																	
3rd South St / IL RTE 17/251	29	46			330	8		20	330	20		72				72	
5th South St / IL RTE 17/251	60	100			720	16						76				76	
<b>PEDESTRIAN CROSSING</b>																	
Elm St @ School	120	102	37	37	797	88	272	125	32	245	33	85	2	6	2	85	1
<b>TOTALS</b>	<b>1947</b>	<b>2911</b>	<b>139</b>	<b>139</b>	<b>22106</b>	<b>232</b>	<b>374</b>	<b>180</b>	<b>18008</b>	<b>300</b>	<b>83</b>	<b>295</b>	<b>2</b>	<b>6</b>	<b>2</b>	<b>235</b>	<b>1</b>

MARSHALL COUNTY SECTION 10-0001-00-SW

1138 Columbus Street  
18151 433-2080  
Copyright 2011 By McClure Engineering Associates, Inc.

Ottawa, Illinois 61350  
FAX (815) 433-5910  
Design Firm License: Illinois 184-000610

REVISIONS		NAME	DATE

**SCHEDULE OF QUANTITIES**

SCALE: AS NOTED      DRAWN BY: KED  
DATE: 2011      CHECKED BY: SMK  
FILE: G:\Drawings\Marshall\10-0001-00-SW\_Route\04 SCH QTY.dwg

CONTRACT NO.	SECTION	COUNTY	TOTAL SHEETS	SHEET NO.
89585	*	MARSHALL COUNTY	16	5
SECTION 10-0001-00-SW		ILLINOIS		



MARSHALL COUNTY SECTION 10-0001-00-SW

**McClure**  
Engineering Associates, Inc.  
1138 Columbus Street  
Ottawa, Illinois 61350  
(618) 433-2080 FAX (618) 433-5930  
Design Firm License: Illinois 184-000818  
Copyright 2011 By McClure Engineering Associates, Inc.

REVISIONS	
NAME	DATE
KED	11/5/12

SHEET INDEX	
SCALE: AS NOTED	DRAWN BY: KED
DATE: 2011	CHECKED BY: SMK
FILE: G:\Drawings\Illinois\10-0001-00-SW-05-Rev1\5 INDEX.dwg	

CONTRACT NO.	SECTION	COUNTY	TOTAL SHEETS	SHEET NO.
89585	*	MARSHALL COUNTY	16	6
* SECTION 10-00001-00-SW		ILLINOIS		

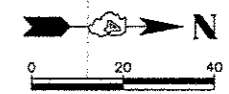
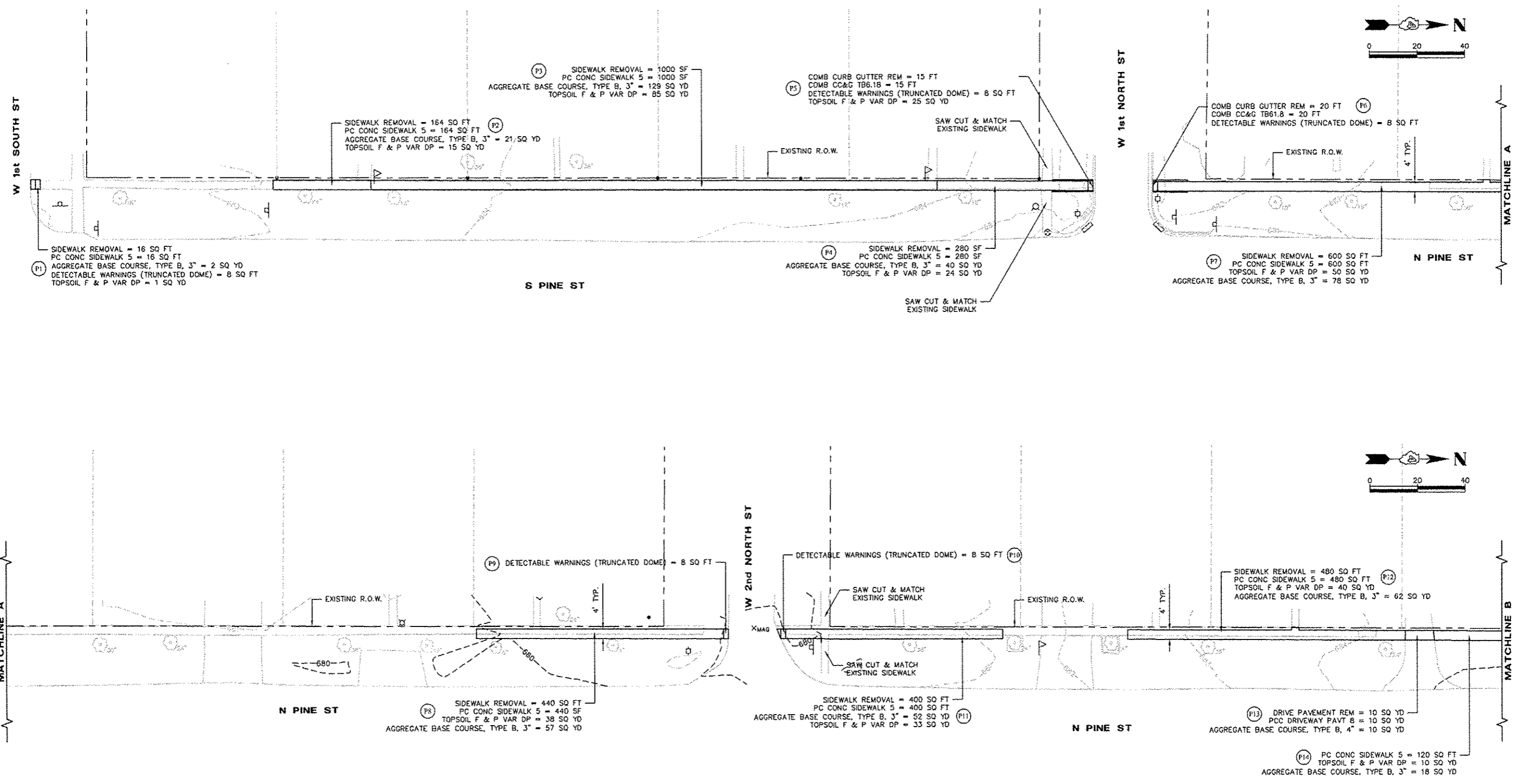

NOTE: EARTH EXCAVATION WILL NOT BE MEASURED FOR PAYMENT BUT SHALL BE CONSIDERED INCIDENTAL TO PC CONC SIDEWALK 5.

**McClure**  
Engineering Associates, Inc.  
1135 Columbus Street  
Ottawa, Illinois 61350  
(815) 433-2090 FAX (815) 433-9930  
Design Firm License: Illinois 184-000810  
Copyright 2011 By McClure Engineering Associates, Inc.

REVISIONS	
NAME	DATE
KED	11/5/12

**PINE STREET  
PLAN SHEET**

SCALE: AS NOTED  
DATE: 2011  
DRAWN BY: KED  
CHECKED BY: SMK  
FILE: D:\Drawings\Winona\10-0001-00-SW Safe Routes\PS 1.dwg

CONTRACT NO.	SECTION	COUNTY	TOTAL SHEETS	SHEET NO.
89585	*	MARSHALL COUNTY	16	7
* SECTION 10-00001-00-SW		ILLINOIS		

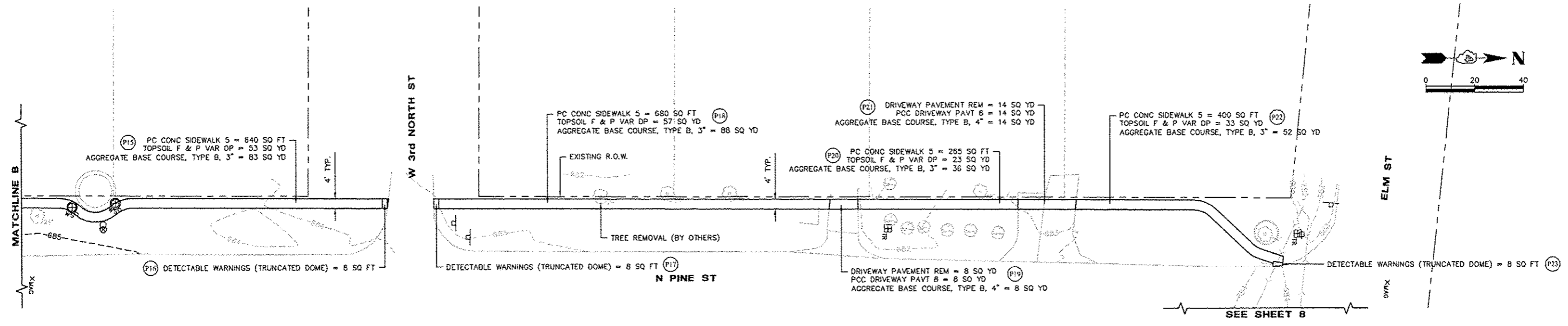

NOTE: EARTH EXCAVATION WILL NOT BE MEASURED FOR PAYMENT BUT SHALL BE CONSIDERED INCIDENTAL TO PC CONC SIDEWALK 5.

**McClure**  
 Engineering Associates, Inc.  
 1138 Columbus Street  
 (815) 433-2060  
 Design Firm License: Illinois 184-000818  
 Copyright 2011 By McClure Engineering Associates, Inc.

Oliver, Illinois 61350  
 FAX: (815) 433-5930

REVISIONS	
NAME	DATE
KED	11/5/12

**PINE STREET  
 PLAN SHEET**

SCALE: AS NOTED  
 DATE: 2011  
 FILE: G:\Drawings\Marion\10-060 Safe Routes\7 PS 2.dwg

DRAWN BY: KED  
 CHECKED BY: SMK

CONTRACT NO.	SECTION	COUNTY	TOTAL SHEETS	SHEET NO.
89585	*	MARSHALL COUNTY	16	8
* SECTION 10-00001-00-SW		ILLINOIS		

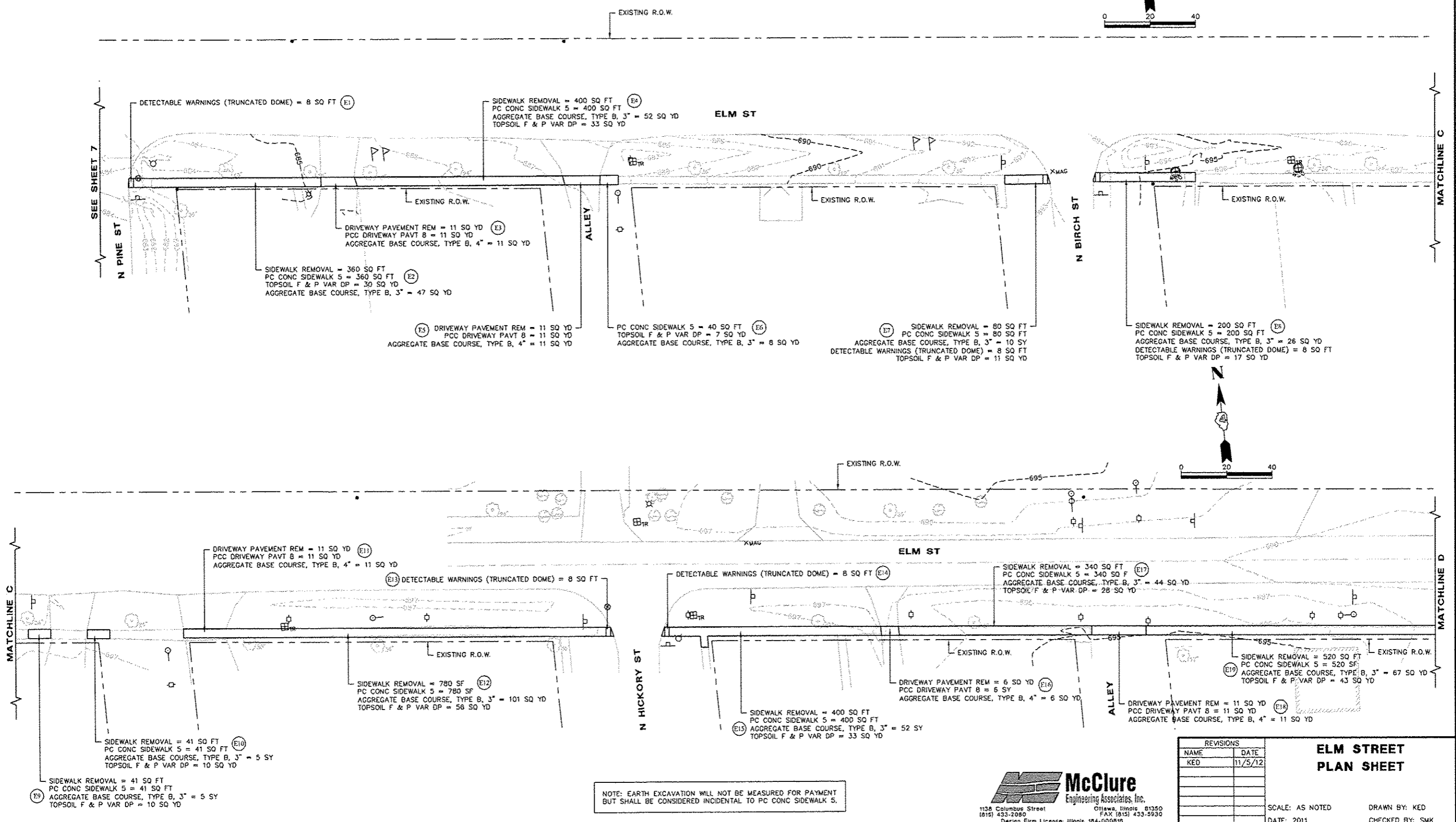
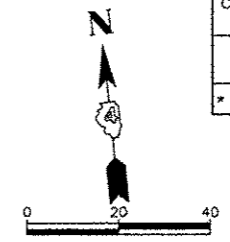

NOTE: EARTH EXCAVATION WILL NOT BE MEASURED FOR PAYMENT BUT SHALL BE CONSIDERED INCIDENTAL TO PC CONC SIDEWALK 5.

**McClure**  
Engineering Associates, Inc.  
1138 Columbus Street  
Ottawa, Illinois 61350  
(815) 433-2090 FAX (815) 433-5930  
Design Firm License: Illinois 184-000910  
Copyright 2011 By McClure Engineering Associates, Inc.

REVISIONS	
NAME	DATE
KED	11/5/12

**ELM STREET  
PLAN SHEET**

SCALE: AS NOTED  
DATE: 2011  
DRAWN BY: KED  
CHECKED BY: SMK  
FILE: Q:\Drawings\Winona\10-0001-00-SW Route 10 PS 3.dwg



CONTRACT NO.	SECTION	COUNTY	TOTAL SHEETS	SHEET NO.
89585	*	MARSHALL COUNTY	16	9
* SECTION 10-00001-00-SW		ILLINOIS		

FIELDCREST  
MIDDLE  
SCHOOL

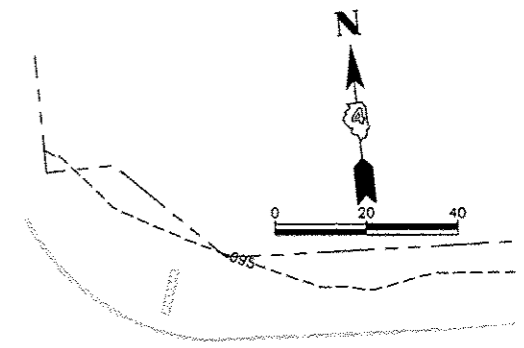
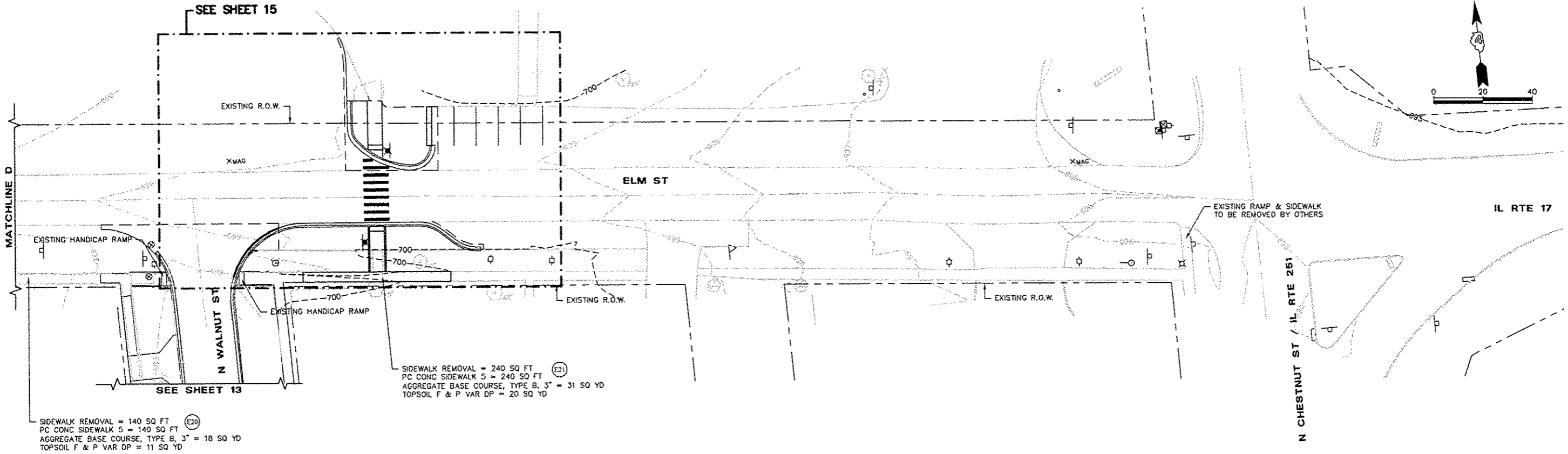

(E20)  
SIDEWALK REMOVAL = 140 SQ FT  
PC CONC SIDEWALK 5 = 140 SQ FT  
AGGREGATE BASE COURSE, TYPE B, 3" = 18 SQ YD  
TOPSOIL F & P VAR DP = 11 SQ YD

(E21)  
SIDEWALK REMOVAL = 240 SQ FT  
PC CONC SIDEWALK 5 = 240 SQ FT  
AGGREGATE BASE COURSE, TYPE B, 3" = 31 SQ YD  
TOPSOIL F & P VAR DP = 20 SQ YD

NOTE: EARTH EXCAVATION WILL NOT BE MEASURED FOR PAYMENT BUT SHALL BE CONSIDERED INCIDENTAL TO PC CONC SIDEWALK 5.

**McClure**  
Engineering Associates, Inc.  
1138 Columbus Street  
(618) 433-7080  
Ottawa, Illinois 61350  
FAX (618) 433-5930  
Design Firm License: Illinois 184-000818  
Copyright 2011 By McClure Engineering Associates, Inc.

REVISIONS	
NAME	DATE
KED	11/5/12

**ELM STREET / IL RTE 17  
PLAN SHEET**

SCALE: AS NOTED  
DATE: 2011  
FILE: G:\Drawings\Monona\10-0001-00-SW\_Site\_Revise\6 PS A.dwg  
DRAWN BY: KED  
CHECKED BY: SMK

CONTRACT NO.	SECTION	COUNTY	TOTAL SHEETS	SHEET NO.
89585	*	MARSHALL COUNTY	16	10
SECTION 10-0001-00-SW		ILLINOIS		

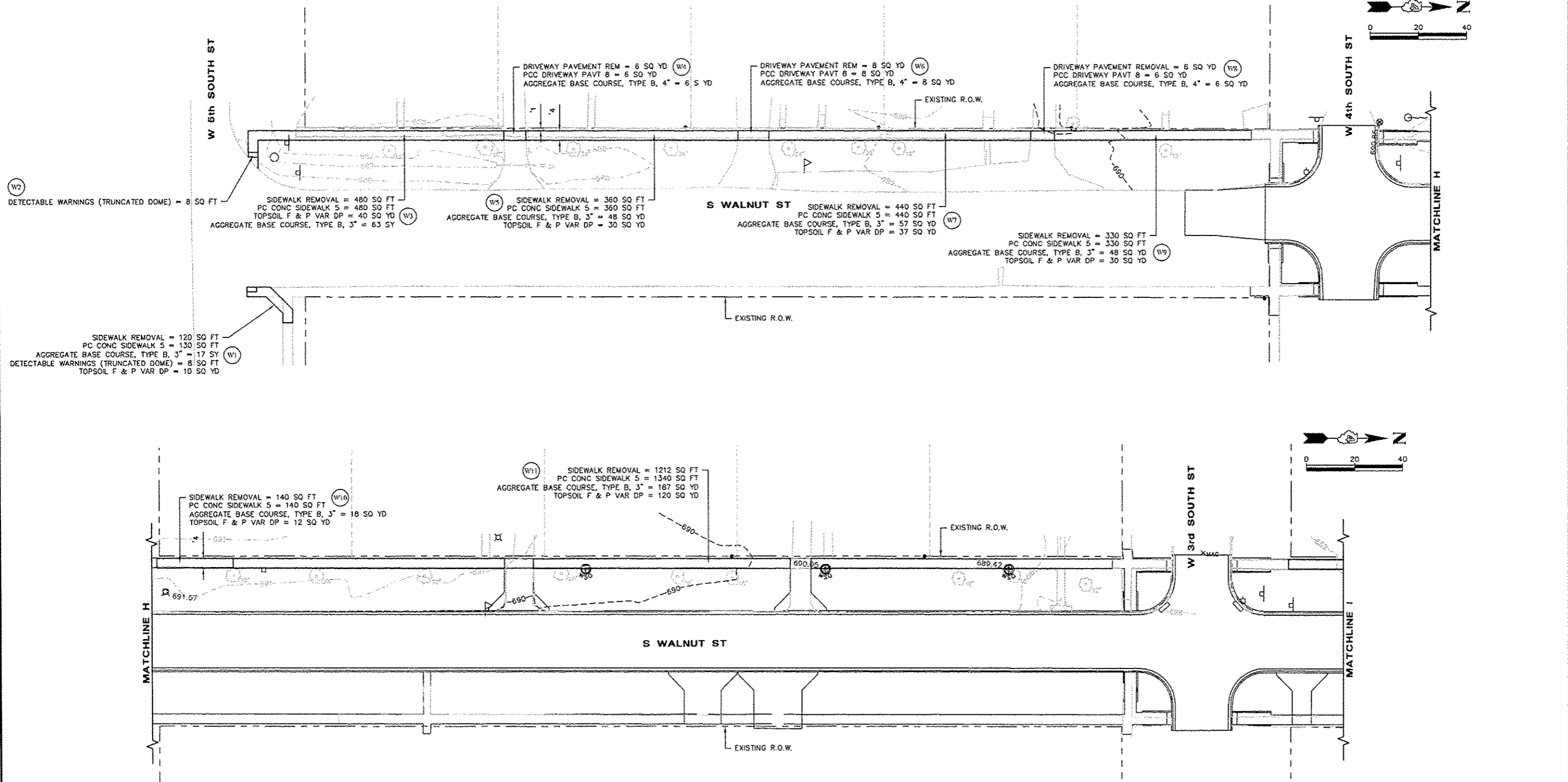

NOTE: EARTH EXCAVATION WILL NOT BE MEASURED FOR PAYMENT BUT SHALL BE CONSIDERED INCIDENTAL TO PC CONC SIDEWALK 5.

**McClure**  
 Engineering Associates, Inc.  
 1136 Columbus Street  
 Ottawa, Illinois 61360  
 (618) 433-2080 FAX (618) 433-5930  
 Design Firm License: Illinois 154-000810  
 Copyright 2011 By McClure Engineering Associates, Inc.

REVISIONS	
NAME	DATE
KED	11/5/12

**WALNUT STREET**  
**PLAN SHEET**

SCALE: AS NOTED  
 DATE: 2011  
 FILE: O:\Drawings\Walnut\10-0001-00-SW Rev14a\10 PS 5.dwg

DRAWN BY: KED  
 CHECKED BY: SMK

CONTRACT NO.	SECTION	COUNTY	TOTAL SHEETS	SHEET NO.
89585	*	MARSHALL COUNTY	16	11
* SECTION 10-00001-00-SW		ILLINOIS		

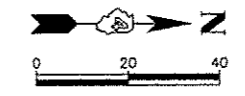
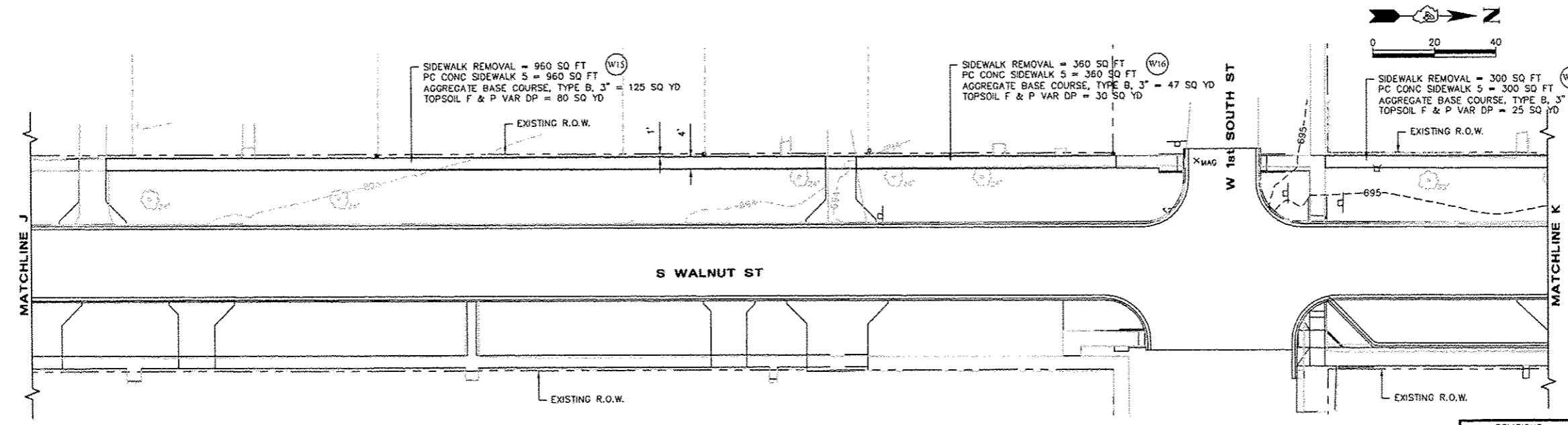
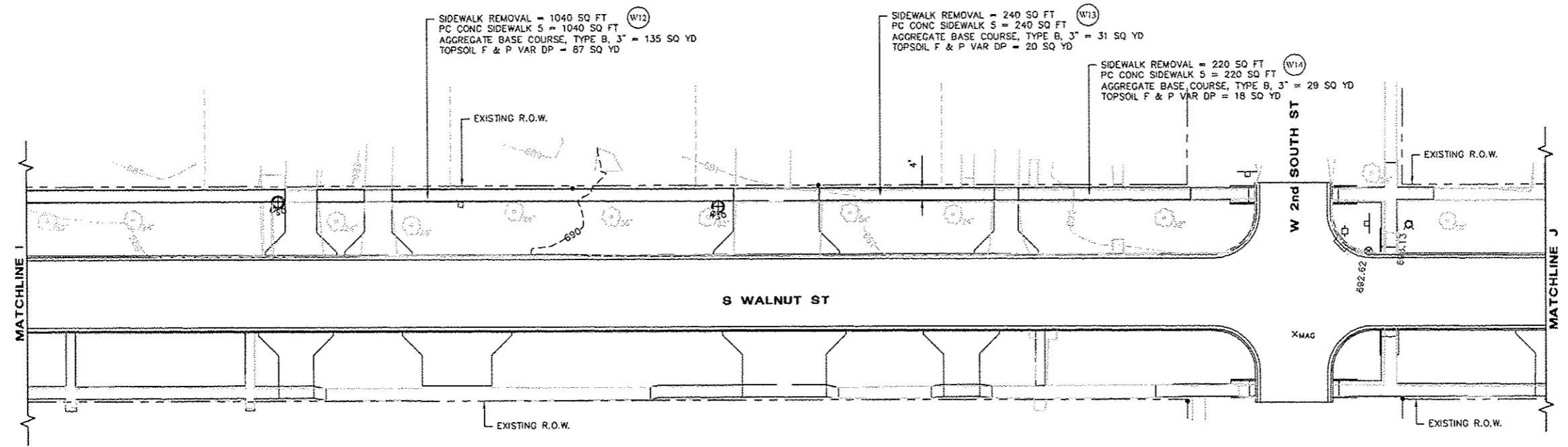

NOTE: EARTH EXCAVATION WILL NOT BE MEASURED FOR PAYMENT BUT SHALL BE CONSIDERED INCIDENTAL TO PC CONC SIDEWALK 5.

**McClure**  
Engineering Associates, Inc.  
1138 Columbus Street  
(615) 433-2080  
Ottawa, Illinois 61350  
FAX (615) 433-5930  
Design Firm License: Illinois 184-000816  
Copyright 2011 By McClure Engineering Associates, Inc.

REVISIONS	
NAME	DATE
KED	11/5/12

**WALNUT STREET  
PLAN SHEET**

SCALE: AS NOTED  
DATE: 2011  
DRAWN BY: KED  
CHECKED BY: SMK  
FILE: G:\Drawings\Wenona\10-0001-00-SW\_Route\11 PS 6.dwg

CONTRACT NO.	SECTION	COUNTY	TOTAL SHEETS	SHEET NO.
89585	*	MARSHALL COUNTY	16	12
* SECTION 10-0001-00-SW		ILLINOIS		

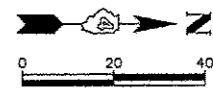
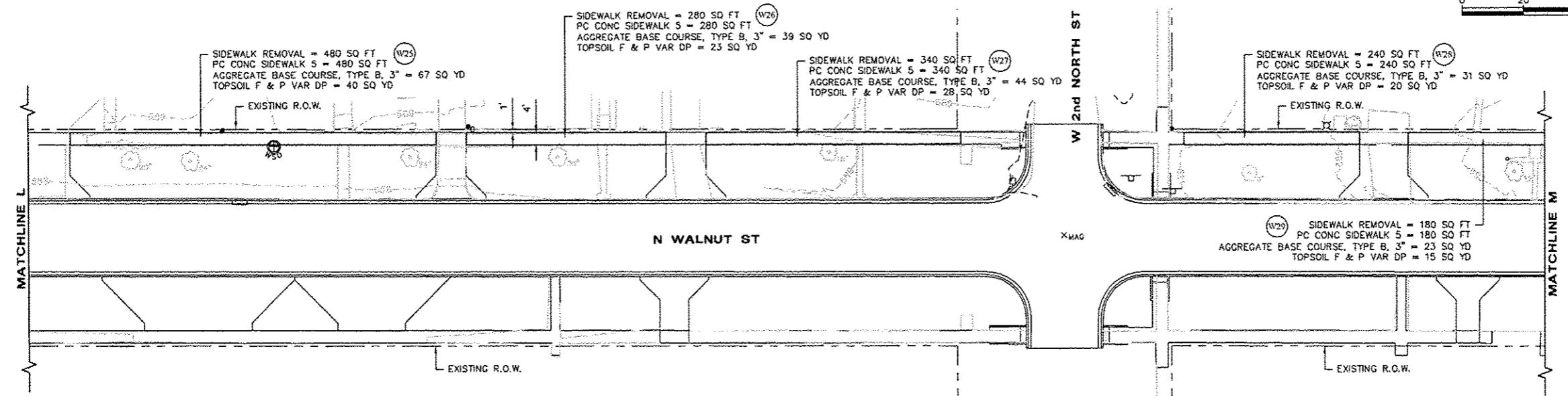
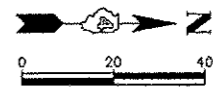
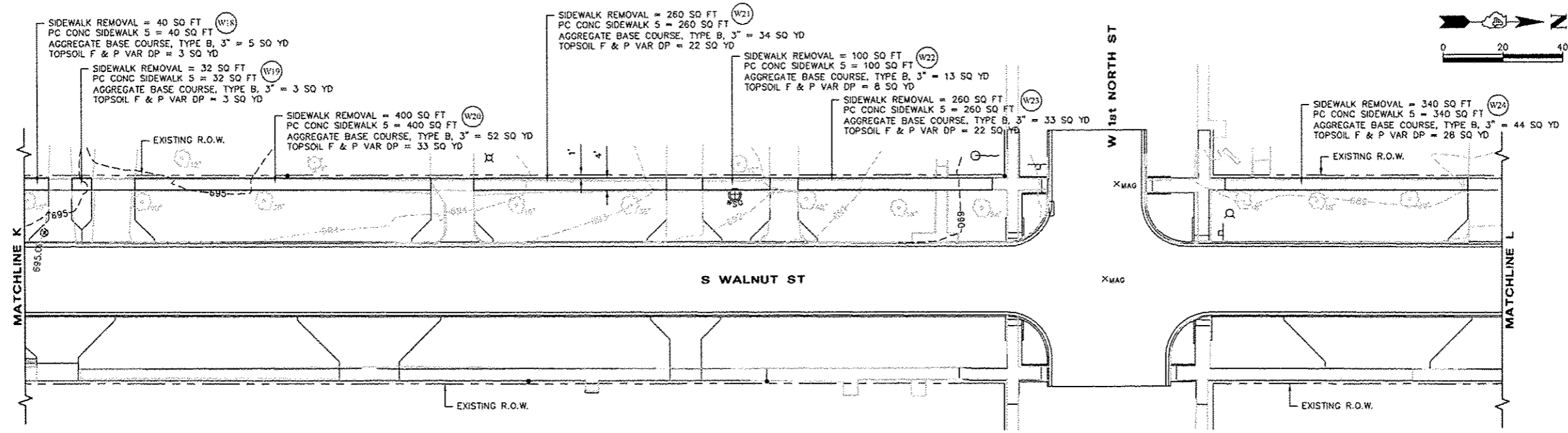

NOTE: EARTH EXCAVATION WILL NOT BE MEASURED FOR PAYMENT BUT SHALL BE CONSIDERED INCIDENTAL TO PC CONC SIDEWALK 5.

**McClure**  
Engineering Associates, Inc.  
1136 Columbus Street  
Ottawa, Illinois 61350  
18151 433-7080  
FAX 18151 433-9930  
Design Firm License: Illinois 18A-000818  
Copyright 2011 By McClure Engineering Associates, Inc.

REVISIONS	
NAME	DATE
KED	11/5/12

**WALNUT STREET  
PLAN SHEET**

SCALE: AS NOTED  
DATE: 2011  
FILE: Q:\Drawings\Winona\10-0001-00-Sw Walnut\12 PS 7.dwg

DRAWN BY: KED  
CHECKED BY: SMK

CONTRACT NO.	SECTION	COUNTY	TOTAL SHEETS	SHEET NO.
89585	*	MARSHALL COUNTY	10	13
SECTION 10-00001-00-SW		ILLINOIS		

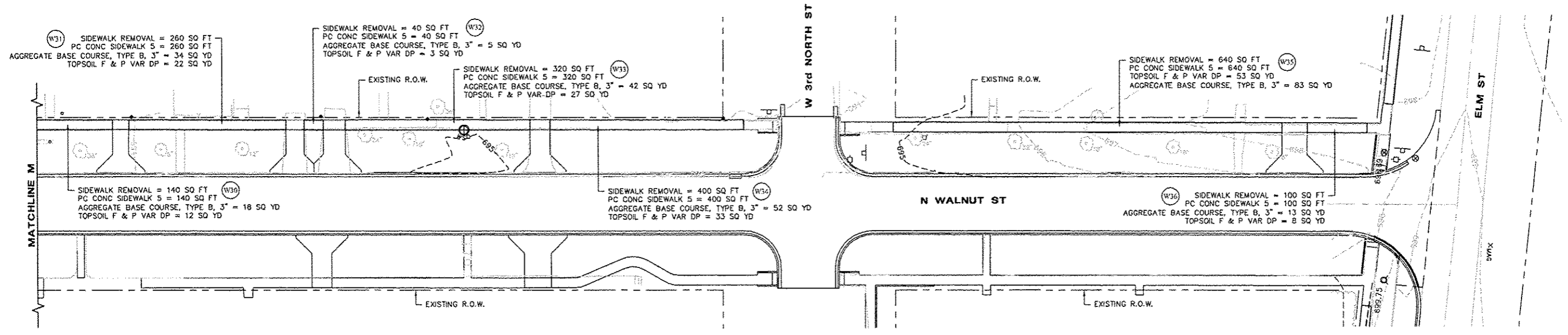

MARSHALL COUNTY SECTION 10-00001-00-SW

NOTE: EARTH EXCAVATION WILL NOT BE MEASURED FOR PAYMENT BUT SHALL BE CONSIDERED INCIDENTAL TO PC CONC SIDEWALK 5.

**McClure**  
Engineering Associates, Inc.  
1138 Columbia Street  
Ottawa, Illinois 61355  
181st 433-2080  
Fax 181st 433-5930  
Design Firm License: Illinois 184-000818  
Copyright 2011 By McClure Engineering Associates, Inc.

REVISIONS	
NAME	DATE
KED	11/5/12

**WALNUT STREET  
PLAN SHEET**

SCALE: AS NOTED  
DATE: 2011  
FILE: G:\Drawings\Marshall\10-0001-00-SW\13 PS 2.dwg

DRAWN BY: KED  
CHECKED BY: SMK

CONTRACT NO.	SECTION	COUNTY	TOTAL SHEETS	SHEET NO.
89585	*	MARSHALL COUNTY	16	14
* SECTION 10-00001-00-SW		ILLINOIS		

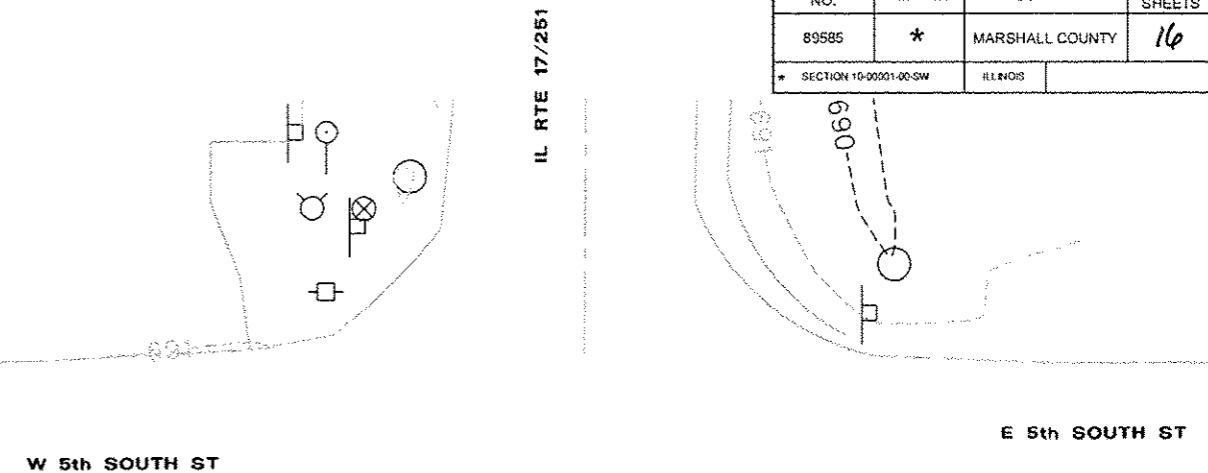
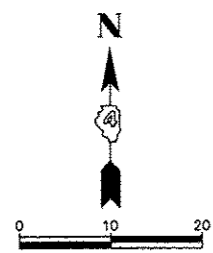

W 5th SOUTH ST

E 5th SOUTH ST

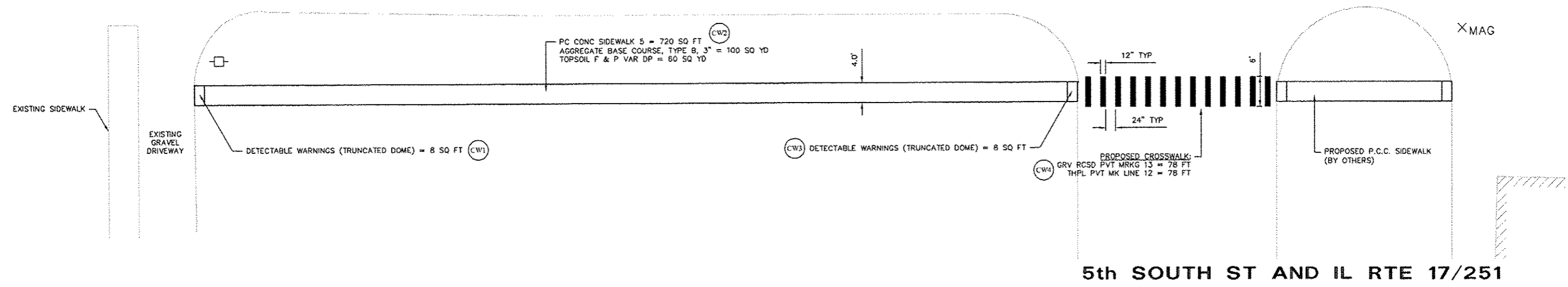

5th SOUTH ST AND IL RTE 17/251

W 3rd SOUTH ST      E 3rd SOUTH ST

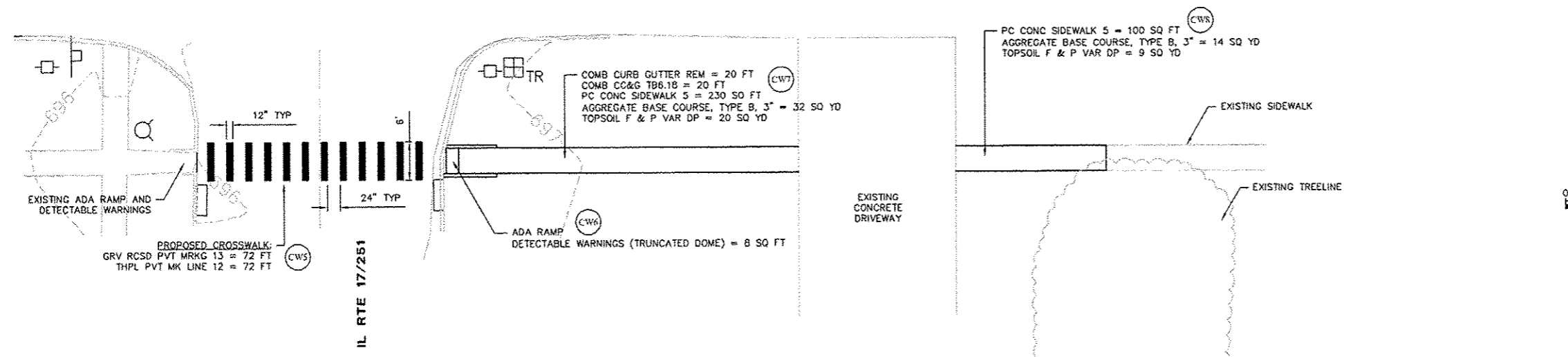

3rd SOUTH ST AND IL RTE 17/251

NOTE: EARTH EXCAVATION WILL NOT BE MEASURED FOR PAYMENT BUT SHALL BE CONSIDERED INCIDENTAL TO PC CONC SIDEWALK 5.

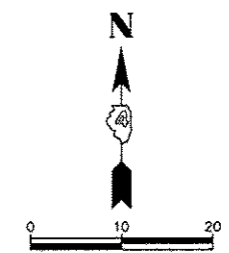

**McClure**  
Engineering Associates, Inc.  
1138 Columbus Street      Ottawa, Illinois 61350  
(615) 433-2080      FAX (615) 433-3930  
Design Firm License: Illinois 184-000816  
Copyright 2011 By McClure Engineering Associates, Inc.

REVISIONS	
NAME	DATE
KED	11/5/12

**CROSSWALK PLAN SHEET**

SCALE: AS NOTED      DRAWN BY: KED  
DATE: 2011      CHECKED BY: SMK  
FILE: G:\Drawings\Manana\10-000-Sw-Revise\14 PS 9.dwg

CONTRACT NO.	SECTION	COUNTY	TOTAL SHEETS	SHEET NO.
89585	*	MARSHALL COUNTY	16	15
SECTION 10-0001-00-SW		ILLINOIS		

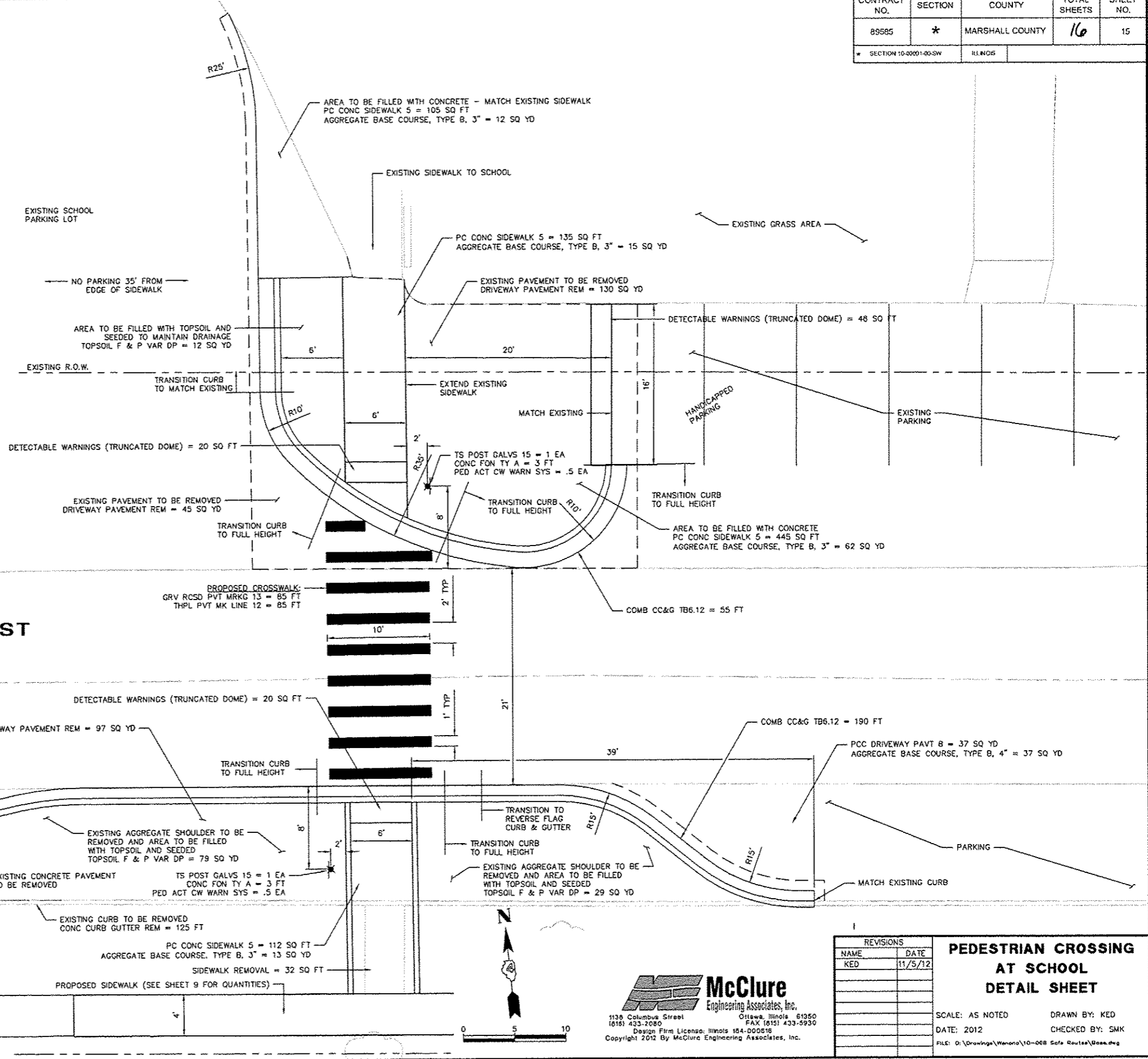
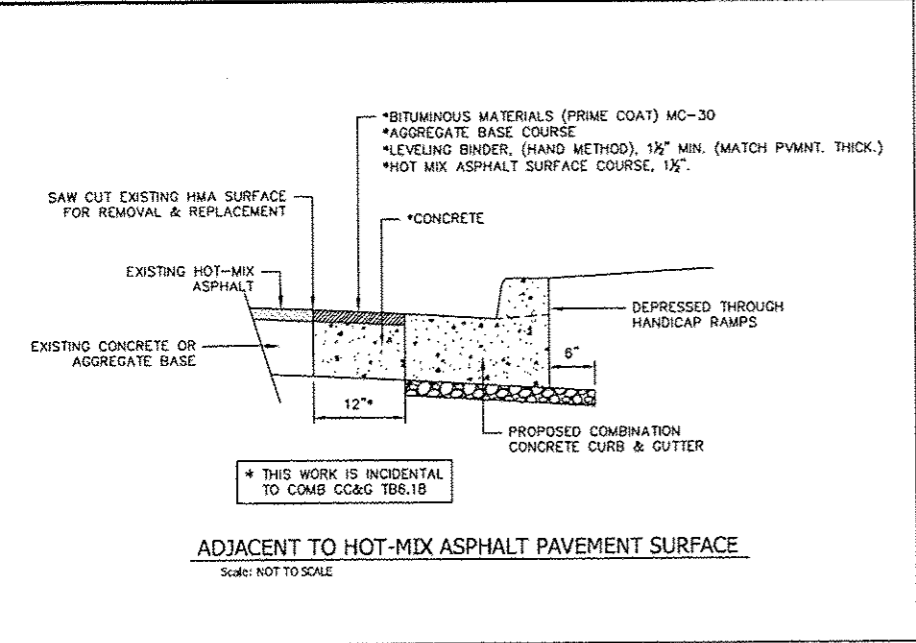

WALNUT ST

ELM ST

**PEDESTRIAN CROSSING AT SCHOOL DETAIL SHEET**

REVISIONS	
NAME	DATE
KED	11/5/12

SCALE: AS NOTED  
 DATE: 2012  
 FILE: D:\Drawings\Wanona\10-008 Safe Routes\Bose.dwg

DRAWN BY: KED  
 CHECKED BY: SMK

**McClure**  
 Engineering Associates, Inc.  
 1138 Columbia Street  
 16161 433-2080  
 Design Firm License: Illinois 164-000618  
 Copyright 2012 By McClure Engineering Associates, Inc.

CONTRACT NO.	SECTION	COUNTY	TOTAL SHEETS	SHEET NO.
89585	*	MARSHALL COUNTY	16	16
SECTION 10-00001-00-SW		ILLINOIS		

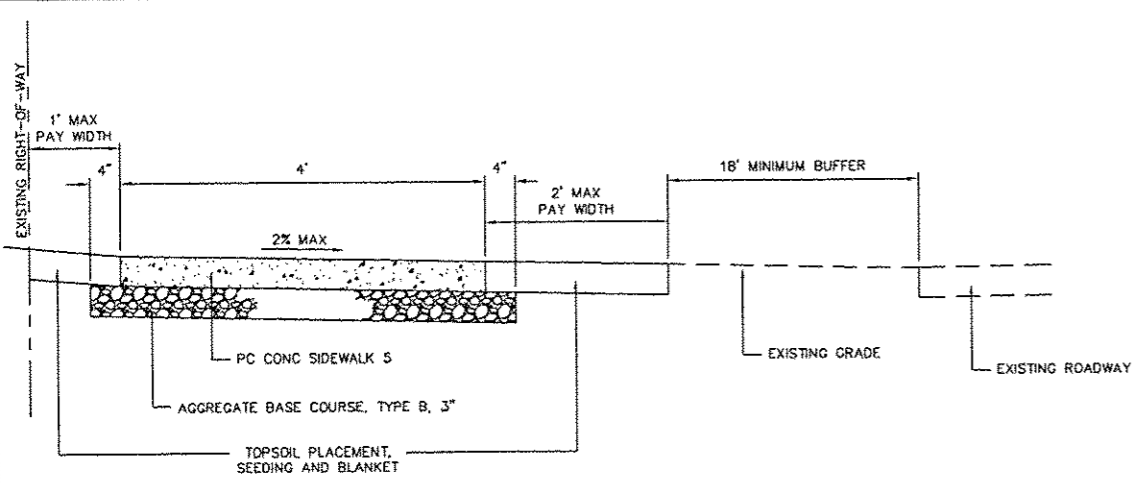

1 PROPOSED SIDEWALK DETAIL - PINE STREET  
Scale: NOT TO SCALE

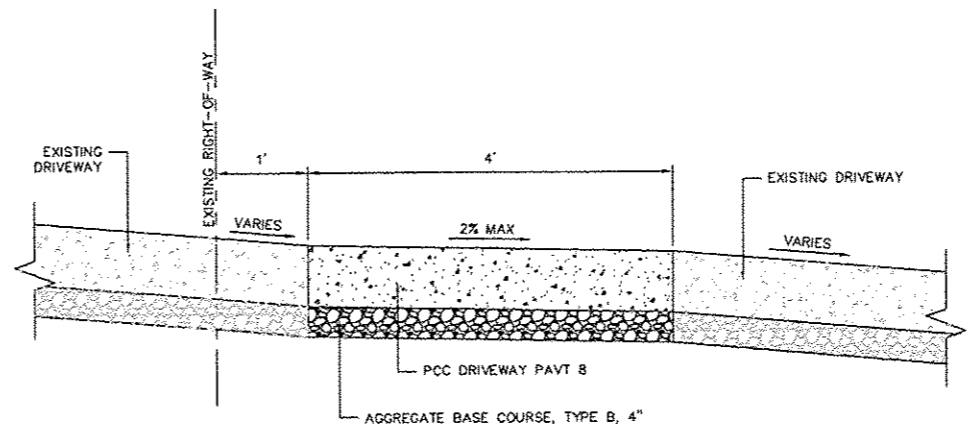

2 PROPOSED SIDEWALK @ DRIVEWAY DETAIL  
Scale: NOT TO SCALE

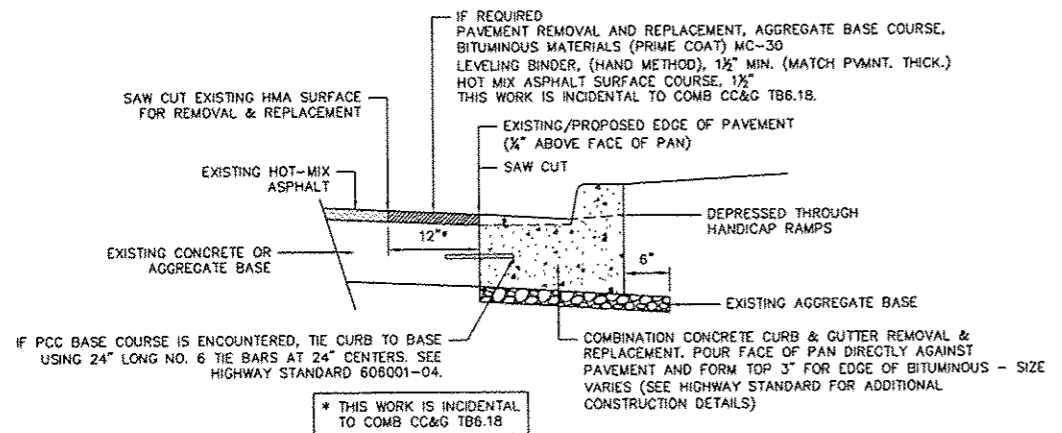

ADJACENT TO HOT-MIX ASPHALT PAVEMENT SURFACE  
Scale: NOT TO SCALE

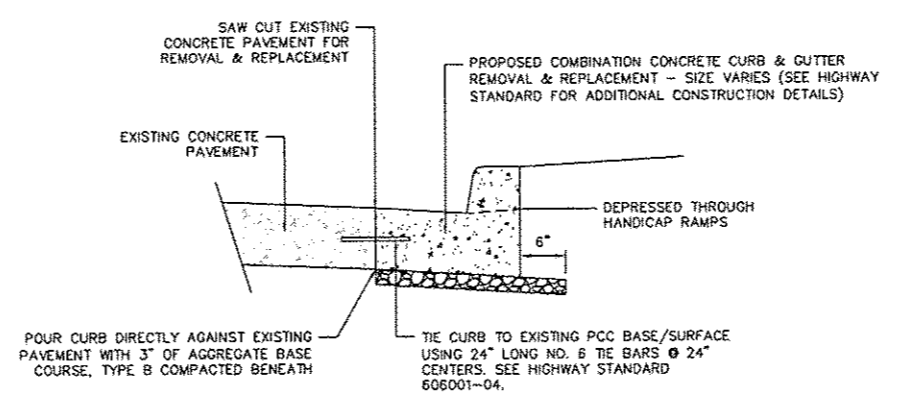

ADJACENT TO PC CONCRETE SURFACE/BASE  
Scale: NOT TO SCALE

3 COMBINATION CONCRETE CURB & GUTTER REMOVAL & REPLACEMENT DETAIL  
Scale: NOT TO SCALE

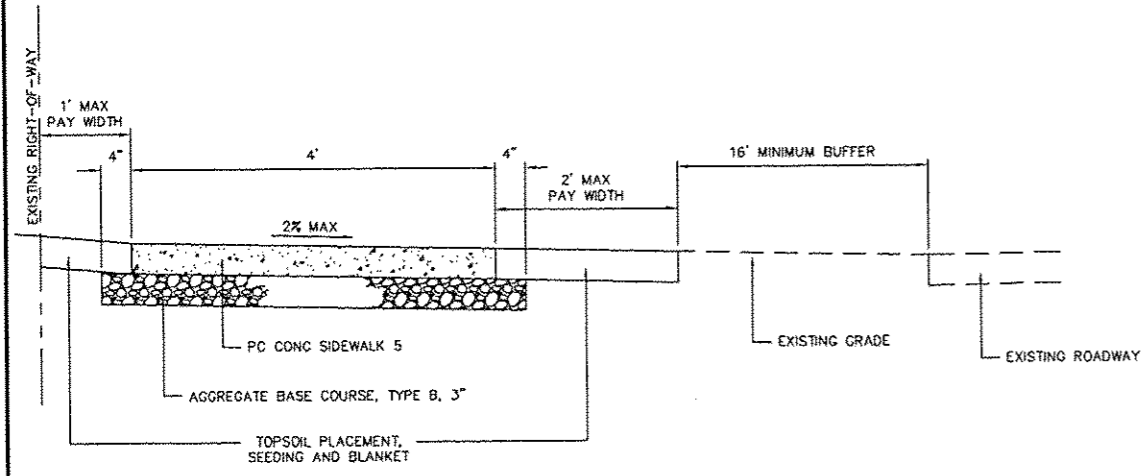

5 PROPOSED SIDEWALK DETAIL - ELM STREET  
Scale: NOT TO SCALE

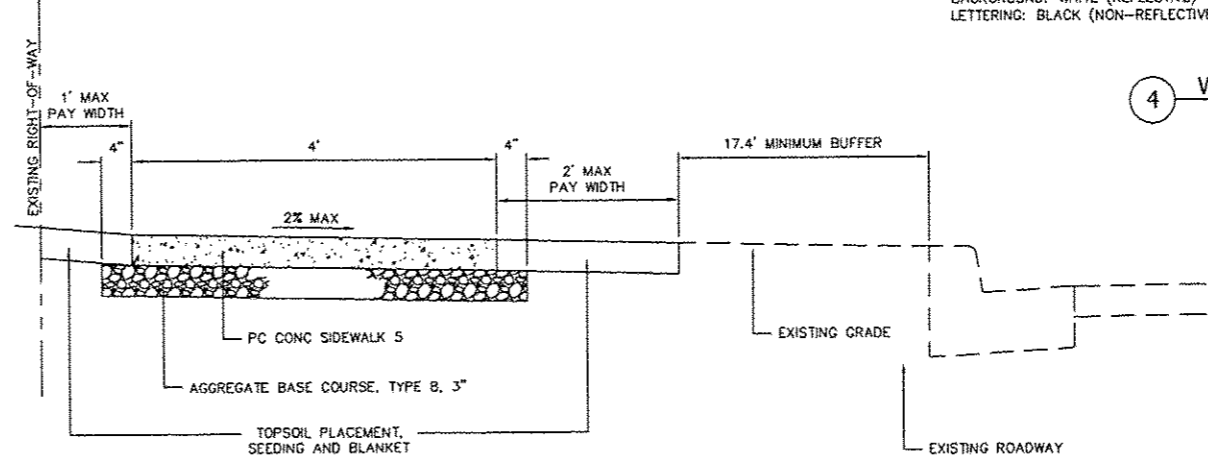

6 PROPOSED SIDEWALK DETAIL - WALNUT STREET  
Scale: NOT TO SCALE

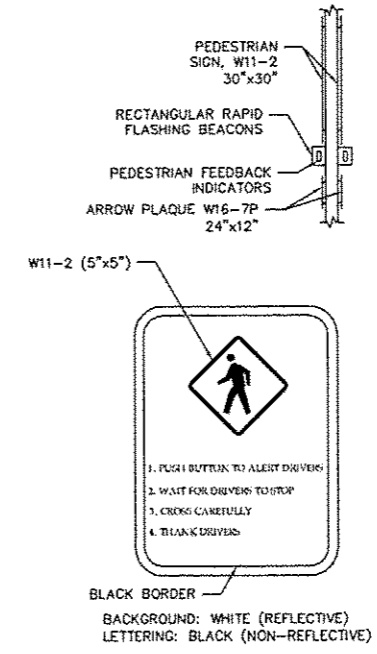

4 PEDESTRIAN ACTIVATED CROSSWALK WARNING SYSTEM RRF8 ASSEMBLY DETAIL  
Scale: NOT TO SCALE

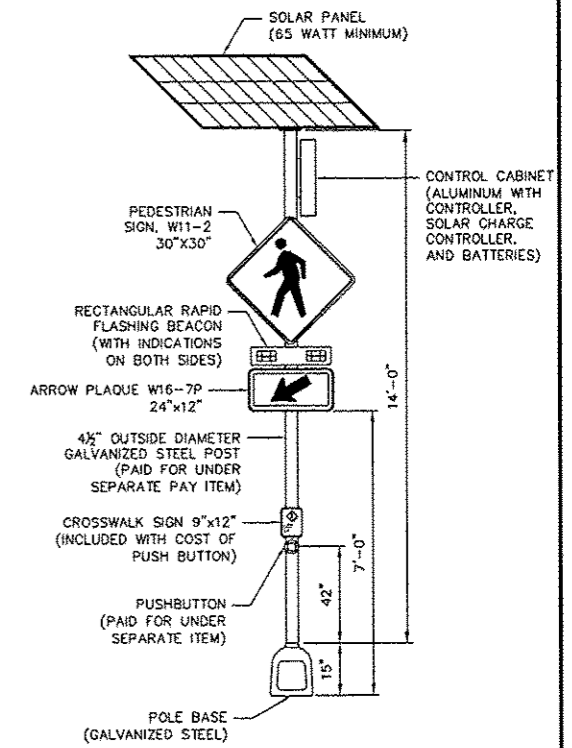

REVISIONS	
NAME	DATE
KED	11/5/12

DETAILS

SCALE: AS NOTED  
DATE: 2011  
FILE: O:\Drawings\Marshall\10-0001-00-SW Safe Routes\16 DETAILS.dwg  
DRAWN BY: KED  
CHECKED BY: SMK

**McClure**  
Engineering Associates, Inc.  
1136 Columbus Street  
Ottawa, Illinois 61350  
(615) 433-2050 FAX (615) 433-5930  
Design Firm License: Illinois 184-000818  
Copyright 2011 By McClure Engineering Associates, Inc.