



**CORPORATE OFFICE**  
 4940 OLD COLLINSVILLE RD.  
 SWANSEA, ILLINOIS 62226  
 TEL (618) 624-4488  
 FAX (618) 624-6688  
 corp@twm-inc.com  
 **WATERLOO OFFICE**  
 113 SOUTH MAIN STREET  
 WATERLOO, ILLINOIS 62298  
 TEL (618) 939-5050  
 FAX (618) 939-3938  
 waterloo@twm-inc.com  
 **ST. LOUIS OFFICE**  
 1001 CRAIG ROAD, SUITE 260  
 ST. LOUIS, MISSOURI 63146  
 TEL (314) 236-5052  
 FAX (314) 872-2194  
 stlouis@twm-inc.com

PROFESSIONAL REGISTRATIONS	LICENSE NO.
ILLINOIS PROFESSIONAL DESIGN FIRM	184-001220
PROFESSIONAL ENGINEERING CORP.	62-035370
PROFESSIONAL STRUCTURAL ENGR. CORP.	61-005202
ILLINOIS PROF. LAND SURVEYING CORP.	049-000029
MISSOURI PROFESSIONAL ENGR. CORP.	NC 001528
MISSOURI LAND SURVEYING CORP.	NC 003346

SEAL

This Professional Service conforms to the current Illinois Minimum Standards for a Boundary Survey

Signature: \_\_\_\_\_  
 Signature Date: \_\_\_\_\_  
 Expiration Date: \_\_\_\_\_

**STATEMENT OF RESPONSIBILITY**  
 I hereby confirm that the document herein to be authorized by my seal is restricted to this sheet, and I hereby disclaim any responsibility for all other drawings, specifications, estimates, reports or other documents or instruments relating to or intended to be utilized for any other part of the architectural, engineering or survey project.

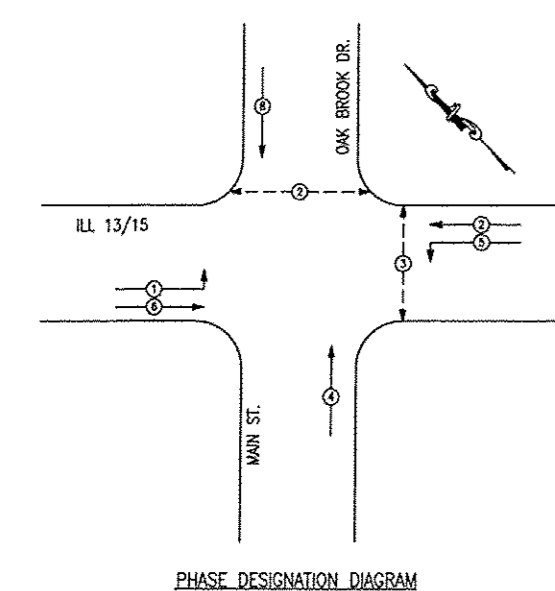
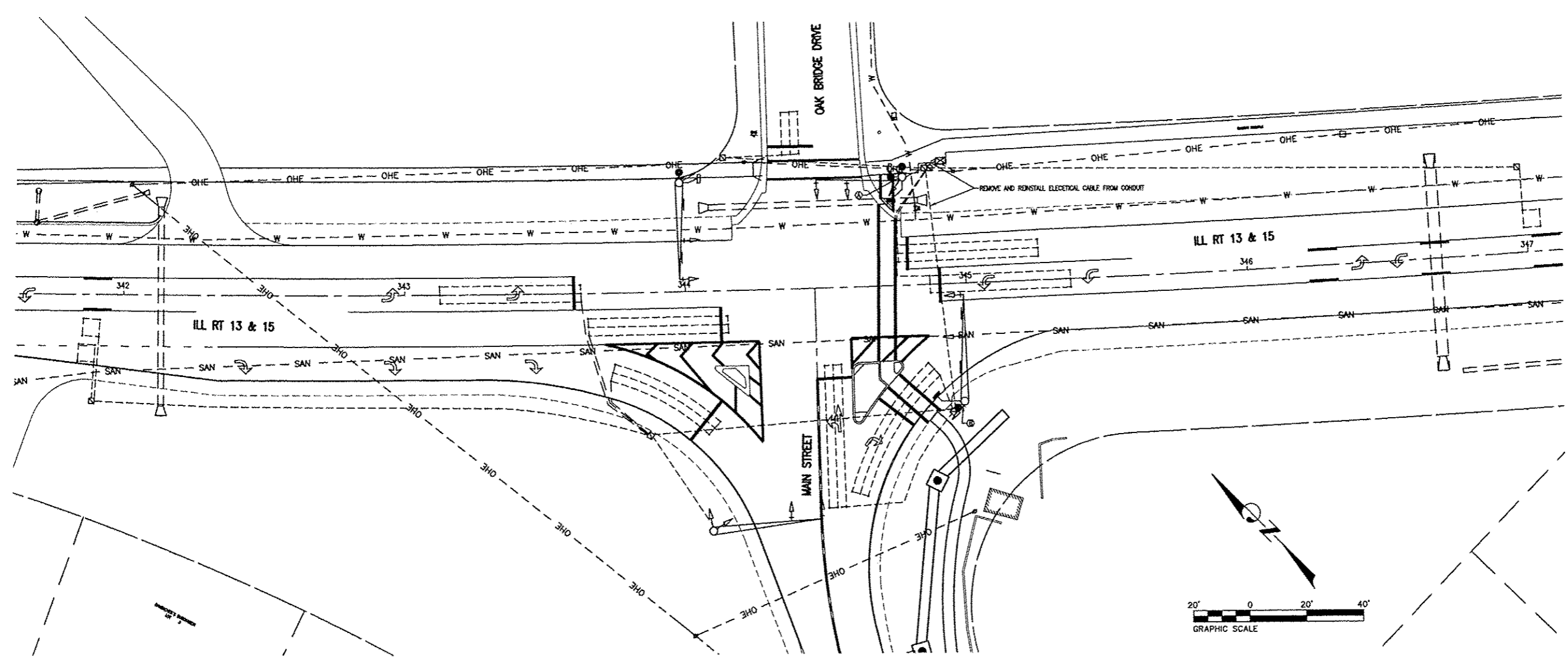

EXISTING SEQUENCE OF OPERATION								
PHASE	1	2	3	4	5	6	7	8
MOVEMENT	←	←	NOT USED	↑	↑	→	NOT USED	↓
CONCURRENT MOVEMENT	5 OR 6	5 OR 6		8	1 OR 2	1 OR 2		4

\* PEDESTRIAN INTERVAL PUSHBUTTON ACTIVATED

PROPOSED SEQUENCE OF OPERATION								
PHASE	1	2	3	4	5	6	7	8
MOVEMENT	←	←	↑	↑	→	→	NOT USED	↓
CONCURRENT MOVEMENT	5 OR 6	5 OR 6	NONE	8	1 OR 2	1 OR 2		4

\* PEDESTRIAN INTERVAL PUSHBUTTON ACTIVATED

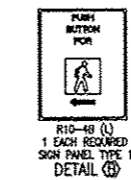
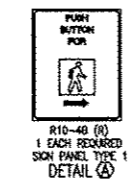
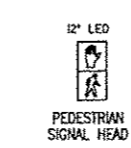

- NOTES**
- ALL PEDESTRIAN SIGNAL HEADS SHALL BE POLYCARBONATE AND SHALL HAVE 12" LED SECTIONS. ALL MOUNTING HARDWARE, SIGNAL POSTS, AND BASES SHALL BE ALUMINUM. ALL BOLTS, SCREWS, NUTS, AND WASHERS SHALL BE STAINLESS STEEL. ANTI-SEIZE PASTE COMPOUND SHALL BE USED ON ALL MOUNTING HARDWARE FIELD CONNECTIONS.
  - ALL TRAFFIC SIGNAL CABLES SHALL BE #14 AWG STRANDED COPPER UNLESS OTHERWISE SPECIFIED.
  - ALL HANDHOLES SHALL BE CAST-IN-PLACE PORTLAND CEMENT CONCRETE (PER ARTICLE 814.03(B)). THE CAST-IN-PLACE LEGEND ON THE COVER SHALL BE "TRAFFIC SIGNALS". SLOPE HANDHOLE COVERS TO MATCH PROPOSED GRADE ELEVATIONS.

**STANDARDS**  
720001  
880006

- EXISTING SIGNAL LEGEND**
- HANDHOLE
  - DOUBLE HANDHOLE
  - DETECTOR LOOP
  - CONTROLLER
  - PEDESTRIAN PUSHBUTTON DETECTOR
  - SIGNAL HEAD, PEDESTRIAN
  - SERVICE INSTALLATION
  - SIGNAL HEAD, POST MOUNTED
  - SIGNAL HEAD WITH BACKPLATE, MAST ARM MOUNTED
  - UNDERGROUND CONDUIT

- PROPOSED SIGNAL LEGEND**
- PEDESTRIAN PUSHBUTTON DETECTOR
  - SIGNAL HEAD, PEDESTRIAN

SECTION 10-00023-00-SW  
TRAFFIC SIGNALS MODIFICATIONS

SAFE ROUTES TO SCHOOL  
SIDEWALK IMPROVEMENTS  
VILLAGE OF FREEBURG  
ST. CLAIR COUNTY, ILLINOIS

REV.	DATE	DESCRIPTION
△		
△		
△		

DRAWN BY: RPM	SHEET
DESIGNED BY: BLR	12
CHECKED BY:	OF 17 SHEETS
APPROVED BY:	
PROJECT NUMBER: D01100115	
<input checked="" type="checkbox"/> ISSUED FOR REVIEW	<input type="checkbox"/> ISSUED FOR BIDDING
<input type="checkbox"/> ISSUED FOR CONSTR.	<input type="checkbox"/> RECORD DRAWING