

STANDARDS

01-19-2018 LETTING ITEM 027

1. COVER SHEET
2. GENERAL NOTES
3. SUMMARY OF QUANTITIES
4. TYPICAL SECTIONS
5. SCHEDULES
- 6 - 7. EXISTING STRUCTURE PLANS

STATE OF ILLINOIS
DEPARTMENT OF TRANSPORTATION

PROPOSED HIGHWAY PLANS

**F.A.P. ROUTE 46 (IL 251)
SECTION (1BD)BC,BDS
PROJECT NHPP-R1PC(818)
BRIDGE WASHING AND CONCRETE SEALING
LASALLE COUNTY**

C-93-027-18

F.A.P. RTE.	SECTION	COUNTY	TOTAL SHEETS	SHEET NO.
46	(1BD)BC,BDS	LASALLE	16	1
ILLINOIS			CONTRACT NO. 66H90	

STANDARDS

- | | |
|-----------|--|
| 000001-06 | STANDARD SYMBOLS, ABBREVIATIONS AND PATTERNS |
| 091006 | DECIMAL OF AN INCH AND OF A FOOT |
| 701006-05 | OFF-ROAD OPERATIONS 2L, 2W, 15' (4.5 m) TO 24' (600 mm) FROM PAVEMENT EDGE |
| 701101-05 | OFF-ROAD OPERATIONS, MULTILANE, 15' (4.5 m) TO 24' (600 mm) FROM PAVEMENT EDGE |
| 701106-02 | OFF-ROAD OPERATIONS, MULTILANE, MORE THAN 15' (4.5 m) AWAY |
| 701601-09 | URBAN LANE CLOSURE, MULTILANE, 1W OR 2W WITH NONTRAVERSABLE MEDIAN |
| 701602-09 | URBAN LANE CLOSURE, MULTILANE, 2W WITH BIDIRECTIONAL LEFT TURN LANE |
| 701901-07 | TRAFFIC CONTROL DEVICES |

PROJECT LOCATION

**STRUCTURE NO. 050-0079
CARRYING FAP ROUTE 46 (IL 251)
OVER THE ILLINOIS RIVER, WATER STREET,
CXS, BALTIMORE AND OHIO RAILROADS
APPROXIMATELY 0.26 MILES SOUTH OF US 6 IN PERU**

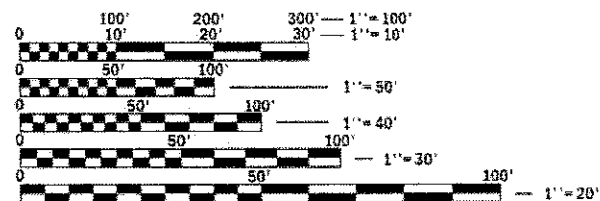

FULL SIZE PLANS HAVE BEEN PREPARED USING STANDARD ENGINEERING SCALES. REDUCED SIZED PLANS WILL NOT CONFORM TO STANDARD SCALES. IN MAKING MEASUREMENTS ON REDUCED PLANS, THE ABOVE SCALES MAY BE USED.

J.U.L.I.E.
JOINT UTILITY LOCATION INFORMATION FOR EXCAVATION
1-800-892-0123
OR 811

**PROJECT ENGINEER: JOE KANNEL P.E.
UNIT CHIEF: RON WOODSHANK
DISTRICT NO. 3 (815) 434-6131
CONTRACT NO. 66H90**

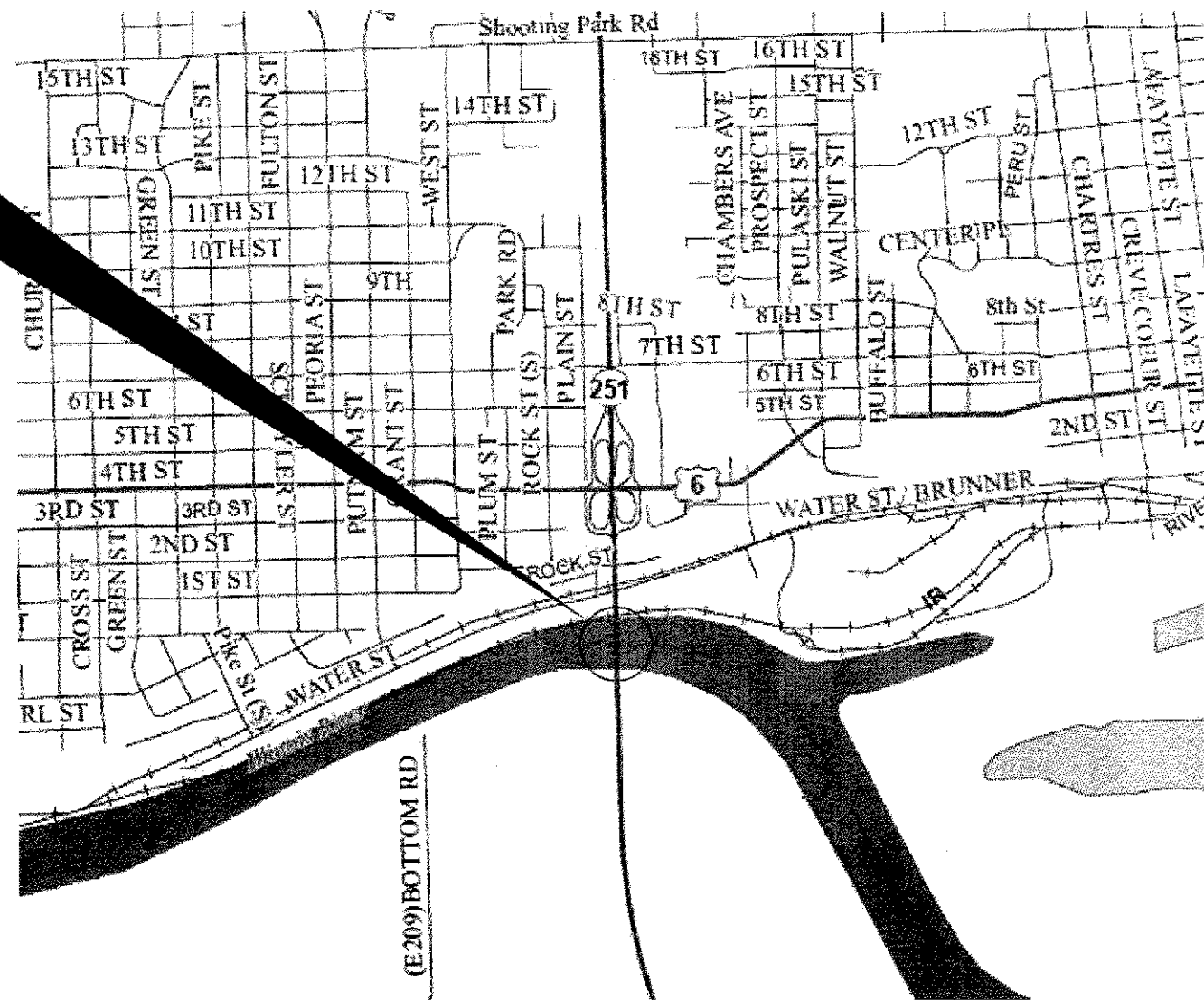

GROSS LENGTH = 2292 FT. = 0.43 MILE
NET LENGTH = 2292 FT. = 0.43 MILE

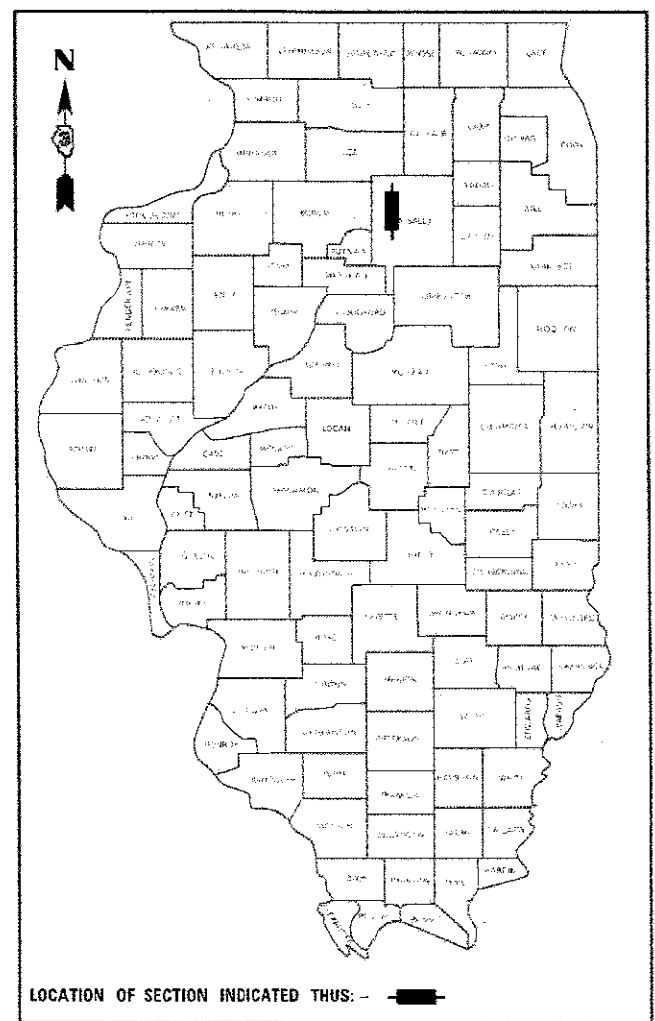

FUNCTIONAL CLASSIFICATION
URBAN OTHER ARTERIAL
F.A.P. ROUTE 46 (IL 251)
2015 ADT 7250
P.V. 85.2% S.U. 11.0% M.U. 3.8%

STATE OF ILLINOIS
DEPARTMENT OF TRANSPORTATION

SUBMITTED *Oct 17 2017*
March
REGIONAL ENGINEER

Nov 30 2017
Harmon M. Addis
ENGINEER OF DESIGN AND ENVIRONMENT

Nov 30 2017
David Allen
DIRECTOR OF PROGRAM DEVELOPMENT

**PRINTED BY THE AUTHORITY
OF THE STATE OF ILLINOIS**

GENERAL NOTES

FOR STABILIZATION, ALL TYPE III BARRICADES WILL REQUIRE A MINIMUM OF FOUR SAND BAGS PER BARRICADE.

ANY REFERENCE TO A STANDARD IN THESE PLANS SHALL BE INTERPRETED TO MEAN THE EDITION AS INDICATED BY THE SUBNUMBER SHOWN IN THE LIST OF STANDARDS OR THE COPY INCLUDED IN THESE PLANS.

THE FOLLOWING RATES OF APPLICATION HAVE BEEN USED IN CALCULATING PLAN QUANTITIES:

COMMITMENTS

STATE OF ILLINOIS
DEPARTMENT OF TRANSPORTATION
DISTRICT THREE
AS BUILT INFORMATION

SUPERVISING CONSTRUCTION FIELD ENGINEER

RESIDENT ENGINEER / TECHNICIAN

START & END DATES
OF CONSTRUCTION:

INSPECTORS:

STATE OF ILLINOIS
DEPARTMENT OF TRANSPORTATION
DISTRICT THREE

REVIEWED BY: David Briviale
DISTRICT STUDIES & PLANS ENGINEER

DATE: 10/12/17

EXAMINED BY: [Signature]
DISTRICT CONSTRUCTION ENGINEER

Michael A. Short
DISTRICT MATERIALS ENGINEER

[Signature]
DISTRICT OPERATIONS ENGINEER

STATE OF ILLINOIS
DEPARTMENT OF TRANSPORTATION

GENERAL NOTES

SCALE: SHEET 1 OF 1 SHEETS STA. TO STA.

F.A.P. RTE.	SECTION	COUNTY	TOTAL SHEETS	SHEET NO.
46	(18D)8C.BDS	LASALLE	16	2
CONTRACT NO. 66H90			ILLINOIS FED. AID PROJECT	

I:\Projects\66H90\Drawings\66H90-18D\8C.BDS\66H90-18D-8C.BDS.dwg
 PLOT DATE: 9/28/2017 10:48:11 AM
 USER: woodstark1

URBAN

CODE NO.	ITEM	UNIT	TOTAL QUANTITY	CONSTR. CODE
				MBPM 80%FED 20%STATE BRIDGE 0047 S.N. 050-0079
X5870015	BRIDGE DECK CONCRETE SEALER	SQ FT	95125	95125
59200101	BRIDGE WASHING NO. 1	EACH	1	1
67100100	MOBILIZATION	L SUM	1	1
70102630	TRAFFIC CONTROL AND PROTECTION, STANDARD 701601	L SUM	1	1
70102632	TRAFFIC CONTROL AND PROTECTION, STANDARD 701602	L SUM	1	1
Z0030850	TEMPORARY INFORMATION SIGNING	SQ FT	42	42

MODEL: Default
FILE NAME: F:\MUL\064848\BID\ITEG Illinois.gov\PI\DOT\Documents\DOT Office\District 3\projects\036648\BC\ADD\2016\036648-036648.dgn

USER NAME = petersonec	DESIGNED - RW	REVISED -
DRAWN - RW	REVISED -	
PLOT SCALE = 100,0000' / in.	CHECKED - EP	REVISED -
PLOT DATE = 10/5/2017	DATE - 9/20/2017	REVISED -

STATE OF ILLINOIS
DEPARTMENT OF TRANSPORTATION

SUMMARY OF QUANTITIES

SCALE: SHEET 1 OF 1 SHEETS STA. TO STA.

F.A.P. RTE. 46	SECTION (1BD)BC.BDS	COUNTY LASALLE	TOTAL SHEETS 16	SHEET NO. 3
CONTRACT NO. 66H90			ILLINOIS FED. AID PROJECT	

REV

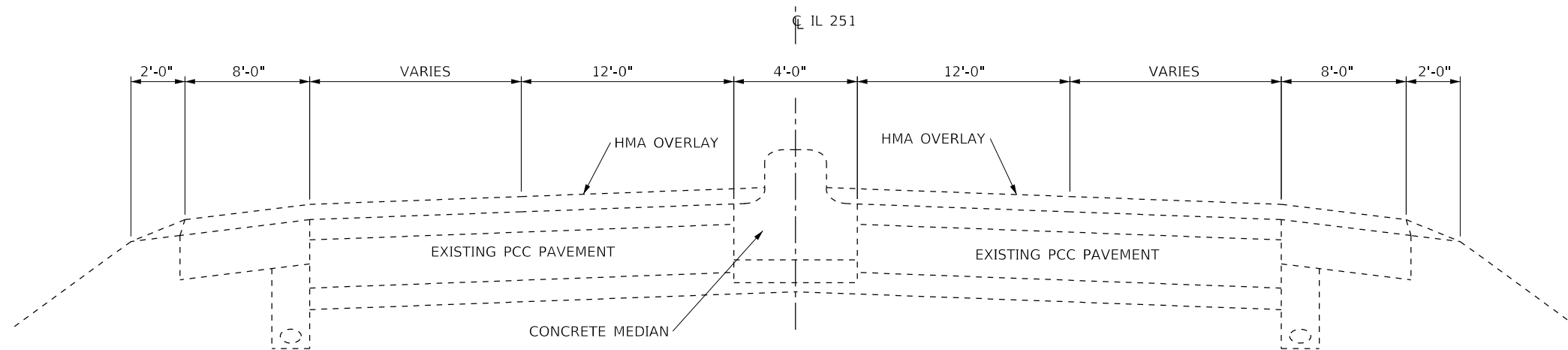

TYPICAL SECTION NO. 1
 NORTH OF RIVER
 STA. 184+00 TO STA. 193+00

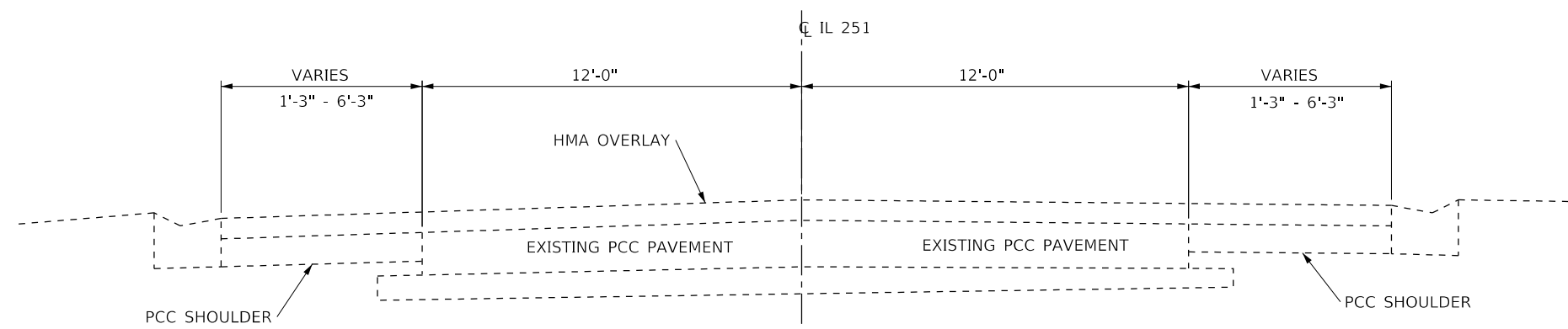

TYPICAL SECTION NO. 2
 SOUTH OF RIVER
 STA. 207+00 TO 224+00

MODEL: Default
 FILE: \\nas01.cba.uillinois.gov:PWIDOT\Documents\DOT_Offices\District 3\Projects\03366190\CADD\03366190-04etalk.dgn

USER NAME = woodshankrl	DESIGNED - RW	REVISED -
	DRAWN - RW	REVISED -
PLOT SCALE = 100.0000' / in.	CHECKED - EP	REVISED -
PLOT DATE = 9/28/2017	DATE - 9/20/2017	REVISED -

**STATE OF ILLINOIS
 DEPARTMENT OF TRANSPORTATION**

TYPICAL SECTIONS			
SCALE:	SHEET 1	OF 1 SHEETS	STA. TO STA.

F.A.P. RTE.	SECTION	COUNTY	TOTAL SHEETS	SHEET NO.
46	(1B)BC,BDS	LASALLE	16	4
CONTRACT NO. 66H90				
ILLINOIS		FED. AID PROJECT		

SCHEDULE - CONCRETE SEALER

LOCATION					CONCRETE SEALER																	
					N. ABUT.	S. ABUT.	PIER 1	PIER 2	PIER 3	PIER 4	PIER 5	PIER 6	PIER 7	PIER 8	PIER 9	PIER 10	PIER 11	PIER 12	NB PARAPET	NB DL	SB DL	SB PARAPET
					SQ FT	SQ FT	SQ FT	SQ FT	SQ FT	SQ FT	SQ FT	SQ FT	SQ FT	SQ FT	SQ FT	SQ FT	SQ FT	SQ FT	SQ FT	SQ FT	SQ FT	SQ FT
STA.	193+22.00				212																	
STA.	193+22.00	TO	STA.	193+97.83													277	1404	2095	277		
STA.	193+97.83					422																
STA.	193+97.83	TO	STA.	195+36.26													504	3390	2147	504		
STA.	195+36.26						303															
STA.	195+36.26	TO	STA.	196+75.20													507	2581	2163	507		
STA.	196+75.20							372														
STA.	196+75.20	TO	STA.	199+41.70													975	4155	4155	975		
STA.	199+41.70								276													
STA.	199+41.70	TO	STA.	204+18.30													1741	7422	7422	1741		
STA.	204+18.30									276												
STA.	204+18.30	TO	STA.	206+84.36													971	4139	4139	971		
STA.	206+84.36										417											
STA.	206+84.36	TO	STA.	208+27.38													522	2225	2225	522		
STA.	208+37.38																					
STA.	208+37.38	TO	STA.	209+69.03													518	2210	2210	518		
STA.	209+69.03																					
STA.	209+69.03	TO	STA.	211+11.35													518	2210	2210	518		
STA.	211+11.35																					
STA.	211+11.35	TO	STA.	212+53.89													522	2225	2225	522		
STA.	212+53.89																					
STA.	212+53.89	TO	STA.	213+95.52													518	2210	2210	518		
STA.	213+95.52																					
STA.	213+95.52	TO	STA.	215+37.75													518	2210	2210	518		
STA.	215+37.75																					
STA.	215+37.75	TO	STA.	216+13.82													277	1183	1183	277		
STA.	216+13.82																					
SUBTOTAL					212	130	422	303	372	276	276	417	359	315	144	280	223	502	8368	37564	36594	8368
TOTAL					95125																	

MODEL: Default
 FILE: \\nas01c.pva\ill08\EBID\NTEC\Illinois.gov\RW\DOT\Documents\DOT_Offices\Director_3\Projects\0366190\CADD\0366190-04-04-17.dgn

USER NAME = petersonc	DESIGNED - RW	REVISED -
	DRAWN - RW	REVISED -
PLOT SCALE = 100.0000' / in.	CHECKED - EP	REVISED -
PLOT DATE = 10/5/2017	DATE - 9/20/2017	REVISED -

STATE OF ILLINOIS
 DEPARTMENT OF TRANSPORTATION

SCALE:		SHEET 1	OF 1	SHEETS	STA.	TO STA.
--------	--	---------	------	--------	------	---------

F.A.P. RTE.	SECTION	COUNTY	TOTAL SHEETS	SHEET NO.
46	(1BD)BC,BDS	LASALLE	16	5
			CONTRACT NO. 66H90	
		ILLINOIS	FED. AID PROJECT	

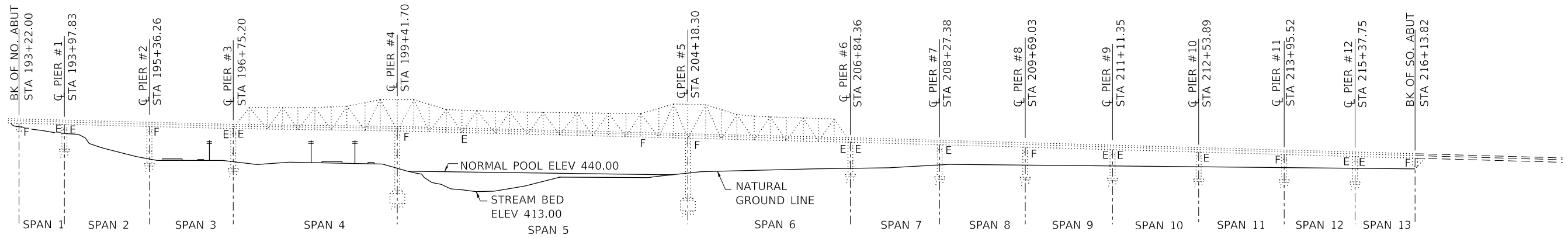

ELEVATION

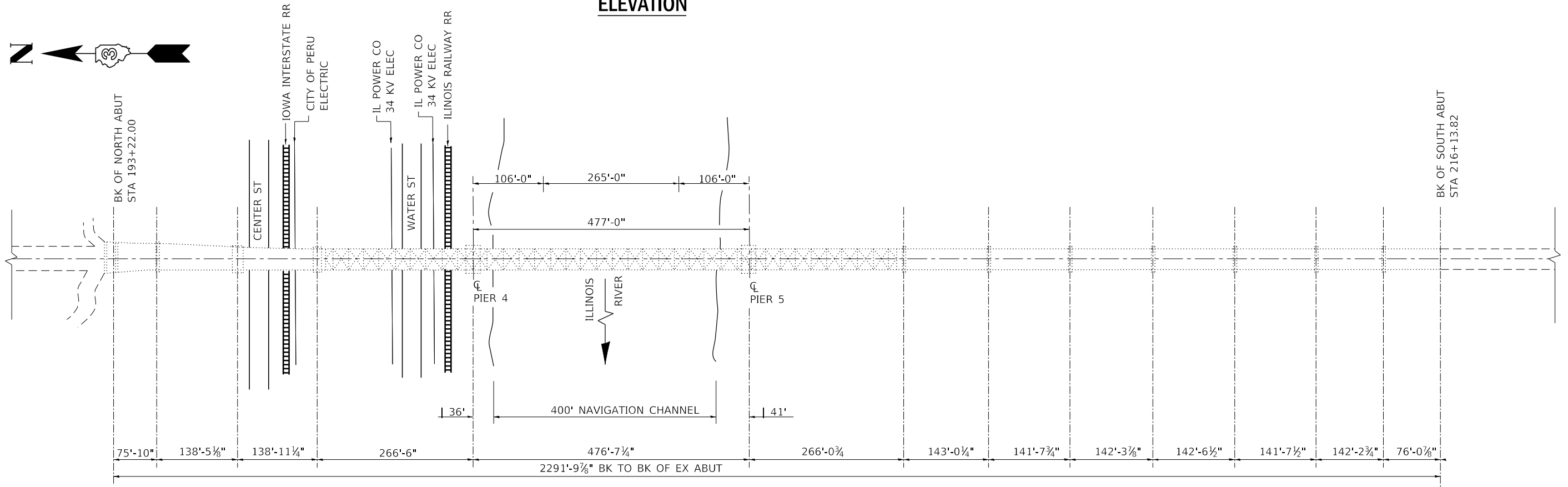

**PLAN
STRUCTURE NO. 050-0079**

MODEL: Default
FILE NAME: P:\1108\B&E\ID\ITC\Illinois.gov\PIV\DOT\Documents\1\DOT Office\1\10366190\CADD\10366190-00-000.dgn

USER NAME = petersonc	DESIGNED - RW	REVISED -
	DRAWN - RW	REVISED -
PLOT SCALE = 100,0000' / in.	CHECKED - EP	REVISED -
PLOT DATE = 10/5/2017	DATE - 9/20/2017	REVISED -

**STATE OF ILLINOIS
DEPARTMENT OF TRANSPORTATION**

**EXISTING STRUCTURE PLANS
GENERAL PLAN AND ELEVATION**

SCALE: SHEET 1 OF 11 SHEETS STA. TO STA.

F.A.P. RTE. 46	SECTION (1BD)BC,BDS	COUNTY LASALLE	TOTAL SHEETS 16	SHEET NO. 6
CONTRACT NO. 66H90				
ILLINOIS FED. AID PROJECT				

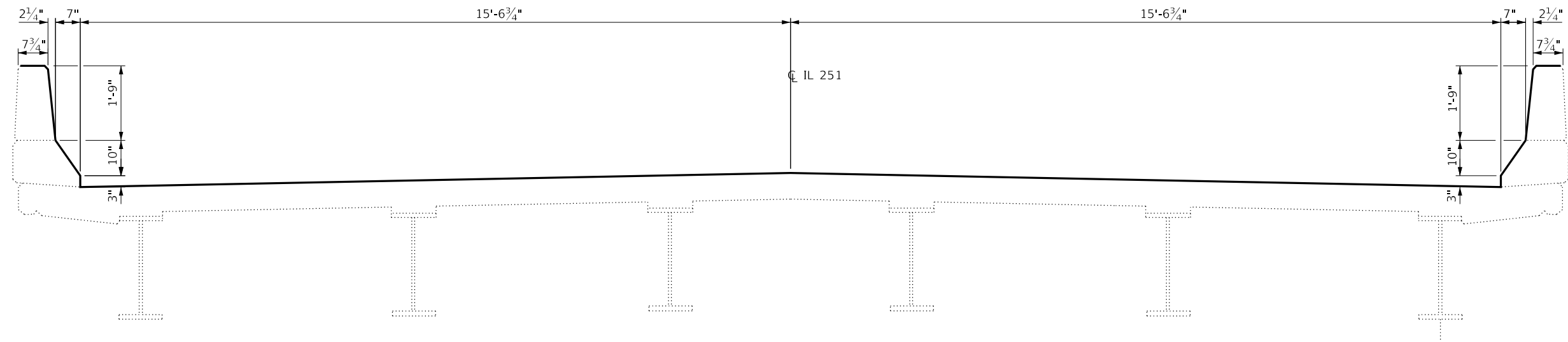

CROSS SECTION - SPAN 4 THRU 6

(LOOKING SOUTH)
STA. 196+75.20 TO STA. 206+84.36

————— CONCRETE SEALER

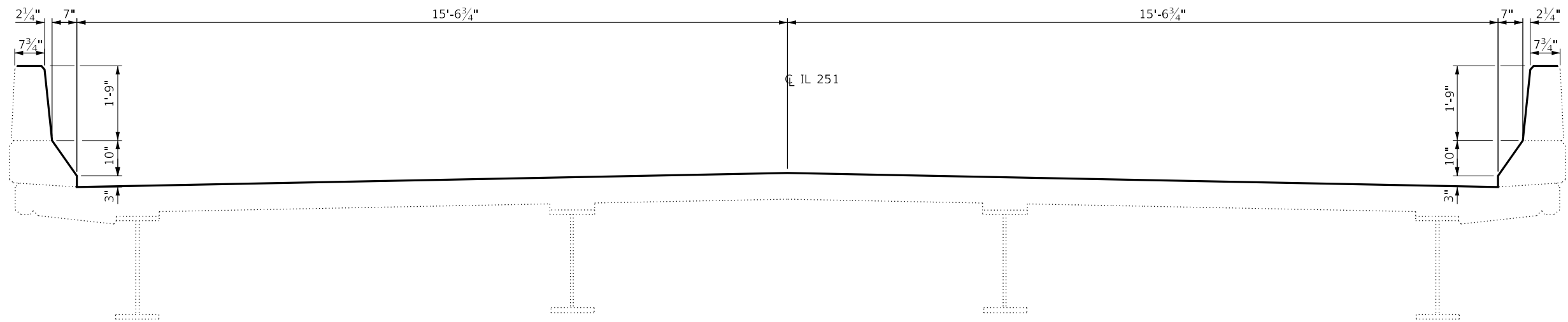

CROSS SECTION - SPAN 7 THRU 13

(LOOKING SOUTH)
STA. 206+84.36 TO STA. 216+13.82

MODEL: Default
FILE: \\nas01c.psu.edu\BID\NTEC\Illinois\gov\PWD\DOT\Documents\18DOT\Office\18ierct\3\Projects\0366190\CADD\0366190-04-rev11.dgn

USER NAME = petersonec	DESIGNED - RW	REVISED -
	DRAWN - RW	REVISED -
PLOT SCALE = 100.0000' / in.	CHECKED - EP	REVISED -
PLOT DATE = 10/5/2017	DATE - 9/20/2017	REVISED -

**STATE OF ILLINOIS
DEPARTMENT OF TRANSPORTATION**

**EXISTING STRUCTURE PLANS
SUPERSTRUCTURE**

SCALE: SHEET 3 OF 11 SHEETS STA. TO STA.

F.A.P. RTE.	SECTION	COUNTY	TOTAL SHEETS	SHEET NO.
46	(1B)BC,BDS	LASALLE	16	8
CONTRACT NO. 66H90				
ILLINOIS FED. AID PROJECT				

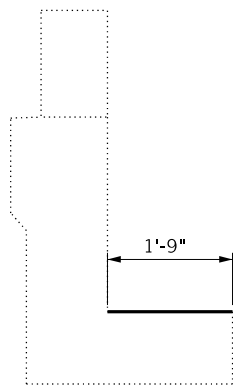

SECTION THRU ABUT.

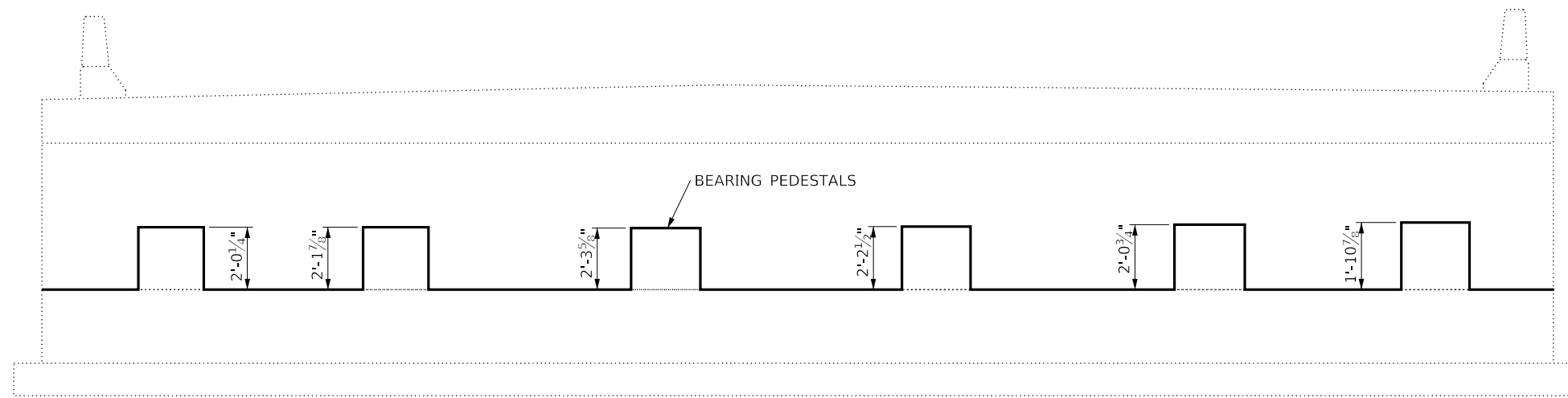

ELEVATION

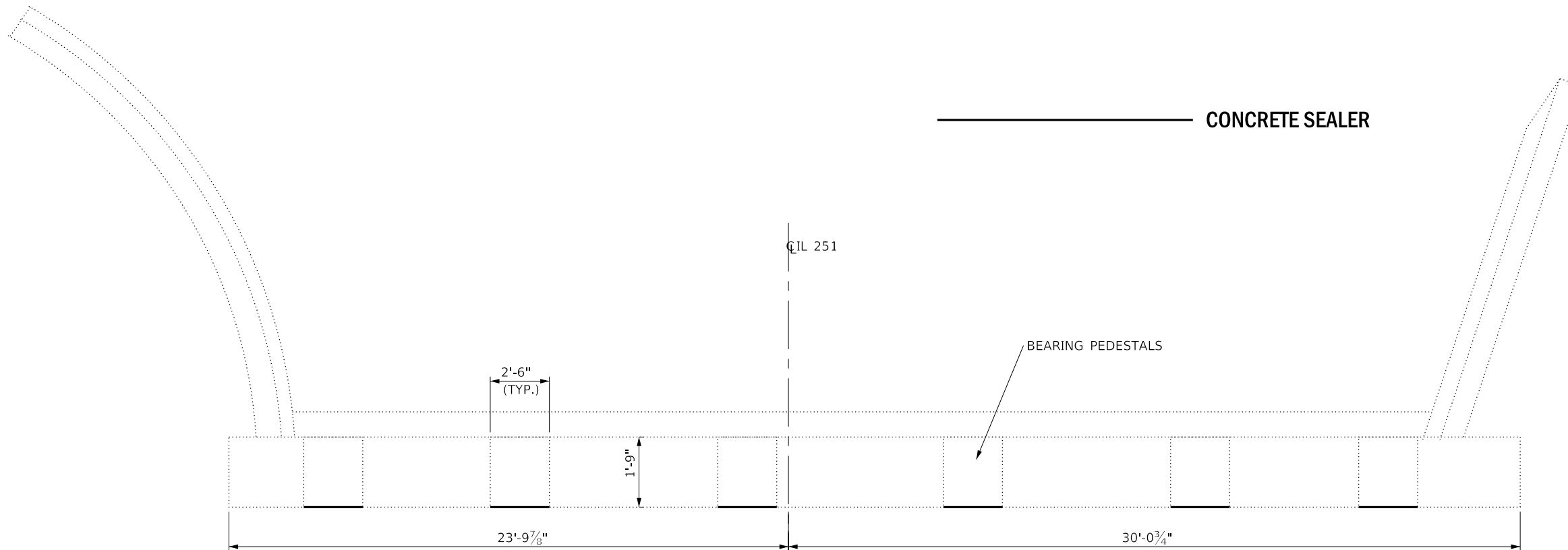

**PLAN
NORTH ABUTMENT**

MODEL: Default
 FILE NAME: P:\1108\B&E\BIDD\ITEC\Illinois\pwr\PIW\DOT\Documents\1\DOT Office\1\Dirct 3\Projects\0366190\CADD\0366190-crete\11.dgn

USER NAME = petersonec	DESIGNED - RW	REVISED -
	DRAWN - RW	REVISED -
PLOT SCALE = 100.0000' / in.	CHECKED - EP	REVISED -
PLOT DATE = 10/5/2017	DATE - 9/20/2017	REVISED -

**STATE OF ILLINOIS
DEPARTMENT OF TRANSPORTATION**

**EXISTING STRUCTURE PLANS
NORTH ABUTMENT**

SCALE: SHEET 4 OF 11 SHEETS STA. TO STA.

F.A.P. RTE.	SECTION	COUNTY	TOTAL SHEETS	SHEET NO.
46	(1B)BC,BDS	LASALLE	16	9
CONTRACT NO. 66H90				
ILLINOIS FED. AID PROJECT				

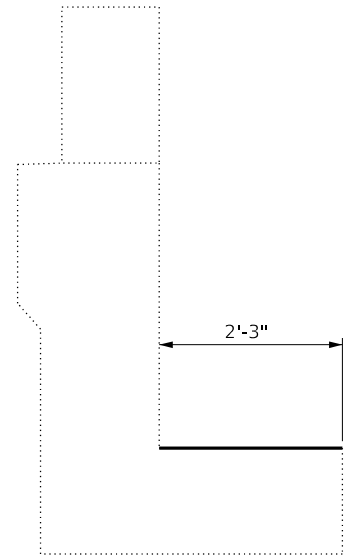

SECTION THRU ABUT.

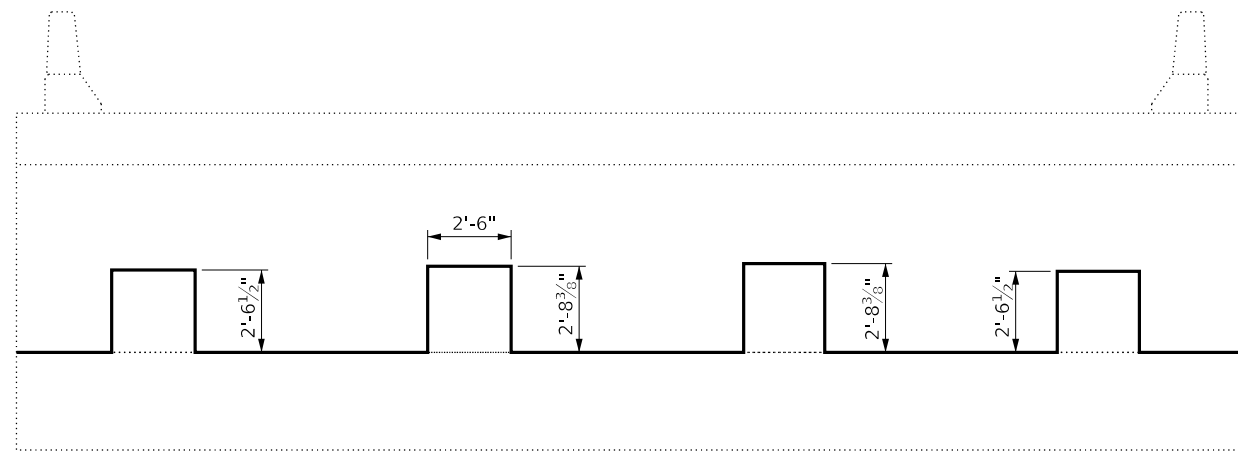

ELEVATION

————— CONCRETE SEALER

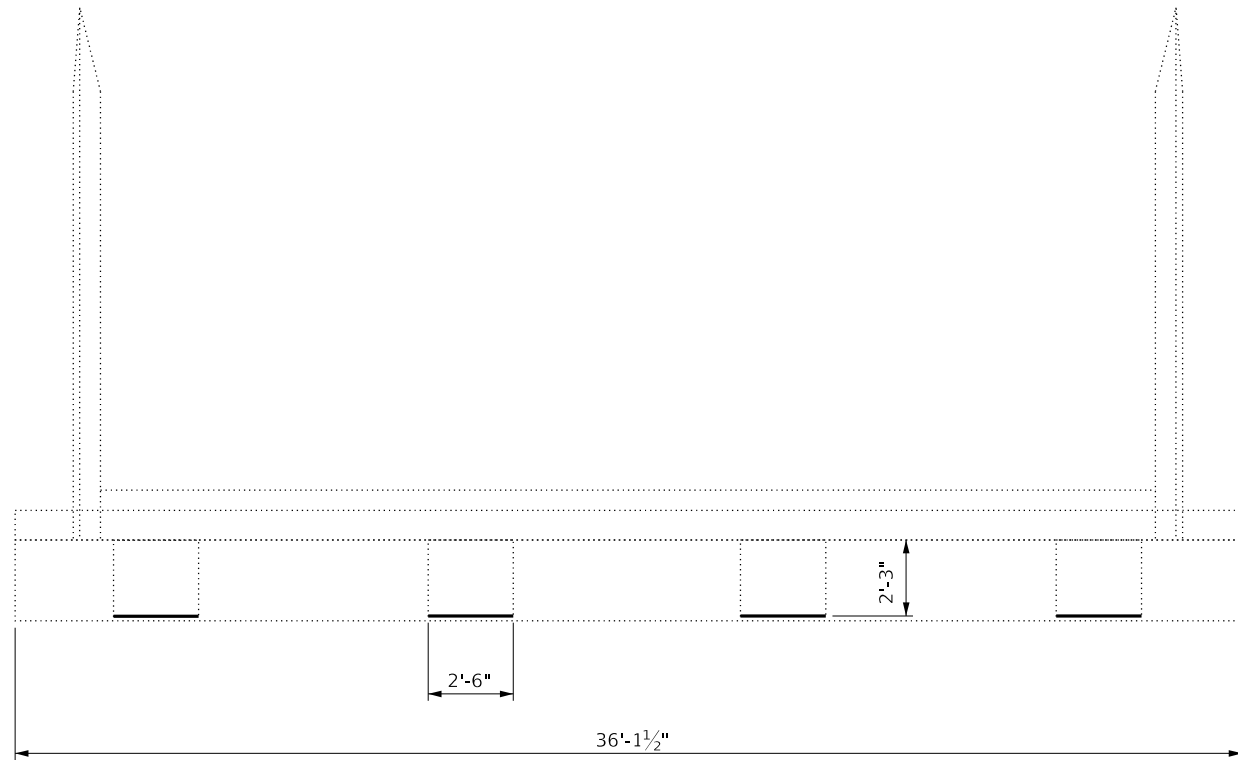

**PLAN
SOUTH ABUTMENT**

MODEL: Default
 FILE NAME: P:\1108\B&E\BID\ITEC\Illinois\pwr\WIDOT\Documents\BID\Office\BID\BID.ctb
 PROJECT: 0366190\CADD\BID\0366190-cretealk.dgn

USER NAME = woodshankr1	DESIGNED - RW	REVISED -
	DRAWN - RW	REVISED -
PLOT SCALE = 100.0000 ' / in.	CHECKED - EP	REVISED -
PLOT DATE = 9/28/2017	DATE - 9/20/2017	REVISED -

**STATE OF ILLINOIS
DEPARTMENT OF TRANSPORTATION**

**EXISTING STRUCTURE PLANS
SOUTH ABUTMENT**

SCALE: SHEET 5 OF 11 SHEETS STA. TO STA.

F.A.P. RTE.	SECTION	COUNTY	TOTAL SHEETS	SHEET NO.
46	(1BD)BC,BDS	LASALLE	16	10
CONTRACT NO. 66H90				
ILLINOIS FED. AID PROJECT				

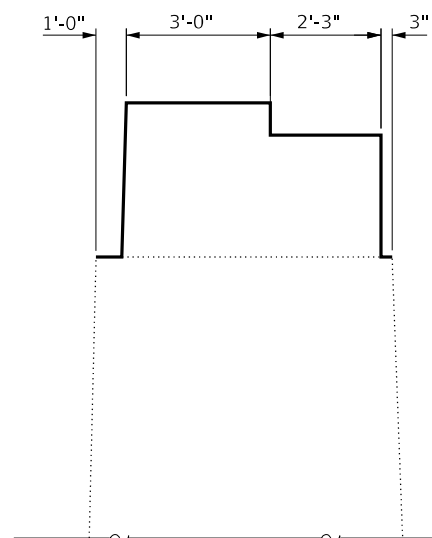

END VIEW

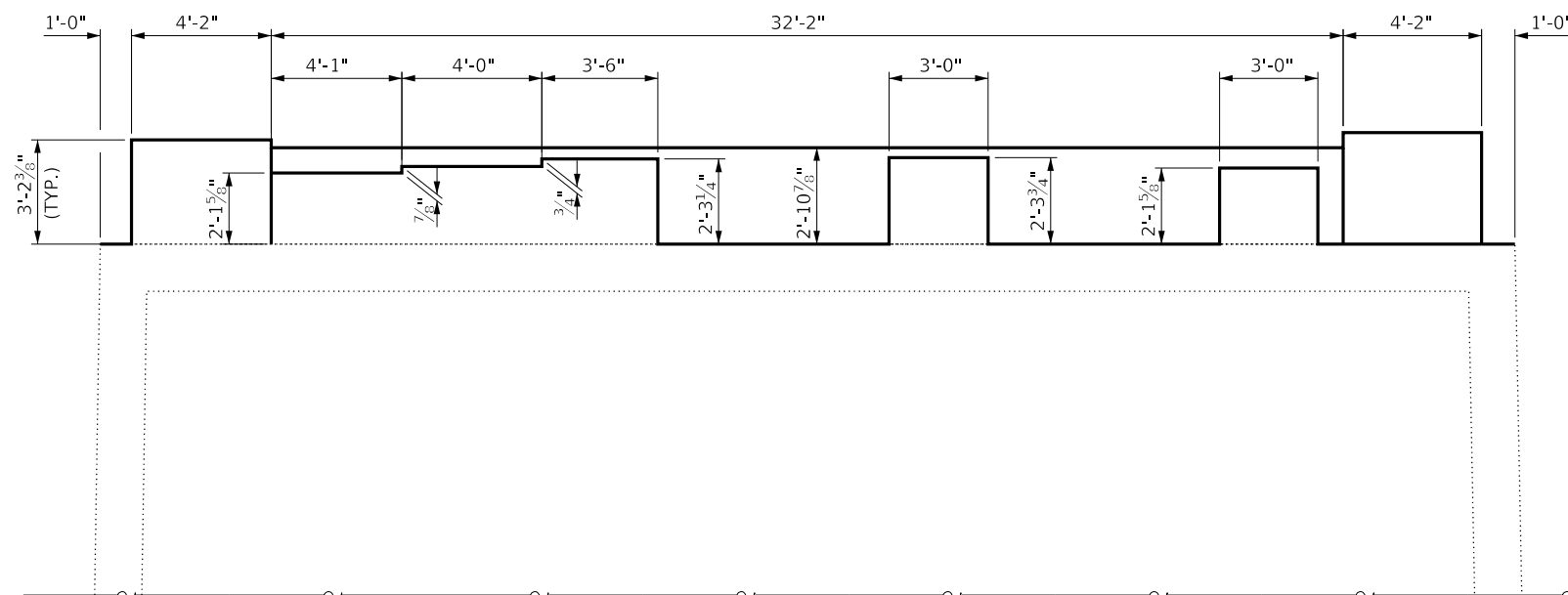

**ELEVATION
PIER 3**

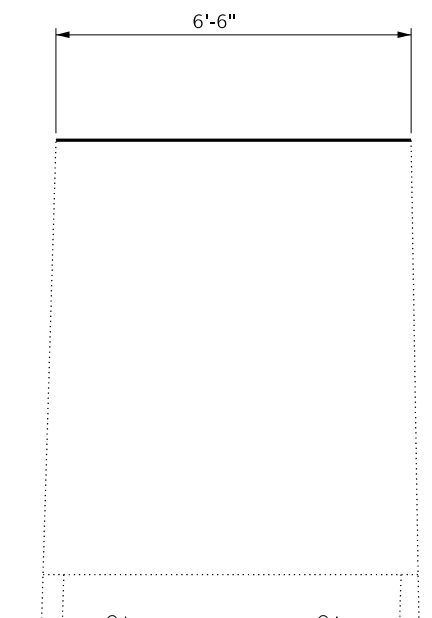

END VIEW

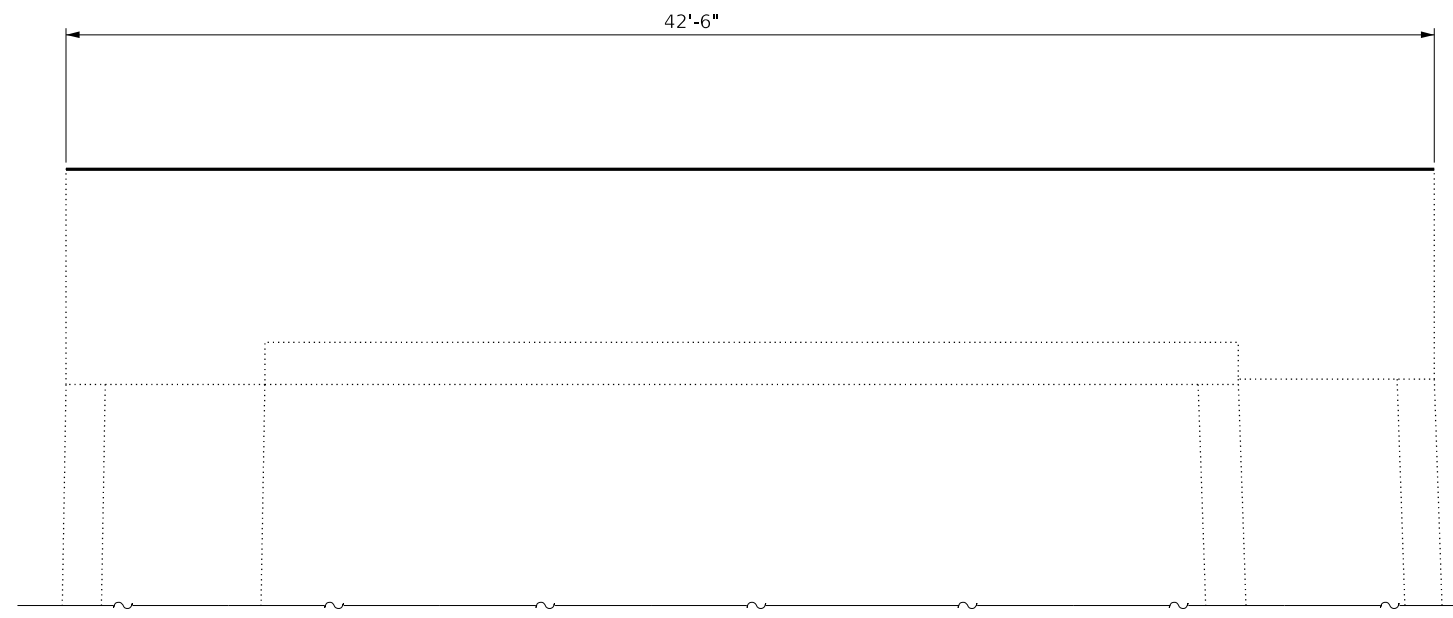

**ELEVATION
PIER 4**

MODEL: Default
FILE: \\nas01c.pva\ill08a\EBID\NTEC\Illinois.gov\PW\DOT\Documents\3\DOT\Office\Director\3\Projects\0366190\CADD\0366190-04-rev1.dgn

USER NAME = petersonc	DESIGNED - RW	REVISED -
	DRAWN - RW	REVISED -
PLOT SCALE = 100.0000 ' / in.	CHECKED - EP	REVISED -
PLOT DATE = 10/5/2017	DATE - 9/20/2017	REVISED -

**STATE OF ILLINOIS
DEPARTMENT OF TRANSPORTATION**

**EXISTING STRUCTURE PLANS
PIER 3 & 4**

SCALE: SHEET 7 OF 11 SHEETS STA. TO STA.

F.A.P. RTE.	SECTION	COUNTY	TOTAL SHEETS	SHEET NO.
46	(1BD)BC,BDS	LASALLE	16	12
			CONTRACT NO. 66H90	
		ILLINOIS	FED. AID PROJECT	

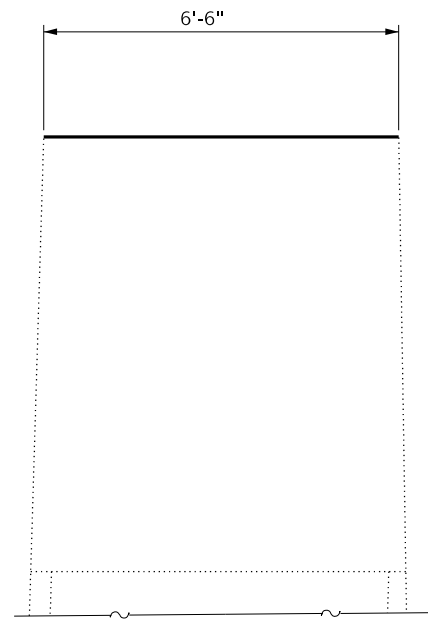

END VIEW

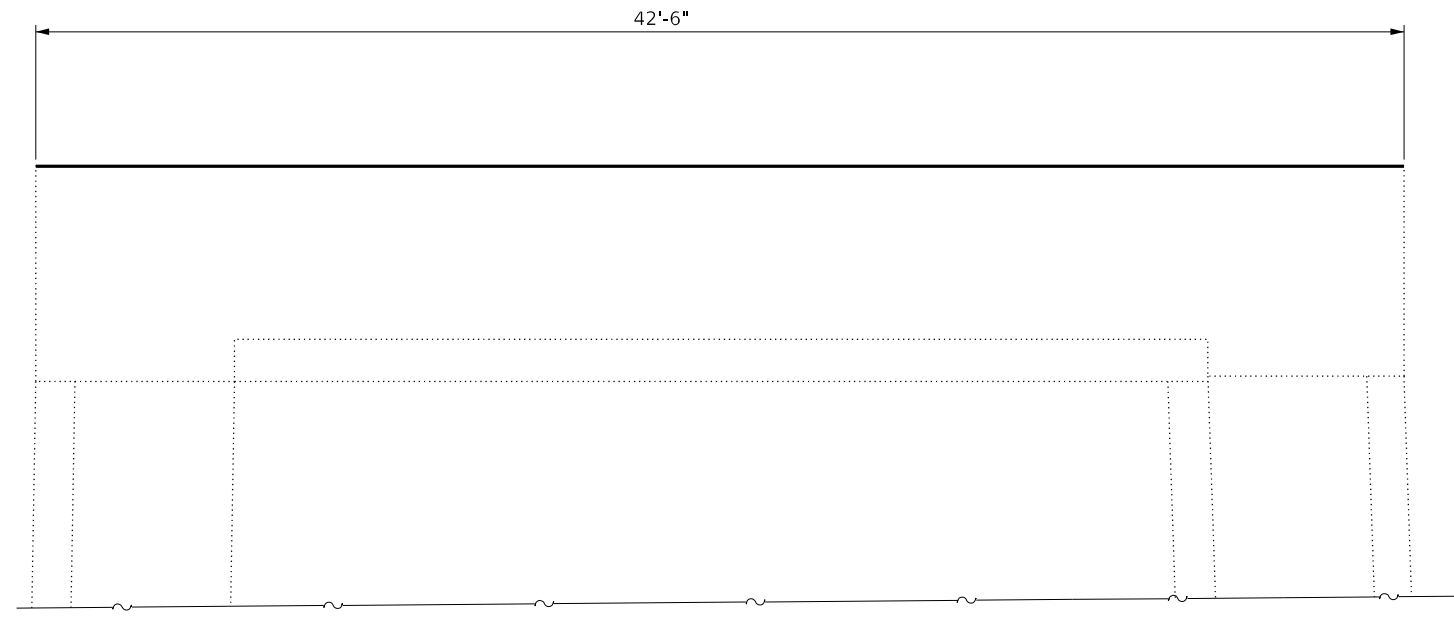

**ELEVATION
PIER 5**

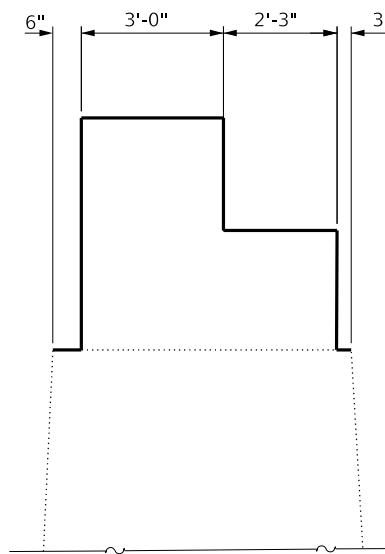

END VIEW

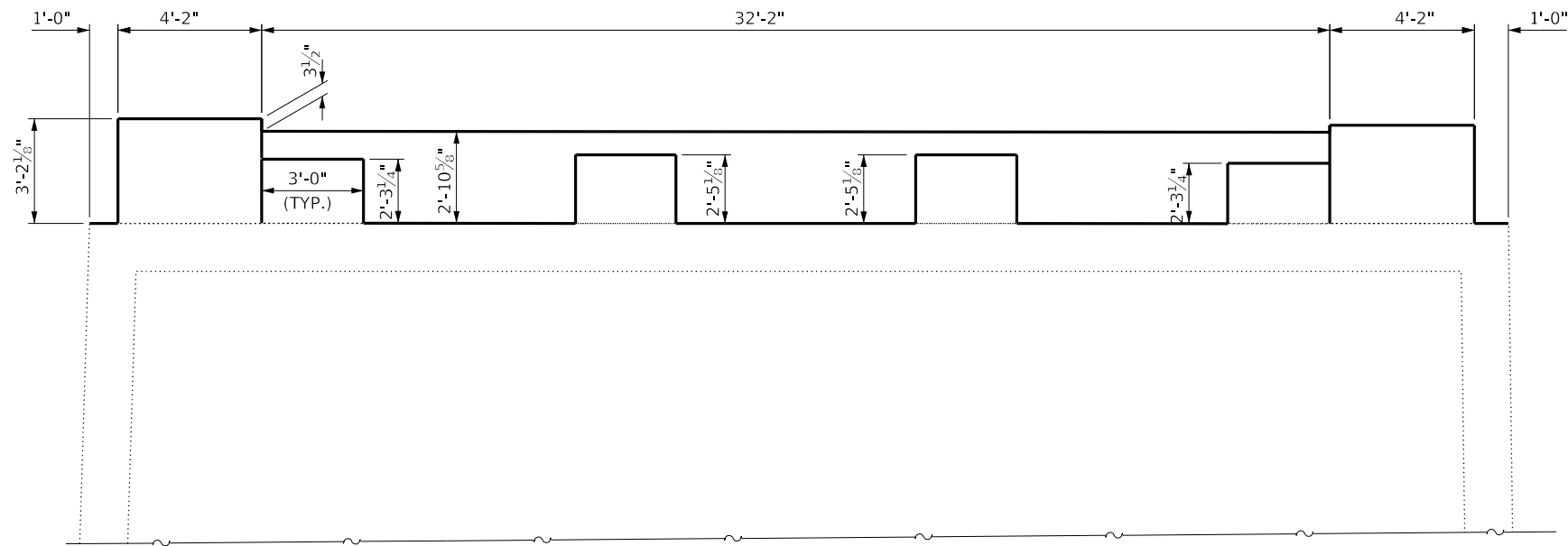

**ELEVATION
PIER 6**

MODEL: Default
 FILE: \\nas01c.psu.edu\B&E\BID\NTEC\Illinois\gov\PIV\DOT\Documents\1\DOT - Offices\Director\3\Projects\0366190\CADD\0366190-04-rev1.dgn

USER NAME = petersonec	DESIGNED - RW	REVISED -
	DRAWN - RW	REVISED -
PLOT SCALE = 100.0000' / in.	CHECKED - EP	REVISED -
PLOT DATE = 10/5/2017	DATE - 9/20/2017	REVISED -

**STATE OF ILLINOIS
DEPARTMENT OF TRANSPORTATION**

**EXISTING STRUCTURE PLANS
PIER 5 & 6**

SCALE: SHEET 8 OF 11 SHEETS STA. TO STA.

F.A.P. RTE.	SECTION	COUNTY	TOTAL SHEETS	SHEET NO.
46	(1BD)BC,BDS	LASALLE	16	13
CONTRACT NO. 66H90				
ILLINOIS FED. AID PROJECT				

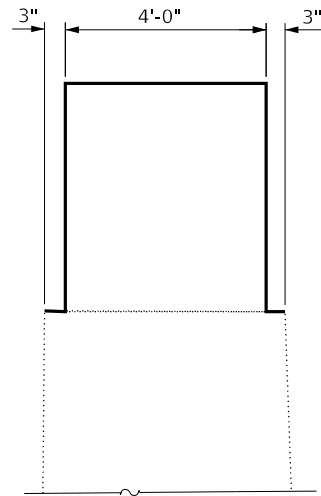

END VIEW

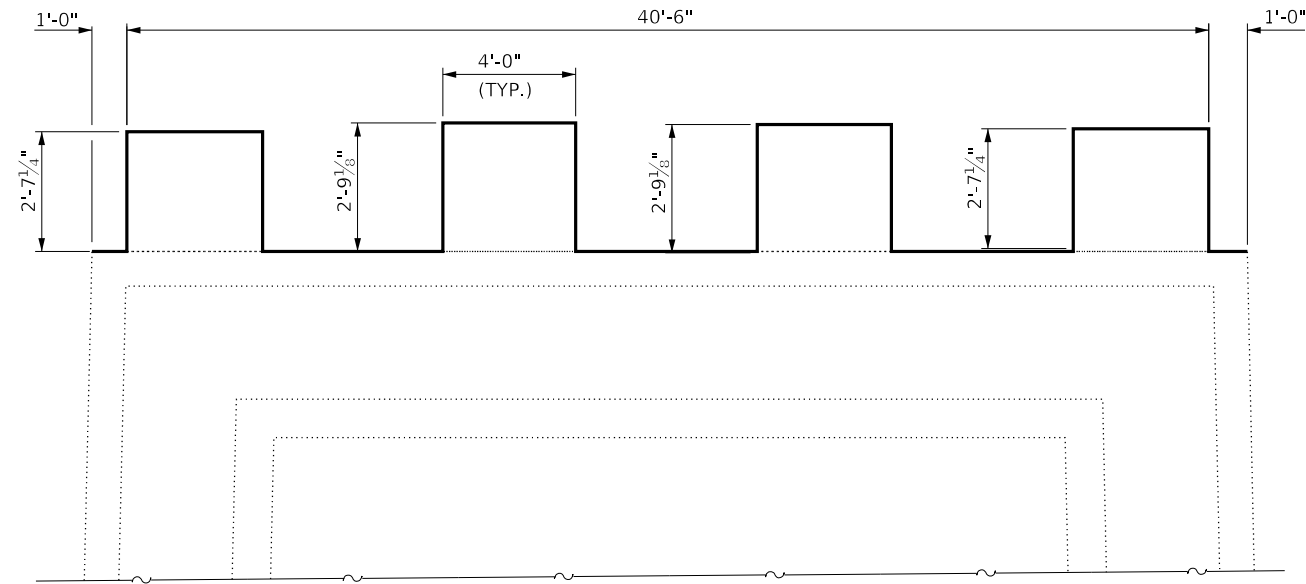

**ELEVATION
PIER 7**

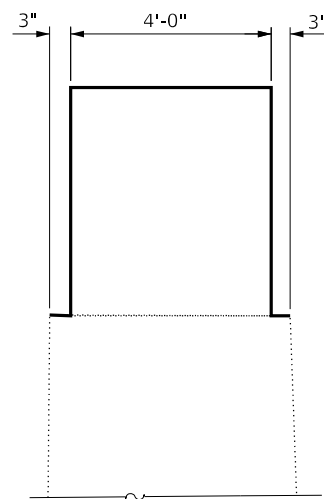

END VIEW

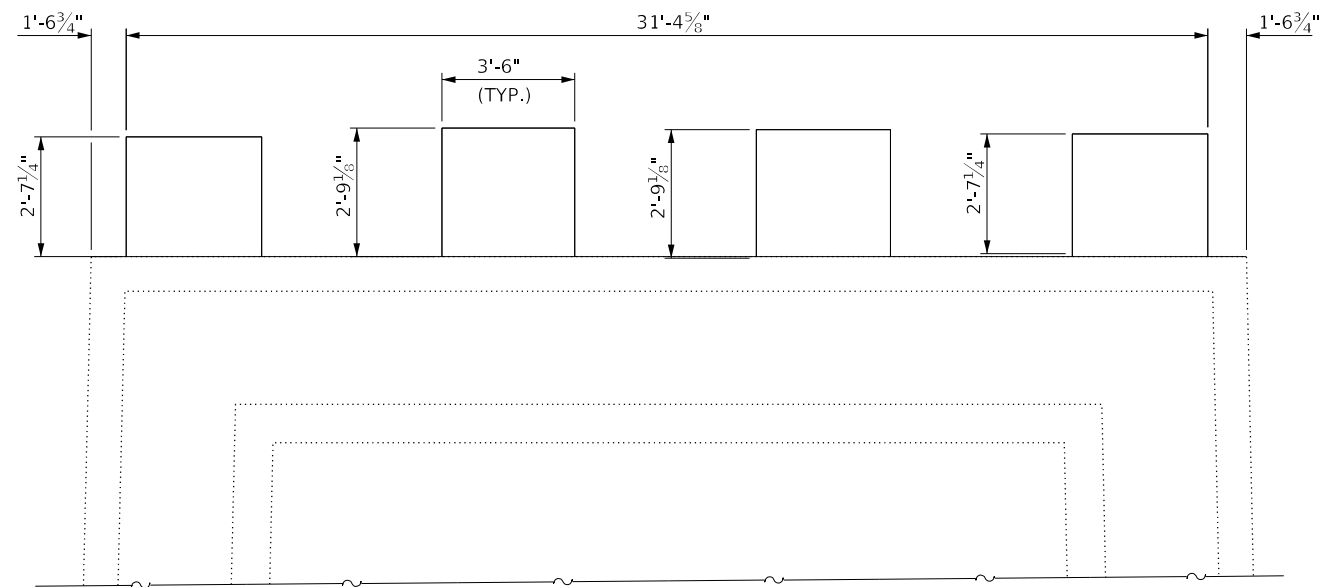

**ELEVATION
PIER 8**

MODEL: Default
 FILE: \\nas01c.psu.edu\B&E\BID\NTEC\Illinois.gov\PIV\DOT\Documents\3\DOT\Office\BID\TCT\Office\BID\TCT\3\Projects\0366190\CADD\0366190-04-01.dgn

USER NAME = petersonec	DESIGNED - RW	REVISED -
	DRAWN - RW	REVISED -
PLOT SCALE = 100.0000' / in.	CHECKED - EP	REVISED -
PLOT DATE = 10/5/2017	DATE - 9/20/2017	REVISED -

**STATE OF ILLINOIS
DEPARTMENT OF TRANSPORTATION**

**EXISTING STRUCTURE PLANS
PIER 7 & 8**

SCALE: SHEET 9 OF 11 SHEETS STA. TO STA.

F.A.P. RTE.	SECTION	COUNTY	TOTAL SHEETS	SHEET NO.
46	(1B)BC,BDS	LASALLE	16	14
CONTRACT NO. 66H90			ILLINOIS FED. AID PROJECT	

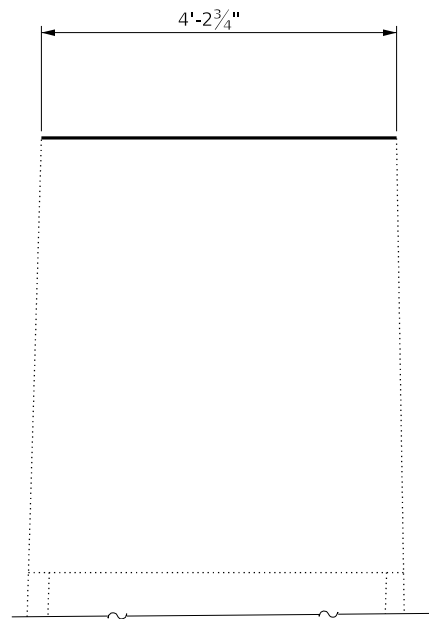

END VIEW

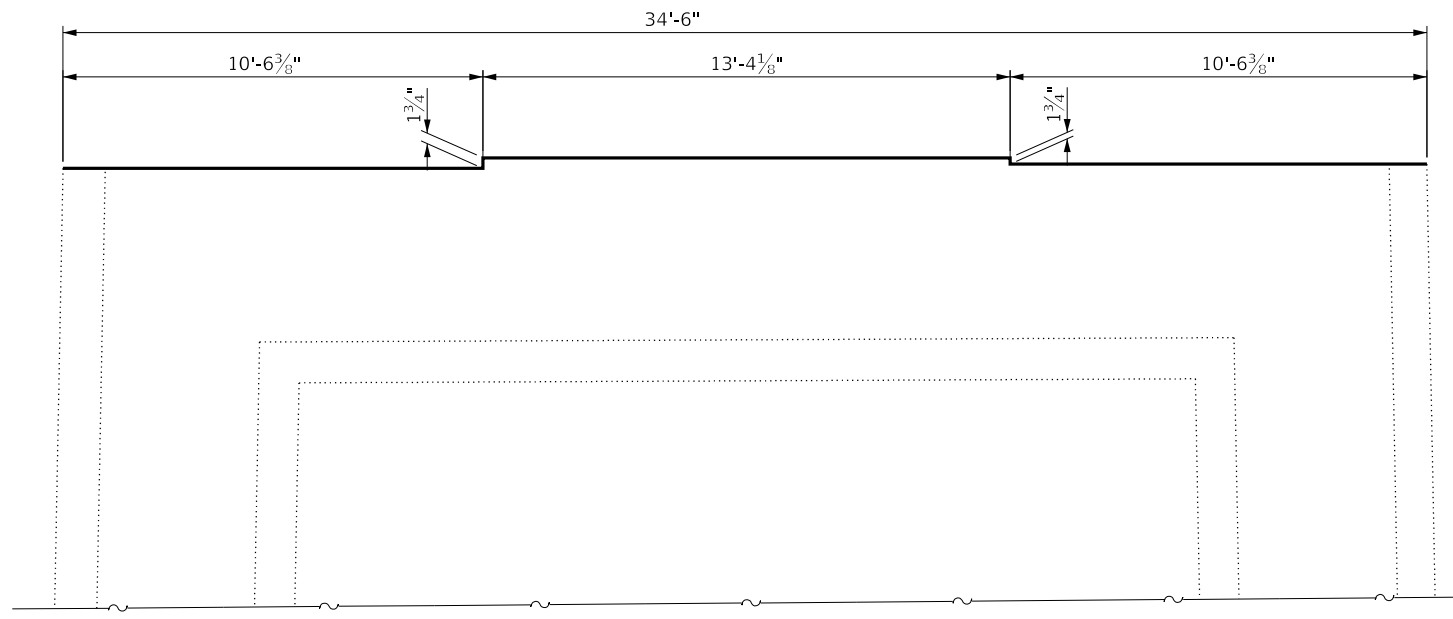

**ELEVATION
PIER 9**

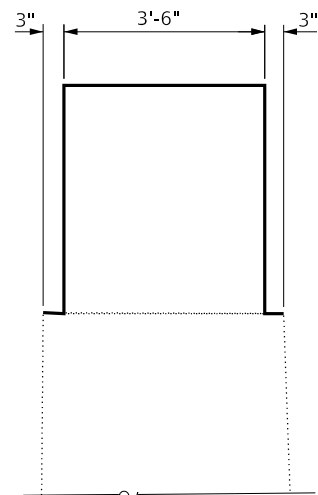

END VIEW

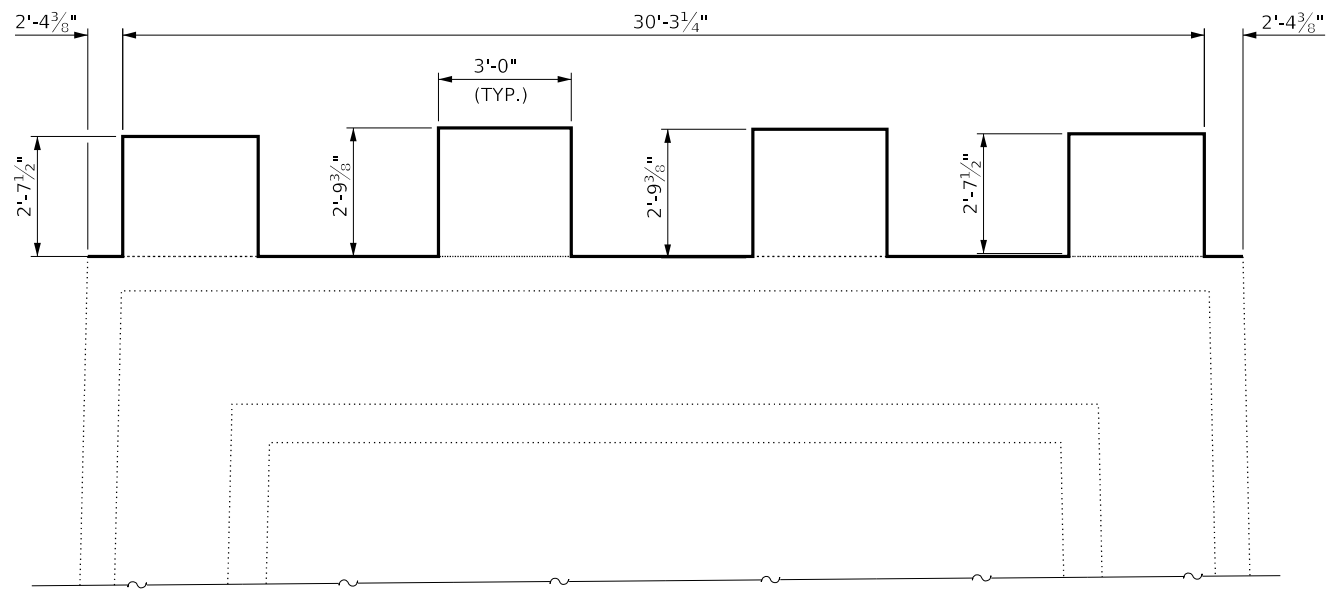

**ELEVATION
PIER 10**

MODEL: Default
 FILE: \\nas01c.pva\ill08a\EBID\NTEC\Illinois.gov\PIV\DOT\Documents\1\DOT_Offices\Director_3\Projects\0366190\CADD\0366190-00-000.dwg

USER NAME = petersonec	DESIGNED - RW	REVISED -
	DRAWN - RW	REVISED -
PLOT SCALE = 100.0000 ' / in.	CHECKED - EP	REVISED -
PLOT DATE = 10/5/2017	DATE - 9/20/2017	REVISED -

**STATE OF ILLINOIS
DEPARTMENT OF TRANSPORTATION**

**EXISTING STRUCTURE PLANS
PIER 9 & 10**

SCALE: SHEET 10 OF 11 SHEETS STA. TO STA.

F.A.P. RTE.	SECTION	COUNTY	TOTAL SHEETS	SHEET NO.
46	(1B)BC,BDS	LASALLE	16	15
CONTRACT NO. 66H90			ILLINOIS FED. AID PROJECT	

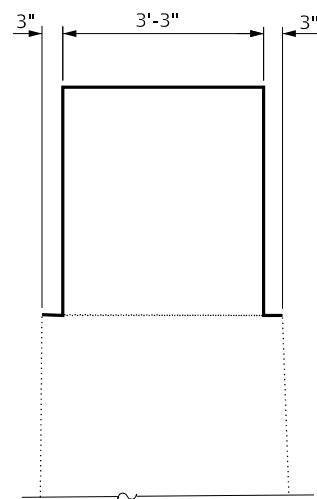

END VIEW

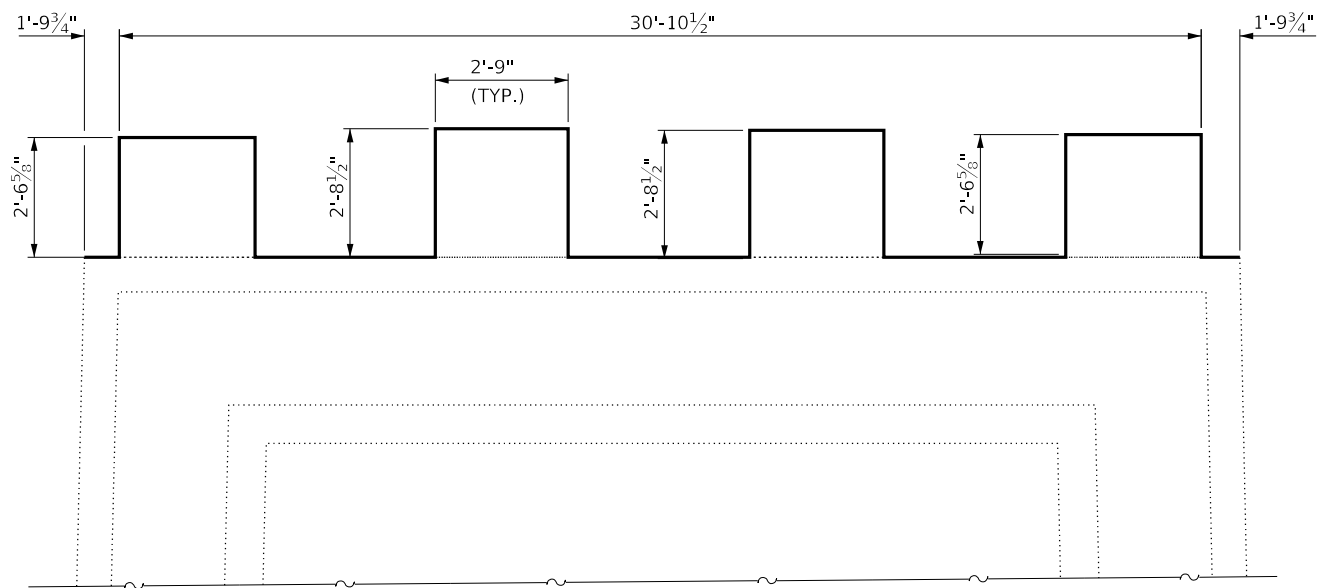

**ELEVATION
PIER 11**

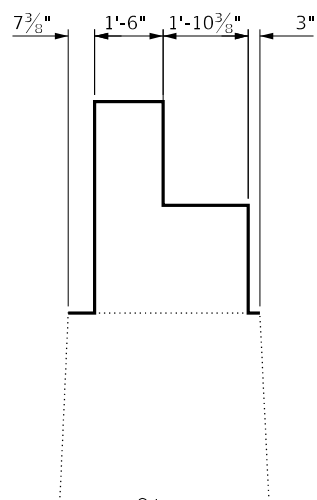

END VIEW

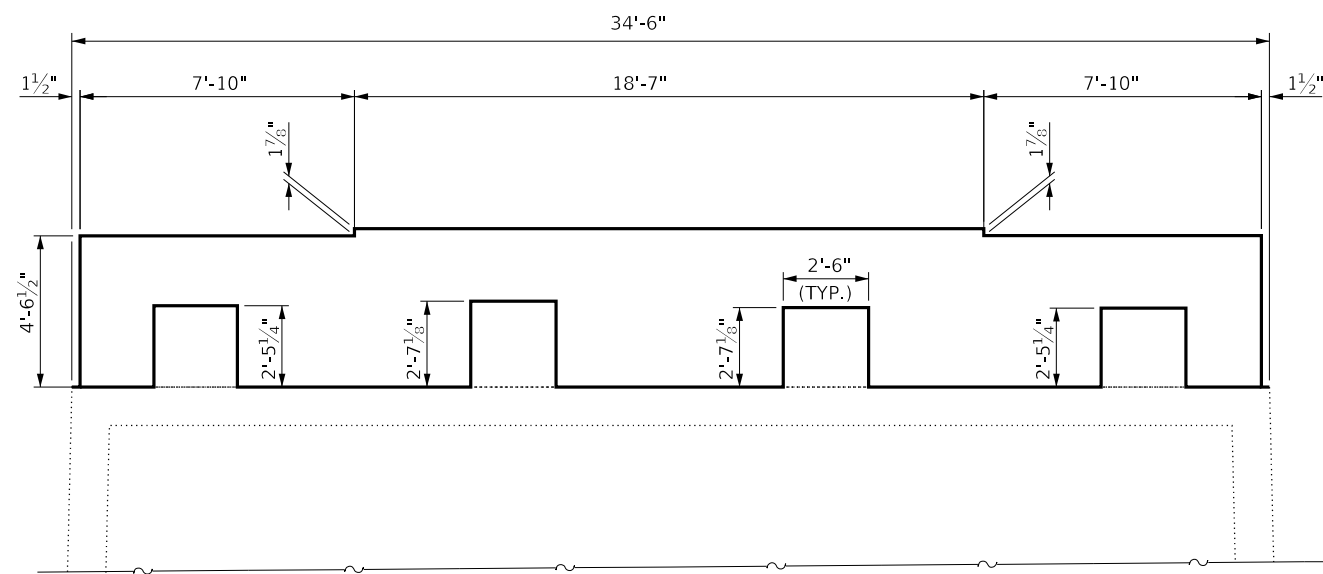

**ELEVATION
PIER 12**

MODEL: Default
 FILE: \\nas01.cba.uillinois.gov\PIV\DOT\Documents\DOT_Offices\Director_3\Projects\0366190_CADD\0366190-00-000-000.dgn

USER NAME = petersonec	DESIGNED - RW	REVISED -
	DRAWN - RW	REVISED -
PLOT SCALE = 100.0000 ' / in.	CHECKED - EP	REVISED -
PLOT DATE = 10/5/2017	DATE - 9/20/2017	REVISED -

**STATE OF ILLINOIS
DEPARTMENT OF TRANSPORTATION**

**EXISTING STRUCTURE PLANS
PIER 11 & 12**

SCALE: SHEET 11 OF 11 SHEETS STA. TO STA.

F.A.P. RTE.	SECTION	COUNTY	TOTAL SHEETS	SHEET NO.
46	(1BD)BC,BDS	LASALLE	16	16
CONTRACT NO. 66H90				
ILLINOIS FED. AID PROJECT				