

STATE OF ILLINOIS  
DEPARTMENT OF TRANSPORTATION

F.A.S. RTE.	SECTION	COUNTY	TOTAL SHEETS	SHEET NO.
**	**	LOGAN/TAZ	9	1
ILLINOIS CONTRACT NO. 72K18				
*FAS 1774 (OLD IL 121) & FAS 468 (ARMINGTON ROAD)				
**((109) RS-4, Q-2 (118) Q) PP				

FOR INDEX OF SHEETS, SEE SHEET NO. 2

PROPOSED IMPROVEMENTS

FAS 1774 (OLD IL 121) &  
FAS 468 (ARMINGTON ROAD)  
((109) RS-4, Q-2 (118) Q) PP  
BITUMIONOUS SURFACE TREATMENT  
LOGAN/TAZEWELL CO

C-96-008-18

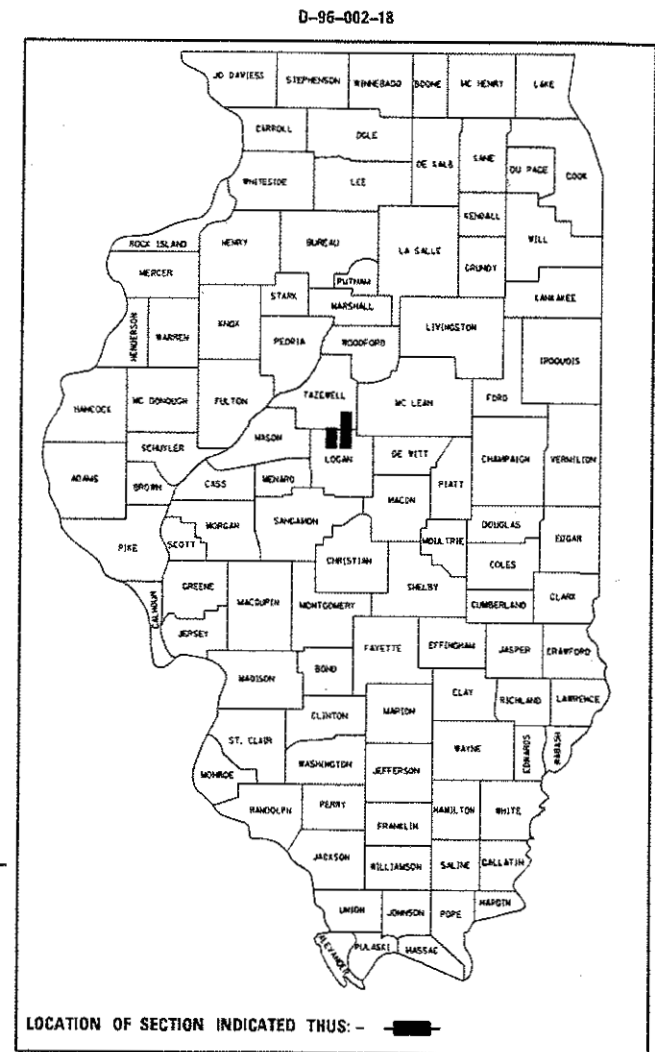

FAS 465  
FAS 468  
ADT = 800  
SU = 10  
MU = 10

FAS 1774  
ADT = 50  
SU = 1  
MU = 1

LOCATION #2  
END PROJECT  
STA. 1105+00

STA. EQ.  
76+57.52bk=  
1137+99.00ah

LOCATION #2  
BENG PROJECT  
STA. 50+20

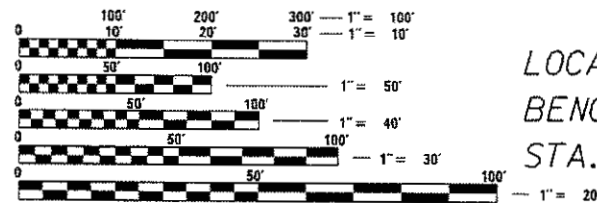

FULL SIZE PLANS HAVE BEEN PREPARED USING STANDARD ENGINEERING SCALES. REDUCED SIZED PLANS WILL NOT CONFORM TO STANDARD SCALES. IN MAKING MEASUREMENTS ON REDUCED PLANS, THE ABOVE SCALES MAY BE USED.

J.U.L.I.E.  
JOINT UTILITY LOCATION INFORMATION FOR EXCAVATION  
1-800-892-0123  
OR 811

PROJECT ENGINEER : MIKE IRWIN - (217)524-7765  
PROJECT MANAGER : TIM SHARP - (217)524-9160

CONTRACT NO. 72K18

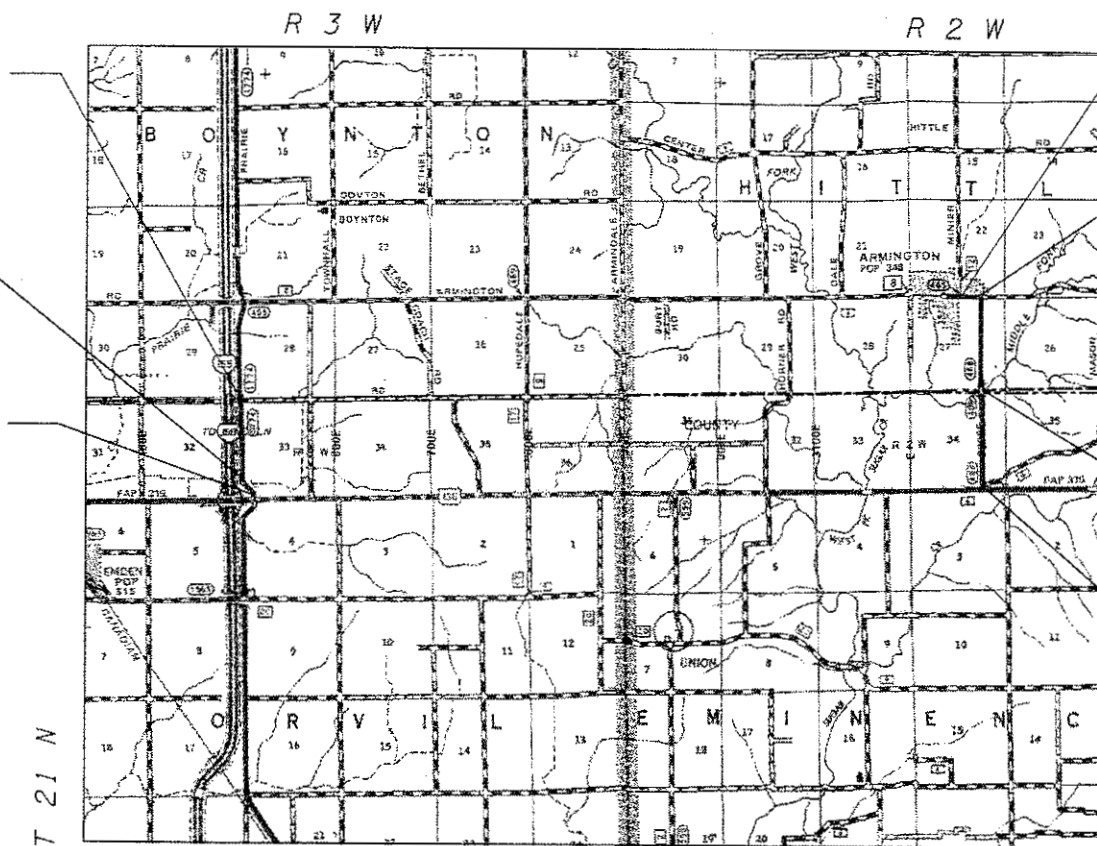

LOCATION #1  
BEGIN PROJECT  
STA. -20+64

STA. EQ.  
FAS 465 0+00=  
FAS 468 0+00

TAZEWELL CO.  
LOGAN CO.

OMISSION  
STA. 52+15 TO  
STA. 54+97

LOCATION #1  
END PROJECT  
STA. 106+50

STATE OF ILLINOIS  
DEPARTMENT OF TRANSPORTATION

SUBMITTED 12 October 2017

Maureen M. Addis  
REGION FOUR ENGINEER

Nov 30 2017  
Maureen M. Addis  
ENGINEER OF DESIGN AND ENVIRONMENT

Nov 30 2017  
[Signature]  
DIRECTOR OF HIGHWAYS CHIEF ENGINEER

PRINTED BY THE AUTHORITY  
OF THE STATE OF ILLINOIS

INDEX OF SHEETS

SHEET NO.	DESCRIPTION
1.	COVER SHEET
2.	INDEX OF SHEETS, STANDARDS, GENERAL NOTES & SIGNATURE
3.	SUMMARY OF QUANTITIES
4.	PROJECT LOCATION MAP
5-8.	PROJECT TYPICAL SECTIONS
9.	BUTT JOINT DETAILS

STANDARDS

STANDARD NO.	DESCRIPTION
442201-03	CLASS C AND D PATCHES
701001-02	OFF-ROAD OPERATIONS, 2L, 2W, MORE THAN 15' (4.5m) AWAY
701006-05	OFF-ROAD OPERATIONS, 2L, 2W, 15' (4.5m) TO 24" (600mm) FROM EDGE OF PAVEMENT
701201-04	LANE CLOSURE, 2L, 2W, DAY ONLY, FOR SPEEDS ≥ 45 MPH
701301-04	LANE CLOSURE, 2L, 2W, SHORT TERM OPERATIONS
701306-04	LANE CLOSURE, 2L, 2W, SLOW MOVING OPERATIONS DAY ONLY, FOR SPEEDS ≥ 45 MPH
701311-03	LANE CLOSURE, 2L, 2W, MOVING OPERATIONS, DAY ONLY
701501-06	URBAN LANE CLOSURE, 2L, 2W, UNDIVIDED
701901-07	TRAFFIC CONTROL DEVICES

NOTES:

COVER AND SEAL COAT AGGREGATE SHALL BE CRUSHED LIMESTONE.

D-6 OPERATIONS WILL PLACE PERMANENT PAVEMENT MARKINGS.

CONTRACTOR SHALL PLACE AGGREGATE SHOULDERS, TYPE B, PRIOR TO BITUMINOUS SURFACE TREATMENT A-2.

CONTRACTOR SHALL APPLY BITUMINOUS SURFACE TREATMENT A-2 ON ALL SIDE ROADS ATTACHED TO FAS 465 TO 25 FT BEYOND THE EDGE OF THE MAINLINE.

UP TO 3 SWEEPINGS MAY BE REQUIRED BY A ROTARY BROOM TO REMOVE EXCESS AGGREGATE.

**STATE OF ILLINOIS  
DEPARTMENT OF TRANSPORTATION  
DIVISION OF HIGHWAYS  
DISTRICT 6**

---

EXAMINED October 5th 2017  
  
 ENGINEER OF OPERATIONS

---

EXAMINED September 21 2017  
  
 ENGINEER OF PROJECT IMPLEMENTATION

---

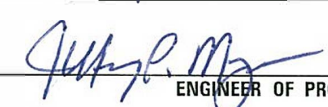
EXAMINED September 29 2017  
  
 ENGINEER OF PROGRAM DEVELOPMENT

\*FAS 1774 (OLD IL 121) & FAS 468 (ARMINGTON ROAD)  
 \*\*((109) RS-4, 0-2 (118) 0) PP

CODE NO.	ITEM	UNIT	TOTAL QUANTITY	0-01624-6015		0-01624-6006	
				100% STATE		100% STATE	
				LOGAN	LOGAN	LOGAN	LOGAN
				OLD L 121	FAS 468	FAS 468	FAS 465
				ROADWAY	ROADWAY	ROADWAY	ROADWAY
				0005	0005	0005	0005
				RURAL	RURAL	RURAL	RURAL
40300400	BITUMINOUS MATERIALS (COVER AND SEAL COAT)	TON	150	51	38	38	23
40300500	COVER COAT AGGREGATE	TON	608	206	153	156	93
40300600	SEAL COAT AGGREGATE	TON	499	164	123	138	74
40600290	BITUMINOUS MATERIALS (TACK COAT)	POUND	3,429	3,429	0	0	0
40600400	MIXTURE FOR CRACKS, JOINTS AND FLANGWAYS	TON	8	3	2	2	1
40600625	LEVELING BINDER (MACHINE METHOD) N50	TON	641	641	0	0	0
40600990	TEMPORARY RAMP	SQ YD	29	29	0	0	0
44200140	PAVEMENT PATCHING, TYPE I, 12 INCH	SQ YD	20	0	20	0	0
44200144	PAVEMENT PATCHING, TYPE II, 12 INCH	SQ YD	130	80	0	0	50
44200148	PAVEMENT PATCHING, TYPE III, 12 INCH	SQ YD	50	0	0	0	50
44200150	PAVEMENT PATCHING, TYPE IV, 12 INCH	SQ YD	230	80	0	0	150
48101200	AGGREGATE SHOULDERS, TYPE B	TON	1,330	451	392	393	94
67100100	MOBLIZATION	L SUM	1	0.35	0.25	0.30	0.10
70100450	TRAFFIC CONTROL AND PROTECTION, STANDARD 701201	L SUM	1	0.35	0.25	0.30	0.10
70100460	TRAFFIC CONTROL AND PROTECTION, STANDARD 701306	L SUM	1	0.35	0.25	0.30	0.10
70102620	TRAFFIC CONTROL AND PROTECTION, STANDARD 701501	L SUM	1	0	0	0	1
78300200	RAISED REFLECTIVE PAVEMENT MARKER REMOVAL	EACH	159	0.00	65	66	28
X4401198	HOT-MIX ASPHALT SURFACE REMOVAL, VARIABLE DEPTH	SQ YD	7,620	7,620	0	0	0

MIXTURE REQUIREMENTS	
THE FOLLOWING MIXTURE REQUIREMENTS ARE APPLICABLE FOR THIS PROJECT	
MIXTURE USE(S):	LEVELING BINDER (MACHINE METHOD) N50
AC/PG:	PG 64-22
DESIGN AIR VOIDS:	4.0% @ N50
MIXTURE COMPOSITION:	IL 9.5
FRICTION AGGREGATE:	N/A
QUALITY MANAGEMENT:	QC/QA

APPLICATION RATES		
	AGGREGATE	BITUMINOUS MATERIAL
COVER COAT	25 lb/sq yd	0.32 gal/sq yd
SEAL COAT	20 lb/sq yd	0.40 gal/sq yd
THE APPLICATION RATES SHOWN ABOVE MAY BE ADJUSTED BY THE ENGINEER BASED ON FIELD CONDITIONS		

FILE NAME *	USER NAME * sharpid	DESIGNED -	REVISED -
S:\CONTRACTS\CAD\72K18 - FAS 1774 OLD IL 121 - FAS 468 (ARMINGTON ROAD) A-2\PLANS\72K18-3-500.dgn		CHECKED -	REVISED -
		DATE -	REVISED -

STATE OF ILLINOIS  
DEPARTMENT OF TRANSPORTATION

SCALE:	SHEET	OF	SHEETS	STA.	TO	STA.
--------	-------	----	--------	------	----	------

\*FAS 1774 (OLD IL 121) & FAS 468 (ARMINGTON ROAD)  
\*\*((109) RS-4, Q-2 ((18) Q) PP

F.A.S. RTE.	SECTION	COUNTY	TOTAL SHEETS	SHEET NO.
*	**	LOGAN/TAZ.	9	3
			CONTRACT NO. 72K18	
ILLINOIS FED. AID PROJECT				

LOCATION #1  
BEGIN PROJECT  
STA. -20+64

FAS 465  
STA. 0+00  
FAS 468  
STA. 0+00

OMISSION  
STA. 52+15 TO  
54+97

TAZEWELL CO.  
LOGAN CO.

LOCATION #1  
END PROJECT  
STA. 106+50

END WORK ON  
FAS 465  
STA. 1+46



TAZEWELL CO.  
LOGAN CO.

LOCATION #2  
END PROJECT  
STA. 1105+00

STA. EQ.  
76+57.52bk=  
1137+99.00ch

LOCATION #2  
BEGIN PROJECT  
STA. 50+20

\*FAS 1774 (OLD IL 121) & FAS 468 (ARMINGTON ROAD)  
\*\*(1109) RS-4, 0-2 (118) O) PP

FILE NAME =	USER NAME = sherptd	DESIGNED -	REVISED -
S:\CONTR\MAIN\T.CAD\72K18 - FAS 1774 IOLA	IL 1211 - FAS 468 (ARMINGTON ROAD) A-2\PLANS	7	0
		CHECKED -	REVISED -
Default	PLOT DATE = 10/11/2017	DATE -	REVISED -

STATE OF ILLINOIS  
DEPARTMENT OF TRANSPORTATION

LOCATION MAP

F.A.S. RTE.	SECTION	COUNTY	TOTAL SHEETS	SHEET NO.
.	..	LOGAN/TAZ	9	4
			CONTRACT NO. 72K18	
[ILLINOIS] FED. AID PROJECT				

SCALE: \_\_\_\_\_ SHEET \_\_\_\_\_ OF \_\_\_\_\_ SHEETS STA. \_\_\_\_\_ TO STA. \_\_\_\_\_

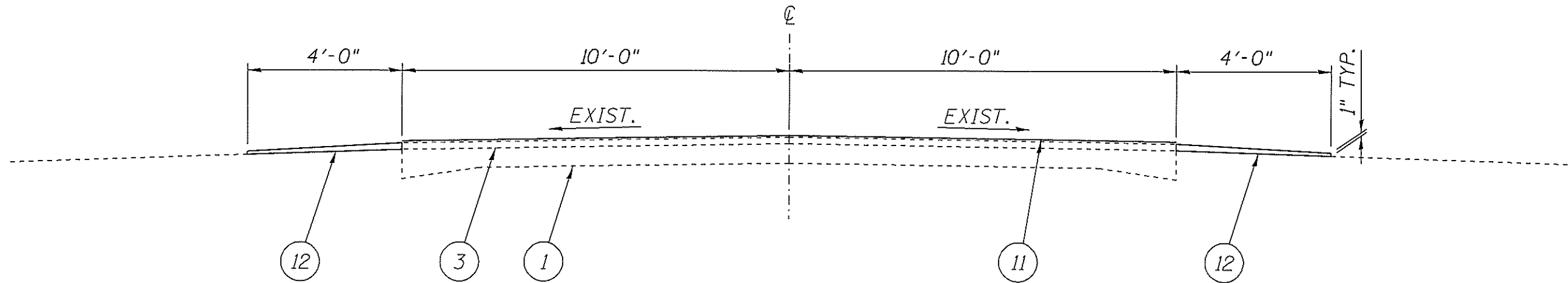

FAS 465  
-11+34 TO 1+04

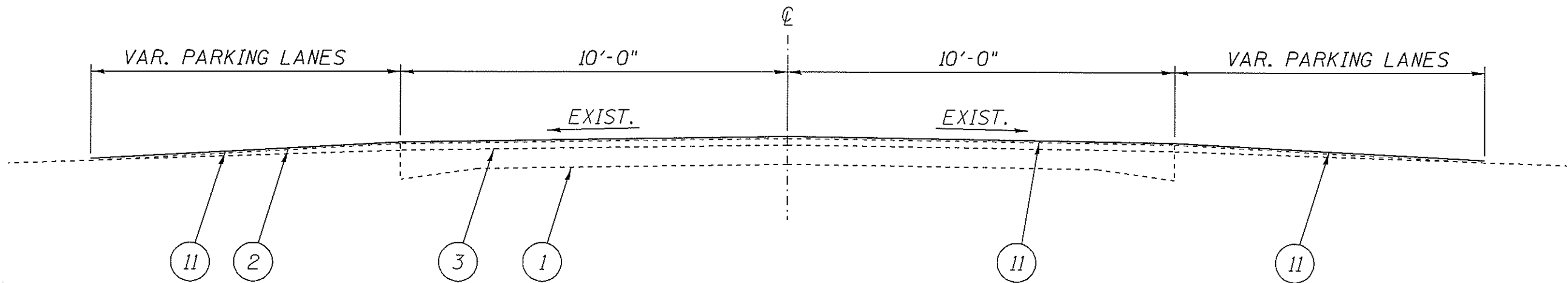

FAS 465  
STA. -20+64 TO -11+34

**LEGEND**

- 1- EXIST. P.C.C. PAVEMENT 9-6 1/2-9"
- 2- EXIST. A-3 PARKING LANE
- 3- EXIST. HOT-MIX ASPHALT SURFACE
- 4- EXIST. CONCRETE GUTTER
- 5- EXIST. AGGREGTE SHOULDER, TYPE B
- 6- EXIST. P.C.C. BASE COURSE WIDENING 9"
- 7- EXIST. GRANULAR EMBANKMENT 15" MIN.
- 8- EXIST. H.M.A SHOULDERS 8"
- 9- EXIST. LIME MODIFIED SOIL 12"
- 10-PROP. LEVELING BINDER (MACHINE METHOD) N50, 1 1/2"
- 11-PROP. BITUMINOUS SURFACE TREATMENT A-2
- 12-PROP. AGGREGATE SHOULDER, TYPE B
- 13-PROP. H.M.A. SURFACE REMOVAL - VARIABLE DEPTH

\* FAS 1774 (OLD IL 121) & FAS 468 (ARWINGTON ROAD)  
\*\* (1109) RS-4, 0-2 (11B) 0) PP

FILE NAME :	USER NAME : sharptd	DESIGNED -	REVISED -
S:\CONTRMADNT_CAD\72K18 - FAS 1774 10LD	IL 121 - FAS 468 (ARWINGTON ROAD) A-2\PLANS	7DR\WH-5-B-typicals.dgn	REVISED -
Default	PLOT SCALE = 3.0000' / 1"	CHECKED -	REVISED -
	PLOT DATE = 10/11/2017	DATE -	REVISED -

STATE OF ILLINOIS  
DEPARTMENT OF TRANSPORTATION

TYPICALS

SCALE: SHEET OF SHEETS STA. TO STA.

F.A.S. RTE.	SECTION	COUNTY	TOTAL SHEETS	SHEET NO.
.	**	LOGAN/TAZ.	9	5
CONTRACT NO. 72K18			ILLINOIS FED. AID PROJECT	

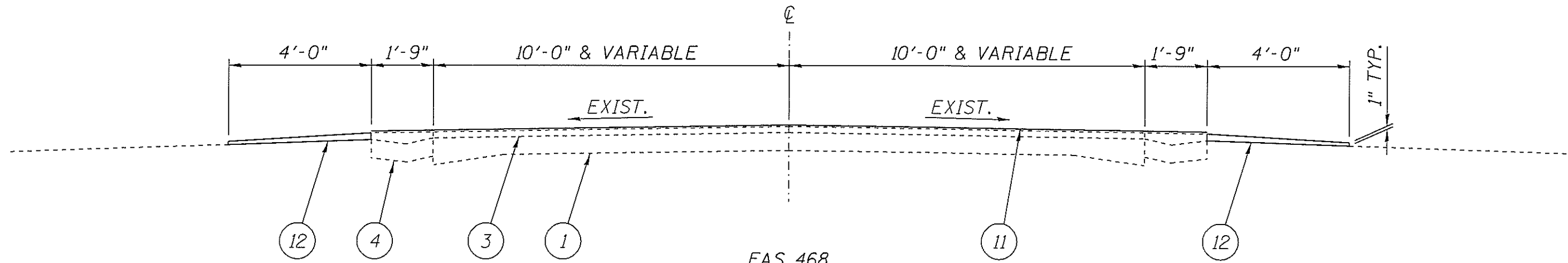

FAS 468  
 STA 0+10 TO 1+00  
 STA 39+16 TO 52+15  
 OMISSION 52+15 TO 54+97  
 STA 54+97 TO 67+40

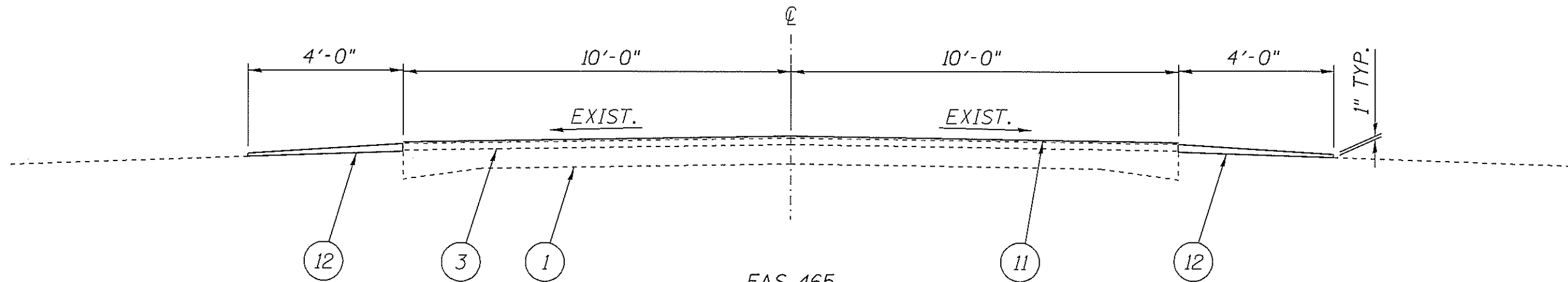

FAS 465  
 STA 1+04 TO 1+46  
 FAS 468  
 STA 1+21 TO 39+16  
 STA. 67+40 TO 106+50

**LEGEND**

- 1- EXIST. P.C.C. PAVEMENT 9-6 1/2-9"
- 2- EXIST. A-3 PARKING LANE
- 3- EXIST. HOT-MIX ASPHALT SURFACE
- 4- EXIST. CONCRETE GUTTER
- 5- EXIST. AGGREGTE SHOULDER, TYPE B
- 6- EXIST. P.C.C. BASE COURSE WIDENING 9"
- 7- EXIST. GRANULAR EMBANKMENT 15" MIN.
- 8- EXIST. H.M.A SHOULDERS 8"
- 9- EXIST. LIME MODIFIED SOIL 12"
- 10-PROP. LEVELING BINDER (MACHINE METHOD) N50, 1 1/2"
- 11-PROP. BITUMINOUS SURFACE TREATMENT A-2
- 12-PROP. AGGREGATE SHOULDER, TYPE B
- 13-PROP. H.M.A. SURFACE REMOVAL - VARIABLE DEPTH

\* FAS 1774 (OLD IL 121) & FAS 468 (ARMINGTON ROAD)  
 \*\* (109) RS-4, D-2 (11B) O) PP

FILE NAME :	USER NAME :	DESIGNED -	REVISED -
S:\CONTRACTS\CAD\72K18 - FAS 1774 (OLD IL 121) - FAS 468 (ARMINGTON ROAD) A-2\PLANS\DRAWING-5-8-typicals.dgn	sharptd		
PLOT SCALE :	PLOT DATE :	CHECKED -	REVISED -
3.0000' / in.	18/11/2017		
DATE :		DATE -	REVISED -

STATE OF ILLINOIS  
 DEPARTMENT OF TRANSPORTATION

TYPICALS

SCALE: SHEET OF SHEETS STA. TO STA.

F.A.S. RTE.	SECTION	COUNTY	TOTAL SHEETS	SHEET NO.
*	**	LOGAN/TAZ.	9	6
CONTRACT NO. 72K18				
ILLINOIS FED. AID PROJECT				

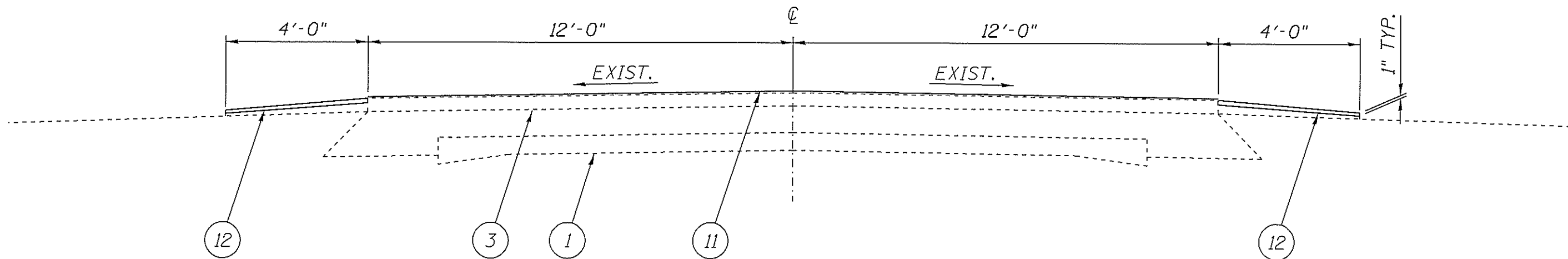

OLD 121  
STA. 1108+30 TO 1112+30

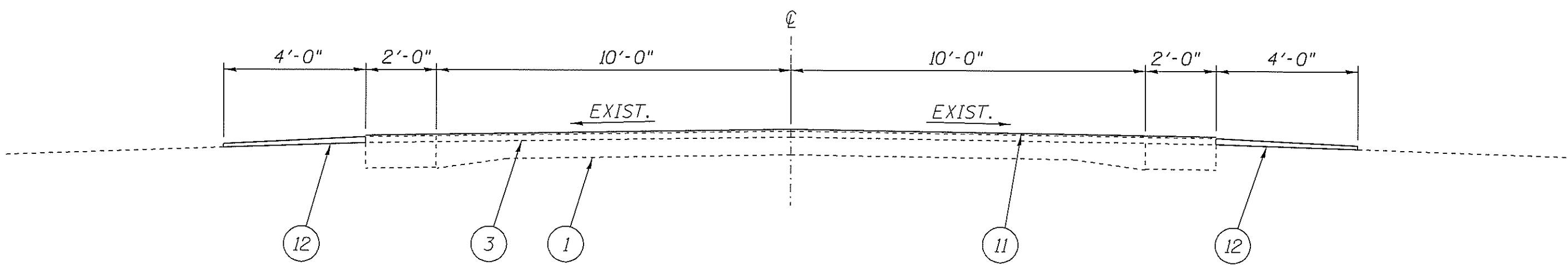

OLD 121  
STA. 1105+00 TO 1108+30  
STA. 1112+30 TO 1113+00  
STA. 1123+23 TO 1137+99

LEGEND

- 1- EXIST. P.C.C. PAVEMENT 9-6 1/2-9"
- 2- EXIST. A-3 PARKING LANE
- 3- EXIST. HOT-MIX ASPHALT SURFACE
- 4- EXIST. CONCRETE GUTTER
- 5- EXIST. AGGREGTE SHOULDER, TYPE B
- 6- EXIST. P.C.C. BASE COURSE WIDENING 9"
- 7- EXIST. GRANULAR EMBANKMENT 15" MIN.
- 8- EXIST. H.M.A SHOULDERS 8"
- 9- EXIST. LIME MODIFIED SOIL 12"
- 10-PROP. LEVELING BINDER (MACHINE METHOD) N50, 1 1/2"
- 11-PROP. BITUMINOUS SURFACE TREATMENT A-2
- 12-PROP. AGGREGATE SHOULDER, TYPE B
- 13-PROP. H.M.A. SURFACE REMOVAL - VARIABLE DEPTH

\* FAS 1774 (OLD IL 121) & FAS 468 (ARMINGTON ROAD)  
\*\* (1109) RS-4, 0-2 (11B) O) PP

FILE NAME =	USER NAME = shprtd	DESIGNED -	REVISED -
S:\CONTRMAINT\CAD\72K18 - FAS 1774 (OLD IL 121) - FAS 468 (ARMINGTON ROAD) A-2\PLANS	72K18-5-8-typicals.dgn	CHECKED -	REVISED -
Default	DATE -	REVISOR -	REVISION -

STATE OF ILLINOIS  
DEPARTMENT OF TRANSPORTATION

TYPICALS			
SCALE:	SHEET	OF	SHEETS
	STA.		TO STA.

F.A.S. RTE.	SECTION	COUNTY	TOTAL SHEETS	SHEET NO.
*	**	LOGAN/TAZ.	9	7
CONTRACT NO. 72K18				
ILLINOIS FED. AID PROJECT				

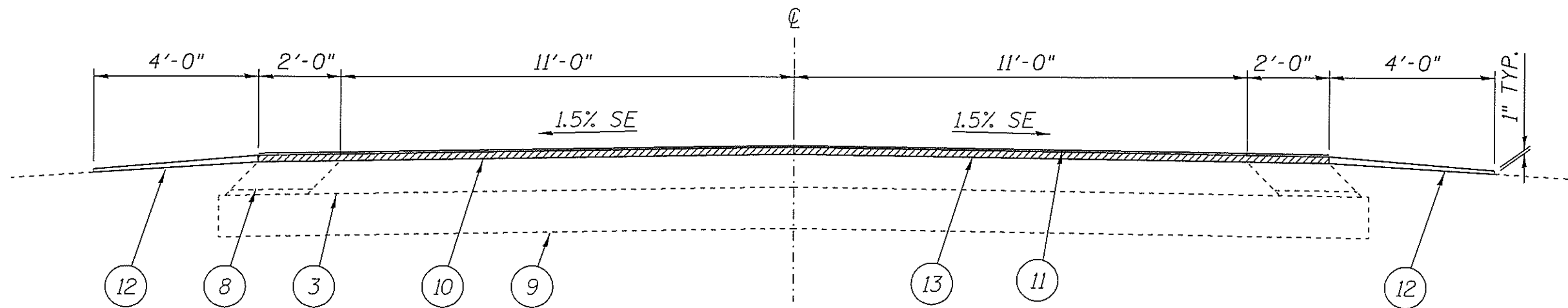

OLD 121  
STA. 50+20 TO 76+57.52

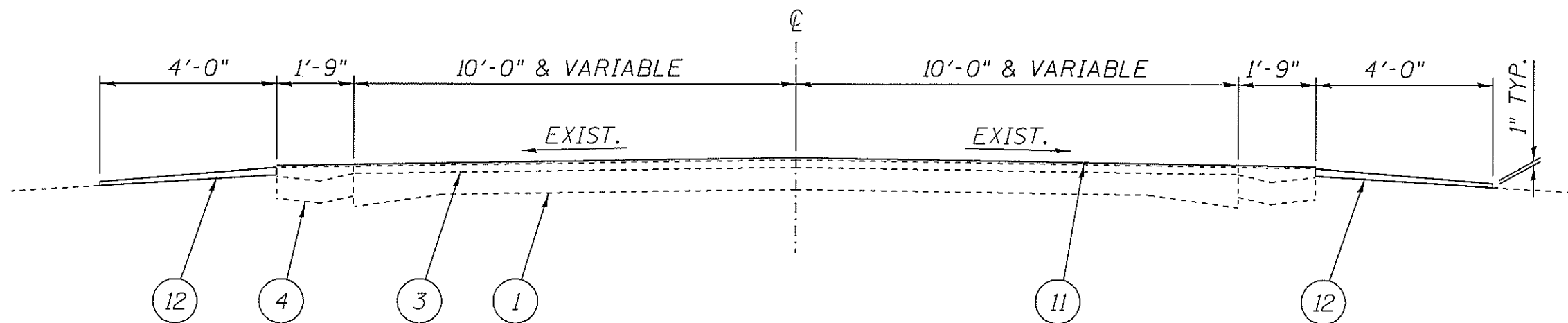

OLD 121  
STA. 1113+00 TO 1123+23

**LEGEND**

- 1- EXIST. P.C.C. PAVEMENT 9-6 1/2-9"
- 2- EXIST. A-3 PARKING LANE
- 3- EXIST. HOT-MIX ASPHALT SURFACE
- 4- EXIST. CONCRETE GUTTER
- 5- EXIST. AGGREGTE SHOULDER, TYPE B
- 6- EXIST. P.C.C. BASE COURSE WIDENING 9"
- 7- EXIST. GRANULAR EMBANKMENT 15" MIN.
- 8- EXIST. H.M.A SHOULDERS 8"
- 9- EXIST. LIME MODIFIED SOIL 12"
- 10-PROP. LEVELING BINDER (MACHINE METHOD) N50, 1 1/2"
- 11-PROP. BITUMINOUS SURFACE TREATMENT A-2
- 12-PROP. AGGREGATE SHOULDER, TYPE B
- 13-PROP. H.M.A. SURFACE REMOVAL - VARIABLE DEPTH

\* FAS 1774 (OLD IL 121) & FAS 468 (ARMINGTON ROAD)  
\*\* (109) RS-4, 0-2 (11B) 0) PP

FILE NAME =	USER NAME = shorptd	DESIGNED -	REVISED -
S:\CONTRMINT_CAD\72K18 - FAS 1774 OLD	IL 121 - FAS 468 (ARMINGTON ROAD) A-2\PLANS	DRAWN - 5-B-typlcais.dgn	REVISED -
Default	PLOT SCALE = 3.0000' / in.	CHECKED -	REVISED -
	PLOT DATE = 10/11/2017	DATE -	REVISED -

STATE OF ILLINOIS  
DEPARTMENT OF TRANSPORTATION

TYPICALS

SCALE: SHEET OF SHEETS STA. TO STA.

F.A.S. RTE.	SECTION	COUNTY	TOTAL SHEETS	SHEET NO.
.	**	LOGAN/TAZ.	9	8
CONTRACT NO. 72K18				
ILLINOIS FED. AID PROJECT				



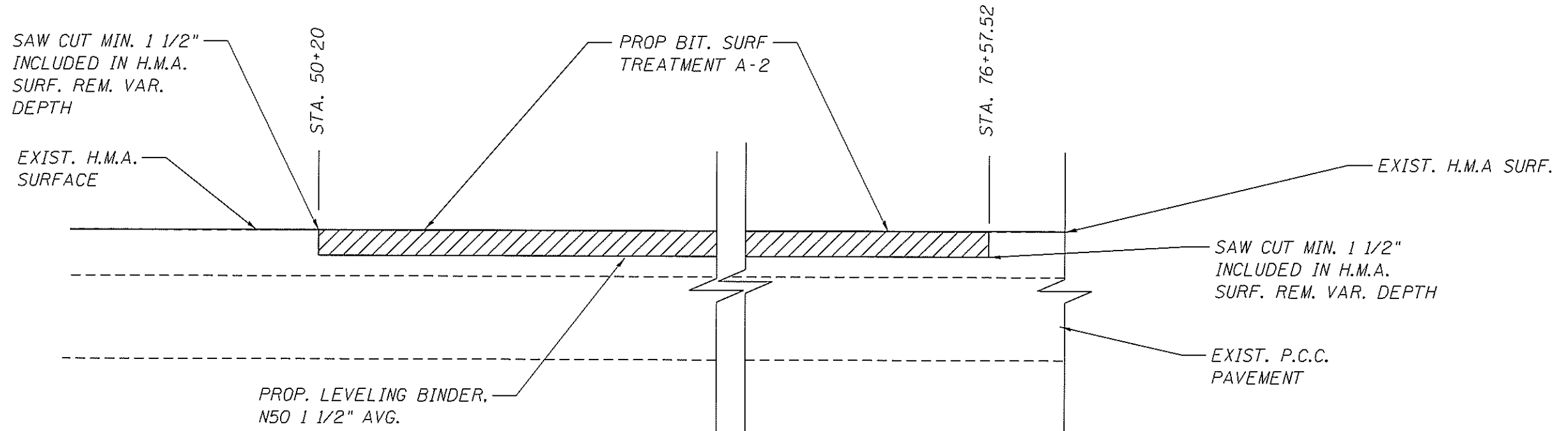

• FAS 1774 (OLD IL 121) & FAS 468 (ARMINGTON ROAD)  
 •• (109) RS-4, 0-2 (118) O) PP

FILE NAME =	USER NAME = shorptd	DESIGNED -	REVISED -
S:\CONTRMAINT\CAD\72K18 - FAS 1774 IOL	IL 121 - FAS 468 (ARMINGTON ROAD) A-2\PLANS	72K18-but-joint.dgn	
Default	PLOT SCALE = 1:2000 ' / in.	CHECKED -	REVISED -
	PLOT DATE = 10/11/2017	DATE -	REVISED -

**STATE OF ILLINOIS  
 DEPARTMENT OF TRANSPORTATION**

<b>BUTT JOINT DETAILS</b>	
SCALE: _____	SHEET OF SHEETS STA. _____ TO STA. _____

F.A.S. RTE.	SECTION	CDUNTY	TOTAL SHEETS	SHEET NO.
*	**	LDGAN/TAZEWEI	9	9
CONTRACT NO. 72K18				
ILLINOIS FED. AID PROJECT				