

**CONSTRUCTION PLANS**

**REHABILITATE THE PAVEMENT AROUND HANGAR G**

**DECATUR PARK DISTRICT  
DECATUR AIRPORT (DEC)  
DECATUR, MACON COUNTY, ILLINOIS**

**IDA PROJECT NO. DEC-4497  
A.I.P. PROJECT NO. 3-17-SBGP-133**

VICINITY MAP

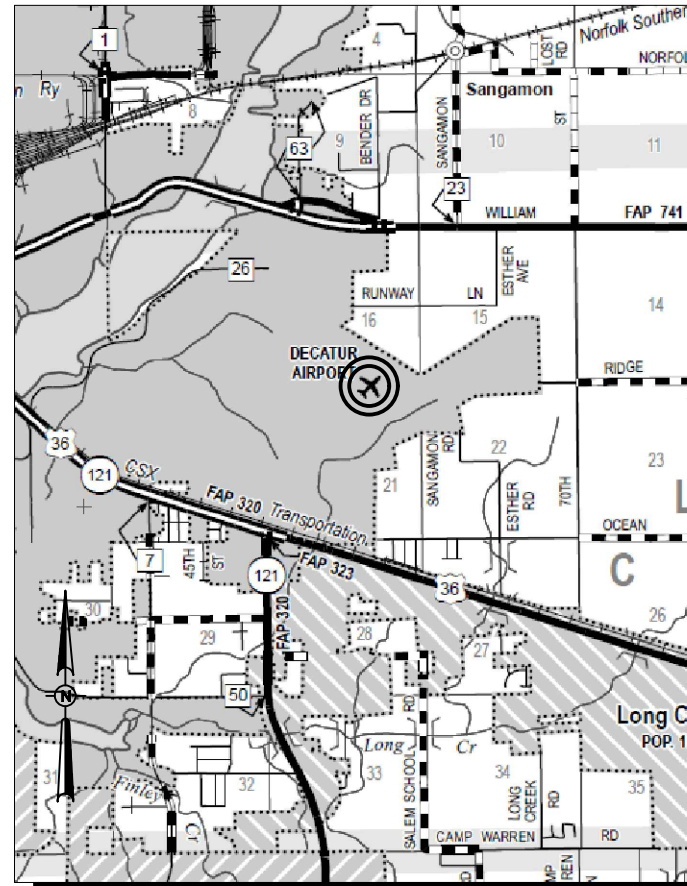

LOCATION MAP

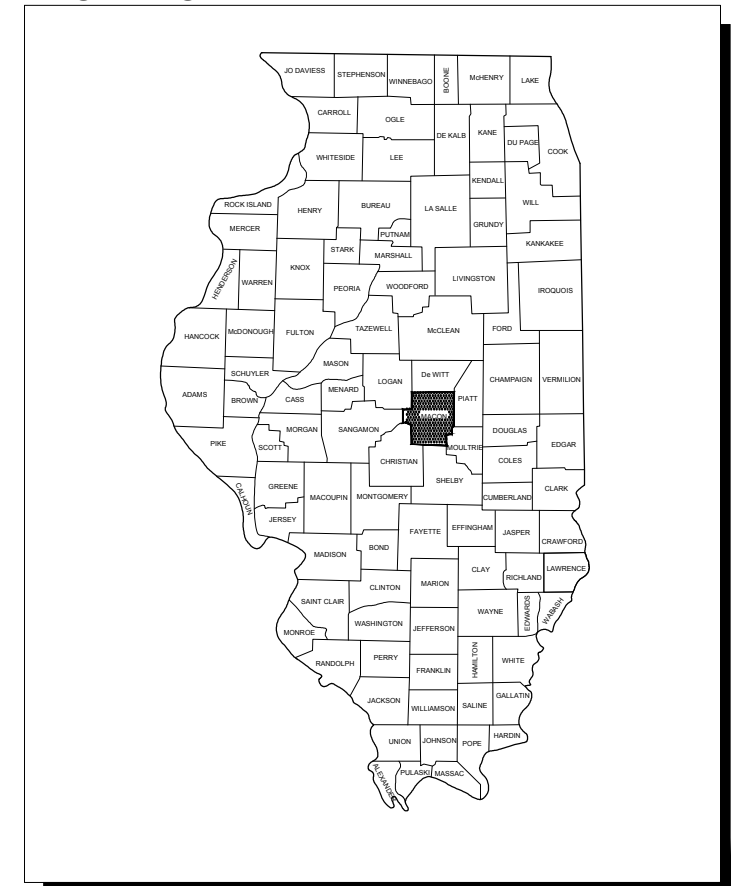

**NOTICE TO CONTRACTORS AND BIDDERS**

THESE CONSTRUCTION PLANS RELY UPON THE SPECIAL PROVISIONS AND THE SPECIFICATIONS TO PROVIDE FOR A COMPLETE DESCRIPTION OF THE WORK AND CONSTRUCTION REQUIREMENTS. THE PLANS SHALL ONLY BE USED IN COMBINATION WITH ALL CONTRACT DOCUMENTS.

| No. | Issue/Description | Sheets Changed | Date | By |
|-----|-------------------|----------------|------|----|
|     |                   |                |      |    |
|     |                   |                |      |    |
|     |                   |                |      |    |
|     |                   |                |      |    |
|     |                   |                |      |    |
|     |                   |                |      |    |
|     |                   |                |      |    |
|     |                   |                |      |    |
|     |                   |                |      |    |
|     |                   |                |      |    |

**PREPARED BY:**

**HANSON**  
HANSON PROFESSIONAL SERVICES INC.  
1525 South Sixth Street  
Springfield, Illinois 62703-2886  
Telephone: 217.788.2450  
Fax: 217.788.2503

**DATE OF PLANS:**  
Nov. 24, 2017

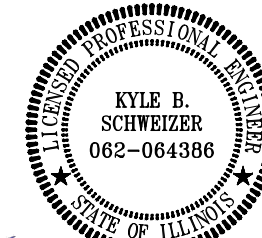

*Kyle Schweitzer*  
Kyle Schweitzer, P.E.  
Project Engineer

NOVEMBER 24, 2017  
Date  
Lic. Exp. 11/30/2019



DECATUR PARK DISTRICT  
DECATUR AIRPORT  
910 South Airport Road  
Decatur, Illinois 62521  
Telephone: 217.428.2423

*Tim Wright*  
Tim Wright  
Airport Director

NOVEMBER 24, 2017  
Date



| INDEX TO SHEETS |                                       |
|-----------------|---------------------------------------|
| SHEET NUMBER    | SHEET TITLE                           |
| 1               | COVER SHEET                           |
| 2               | SHEET INDEX AND SUMMARY OF QUANTITIES |
| 3               | SITE PLAN AND GENERAL NOTES           |
| 4               | CONSTRUCTION SAFETY PLAN AND DETAILS  |
| 5               | STORMWATER POLLUTION PREVENTION PLAN  |
| 6               | SWPPP DETAILS                         |
| 7               | TYPICAL SECTIONS                      |
| 8               | REMOVAL PLAN                          |
| 9               | CONSTRUCTION PLAN                     |
| 10              | JOINTING PLAN                         |
| 11              | JOINTING DETAILS                      |
| 12              | STAKING PLAN                          |
| 13              | APRON CROSS SECTIONS                  |
| 14              | ACCESS ROAD CROSS SECTIONS            |

| SUMMARY OF QUANTITIES |                               |      |                |                   |
|-----------------------|-------------------------------|------|----------------|-------------------|
| ITEM NO.              | DESCRIPTION                   | UNIT | TOTAL QUANTITY | AS-BUILT QUANTITY |
| AR150510              | ENGINEER'S FIELD OFFICE       | L.S. | 1              |                   |
| AR150520              | MOBILIZATION                  | L.S. | 1              |                   |
| AR152411              | UNCLASSIFIED EXCAVATION       | L.S. | 1              |                   |
| AR152480              | SHOULDER ADJUSTMENT           | S.Y. | 235            |                   |
| AR152511              | SUBGRADE REPAIR               | S.Y. | 200            |                   |
| AR152540              | SOIL STABILIZATION FABRIC     | S.Y. | 3,843          |                   |
| AR156510              | SILT FENCE                    | L.F. | 450            |                   |
| AR209604              | CRUSHED AGG. BASE COURSE - 4" | S.Y. | 3,843          |                   |
| AR401900              | REMOVE BITUMINOUS PAVEMENT    | S.Y. | 3,737          |                   |
| AR501501              | TEST BATCH PCC CONCRETE       | EA.  | 1              |                   |
| AR501506              | 6" PCC PAVEMENT               | S.Y. | 3,795          |                   |
| AR620520              | PAVEMENT MARKING-WATERBORNE   | S.F. | 422            |                   |
| AR620525              | PAVEMENT MARKING-BLACK BORDER | S.F. | 428            |                   |
| AR904510              | SODDING                       | S.Y. | 235            |                   |
|                       |                               |      |                |                   |
|                       |                               |      |                |                   |
|                       |                               |      |                |                   |

**REHABILITATE THE PAVEMENT AROUND HANGAR G**

IDA No: DEC-4497  
AIP No: 3-17-SBGP-133

Contract No. DE078

| NO. | DATE | DESCRIPTION |     |     |
|-----|------|-------------|-----|-----|
|     |      | DES         | DWN | REV |
|     |      |             |     |     |
|     |      |             |     |     |
|     |      |             |     |     |
|     |      |             |     |     |
|     |      |             |     |     |
|     |      |             |     |     |
|     |      |             |     |     |

ISSUE: NOVEMBER 24, 2017

PROJECT NO: 16A0021  
CAD FILE: G-002-FLP.DWG  
DESIGN BY: KMS 01/19/2017  
DRAWN BY: KMS 01/19/2017  
REVIEWED BY: KBS 03/02/2017

SHEET TITLE

SHEET INDEX AND SUMMARY OF QUANTITIES

**REHABILITATE THE PAVEMENT AROUND HANGAR G**

IDA No: DEC-4497  
AIP No: 3-17-SBGP-133

Contract No. DE078

| NO. | DATE | DESCRIPTION |     |     |     |
|-----|------|-------------|-----|-----|-----|
|     |      |             | DES | DWN | REV |
|     |      |             |     |     |     |
|     |      |             |     |     |     |
|     |      |             |     |     |     |
|     |      |             |     |     |     |
|     |      |             |     |     |     |
|     |      |             |     |     |     |

ISSUE: NOVEMBER 24, 2017  
PROJECT NO: 16A0021  
CAD FILE: G-003-SIT.DWG  
DESIGN BY: KMS 01/12/2017  
DRAWN BY: KMS 01/12/2017  
REVIEWED BY: KBS 03/02/2017

SHEET TITLE

**SITE PLAN AND GENERAL NOTES**

**SCOPE OF WORK**

THE PROJECT SCOPE CONSISTS OF FULLY REMOVING THE EXISTING BITUMINOUS PAVEMENT ON THE SOUTH AND WEST SIDES OF HANGAR G AND THE WEST SIDE ACCESS ROAD FOR HANGAR F AND HANGAR G. THE FULL DEPTH REMOVAL AND REPLACEMENT INCLUDES REMOVAL OF UNDERLYING MATERIALS DOWN TO A DEPTH OF 10" AND INSTALLING SEPARATION FABRIC FOLLOWED BY 4" OF CRUSHED AGGREGATE SUBBASE, AND 6" OF PCC PAVEMENT WITH ASSOCIATED GRADING AS SHOWN. MARKING IS TO BE REPLACED IN THE SAME LOCATION AS PRIOR TO CONSTRUCTION, AND NON PAVEMENT AREAS WILL BE RESTORED.

**GENERAL NOTES**

1. THE PROJECT PAY ITEMS ARE INTENDED TO BE INCLUSIVE OF ALL WORK TO BE PERFORMED AS SHOWN IN THESE PLANS. ALL INCIDENTAL WORK REQUIRED TO COMPLETE THE PROJECT TO THE SATISFACTION OF THE RESIDENT ENGINEER IS TO BE INCLUDED IN THE COSTS OF PERFORMING THESE ITEMS. THE CONTRACTOR SHALL FURNISH ALL LABOR, MATERIAL, EQUIPMENT, AND TRANSPORTATION NECESSARY TO CONSTRUCT ALL ELEMENTS OF THE PROJECT AS DESCRIBED IN THE CONSTRUCTION PLANS AND SPECIFICATIONS.
2. THE RULES, REGULATIONS, AND SPECIFICATIONS ENUMERATED HEREIN SHALL BE CONSIDERED AS MINIMUM REQUIREMENTS. THEY SHALL NOT PROHIBIT THE CONTRACTOR FROM FURNISHING AND INSTALLING HIGHER GRADES OF MATERIAL THAN ARE SPECIFIED HEREIN, IF APPROVED BY THE ENGINEER.
3. ACCESS TO THE SITE SHALL BE RESTRICTED EXCLUSIVELY TO THE DESIGNATED CONSTRUCTION ENTRANCE, STAGING AREA, AND HAUL ROUTE. NO EQUIPMENT OR PERSONNEL SHALL BE PERMITTED OUTSIDE THE GENERAL PROJECT AREA.
4. IT SHALL BE THE RESPONSIBILITY OF THE CONTRACTOR TO PROTECT AND KEEP CLEAN OF DEBRIS ALL EXISTING AIRFIELD AND ROADWAY PAVEMENTS AT ALL TIMES. ANY DAMAGE TO EXISTING ELECTRICAL, DRAINAGE, AND PAVEMENT STRUCTURES SHALL BE IMMEDIATELY REPAIRED AT NO ADDITIONAL COST TO THE CONTRACT.
5. CONTRACTOR IS REQUIRED TO PROVIDE THEIR OWN RESTROOM FACILITIES.
6. THE LOCATION OF THE ENGINEER'S FIELD OFFICE WILL BE DETERMINED AT THE PRE-CONSTRUCTION MEETING.
7. THE OWNER SHALL HAVE THE RIGHT OF FIRST REFUSAL FOR ALL SALVAGEABLE MATERIAL REMOVED ON THE PROJECT.
8. THE CONTRACTOR SHALL BE RESPONSIBLE FOR OBTAINING PERMITS FOR HAULING ON PUBLIC ROADS, AS APPLICABLE. THE CONTRACTOR SHALL BE RESPONSIBLE FOR CORRECTING ANY DAMAGES TO ANY PAVEMENTS (PUBLIC OR PRIVATE) CAUSED BY HIS/HER CONSTRUCTION EQUIPMENT OR PERSONNEL.
9. THE CONTRACTOR SHALL PROVIDE ONE SET OF PRELIMINARY REDLINED RECORD DRAWINGS TO THE RESIDENT ENGINEER AT THE COMPLETION OF THE PROJECT FOR INCORPORATION INTO THE OFFICIAL RECORD DRAWINGS HE WILL PREPARE.
10. APPROXIMATE LOCATIONS OF UNDERGROUND UTILITIES ARE SHOWN THROUGHOUT THESE PLANS. THE CONTRACTOR SHALL DETERMINE EXACT LOCATIONS AND PROTECT THESE UTILITIES DURING CONSTRUCTION. ANY UTILITIES DAMAGED DURING CONSTRUCTION SHALL BE REPAIRED AT THE CONTRACTOR'S EXPENSE. CONTRACTOR SHALL COORDINATE WITH THE PROPER AUTHORITIES FOR THE PURPOSE OF LOCATING AND PROTECTING EXISTING UNDERGROUND UTILITIES.
11. **NPDES PERMIT** - THIS PROJECT WILL NOT DISTURB MORE THAN 1 ACRE, THEREFORE A NPDES PERMIT IS NOT REQUIRED.
12. **MATERIAL CERTIFICATIONS** - MATERIALS CANNOT BE INSTALLED UNTIL ALL THE MATERIAL CERTIFICATIONS FOR THAT ITEM HAVE BEEN RECEIVED, REVIEWED AND ACCEPTED BY THE RESIDENT ENGINEER. MATERIALS INSTALLED WITHOUT APPROVAL ARE SUBJECT TO REMOVAL AND REPLACEMENT AT THE CONTRACTOR'S EXPENSE.
13. **CERTIFIED PAYROLLS** - THE RESIDENT ENGINEER CANNOT FORWARD A CONSTRUCTION REPORT FOR PAYMENT TO THE IDOT-DIVISION OF AERONAUTICS FOR PROCESSING UNTIL ALL CERTIFIED PAYROLLS FOR THAT PERIOD HAVE BEEN RECEIVED.

**UTILITY NOTE**

THE LOCATION, SIZE, AND TYPE OF MATERIAL OF EXISTING UNDERGROUND AND/OR ABOVEGROUND UTILITIES INDICATED ON THE PLANS ARE NOT REPRESENTED AS BEING ACCURATE, SUFFICIENT OR COMPLETE. NEITHER THE OWNER NOR THE ENGINEER ASSUMES ANY RESPONSIBILITY WHATEVER IN RESPECT TO THE ACCURACY, COMPLETENESS, OR SUFFICIENCY OF THE INFORMATION. THERE IS NO GUARANTEE, EITHER EXPRESSED OR IMPLIED, THAT THE LOCATIONS, SIZE AND TYPE OF MATERIAL OF EXISTING UNDERGROUND UTILITIES INDICATED ARE REPRESENTATIVE OF THOSE TO BE ENCOUNTERED IN THE CONSTRUCTION. IT SHALL BE THE CONTRACTOR'S RESPONSIBILITY TO DETERMINE THE ACTUAL LOCATION OF ALL SUCH FACILITIES, INCLUDING SERVICE CONNECTIONS TO UNDERGROUND UTILITIES. PRIOR TO CONSTRUCTION, THE CONTRACTOR SHALL NOTIFY THE UTILITY COMPANIES OF HIS OPERATIONAL PLANS AND SHALL OBTAIN FROM THE RESPECTIVE UTILITY COMPANIES DETAILED INFORMATION AND ASSISTANCE RELATIVE TO THE LOCATION OF THEIR FACILITIES AND THE WORKING SCHEDULE OF THE COMPANIES FOR REMOVAL OR ADJUSTMENT WHERE REQUIRED. IN THE EVENT AN UNEXPECTED UTILITY INTERFERENCE IS ENCOUNTERED DURING CONSTRUCTION, THE CONTRACTOR SHALL IMMEDIATELY NOTIFY THE UTILITY COMPANY OF JURISDICTION. THE OWNER'S REPRESENTATIVE AND/OR THE RESIDENT ENGINEER SHALL ALSO BE IMMEDIATELY NOTIFIED. ANY DAMAGE TO SUCH MAINS AND SERVICES SHALL BE RESTORED TO SERVICE AT ONCE AND PAID FOR BY THE CONTRACTOR AT NO ADDITIONAL COST TO THE CONTRACT. ALL UTILITY CABLES AND LINES SHALL BE LOCATED BY THE RESPECTIVE UTILITY. **CONTACT JULIE (JOINT UTILITY LOCATION INFORMATION FOR EXCAVATORS) FOR UTILITY INFORMATION, PHONE: 1-800-892-0123.** CONTACT THE FAA (FEDERAL AVIATION ADMINISTRATION) FOR ASSISTANCE IN LOCATING FAA CABLES AND UTILITIES. LOCATION OF FAA POWER, CONTROL, AND COMMUNICATION CABLES SHALL BE COORDINATED WITH AND/OR LOCATED BY THE FAA. ALSO CONTACT AIRPORT DIRECTOR/MANAGER AND AIRPORT PERSONNEL FOR ASSISTANCE IN LOCATING UNDERGROUND AIRPORT CABLES AND/OR UTILITIES. ALSO COORDINATE WORK WITH ALL ABOVEGROUND UTILITIES.

**J.U.L.I.E. INFORMATION**

COUNTY \_\_\_\_\_ MACON  
CITY \_\_\_\_\_ DECATUR  
TOWNSHIP \_\_\_\_\_ LONG CREEK  
SECTION NO. \_\_\_\_\_ 20 & 21  
ADDRESS \_\_\_\_\_ DECATUR AIRPORT  
AIRPORT ROAD  
DECATUR, IL 62524

**SURVEY CONTROL NOTES**

1. ALL COORDINATES SHOWN IN ARE REFERENCED TO THE ILLINOIS STATE PLANE COORDINATE SYSTEM, EAST ZONE, NAD-83.
2. THE CONTRACTOR SHALL BE RESPONSIBLE FOR ALL CONSTRUCTION LAYOUT AND ANY EXTENSION OF THE CONTROL NETWORK NEEDED TO PROPERLY COMPLETE THE WORK.

**HORIZONTAL & VERTICAL CONTROL DATA**

| NO. | DESCRIPTION  | NORTHING     | EASTING    | ELEV.  |
|-----|--|--------------|------------|--------|
| 1   | NGS MONUMENT "Z 262" - DISK IN CONCRETE              | 1,154,102.83 | 831,234.41 | 676.30 |
| 2   | MW1 - IRON PIN IN GRASS                              | 1,154,503.01 | 831,190.79 |        |
| 3   | MW2 - IRON PIN IN GRASS                              | 1,154,836.08 | 831,186.22 |        |
| 4   | CHISELED "X" ON TOP N.E. FLANGE BOLT OF FIRE HYDRANT |              |            | 676.19 |

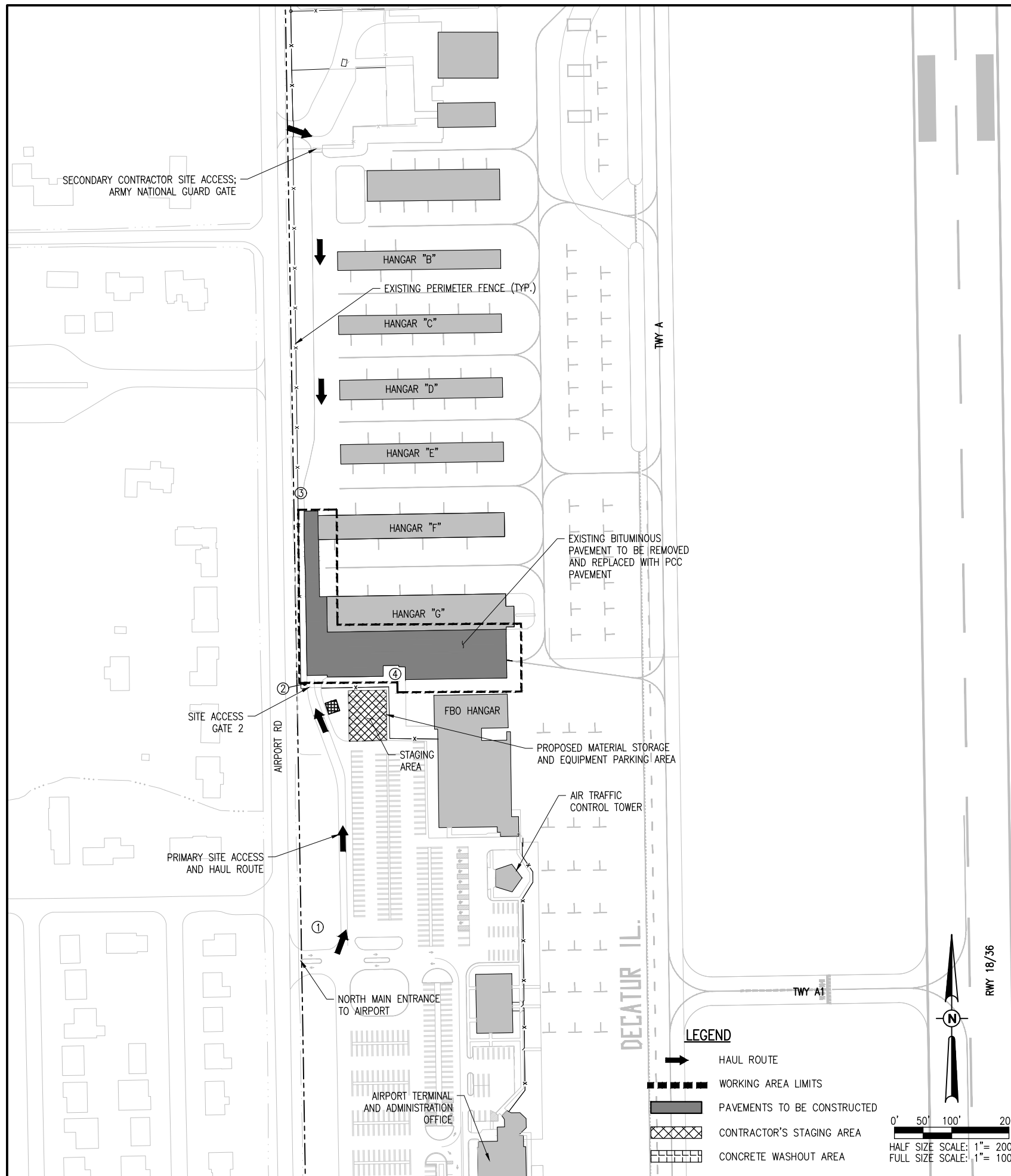



**PROPOSED SAFETY PLAN**

- GENERAL – THE DECATUR AIRPORT IS TOWER CONTROLLED FROM 6 A.M. TO 10 P.M. AND IS COMPRISED OF THREE RUNWAYS AND THE ASSOCIATED TAXIWAY SYSTEM. THE PROPOSED CONSTRUCTION WILL NOT NECESSITATE CLOSING ANY RUNWAYS AND/OR TAXIWAYS. THE APRON IN FRONT OF HANGAR "G" AND A PORTION ON THE ACCESS ROAD ON THE WEST SIDE OF THE NORTH T-HANGARS WILL BE CLOSED FOR THE PROJECT DURATION.
- THE CONTRACTOR SHALL HAVE THE SAFETY PLAN COMPLIANCE DOCUMENT (SPCD), AS DETAILED IN THE SPECIAL PROVISIONS, SUBMITTED AND APPROVED PRIOR TO BEING ISSUED "NOTICE TO PROCEED".
- CONTRACTOR WILL NOTIFY THE AIRPORT A MINIMUM OF 30 DAYS BEFORE THE DESIRED STARTING DATE TO ALLOW FOR TEMPORARY RELOCATION OF AIRCRAFT INSIDE HANGAR "G".
- BARRICADES SHALL BE PLACED IN PLACE BEFORE ANY WORK BEGINS AND FOR THE DURATION OF THE PROJECT.
- AIRPORT SECURITY WILL BE MAINTAINED AT ALL TIMES. ONLY CONTRACTOR EMPLOYEES SHALL BE ALLOWED WITHIN THE PROJECT LIMITS. GATES SHALL BE CLOSED AT ALL TIMES UNLESS THE CONTRACTOR IS IN A CONTINUOUS HAULING OPERATIONS, DURING WHICH TIME HE WILL PROVIDE A PERSON TO MONITOR THE GATE AREA.
- CONTRACTOR SHALL USE THE DESIGNATED PRIMARY HAUL ROUTE FROM THE SOUTH, UNLESS DIRECTED BY THE RESIDENT ENGINEER/TECHNICIAN TO USE THE SECONDARY ROUTE FROM THE NORTH.
- ALL SAFETY RELATED WORK OR MAINTENANCE IS INCIDENTAL TO THE CONTRACT.
- NO EQUIPMENT TALLER THAN 25' WILL BE ALLOWED ONSITE WITHOUT PRIOR REQUEST AND AIRSPACE APPROVAL BY FAA.

**SAFETY NOTES**

- ALL CONSTRUCTION/OPERATIONS ARE TO BE PERFORMED IN ACCORDANCE WITH FAA ADVISORY CIRCULAR (AC) 150/5370-2F "OPERATIONAL SAFETY ON AIRPORTS DURING CONSTRUCTION".
- ALL CONSTRUCTION EQUIPMENT ON THE AIRPORT SHALL BE MARKED, LIGHTED AND/OR FLAGGED IN ACCORDANCE WITH AC 150/5210-5 AND 70/7460-1.
- THE CONTRACTOR'S EMPLOYEES WILL PARK THEIR VEHICLES IN THE DESIGNATED EQUIPMENT PARKING AND STORAGE AREA AS SHOWN ON THIS SHEET. ONLY CONTRACTOR VEHICLES WILL BE ALLOWED OUTSIDE THIS AREA.
- THE CONTRACTOR AND HIS EMPLOYEES WILL BE RESTRICTED TO THE WORK AREA AND ALL OTHER AREAS OF THE AIRPORT ARE "OFF LIMITS" TO THEM.
- ALL WORK PERFORMED SHALL BE DONE IN A ORDERLY AND EFFECTIVE MANNER TO MINIMIZE DISRUPTION TO AIRPORT OPERATIONS.
- THE CONTRACTOR IS TO BE RESPONSIBLE FOR THE PROTECTION OF DRIVEWAY AND ROAD PAVEMENT AND SHOULDERS; RUNWAY, TAXIWAY AND APRON PAVEMENTS AND SHOULDERS; RUNWAY, TAXIWAY AND AIRPORT LIGHTING EQUIPMENT; AND SEEDED AND TURFED AREAS THAT ARE UTILIZED IN OR AFFECTED BY THE CONTRACTOR'S ACTIVITIES. ITEMS DAMAGED BY THE CONTRACTOR ARE TO BE REPAIRED AT THE CONTRACTOR'S EXPENSE AND TO THE SATISFACTION OF AIRPORT MANAGER AND THE OWNER'S REPRESENTATIVE.
- WHEN CONDITIONS DICTATE OR AS DETERMINED BY THE AIRPORT MANAGER OR THE OWNER'S REPRESENTATIVE THE CONTRACTOR SHALL BE REQUIRED TO USE A PICK-UP TYPE SWEEPER IN ALL ACTIVE CONSTRUCTION PAVEMENT AREAS. THE CONTRACTOR WILL BE REQUIRED TO HAVE A SWEEPER AVAILABLE FOR USE AT ALL TIMES. THE COST OF SWEEPING SHALL BE CONSIDERED INCIDENTAL TO THE CONTRACT.
- IDENTIFICATION- WHEN THE CONTRACTORS VEHICLES AND EQUIPMENT ARE ON THE AIRPORT THEY SHALL BE PROPERLY MARKED WITH THREE (3') FOOT SQUARE CHECKERED FLAGS (INTERNATIONAL ORANGE AND WHITE). THE CONTRACTOR WILL ALSO PROVIDE WORKERS WITH SOME TYPE OF TAG OR GARMENT TO IDENTIFY THE PERSON AS BEING PART OF THE CONSTRUCTION CREW.
- RADIO CONTROL- THE CONTRACTOR WILL BE REQUIRED TO BE IN TWO-WAY RADIO CONTACT WITH THE AIRPORT CONTROL TOWER – GROUND FREQUENCY (121.75 MHz). THIS WILL KEEP THE CONTRACTOR IN CONSTANT CONTACT WITH THE DECATUR AIRPORT CONTROL TOWER IN CASE OF AN AERONAUTICAL EMERGENCY THAT WOULD REQUIRE ACTION BY THE CONTRACTOR AND/OR HIS PERSONNEL.

**NOTES:**

- INTENDED USE FOR THE FOLLOWING:
  - MARKING/LIGHTING OF TEMPORARY HAZARDS WITHIN THE AOA.
  - LONGTERM CLOSURE OF AIRCRAFT ROUTES.
- INSTALL AT 12' CENTER TO CENTER SPACING ALONG FULL WIDTH OF PAVEMENT.
- USE IN AREAS SUBJECT TO JET BLAST.
- BARRICADE SHALL BE EQUIPPED WITH ALTERNATING ORANGE AND WHITE 20" X 20" FLAGS.
- BARRICADES SHALL BE WATER-FILLED AND MODULAR TO ASSEMBLE/DISASSEMBLE AND NEST FOR COMPACT STORAGE.
- CONTRACTOR MAY SUBMIT ALTERNATIVE BARRICADE FOR APPROVAL BY ENGINEER. ALTERNATIVE MUST MEET MINIMUM REQUIREMENTS OF FAA AC 150/5370-2F (LATEST EDITION).
- FURNISHING, INSTALLING, MAINTAINING AND REMOVING BARRICADES SHALL BE INCIDENTAL TO THE CONTRACT.
- CONTRACTOR SHALL MAINTAIN THE BARRICADES. ANY DAMAGED BARRICADES SHALL BE REPLACED AND NEW BARRICADES PROVIDED.

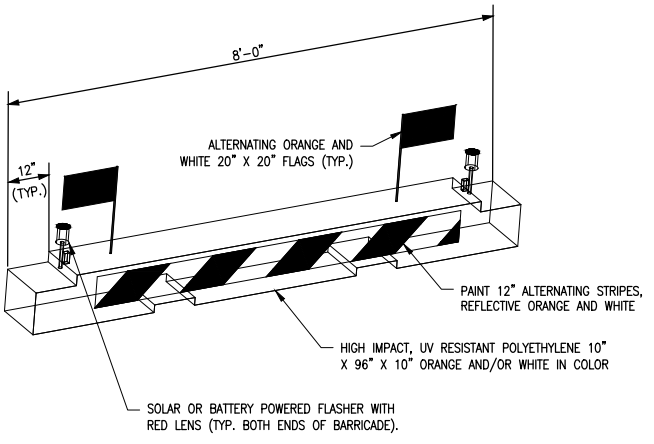

**LOW PROFILE AIRCRAFT BARRICADE DETAIL**

| CRITICAL POINTS     |                  |                 |              |              |
|---------------------|------------------|-----------------|--------------|--------------|
| NAME                | LATITUDE         | LONGITUDE       | HEIGHT (AGL) | GROUND ELEV. |
| CP1 - CONST. EQUIP. | N 088-52-41.8112 | W 39-50-11.2775 | 25'-0"       | 676.0        |
| CP2 - CONST. EQUIP. | N 088-52-37.5886 | W 39-50-08.8601 | 25'-0"       | 674.2        |

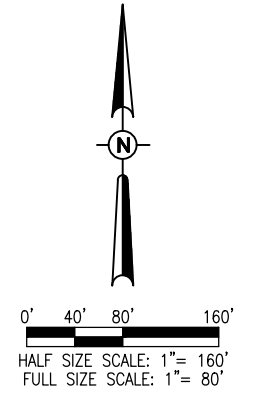
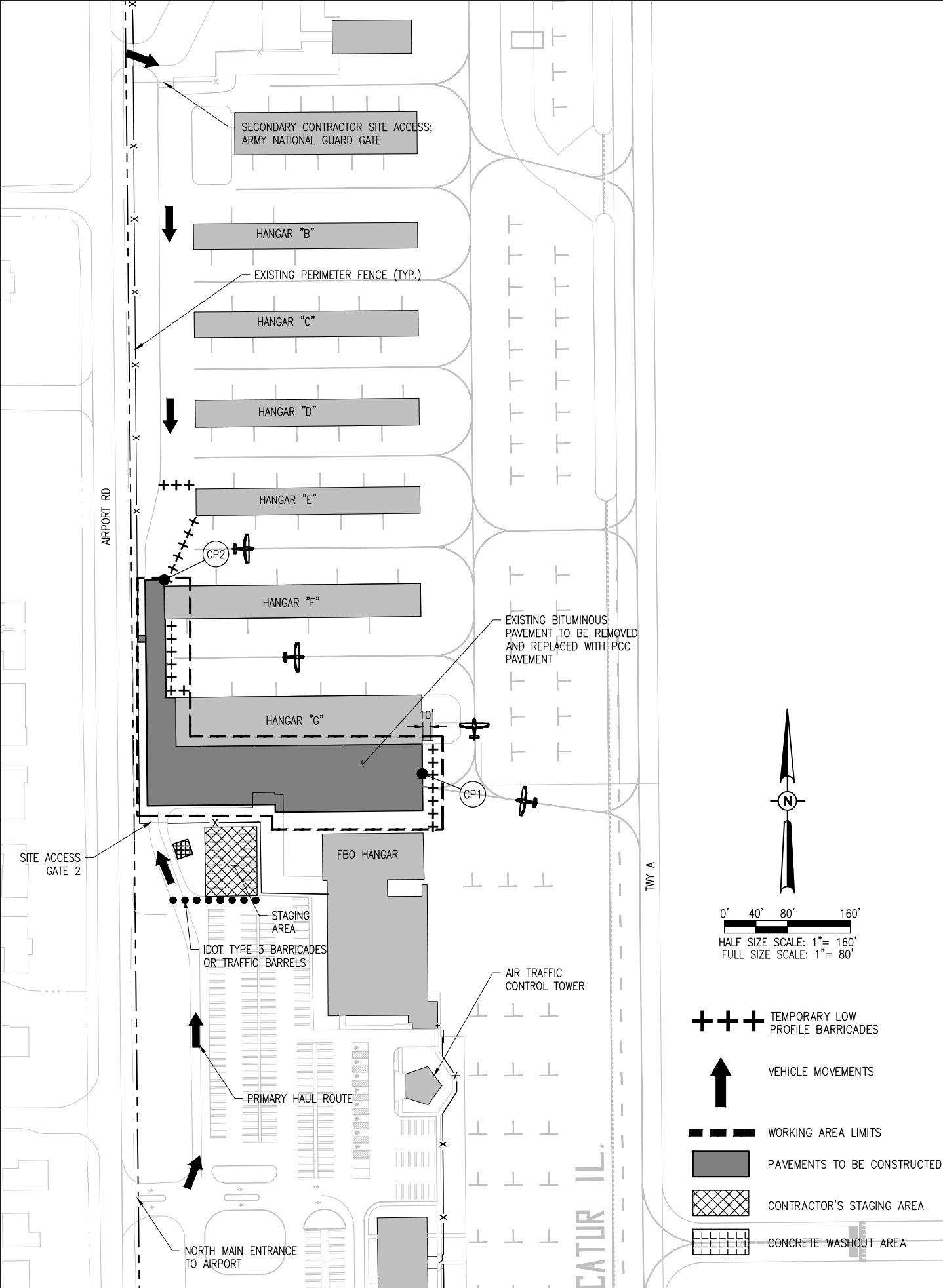

- +++ TEMPORARY LOW PROFILE BARRICADES
- ↑ VEHICLE MOVEMENTS
- WORKING AREA LIMITS
- PAVEMENTS TO BE CONSTRUCTED
- ▨ CONTRACTOR'S STAGING AREA
- CONCRETE WASHOUT AREA

I:\16\0851\16A0021\16A0021\DCAD\AIRPORT\SHHEET\G-004-SFY.DWG  
NOV 28, 2017 11:25 AM ISCHWED1286

**REHABILITATE THE PAVEMENT AROUND HANGAR G**

IDA No: DEC-4497  
AIP No: 3-17-SBGP-133

Contract No. DE078

| NO. | DATE | DESCRIPTION |     |     |
|-----|------|-------------|-----|-----|
|     |      | DES         | DWN | REV |
|     |      |             |     |     |
|     |      |             |     |     |
|     |      |             |     |     |
|     |      |             |     |     |
|     |      |             |     |     |

ISSUE: NOVEMBER 24, 2017  
PROJECT NO: 16A0021  
CAD FILE: G-004-SFY.DWG  
DESIGN BY: KMS 01/13/2017  
DRAWN BY: KMS 01/13/2017  
REVIEWED BY: KBS 03/02/2017

SHEET TITLE

**CONSTRUCTION SAFETY PLAN AND DETAILS**



**EROSION CONTROL NOTES**

1. THIS PROJECT WILL DISTURB LESS THAN 1 ACRE OF LAND, THEREFORE NO N.P.D.E.S. PERMIT WILL BE REQUIRED.
2. SOIL EROSION AND SEDIMENT CONTROL MAINTENANCE MUST OCCUR, AT A MINIMUM, EVERY WEEK OR AFTER EVERY 1/2" INCH OR GREATER RAINFALL EVENT.
3. CONTRACTOR IS RESPONSIBLE FOR ALL SITE MAINTENANCE UNTIL THE SITE IS TURNED OVER. THIS INCLUDES MOWING WHERE VEGETATION HAS BEGUN TO GROW BEFORE SUBSTANTIAL COMPLETION.

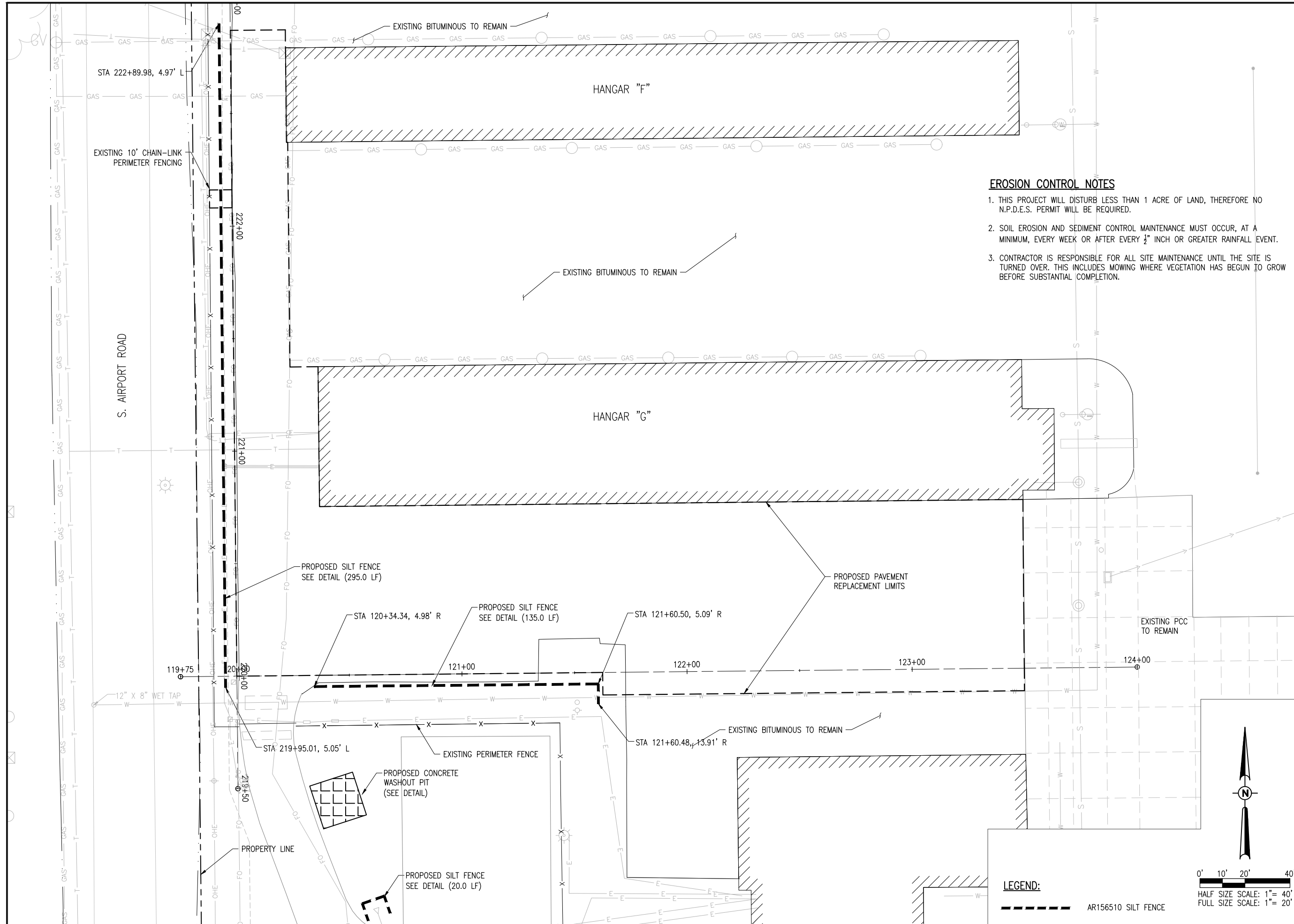

**LEGEND:**

--- AR156510 SILT FENCE

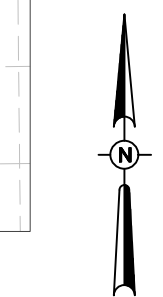

0' 10' 20' 40'  
HALF SIZE SCALE: 1" = 40'  
FULL SIZE SCALE: 1" = 20'

**REHABILITATE THE PAVEMENT AROUND HANGAR G**

IDA No: DEC-4497  
AIP No: 3-17-SBGP-133

Contract No. DE078

| NO. | DATE | DESCRIPTION |     |     |
|-----|------|-------------|-----|-----|
|     |      | DES         | DWN | REV |
|     |      |             |     |     |
|     |      |             |     |     |
|     |      |             |     |     |
|     |      |             |     |     |
|     |      |             |     |     |

ISSUE: NOVEMBER 24, 2017  
PROJECT NO: 16A0021  
CAD FILE: C-181-SWP.DWG  
DESIGN BY: KMS 01/13/2017  
DRAWN BY: KMS 01/13/2017  
REVIEWED BY: KMS 02/03/2017

SHEET TITLE

**STORMWATER POLLUTION PREVENTION PLAN**

I:\16\0021\16A0021\CAD\AIRPORT\ISHEET\C-181-SWP.DWG  
NOV 28, 2017 11:26 AM ISCHWED1286

**STORM WATER POLLUTION PREVENTION NOTES**

1. THE CONTRACTOR SHALL IMPLEMENT ALL PROVISIONS OF THE CONTRACT DOCUMENTS TO ASSURE THAT STORM WATER POLLUTION PREVENTION ITEMS ARE CONSTRUCTED AND MAINTAINED IN A TIMELY MANNER. SEDIMENTATION MUST NOT BE TRANSPORTED OFF THE CONSTRUCTION SITE. PERMANENT DRAINAGE FEATURES AND VEGETATIVE MEASURES SHALL BE PROVIDED AS SOON AS POSSIBLE.
2. THE MAINTENANCE OF ALL STORM WATER POLLUTION PREVENTION MEASURES IS INCIDENTAL TO THE ASSOCIATED ITEM.
3. THE CONTRACTOR SHALL BE REQUIRED TO IMPLEMENT AND MAINTAIN STORM WATER POLLUTION PREVENTION PRACTICES AND MEASURES PRIOR TO THE STRIPPING OF EXISTING VEGETATION WHEREVER POSSIBLE AND AS SOON AS CONSTRUCTION PERMITS IN OTHER AREAS. POLLUTION CONTROL MEASURES SHALL BE IN ACCORDANCE WITH THE CONTRACT DOCUMENTS, INCLUDING THESE CONSTRUCTION PLANS, AND WITH STANDARDS AND SPECIFICATIONS FOR SOIL EROSION AND SEDIMENT CONTROL, ILLINOIS ENVIRONMENTAL PROTECTION AGENCY, CURRENT ISSUE. THE CONTRACTOR SHALL ADJUST HIS OPERATIONS AND IMPLEMENT POLLUTION CONTROL MEASURES SO THAT NO RUNOFF FROM STRIPPED AREAS WILL LEAVE THE CONSTRUCTION SITE OTHER THAN THROUGH SEDIMENT TRAPS OR OTHER SUITABLE CONTROL MEASURES.
4. POLLUTION CONTROL ITEMS SHALL BE PROVIDED AS NOTED ON THE STORM WATER POLLUTION PREVENTION PLAN AND IN THE STORM WATER POLLUTION PREVENTION DETAILS AND AS DIRECTED BY THE ENGINEER. THE LIMITS OF SUCH MEASURES SHALL BE STAKED BY THE CONTRACTOR PRIOR TO THE COMMENCEMENT OF CONSTRUCTION. SUCH LIMITS MAY BE ADJUSTED BY THE ENGINEER TO ACCOUNT FOR ACTUAL SITE CONDITIONS EXPERIENCED DURING CONSTRUCTION. ADDITIONAL COMPENSATION FOR MEASURES EXCEEDING THE PLAN QUANTITIES WILL BE PAID FOR AT THE CONTRACT UNIT PRICE FOR EACH ITEM.
5. THE CONTRACTOR IS TO MAINTAIN AND ADJUST, REPAIR OR REPLACE ALL POLLUTION PREVENTION MEASURES AS REQUIRED OR AS DIRECTED BY THE ENGINEER UNTIL PERMANENT VEGETATION HAS BEEN ESTABLISHED. MAINTENANCE OF POLLUTION CONTROL MEASURES IS TO BE PROVIDED AT NO ADDITIONAL COST TO THE CONTRACT.
6. ADDITIONAL STORMWATER POLLUTION PREVENTION MEASURES ARE EXISTING ON SITE LOCATED AT DRAINAGE FACILITIES AND ALONG THE PROPERTY LINE.

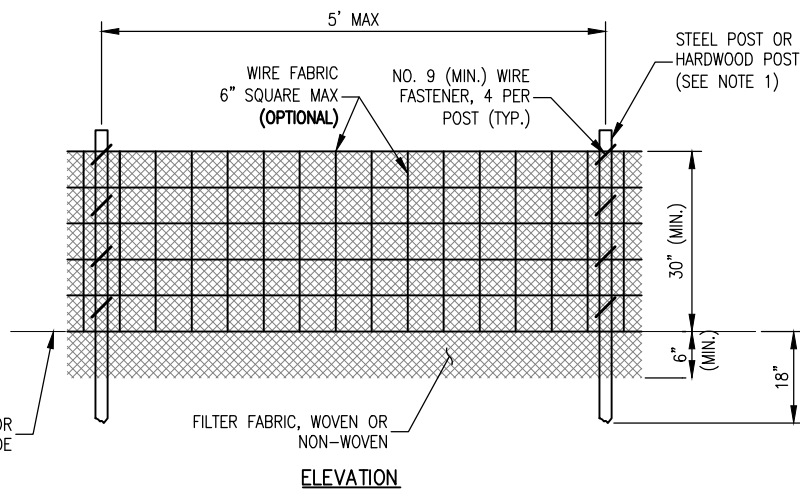
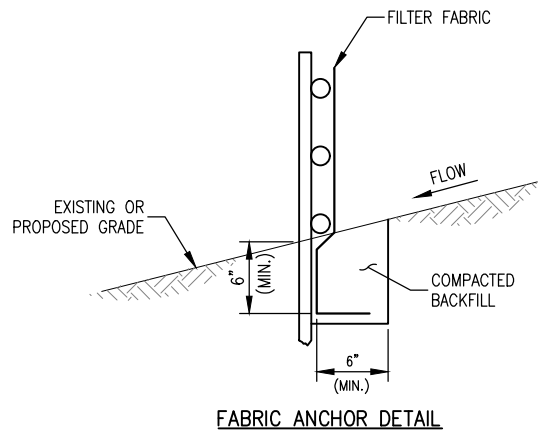

**NOTES:**

1. FENCE POST SHALL BE EITHER STEEL "T" LINE POST OR HARDWOOD POST WITH A MINIMUM SECTIONAL AREA OF 2.0 SQUARE INCHES. A CARPENTER'S (NOMINAL) 2"x2" POST WILL MEET SPECIFICATIONS.
2. TOP AND BOTTOM WIRE OF WIRE FABRIC SHALL BE MINIMUM GAGE NO. 9. INTERMEDIATE WIRES OF THE WIRE FABRIC SHALL BE MINIMUM GAGE NO. 11.
3. WIRE FABRIC SHALL BE SECURELY FASTENED TO FENCE POSTS WITH NO. 9 GAGE WIRE MINIMUM. FOUR (4) FASTENERS PER POST REQUIRED.
4. FILTER FABRIC SHALL BE SECURELY FASTENED TO WIRE FABRIC AND POSTS WITH TIES OR STAPLES SPACED AT 12" APART AT THE TOP, MIDDLE AND BOTTOM.
5. WHEN TWO SECTIONS OF FILTER FABRIC MEET, THEY SHALL BE OVERLAPPED BY 6" AND FOLDED AND ATTACHED TO THE WIRE FABRIC AT A POST.
6. FILTER FABRIC SHALL BE IN ACCORDANCE WITH SPECIAL PROVISIONS WITH APPARENT OPENING SIZE (AOS) OF AT LEAST 40 FOR NONWOVEN AND WOVEN (OR MAXIMUM OF 0.60mm).
7. SOIL DISTURBANCE SHALL BE CONDUCTED IN SUCH A MANNER AS TO MINIMIZE EROSION. SOIL STABILIZATION MEASURES SHALL CONSIDER THE TIME OF YEAR, SITE CONDITIONS AND THE USE OF TEMPORARY OR PERMANENT MEASURES.
8. ALL STORM SEWERS THAT ARE OR WILL BE FUNCTIONING DURING CONSTRUCTION SHALL BE PROTECTED BY AN APPROPRIATE SEDIMENT CONTROL MEASURE.
9. SILT FENCE SHALL BE INSTALLED PRIOR TO ANY GRADING WORK IN THE AREA TO BE PROTECTED. PERIODIC INSPECTION SHALL BE PERFORMED AND REQUIRED MAINTENANCE SHALL BE PROVIDED AFTER EACH RAIN EVENT.
10. MAINTENANCE SHALL BE PERFORMED AS NEEDED AND MATERIAL REMOVED AND REPLACED WHEN BULGES DEVELOP IN THE SILT FENCE.
11. IF DEWATERING SERVICES ARE USED, ADJOINING PROPERTIES AND DISCHARGE LOCATIONS SHALL BE PROTECTED FROM EROSION. DISCHARGES SHALL BE ROUTED THROUGH AN EFFECTIVE SEDIMENT CONTROL MEASURE (E.G. SEDIMENT TRAP, SEDIMENT BASIN, OR OTHER APPROPRIATE MEASURE).
12. FENCE POSTS SHALL BE REMOVED WHEN DIRECTED AT PROJECT END.
13. THE EROSION CONTROL MEASURES INDICATED ON THE PLANS ARE THE MINIMUM REQUIREMENTS. ADDITIONAL MEASURES MAY BE REQUIRED AS DIRECTED BY THE ENGINEER OR GOVERNING AGENCY.

**SILT FENCE**

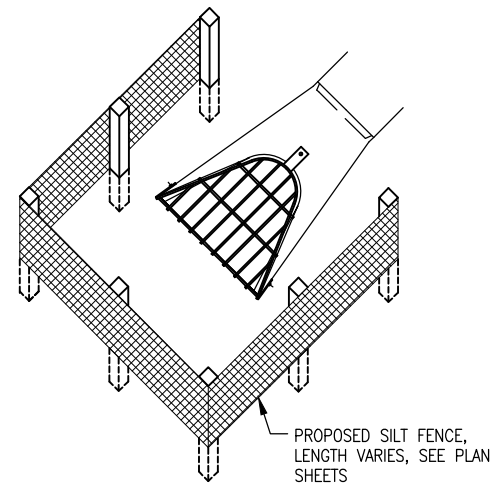

**SILT FENCE PLACEMENT AT FLARED END SECTIONS (FES)**

**SEDIMENTATION AND EROSION CONTROL NOTES:**

1. SOIL DISTURBANCE SHALL BE CONDUCTED IN SUCH A MANNER AS TO MINIMIZE EROSION. SOIL STABILIZATION MEASURES SHALL CONSIDER THE TIME OF YEAR, SITE CONDITIONS AND THE USE OF TEMPORARY OR PERMANENT MEASURES.
2. SOIL EROSION AND SEDIMENT CONTROL FEATURES SHALL BE CONSTRUCTED PRIOR TO THE COMMENCEMENT OF HYDROLOGIC DISTURBANCE OF UPLAND AREAS.
3. DISTURBED AREAS SHALL BE STABILIZED WITH TEMPORARY OR PERMANENT MEASURES WITHIN 14 CALENDAR DAYS OF THE END OF ACTIVE HYDROLOGIC DISTURBANCE, OR REDISTURBANCE.
4. AREAS OR EMBANKMENTS HAVING SLOPES GREATER THAN OR EQUAL TO 8H:1V SHALL BE STABILIZED WITH SOD, MAT OR BLANKET IN COMBINATION WITH SEEDING.
5. EROSION CONTROL BLANKET SHALL BE REQUIRED ON ALL INTERIOR DETENTION BASIN SIDE SLOPES BETWEEN NORMAL WATER LEVEL AND HIGH WATER LEVEL.
6. ALL STORM SEWERS THAT ARE OR WILL BE FUNCTIONING DURING CONSTRUCTION SHALL BE PROTECTED, BY AN APPROPRIATE SEDIMENT CONTROL MEASURE.
7. ALL TEMPORARY EROSION AND SEDIMENT CONTROL MEASURES SHALL BE REMOVED WITHIN 30 DAYS AFTER FINAL SITE STABILIZATION IS ACHIEVED OR AFTER THE TEMPORARY MEASURES ARE NO LONGER NEEDED.
8. ALL TEMPORARY AND PERMANENT EROSION CONTROL MEASURES MUST BE MAINTAINED AND REPAIRED AS NEEDED. THE PROPERTY OWNER SHALL BE ULTIMATELY RESPONSIBLE FOR MAINTENANCE AND REPAIR.
9. A STABILIZED MAT OF AGGREGATE UNDERLAIN WITH FILTER CLOTH (OR OTHER APPROPRIATE MEASURE) SHALL BE LOCATED AT ANY POINT WHERE TRAFFIC WILL BE ENTERING OR LEAVING A CONSTRUCTION SITE TO OR FROM A PUBLIC RIGHT-OF-WAY, STREET, ALLEY OR PARKING AREA. ANY SEDIMENT OR SOIL REACHING AN IMPROVED PUBLIC RIGHT-OF-WAY, STREET, ALLEY OR PARKING AREA SHALL BE REMOVED BY SCRAPING OR STREET CLEANING AS ACCUMULATIONS WARRANT AND TRANSPORTED TO A CONTROLLED SEDIMENT DISPOSAL AREA.
10. SOIL STOCKPILES SHALL NOT BE LOCATED IN A FLOOD PRONE AREA OR A DESIGNATED BUFFER. NO STOCKPILES SHALL BE LOCATED WITHIN AN ACTIVE RUNWAY SAFETY AREA, RUNWAY OBJECT FREE AREA, RUNWAY OBSTACLE FREE ZONE, OR ACTIVE TAXIWAY OBJECT FREE AREA.
11. IF DEWATERING SERVICES ARE USED, ADJOINING PROPERTIES AND DISCHARGE LOCATIONS SHALL BE PROTECTED FROM EROSION. DISCHARGES SHALL BE ROUTED THROUGH AN EFFECTIVE SEDIMENT CONTROL MEASURE (e.g. SEDIMENT TRAP, SEDIMENT BASIN, OR OTHER APPROPRIATE MEASURE).
12. THE EROSION CONTROL MEASURES INDICATED ON THE PLANS ARE THE MINIMUM REQUIREMENTS. ADDITIONAL MEASURES MAY BE REQUIRED, AS DIRECTED BY THE ENGINEER OR GOVERNING AGENCY.

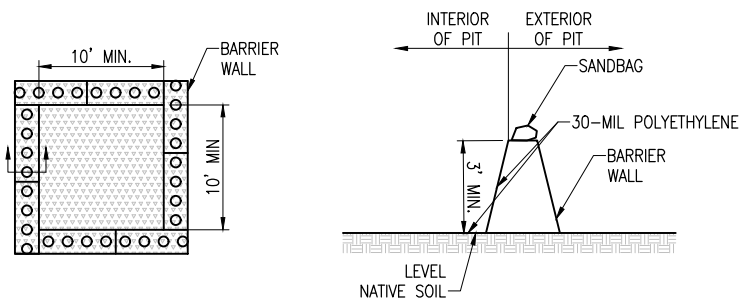

**CONCRETE WASHOUT DETAIL**

**NOTES:**

1. IMPERMEABLE SHEETING MUST EXTEND OVER ENTIRE BASIN AND BERM TO PREVENT ESCAPE OF DISCHARGE.
2. PROTECT AREA AROUND UNIT FOR 10 FEET WITH PLASTIC UNDER AND AROUND UNIT TO CONTAIN SPILLS OR OVERFLOW.
3. FACILITY LINED WITH 30-MIL POLYETHYLENE LINER AND SECURED USING SAND BAGS, OR OTHER ANCHORS, AND SHALL BE FREE OF HOLES OR TEARS.
4. FACILITY IS TO BE LOCATED ON LEVEL GROUND.
5. WASHOUT NEEDS TO BE COVERED OR LIQUIDS TO BE REMOVED PRIOR TO IMPENDING STORMS TO PREVENT OVERFLOW.
6. IF EFFLUENT CANNOT BE REMOVED PRIOR TO ANTICIPATED RAINFALL EVENT, PLACE AND SECURE A NON-COLLAPSING, NON WATER COLLECTING COVER OVER THE WASHOUT FACILITY TO PREVENT ACCUMULATION AND PRECIPITATION OVERFLOW.
7. REMOVE WASHOUT WATER FROM HIGH VOLUME FACILITIES WITH A VACUUM TRUCK AND DISPOSE OF PROPERLY. DO NOT DISCHARGE WASTEWATER INTO THE ENVIRONMENT. (NOTE: ACIDITY, NOT PARTICULATES, IS ENVIRONMENTALLY HAZARDOUS)
8. DO NOT DISCHARGE WASHOUT WATER INTO THE ENVIRONMENT; FACILITATE EVAPORATION OF LOW VOLUME WASHOUT WATER.
9. INSPECT LINE FOR TEARS. AN INTACT LINER WILL ENSURE THAT CONCRETE WASTEWATER WILL NOT ESCAPE THE WASHOUT FACILITY.
10. REPLACE DAMAGED LINER IMMEDIATELY.
11. CHECK AREA SURROUNDING FACILITY FOR SIGNS OF EFFLUENT ESCAPING CONTAINMENT.
12. INSPECT WASHOUT AREA FOLLOWING POUR TO EVALUATE EFFECTIVENESS.
13. CHECK DEPTH OF SOLIDS TO ENSURE VOLUME IS SUFFICIENT FOR NEXT POUR.
14. INSPECT WASHOUTS PRIOR TO POUR TO ENSURE SUFFICIENT VOLUME IS AVAILABLE TO CONTAIN WASHOUT.
15. REMOVE TEMPORARY CONCRETE WASHOUT FACILITIES WHEN NO LONGER NEEDED AND RESTORE DISTURBED AREAS TO ORIGINAL CONDITION.
16. DISPOSE OF SOLIDIFIED CONCRETE WASTE, CONSIDERED CLEAN CONSTRUCTION OR DEMOLITION DEBRIS (CCDD) AS PER THE IEPA ACT (415 ILCS5).
17. COST OF TEMPORARY WASHOUT AREA IS INCIDENTAL TO PCC PAVING.

**CONCRETE WASHOUT PIT**

I:\16\JOBS\16A002\16A002\DCAD\AIRPORT\SHSHEET\C-581-SWP.DWG NOV 28, 2017 2:29 PM SCHWEIDT26



**REHABILITATE THE PAVEMENT AROUND HANGAR G**

IDA No: DEC-4497  
AIP No: 3-17-SBGP-133

Contract No. DE078

| NO. | DATE | DESCRIPTION |     |     |
|-----|------|-------------|-----|-----|
|     |      | DES         | DWN | REV |
|     |      |             |     |     |
|     |      |             |     |     |
|     |      |             |     |     |
|     |      |             |     |     |
|     |      |             |     |     |
|     |      |             |     |     |
|     |      |             |     |     |
|     |      |             |     |     |
|     |      |             |     |     |

ISSUE: NOVEMBER 24, 2017

PROJECT NO: 16A0021

CAD FILE: C-581-SWP.DWG

DESIGN BY: KMS 01/13/2017

DRAWN BY: JAB 01/13/2017

REVIEWED BY: KBS 02/03/2017

SHEET TITLE

**SWPPP DETAILS**

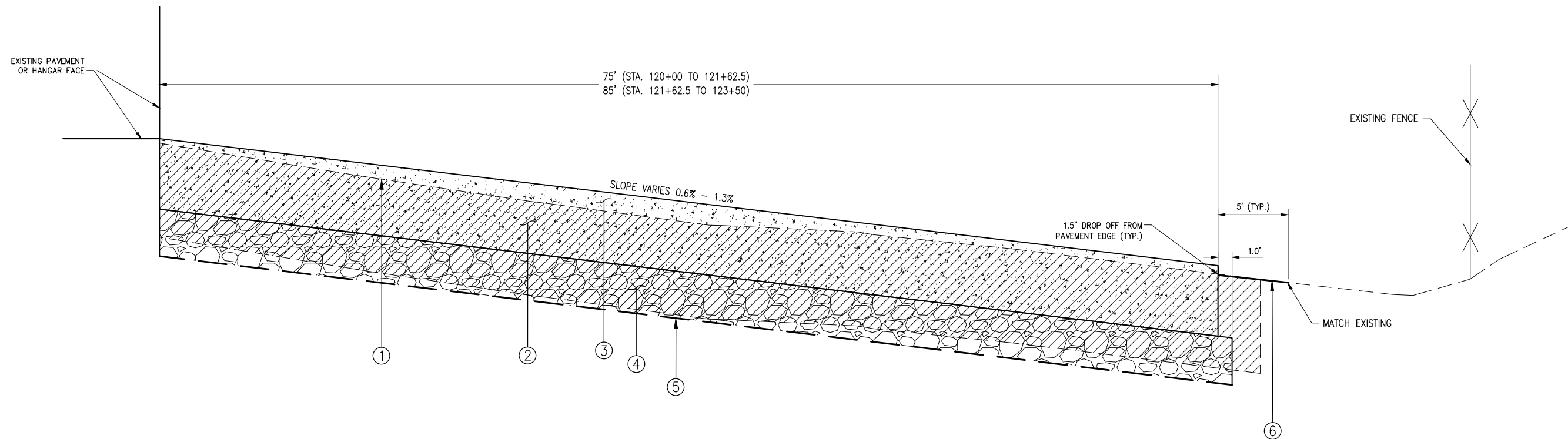

**APRON PAVEMENT (E/W) - TYPICAL SECTION "A-A"**  
NOT TO SCALE  
STA. 120+00 TO STA. 123+50

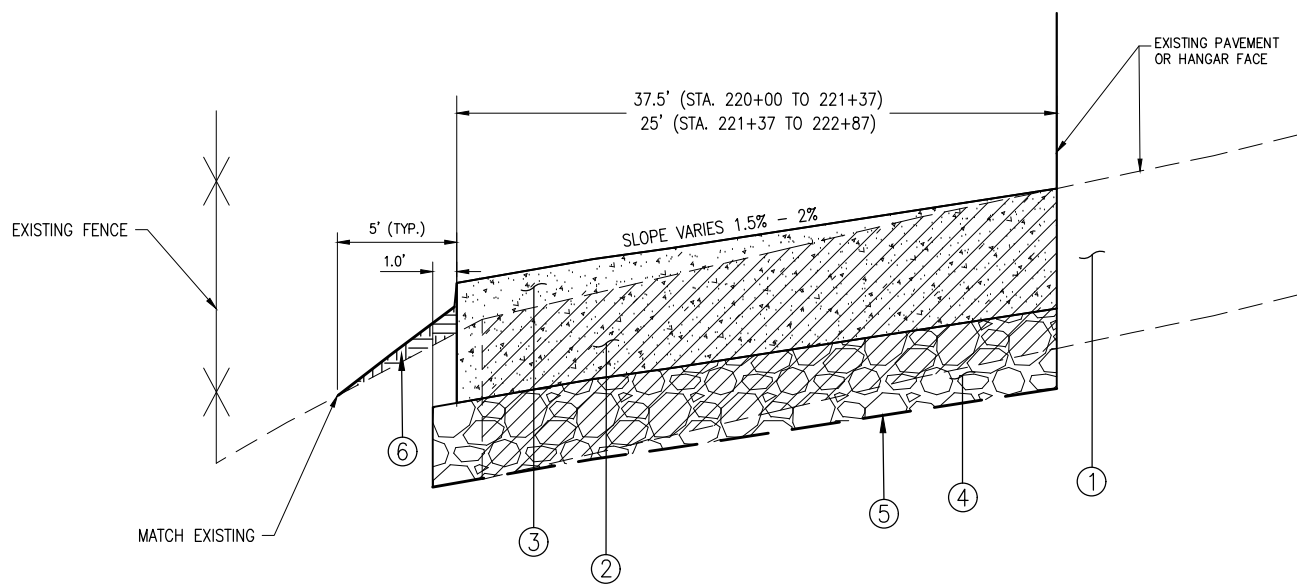

**ACCESS ROAD PAVEMENT (N/S) - TYPICAL SECTION "B-B"**  
NOT TO SCALE  
STA. 120+00 TO STA. 122+87

**LEGEND FOR TYPICAL SECTIONS**

- ① EXISTING BITUMINOUS PAVEMENT (APPROX. 8") ON SUBGRADE
- ② PROPOSED AR401900 REMOVE BITUMINOUS PAVEMENT
- ③ PROPOSED AR501506 6" PCC PAVEMENT
- ④ PROPOSED AR209604 CRUSHED AGGREGATE BASE COURSE - 4"
- ⑤ PROPOSED AR152540 SOIL STABILIZATION FABRIC
- ⑥ PROPOSED AR152480 SHOULDER ADJUSTMENT  
PROPOSED AR904510 SODDING

**NOTES:**

1. EXISTING PAVEMENT THICKNESS MAY VARY AND AGGREGATE SUBBASE MAY BE PRESENT IN SOME AREAS. REFER TO REMOVAL PLAN FOR ADDITIONAL INFO.
2. FOR ADDITIONAL LANDSCAPING INFORMATION, SEE PROPOSED SITE PLAN.
3. ITEM AR209604 CRUSHED AGGREGATE BASE COURSE EXTENDS 1' OUTSIDE ALL PAVEMENT EDGES ADJACENT TO TURF.
4. REFER TO JOINTING DETAILS SHEET FOR ADDITIONAL INFO ON CONCRETE PAVEMENT TIE-IN TO EXISTING PAVEMENT.

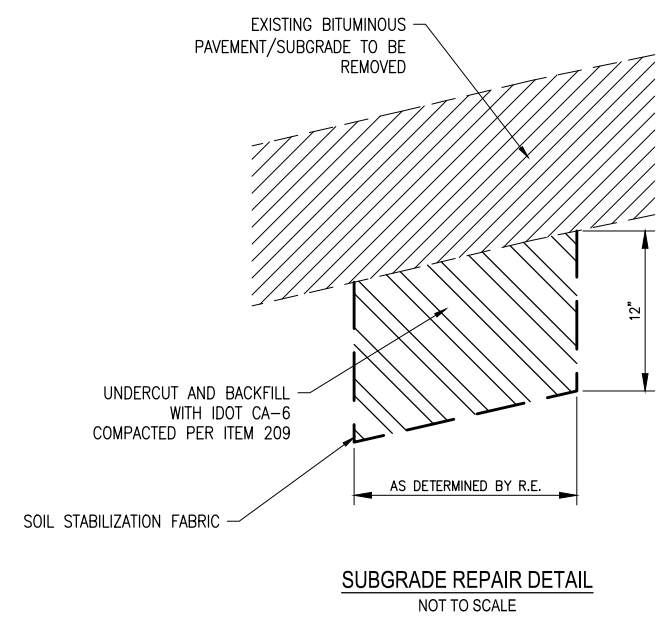

**SUBGRADE REPAIR DETAIL**  
NOT TO SCALE

**REHABILITATE THE PAVEMENT AROUND HANGAR G**

IDA No: DEC-4497  
AIP No: 3-17-SBGP-133

Contract No. DE078

| NO. | DATE | DESCRIPTION |     |     |
|-----|------|-------------|-----|-----|
|     |      | DES         | DWN | REV |
|     |      |             |     |     |
|     |      |             |     |     |
|     |      |             |     |     |
|     |      |             |     |     |
|     |      |             |     |     |
|     |      |             |     |     |
|     |      |             |     |     |
|     |      |             |     |     |
|     |      |             |     |     |

ISSUE: NOVEMBER 24, 2017  
PROJECT NO: 16A0021  
CAD FILE: C-121-TYP.DWG  
DESIGN BY: KMS 01/18/2017  
DRAWN BY: KMS 01/18/2017  
REVIEWED BY: KMS 03/02/2017

SHEET TITLE

**TYPICAL SECTIONS**



Decatur Park District  
Decatur Airport  
910 South Airport Road  
Decatur, IL 62521

**REMOVAL NOTES**

- "REMOVE BITUMINOUS PAVEMENT" - PER SQUARE YARD, SHALL CONSIST OF REMOVING FULL-DEPTH OF EXISTING BITUMINOUS PAVEMENT TO LIMITS SHOWN, REGARDLESS OF THICKNESS. BASED ON PAVEMENT CORES AND RECORD DRAWINGS, AN AVERAGE OF THICKNESS OF 8" HAS BEEN USED FOR ESTIMATION PURPOSES. **NO ADJUSTMENTS TO UNIT PRICE WILL BE MADE FOR ASPHALT THICKNESSES FOUND GREATER OR LESS THAN 8".**
- "UNCLASSIFIED EXCAVATION" - PER LUMP SUM, SHALL CONSIST OF ALL REMAINING EXCAVATION OF EARTH OR AGGREGATE MATERIAL NECESSARY TO BRING SITE TO PROPOSED SUBGRADE ELEVATION AFTER REMOVAL OF BITUMINOUS PAVEMENT. BASED ON PAVEMENT CORES AND RECORD DRAWINGS, AN AVERAGE DEPTH OF 2" HAS BEEN USED FOR ESTIMATION PURPOSES IN EXISTING PAVEMENT AREAS, AND 10" IN NON-PAVED AREAS. ESTIMATED EXCAVATION QUANTITY IS 245 CUBIC YARDS. QUANTITY IS FOR **INFORMATIONAL PURPOSES ONLY, AND WILL NOT BE MEASURED FOR PAYMENT, NOR WILL ANY ADJUSTMENTS TO THE LUMP SUM PRICE BE MADE** FOR EXCAVATION GREATER OR LESS THAN THAT ESTIMATED.
- ALL BITUMINOUS PAVEMENT SAWING IS INCIDENTAL TO PAVEMENT REMOVAL. ANY HANDWORK REQUIRED TO ESTABLISH A CLEAN VERTICAL FACE ON ADJACENT PAVEMENT OR HANGAR FOUNDATIONS/SLABS IS ALSO INCIDENTAL.
- UTILITY LOCATIONS SHOWN ARE APPROXIMATE, BASED ON RECORD DATA AND SURFACE FEATURES. CONTRACTOR SHALL COORDINATE WITH AIRPORT MAINTENANCE STAFF AND UTILITY OWNERS FOR FIELD LOCATION. CONTRACTOR SHALL EXERCISE EXTREME CAUTION OVER ANY AREAS WHERE UTILITIES MAY BE PRESENT. POT-HOLING SHALL BE UTILIZED AS NECESSARY BEFORE ANY EXCAVATION OR COMPACTION IS UNDERTAKEN.
- ONCE CUT TO PROPOSED GRADE, SUBGRADE SHALL BE RECOMPACTED, PROOF-ROLLED WITH A LOADED TANDEM, AND ACCEPTED BY THE RESIDENT ENGINEER/TECHNICIAN PRIOR TO PLACEMENT OF STABILIZATION FABRIC. STABILIZATION FABRIC SHALL BE IN ACCORDANCE WITH ITEM 152540 OF THE STANDARD SPECIFICATIONS. UNSATISFACTORY SUBGRADE AREAS SHALL BE UNDERCUT AND BACKFILLED PER THE "SUBGRADE STABILIZATION" PAY ITEM.
- A QUANTITY OF 200 SQUARE YARDS OF "SUBGRADE STABILIZATION" - PER SQUARE YARD, HAS BEEN INCLUDED FOR USE AS DETERMINED NECESSARY BY THE RESIDENT ENGINEER/TECHNICIAN, BASED ON SUBGRADE CONDITIONS FOUND FOLLOWING PAVEMENT REMOVAL. ITEM SHALL INCLUDE UNDERCUTTING OF SUBGRADE ADDITIONAL 12" BELOW PROPOSED GRADE, PLACEMENT OF STABILIZATION FABRIC, AND OF 12" OF IDOT CA-6 AGGREGATE PLACED AND COMPACTED IN LIFTS.

| COORDINATE DATA FOR HANGAR "G" APRON BASELINE (E/W) |           |        |              |              |
|---|-----------|--------|--------------|--------------|
| ID  | STATION   | OFFSET | NORTHING     | EASTING      |
| 1   | 119+75.00 | ℄      | 1,154,517.24 | 831,169.15   |
| 2   | 124+00.00 | ℄      | 1,154,521.55 | 8,311,594.13 |

| COORDINATE DATA FOR ACCESS ROAD BASELINE (N/S) |           |        |              |            |
|--|-----------|--------|--------------|------------|
| ID   | STATION   | OFFSET | NORTHING     | EASTING    |
| A  | 219+50.00 | ℄      | 1,154,467.50 | 831,194.66 |
| B  | 223+00.00 | ℄      | 1,154,817.48 | 831,191.11 |

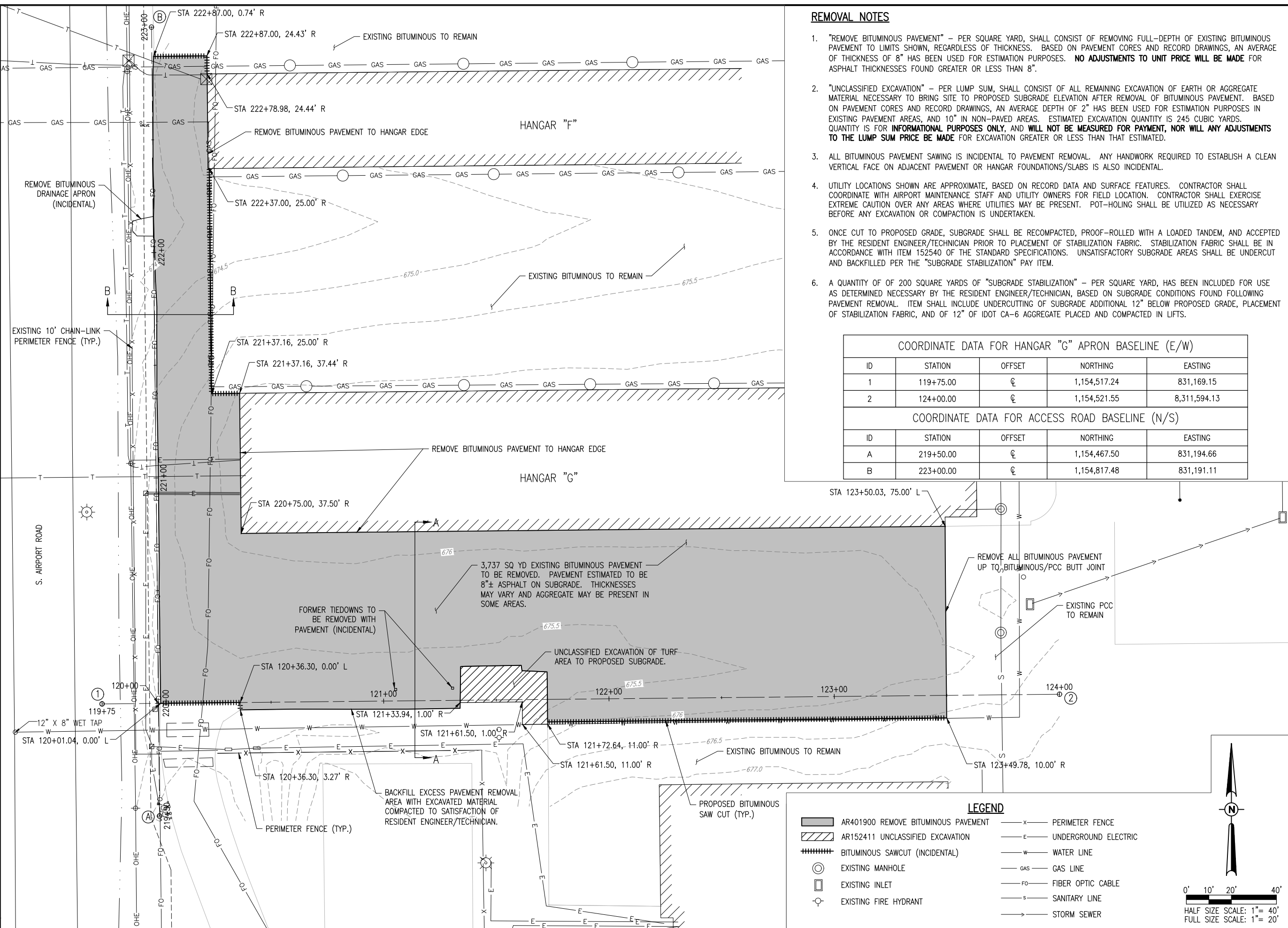

**REHABILITATE THE PAVEMENT AROUND HANGAR G**

IDA No: DEC-4497  
AIP No: 3-17-SBGP-133

Contract No. DE078

| NO. | DATE | DESCRIPTION |     |     |
|-----|------|-------------|-----|-----|
|     |      | DES         | DWN | REV |
|     |      |             |     |     |
|     |      |             |     |     |
|     |      |             |     |     |
|     |      |             |     |     |
|     |      |             |     |     |
|     |      |             |     |     |

ISSUE: NOVEMBER 24, 2017  
PROJECT NO: 16A0021  
CAD FILE: C-111-PRP.DWG  
DESIGN BY: KMS 01/18/2017  
DRAWN BY: KMS 01/18/2017  
REVIEWED BY: KBS 03/02/2017

SHEET TITLE

**REMOVAL PLAN**

I:\16\OBSS\16A0021\16A0021\CAD\AIRPORT\SHSHEET\C-111-PRP.DWG  
 NOV 28, 2017 11:28 AM ISCHWED1286





### PAVING NOTES

1. PCC PAVING SHALL BE IN ACCORDANCE WITH ITEM 501 OF STANDARD SPECIFICATIONS. CRUSHED AGGREGATE BASE COURSE SHALL BE IN ACCORDANCE WITH ITEM 209.
2. NO PAVING WILL BE PERMITTED UNTIL TEST BATCH BREAKS HAVE BEEN APPROVED BY THE ENGINEER. CONTRACTOR MAY REQUEST CALENDAR DAYS BE SUSPENDED WHILE WAITING FOR BREAKS.
3. REFER TO JOINTING PLAN SHEET AND NOTES FOR JOINTING LAYOUT. CONTRACTOR SHALL INFORM RESIDENT ENGINEER OF INTENDED PAVING SEQUENCE PRIOR TO CONCRETE POUR. ANY PROPOSED ADJUSTMENTS TO THE JOINTING LAYOUTS TO FACILITATE CERTAIN PAVING SEQUENCES SHALL BE APPROVED BY THE PROJECT ENGINEER.
4. UTILITY LOCATIONS SHOWN ARE APPROXIMATE, BASED ON RECORD DATA AND SURFACE FEATURES. CONTRACTOR SHALL COORDINATE WITH AIRPORT MAINTENANCE STAFF AND UTILITY OWNERS FOR FIELD LOCATION. CONTRACTOR SHALL EXERCISE EXTREME CAUTION OVER ANY AREAS WHERE UTILITIES MAY BE PRESENT. POT-HOLING SHALL BE UTILIZED AS NECESSARY BEFORE ANY EXCAVATION OR COMPACTION IS UNDERTAKEN.

### SHOULDER ADJUSTMENT NOTES

1. SHOULDER ADJUSTMENT SHALL CONSIST OF REWORKING TURF SHOULDERS WITHIN 5' OF COMPLETED PAVEMENT EDGES PREPARATION FOR SODDING. OFFSITE TOPSOIL SHALL BE USED TO SUPPLEMENT EXISTING MATERIAL AS NECESSARY. TOPSOIL SHALL BE APPROVED BY RESIDENT ENGINEER/TECHNICIAN PRIOR TO INCORPORATION.
2. THIS WORK WILL BE PAID FOR UNDER:  
ITEM NO. AR152480 "SHOULDER ADJUSTMENT" - PER S.Y.

### SODDING NOTES

1. THE TURF AREAS SHOWN AS PROPOSED SODDING SHALL BE LIMED, FERTILIZED, SODDED, AND WATERED IN ACCORDANCE WITH ITEM 904 OF THE STANDARD SPECIFICATIONS. EXACT QUANTITY SHALL BE CONFIRMED WITH RESIDENT ENGINEER/TECHNICIAN PRIOR TO DELIVERY TO SITE.
2. ALL ROCK, ASPHALT, OR CONCRETE DEBRIS LEFT FROM THE PAVING OPERATION WILL BE DISPOSED OF OFF THE AIRPORT SITE PRIOR TO SOD PLACEMENT.
3. THE PRIME CONTRACTOR WILL BE RESPONSIBLE FOR COORDINATION OF ALL SUB-CONTRACTORS AS TO THEIR RESPONSIBILITIES PERTAINING TO THE SODDING OPERATIONS.
4. THIS WORK WILL BE PAID FOR UNDER:  
ITEM NO. AR904510 "SODDING" - PER S.Y.

### MARKING NOTES

1. PROPOSED TAXI PAVEMENT MARKING SHALL CONSIST OF A 12" WIDE YELLOW STRIPE WITH 6" BLACK BORDER ON BOTH SIDES. MARKING SHALL BE IN ACCORDANCE WITH ITEM 620 OF THE STANDARD SPECIFICATIONS FOR WATERBORNE MARKING.
2. CONTRACTOR SHALL THOROUGHLY WATER-BLAST AREA TO BE MARKED OF CURING COMPOUND PRIOR TO MARKING. MARKINGS NOT PLACED ENTIRELY ON WATER-BLASTED AREAS SHALL BE REMOVED AND REMARKED.
3. THIS WORK WILL BE PAID FOR UNDER:  
ITEM NO. AR620520 "PAVEMENT MARKING-WATERBORNE" - PER S.F.  
ITEM NO. AR620525 "PAVEMENT MARKING-BLACK BORDER" - PER S.F.

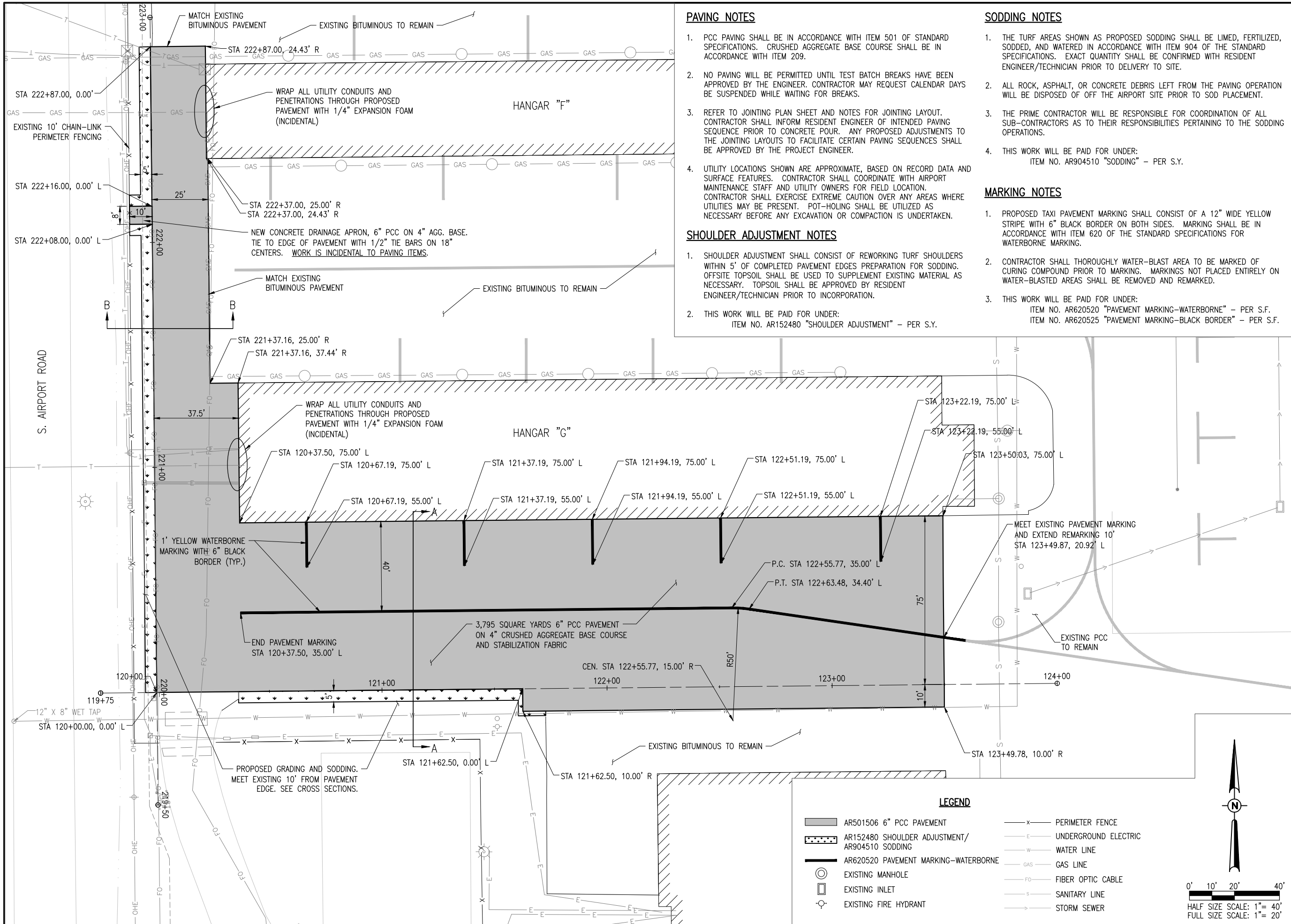

### REHABILITATE THE PAVEMENT AROUND HANGAR G

IDA No: DEC-4497  
AIP No: 3-17-SBGP-133

Contract No. DE078

| NO. | DATE | DESCRIPTION |     |     |
|-----|------|-------------|-----|-----|
|     |      | DES         | DWN | REV |
|     |      |             |     |     |
|     |      |             |     |     |
|     |      |             |     |     |
|     |      |             |     |     |
|     |      |             |     |     |
|     |      |             |     |     |
|     |      |             |     |     |
|     |      |             |     |     |
|     |      |             |     |     |
|     |      |             |     |     |

ISSUE: NOVEMBER 24, 2017  
PROJECT NO: 16A0021  
CAD FILE: C-121-CON.DWG  
DESIGN BY: KMS 01/18/2017  
DRAWN BY: KMS 01/18/2017  
REVIEWED BY: KBS 02/03/2017

SHEET TITLE

### CONSTRUCTION PLAN

I:\16\BBS\16A0021\16A0021\CAD\AIRPORT\16A0021-CON.DWG  
NOV 28, 2017 11:30 AM ISCHWED1286



**JOINTING NOTES**

1. JOINT REINFORCING, JOINT EXPANSION MATERIAL AND JOINT SAWING AND SEALING ARE INCIDENTAL TO P.C.C. PAVEMENT.
2. SEE SHEET 11 FOR JOINTING DETAILS.
3. SEE SHEET 12 STAKING PLAN FOR CONCRETE SLAB ELEVATIONS.

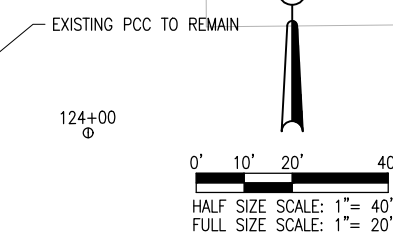
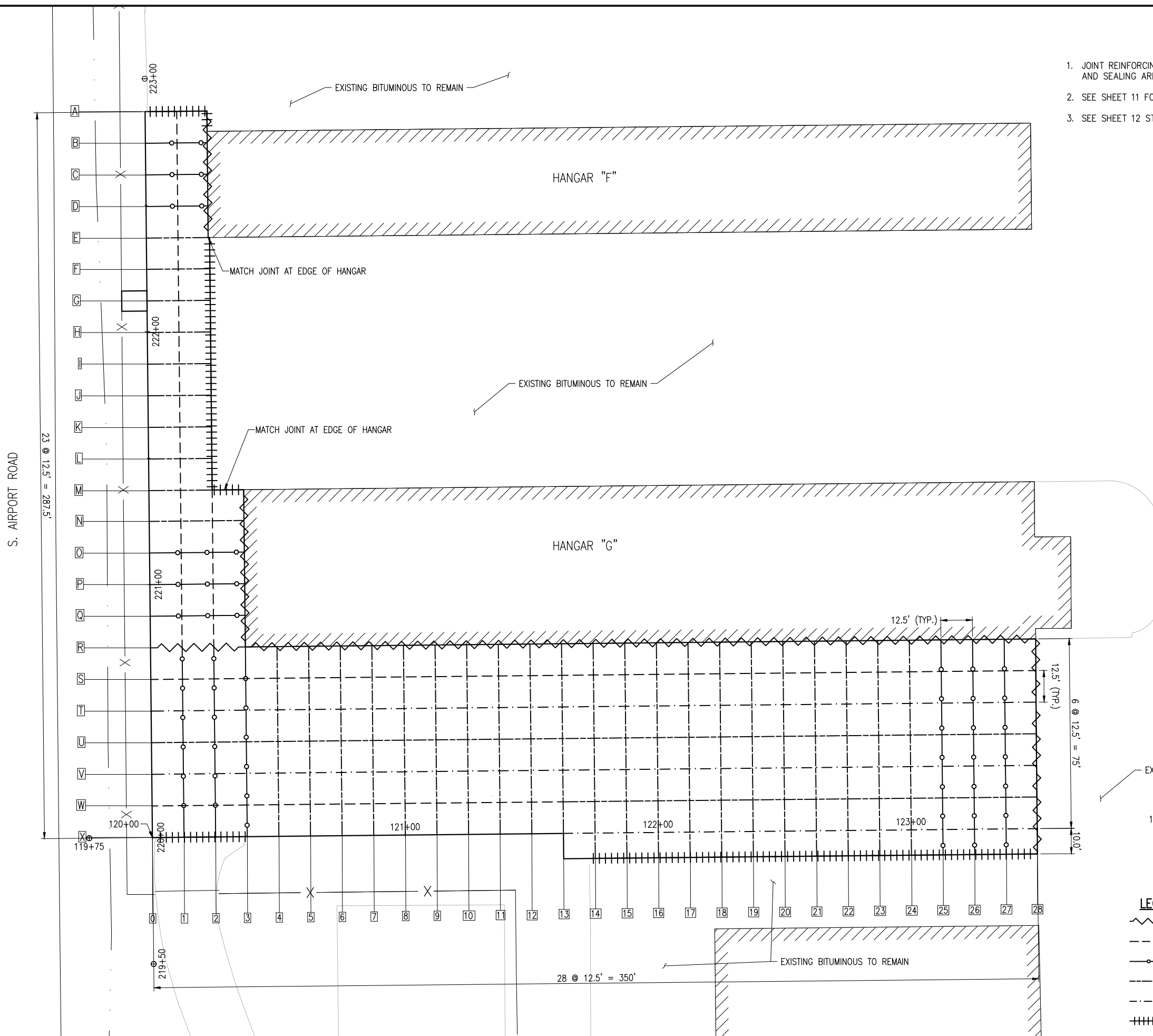

**LEGEND**

|  |                                     |
|--|-------------------------------------|
|  | TYPE A - THICKENED ISOLATION JOINT  |
|  | TYPE B - HINGED CONTRACTION JOINT   |
|  | TYPE C - DOWELED CONTRACTION JOINT  |
|  | TYPE D - DUMMY CONTRACTION JOINT    |
|  | TYPE E - DOWELED CONSTRUCTION JOINT |
|  | BITUMINOUS PRESSURE RELIEF JOINT    |

**REHABILITATE THE PAVEMENT AROUND HANGAR G**

IDA No: DEC-4497  
AIP No: 3-17-SBGP-133

Contract No. DE078

|  |  |  |  |  |  |
|--|--|--|--|--|--|
|  |  |  |  |  |  |
|  |  |  |  |  |  |
|  |  |  |  |  |  |
|  |  |  |  |  |  |
|  |  |  |  |  |  |
|  |  |  |  |  |  |

| NO. | DATE | DESCRIPTION |     |     |
|-----|------|-------------|-----|-----|
|     |      | DES         | DWN | REV |
|     |      |             |     |     |
|     |      |             |     |     |
|     |      |             |     |     |
|     |      |             |     |     |

ISSUE: NOVEMBER 24, 2017

PROJECT NO: 16A0021

CAD FILE: C-161-JNT.DWG

DESIGN BY: KMS 01/10/2017

DRAWN BY: JAB 01/10/2017

REVIEWED BY: KBS 02/03/2017

SHEET TITLE

**JOINTING PLAN**

I:\16\0021\16A0021\CAD\AIRPORT\161-JNT.DWG  
NOV 28, 2017 11:31 AM ISCHWEDT286

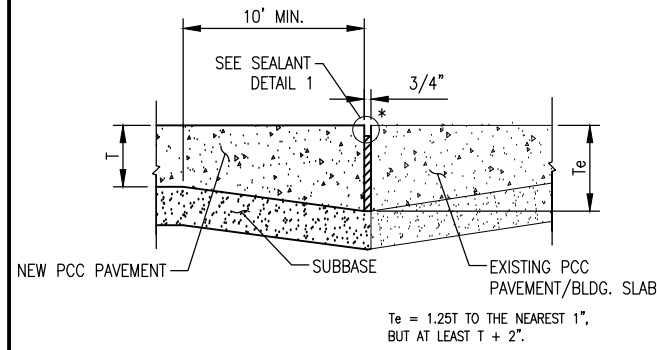

**TYPE A - THICKENED EDGE ISOLATION JOINT**

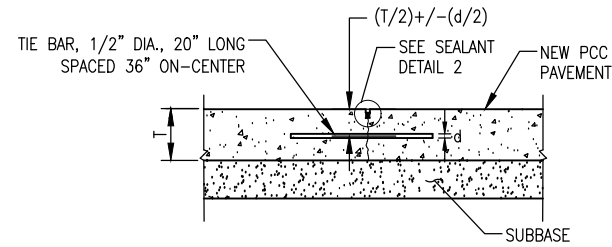

**TYPE B - HINGED CONTRACTION JOINT**

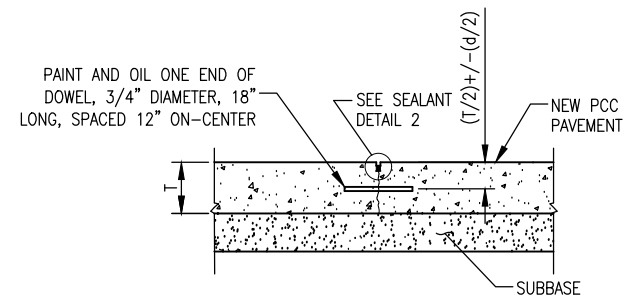

**TYPE C - DOWELED CONTRACTION JOINT**

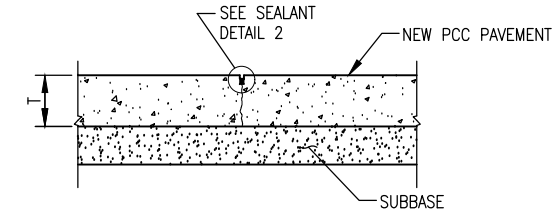

**TYPE D - DUMMY CONTRACTION JOINT**

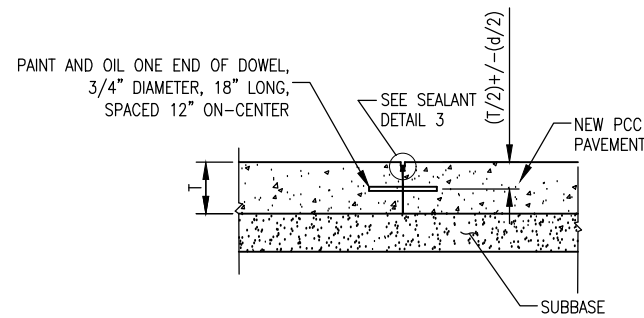

**TYPE E - DOWELED CONSTRUCTION JOINT**

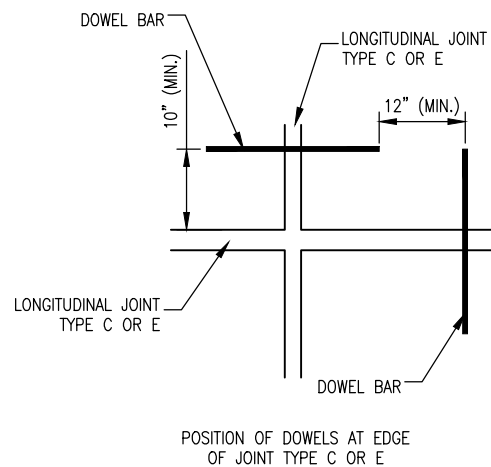

**DOWEL PLAN VIEW**

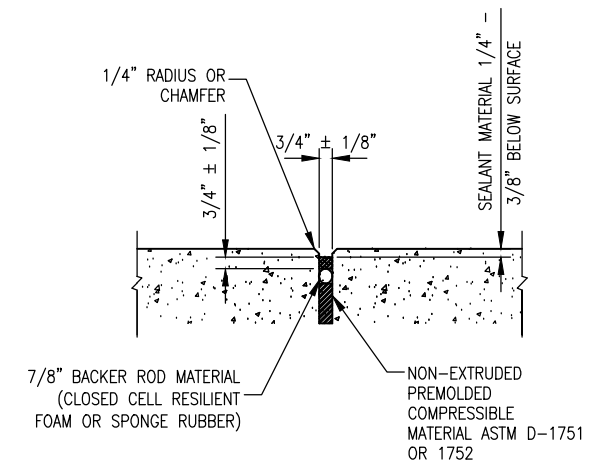

**DETAIL 1 - SEALANT**

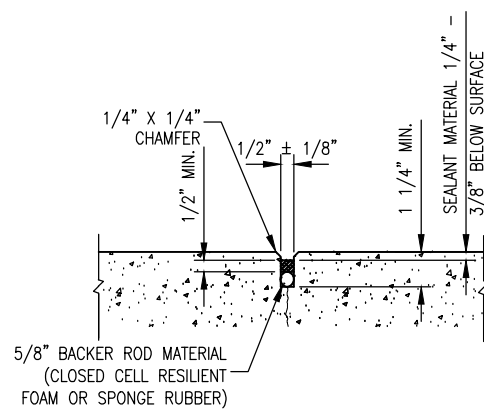

**DETAIL 2 - SEALANT**

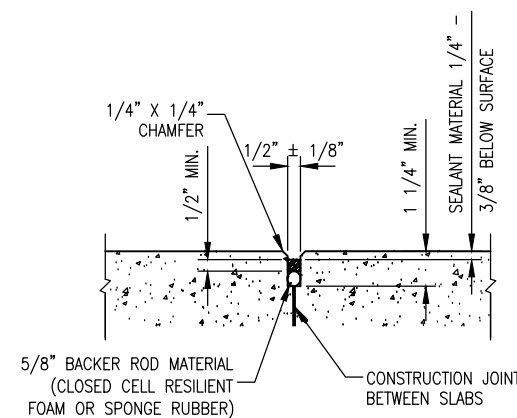

**DETAIL 3 - SEALANT**

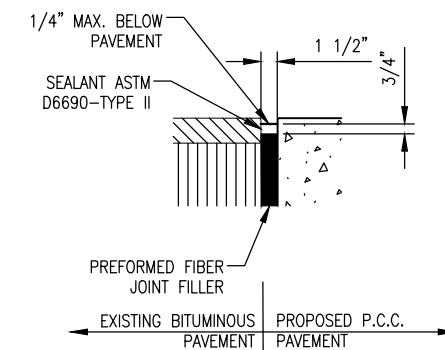

**BITUMINOUS PRESSURE RELIEF JOINT**

**NOTES:**

1. ALL JOINT SEALING TO BE INCIDENTAL TO ITEM AR501506 - 6" PCC PAVEMENT.
2. ALL JOINT SEALANT TO BE SILICONE EXCEPT AT ASPHALT INTERFACE.

**REHABILITATE THE PAVEMENT AROUND HANGAR G**

IDA No: DEC-4497  
AIP No: 3-17-SBGP-133

Contract No. DE078

|  |  |  |  |
|--|--|--|--|
|  |  |  |  |
|  |  |  |  |
|  |  |  |  |
|  |  |  |  |
|  |  |  |  |
|  |  |  |  |
|  |  |  |  |
|  |  |  |  |
|  |  |  |  |
|  |  |  |  |

| NO. | DATE | DESCRIPTION |     |     |
|-----|------|-------------|-----|-----|
|     |      | DES         | DWN | REV |
|     |      |             |     |     |

ISSUE: NOVEMBER 24, 2017

PROJECT NO: 16A0021

CAD FILE: C-561-JNT.DWG

DESIGN BY: KMS 01/13/2017

DRAWN BY: KMS 01/13/2017

REVIEWED BY: KBS 02/03/2017

SHEET TITLE

**JOINTING DETAILS**



Decatur Park District  
Decatur Airport  
910 South Airport Road  
Decatur, IL 62521

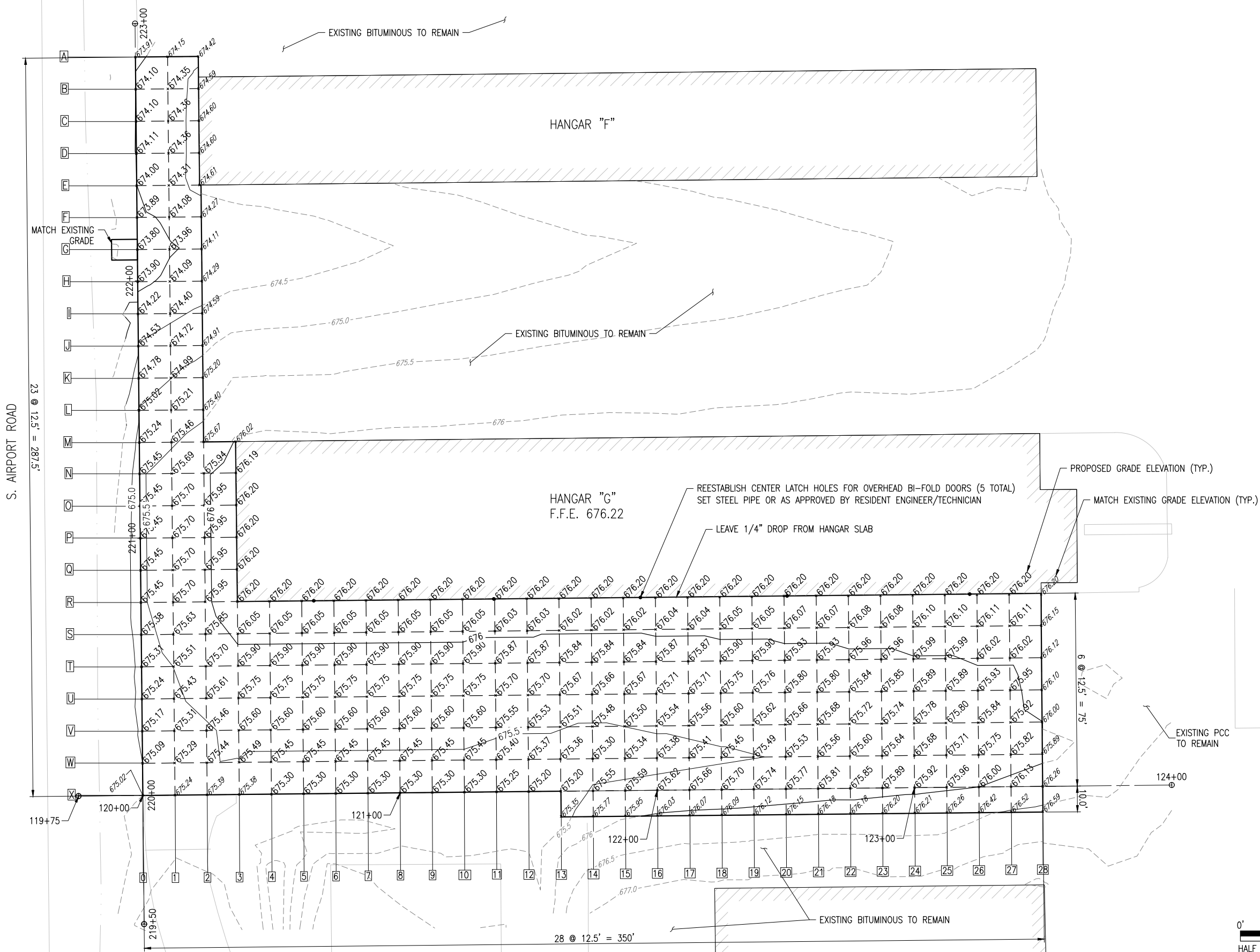

**REHABILITATE THE PAVEMENT AROUND HANGAR G**

IDA No: DEC-4497  
AIP No: 3-17-SBGP-133

Contract No. DE078

| NO. | DATE | DESCRIPTION |     |     |
|-----|------|-------------|-----|-----|
|     |      | DES         | DWN | REV |
|     |      |             |     |     |
|     |      |             |     |     |
|     |      |             |     |     |
|     |      |             |     |     |
|     |      |             |     |     |
|     |      |             |     |     |
|     |      |             |     |     |
|     |      |             |     |     |
|     |      |             |     |     |

ISSUE: NOVEMBER 24, 2017  
PROJECT NO: 16A0021  
CAD FILE: C-191-STK.DWG  
DESIGN BY: KMS 01/10/2017  
DRAWN BY: JAB 01/10/2017  
REVIEWED BY: KBS 03/02/2017

SHEET TITLE

**STAKING PLAN**

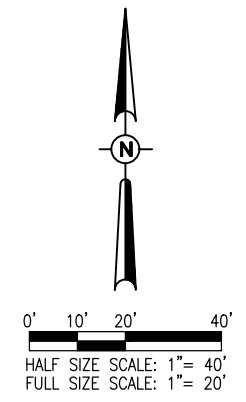



STA 121+50

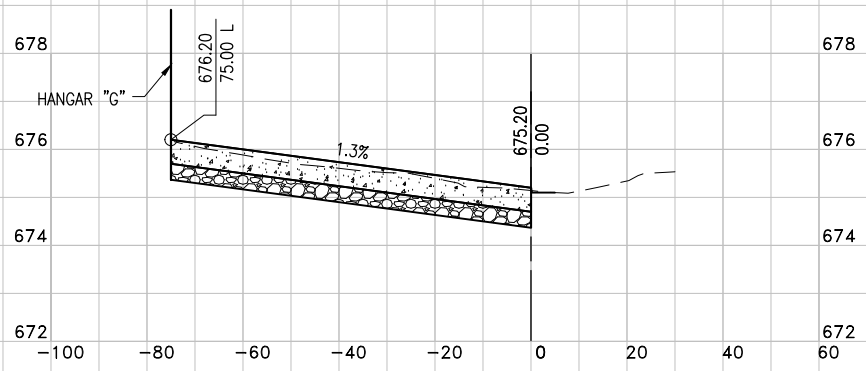

STA 123+50

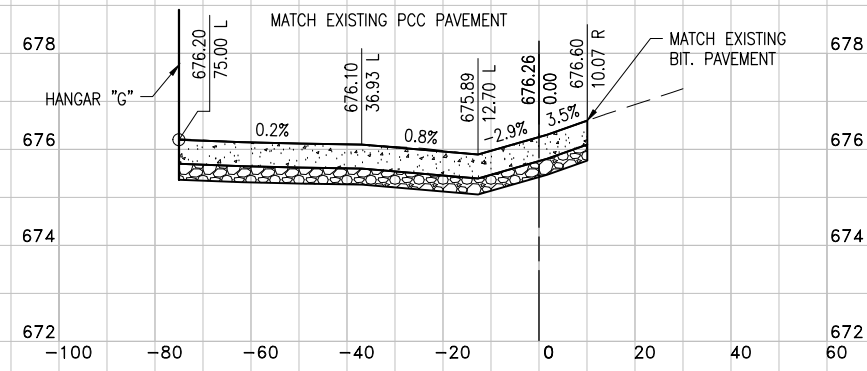

STA 121+00

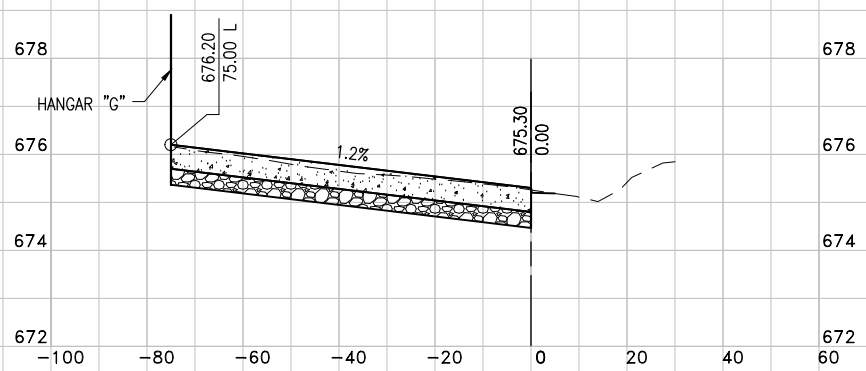

STA 123+00

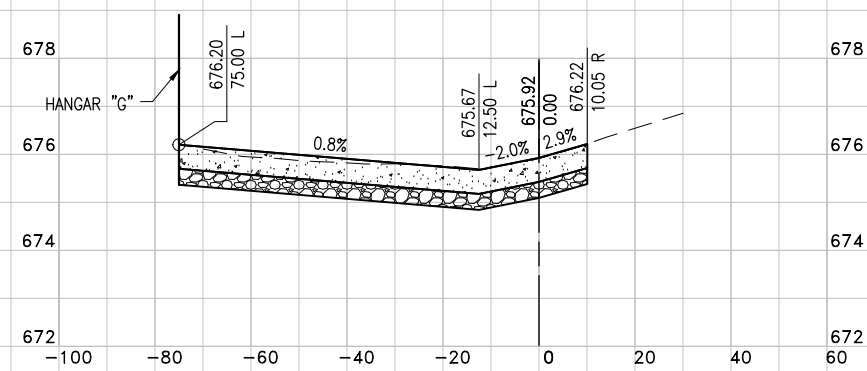

STA 120+50

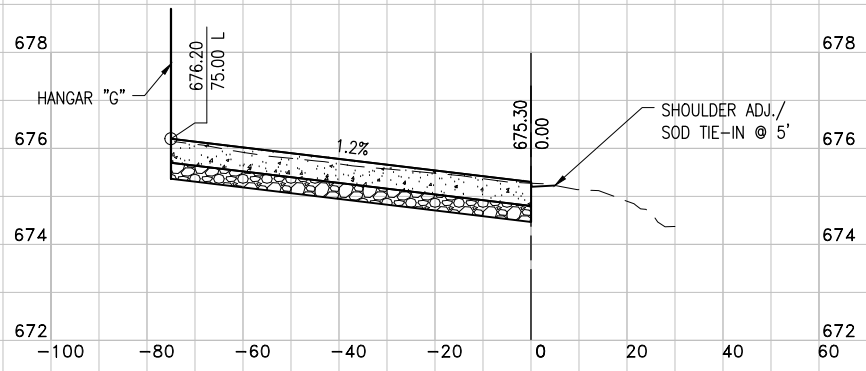

STA 122+50

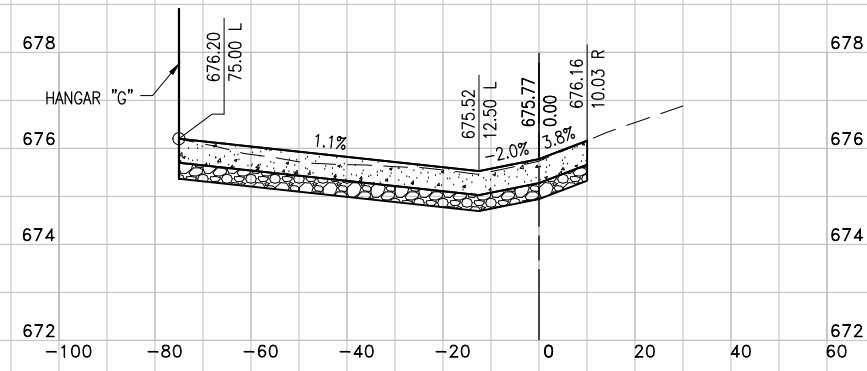

STA 120+00

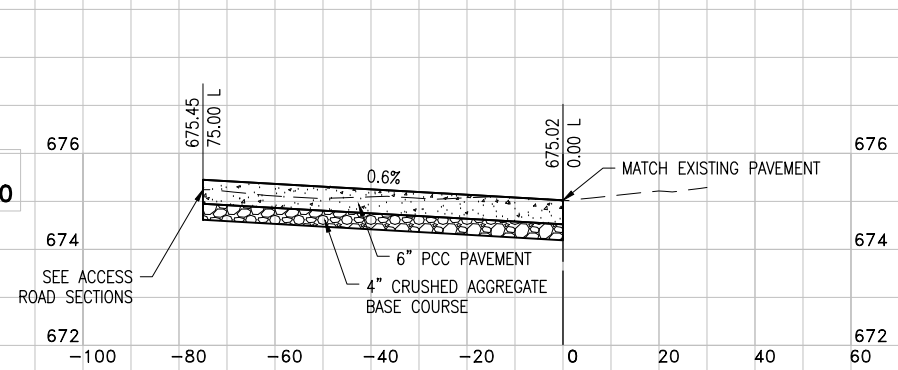

STA 122+00

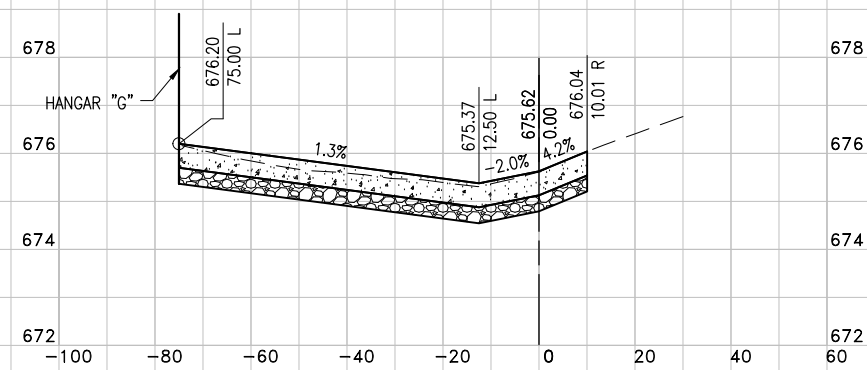

REHABILITATE THE PAVEMENT AROUND HANGAR G

IDA No: DEC-4497  
AIP No: 3-17-SBGP-133

Contract No. DE078

|     |      |             |
|-----|------|-------------|
| NO. | DATE | DESCRIPTION |
|     |      |             |
|     |      |             |
|     |      |             |
|     |      |             |
|     |      |             |
|     |      |             |
|     |      |             |
|     |      |             |
|     |      |             |

ISSUE: NOVEMBER 24, 2017  
PROJECT NO: 16A0021  
CAD FILE: C-301-XS.DWG  
DESIGN BY: KMS 01/20/2017  
DRAWN BY: KMS 01/20/2017  
REVIEWED BY: KBS 03/02/2017

SHEET TITLE

APRON CROSS SECTIONS

I:\16\OB\16A0021\16A0021\DCAD\AIRPORT\ISHEET\C-301-XS.DWG  
NOV 28, 2017 11:33 AM SCHWE01296



Decatur Park District  
Decatur Airport  
910 South Airport Road  
Decatur, IL 62521

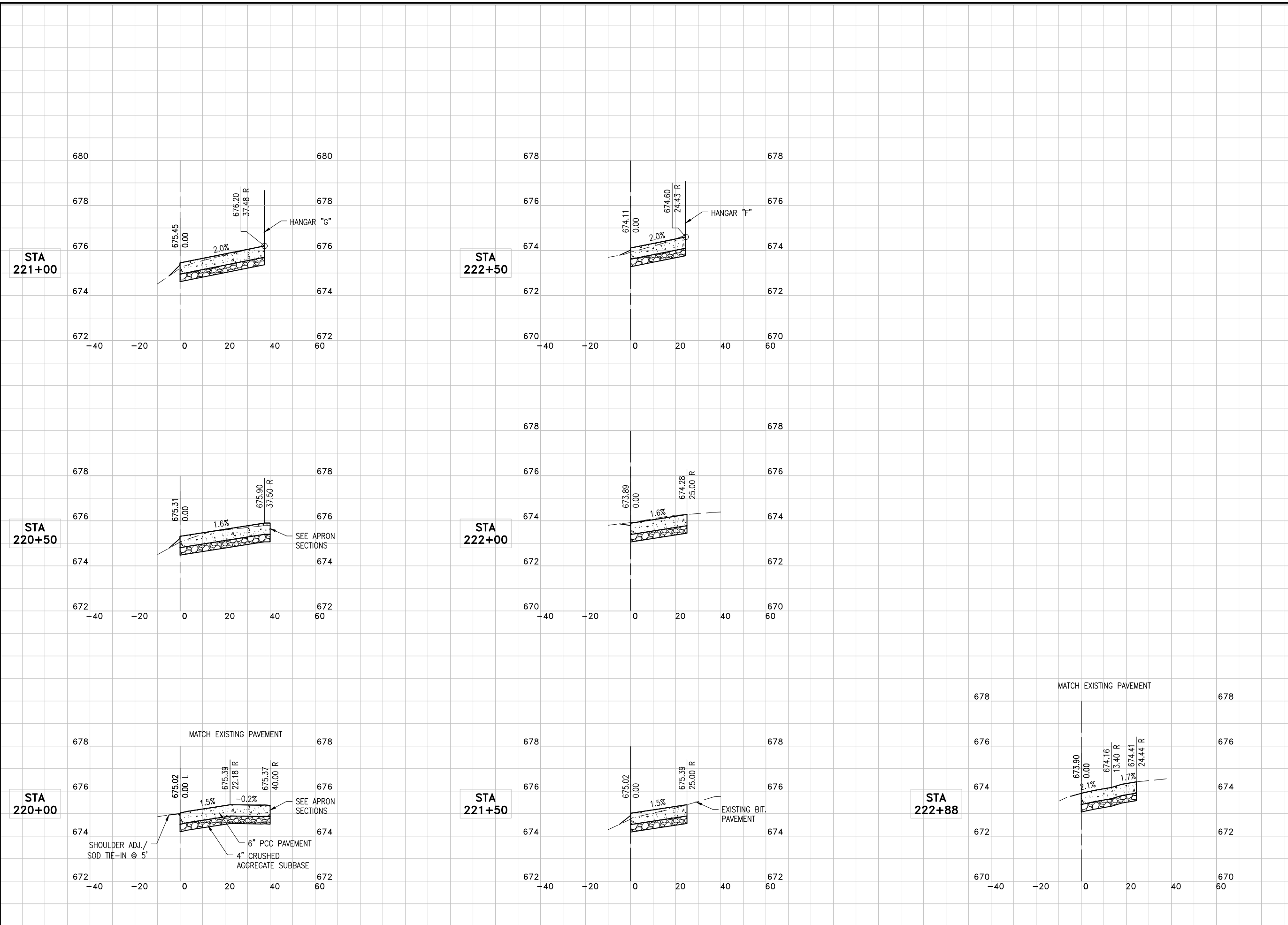

REHABILITATE THE PAVEMENT AROUND HANGAR G

IDA No: DEC-4497  
AIP No: 3-17-SBGP-133

Contract No. DE078

|  |  |  |  |
|--|--|--|--|
|  |  |  |  |
|  |  |  |  |
|  |  |  |  |
|  |  |  |  |
|  |  |  |  |
|  |  |  |  |

| NO. | DATE | DESCRIPTION |     |     |
|-----|------|-------------|-----|-----|
|     |      | DES         | DWN | REV |
|     |      |             |     |     |

ISSUE: NOVEMBER 24, 2017  
PROJECT NO: 16A0021  
CAD FILE: C-302-XS.DWG  
DESIGN BY: KMS 01/20/2017  
DRAWN BY: KMS 01/20/2017  
REVIEWED BY: KBS 03/02/2017

SHEET TITLE

ACCESS ROAD CROSS SECTIONS

I:\16\0021\16A0021\CAD\AIRPORT\SHSHEET\C-302-XS.DWG  
NOV 28, 2017 11:34 AM ISCHWED1296