

STATE OF ILLINOIS
DEPARTMENT OF TRANSPORTATION

F.A.I. RTE.	SECTION	COUNTY	TOTAL SHEETS	SHEET NO.
55, 72	D6 PATCHING 2024-1	SANGAMON	14	1
		ILLINOIS	CONTRACT NO. 72722	

FOR INDEX OF SHEETS, SEE SHEET NO. 2

PROPOSED HIGHWAY PLANS

FAI ROUTE 55, 72 (I 55, 72)
SECTION D6 PATCHING 2024-1
PROJECT
PAVEMENT PATCHING
SANGAMON COUNTY

C-96-020-24

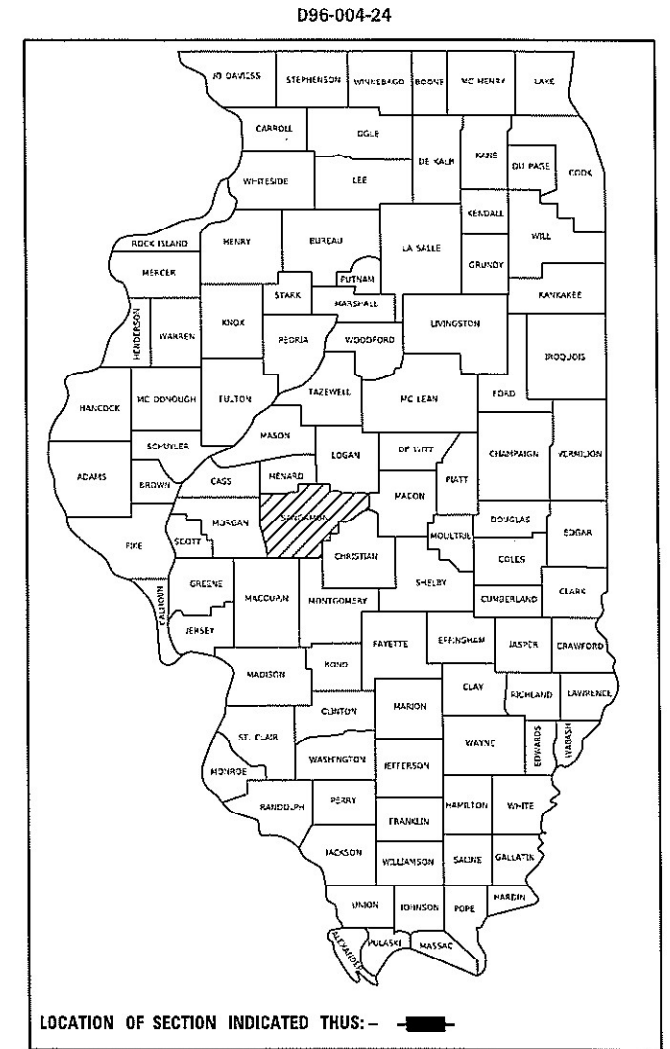

ADT = 27,100 (2021)
SU = 1,200 (2021)
MU = 5,700 (2021)

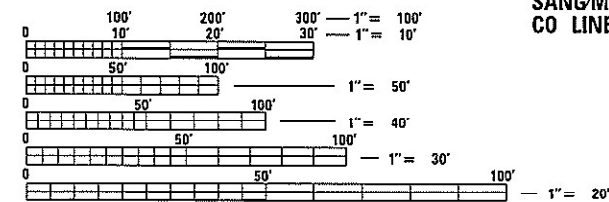

FULL SIZE PLANS HAVE BEEN PREPARED USING STANDARD ENGINEERING SCALES. REDUCED SIZED PLANS WILL NOT CONFORM TO STANDARD SCALES. IN MAKING MEASUREMENTS ON REDUCED PLANS, THE ABOVE SCALES MAY BE USED.

J.U.L.I.E.
JOINT UTILITY LOCATION INFORMATION FOR EXCAVATORS
1-800-892-0123
OR 811

PROJECT ENGINEER: MIKE HAMBY (217)524-7765
PROJECT MANAGER TIM SHARP (217)524-9160

CONTRACT NO. 72722

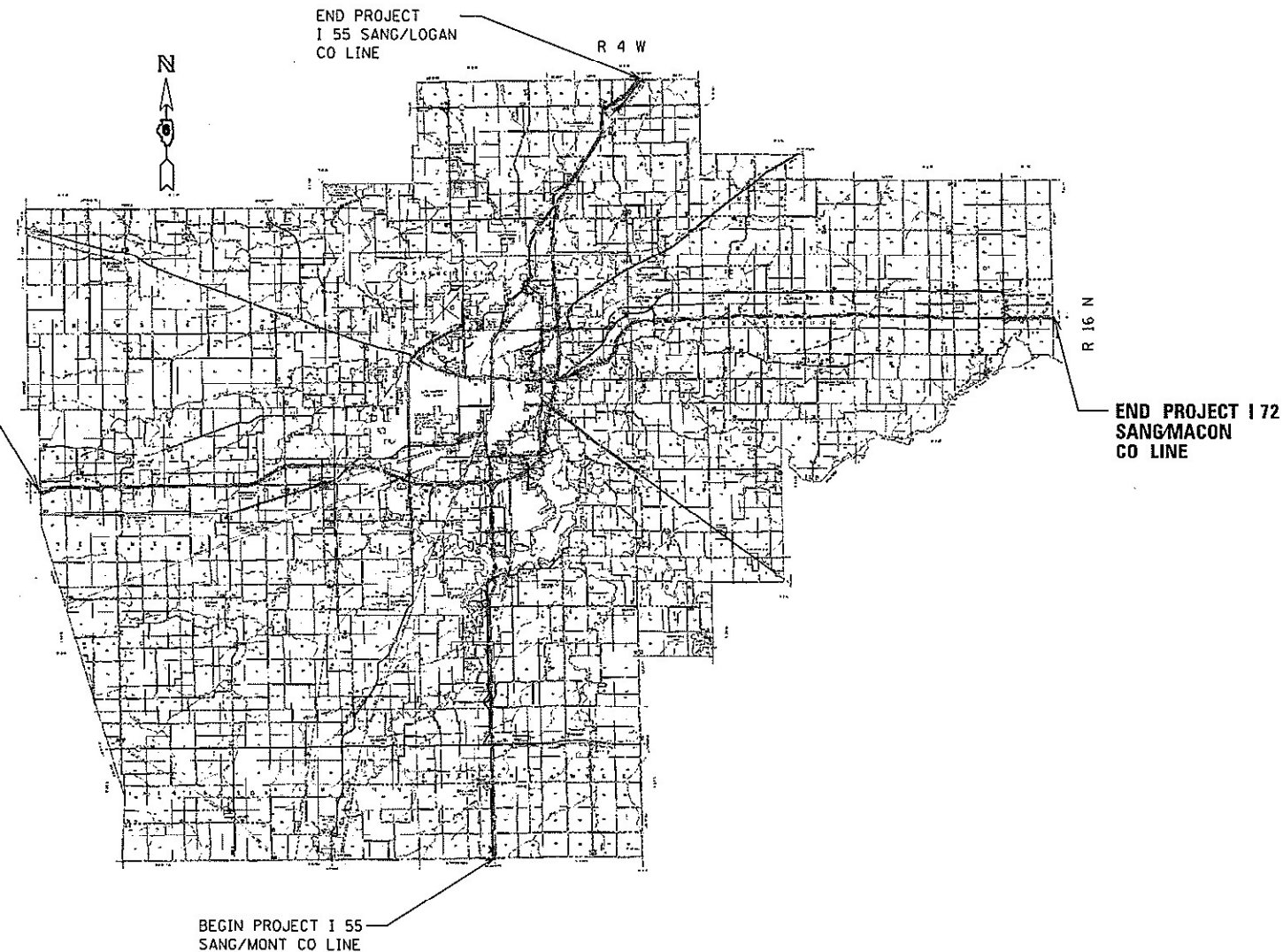

STATE OF ILLINOIS
DEPARTMENT OF TRANSPORTATION

SUBMITTED DEC 8 20 23

Julia P. May REGIONAL ENGINEER
SVR
December 8, 2023

Steph M. Smith ENGINEER OF DESIGN AND ENVIRONMENT
December 8, 2023

Steph M. Smith DIRECTOR OF HIGHWAYS PROJECT IMPLEMENTATION

PRINTED BY THE AUTHORITY
OF THE STATE OF ILLINOIS

INDEX OF SHEETS

SHEET NO.	DESCRIPTION
1.	COVER SHEET
2.	INDEX OF SHEETS, STANDARDS, GENERAL NOTES & SIGNATURE
3.	SUMMARY OF QUANTITIES
4-5.	PATCHING SCHEDULES
6.	PROJECT LOCATION MAP
7-9.	PROJECT TYPICAL SECTIONS
10.	DETOUR PLAN
11-14.	DETOUR DETAILS

STANDARDS

STANDARD NO.	DESCRIPTION
000001-08	STANDARD SYMBOLS, ABBREVIATIONS AND PATTERNS
001006	DECIMAL OF AN INCH AND OF A FOOT
420001-10	PAVEMENT JOINTS
420701-03	PAVEMENT WELDED WIRE REINFORCEMENT
442001-04	CLASS A PATCHES
442101-09	CLASS B PATCHES
701101-05	OFF-RD OPERATIONS, MULTILANE, 15' TO 24" FROM EDGE OF PAVEMENT
701106-02	OFF-RD OPERATIONS, MULTILANE, MORE THAN 15" AWAY
701400-12	APPROACH TO LANE CLOSURE, FREEWAY/EXPRESSWAY
701401-13	LANE CLOSURE, FREEWAY/EXPRESSWAY
701411-09	LANE CLOSURE, MULTILANE AT ENTRANCE OR EXIT RAMP FOR SPEEDS \geq 45 MPH
701446-11	TWO LANE CLOSURE, FREEWAY/EXPRESSWAY
701901-09	TRAFFIC CONTROL DEVICES
701422-10	LANE CLOSURE, MULTILANE, FOR SPEEDS \geq 45 MPH TO 55 MPH
701451-05	RAMP CLOSURE FREEWAY/EXPRESSWAY
701456-05	PARTIAL EXIT RAMP CLOSURE FREEWAY/EXPRESSWAY

STATE OF ILLINOIS DEPARTMENT OF TRANSPORTATION DIVISION OF HIGHWAYS DISTRICT 6	
EXAMINED	October, 25 20 23
<i>[Signature]</i> ENGINEER OF OPERATIONS	
EXAMINED	October, 25 20 23
<i>[Signature]</i> ENGINEER OF PROJECT IMPLEMENTATION	
EXAMINED	October, 25 20 23
<i>[Signature]</i> ENGINEER OF PROGRAM DEVELOPMENT	

REV. - MS

FILE NAME =	USER NAME = Timothy.Sharp	DESIGNED -	REVISED -	STATE OF ILLINOIS DEPARTMENT OF TRANSPORTATION	INDEX OF SHEETS, STANDARDS GENERAL NOTES, SIGNATURES	F.A.I. RTE.	SECTION	COUNTY	TOTAL SHEETS	SHEET NO.	
S:\CONTRMAINT_CAD\combined-72722\PLANS	72722-ah-2-ge.mote.dgn	DRAWN - DMS	REVISED -			55572	D6 PATCHING 2024-1	SANGAMON	14	2	
Default	PLOT SCALE = 80.0000' / in.	CHECKED -	REVISED -			SCALE: _____ SHEET _____ OF _____ SHEETS STA. _____ TO STA. _____		ILLINOIS FED. AID PROJECT			
	PLOT DATE = 10/26/2023	DATE -	REVISED -			CONTRACT NO. 72722					

0-02178-6019
100% STATE
SANGAMON

CODE NO.	ITEM	UNIT	TOTAL QUANTITY	ROADWAY
				0006 RURAL
44200050	WELDED WIRE REINFORCEMENT	SQ YD	600	600
44200610	CLASS A PATCHES, TYPE II, 13 INCH	SQ YD	357	357
44200612	CLASS A PATCHES, TYPE III, 13 INCH	SQ YD	52	52
44200614	CLASS A PATCHES, TYPE IV, 13 INCH	SQ YD	47	47
44200620	CLASS A PATCHES, TYPE II, 14 INCH	SQ YD	83	83
44200624	CLASS A PATCHES, TYPE III, 14 INCH	SQ YD	36	36
44200628	CLASS A PATCHES, TYPE IV, 14 INCH	SQ YD	53	53
44201023	CLASS B PATCHES, TYPE III, 14 INCH	SQ YD	24	24
44201025	CLASS B PATCHES, TYPE IV, 14 INCH	SQ YD	576	576
44201043	CLASS B PATCHES, TYPE II, 16 INCH	SQ YD	435	435
44201299	DOWEL BARS 1 1/2"	EACH	1,156	1,156
44213000	PATCHING REINFORCEMENT	SQ YD	628	628
44213200	SAW CUTS	FOOT	7,165	7,165
44213204	TIE BARS 3/4"	EACH	147	147
67100100	MOBILIZATION	L SUM	1	1
70100320	TRAFFIC OCONTROL AND PROTECTION, STANDARD 701422	L SUM	1	1
70100420	TRAFFIC CONTROL AND PROTECTION, STANDARD 701411	EACH	20	20
70100800	TRAFFIC OCONTROL AND PROTECTION, STANDARD 701401	L SUM	1	1
70100815	TRAFFIC OCONTROL AND PROTECTION, STANDARD 701446	L SUM	1	1
70100820	TRAFFIC OCONTROL AND PROTECTION, STANDARD 701451	L SUM	1	1
70107025	CHANGEABLE MESSAGE SIGN	CAL DAY	30	30
70100825	TRAFFIC OCONTROL AND PROTECTION, STANDARD 701456	L SUM	1	1
70200100	NIGHTTIME WORK ZONE LIGHTING	L SUM	1	1
Z0016702	DETOUR SIGNING	L SUM	1	1

REV. - MS

MODEL: Default
FILE NAME: S:\CONTRACTS\100\CONTRACTS\100\CONTRACTS\100\ANS\72722\PLAN\72722-INT-3-S00.dgn

USER NAME = Timothy.Sharp	DESIGNED - _____	REVISED - _____
PLOT SCALE = 2.0000' / in.	DRAWN - _____	REVISED - _____
PLOT DATE = 10/27/2023	CHECKED - _____	REVISED - _____
	DATE - _____	REVISED - _____

**STATE OF ILLINOIS
DEPARTMENT OF TRANSPORTATION**

SUMMARY OF QUANTITIES

SCALE: _____ SHEET _____ OF _____ SHEETS STA. _____ TO STA. _____

F.A.I. RTE.	SECTION	COUNTY	TOTAL SHEETS	SHEET NO.
55, 72	D6 PATCHING 2024-1	SANGAMON	14	3
			CONTRACT NO. 72722	
ILLINOIS FED. AID PROJECT				

END PROJECT ON I-55
SANG/LOGAN CO LINE

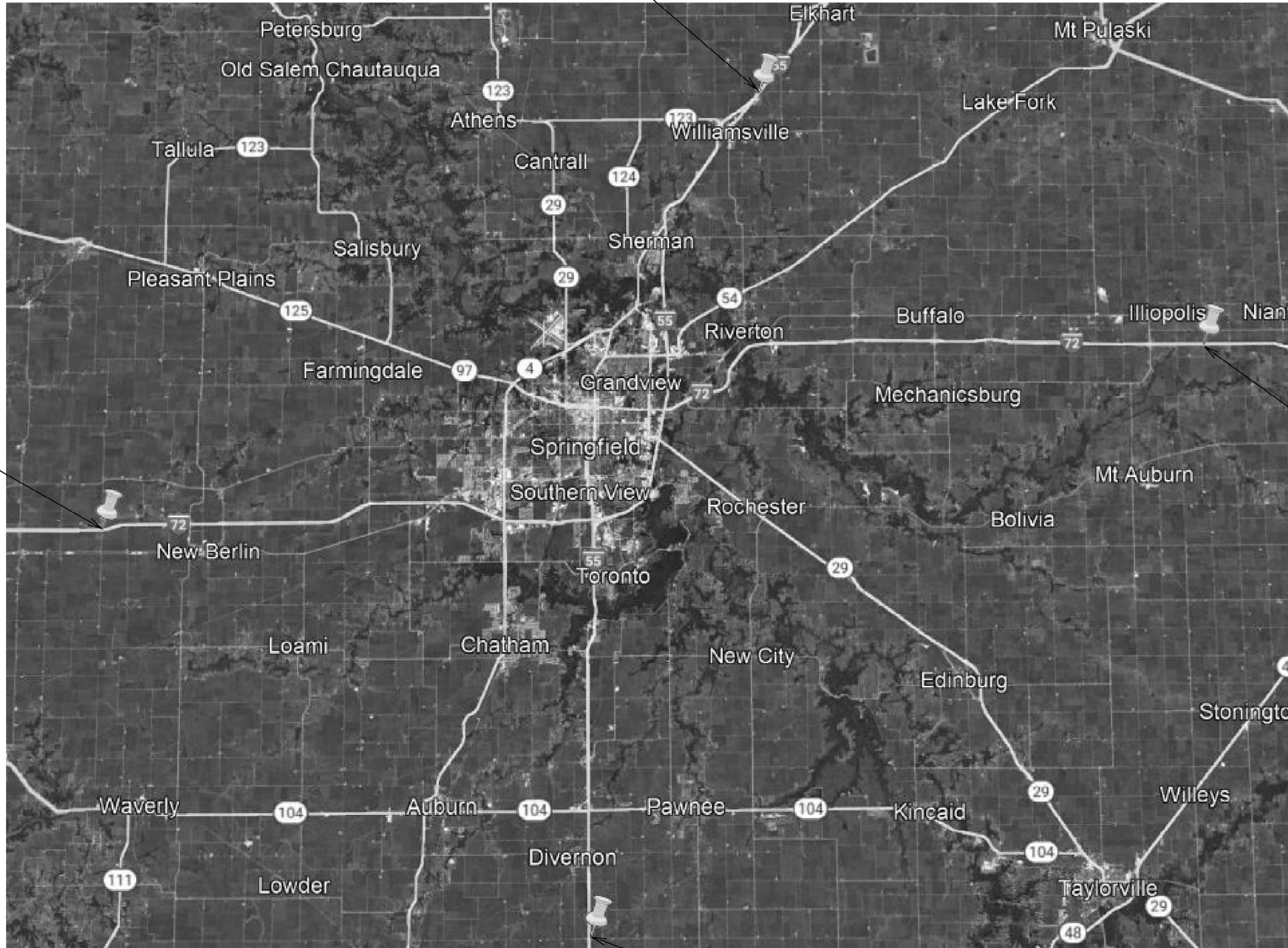

BEGIN PROJECT
ON I-72
SANG/MORGAN
CO LINE

END PROJECT
ON I-72
SANG/MACON
CO LINE

BEGIN PROJECT ON I-55
SANG/MONT CO. LINE

REV. - MS

MODEL: Default
FILE NAME: S:\CONTRACTS\72722\PLANS\72089-sh-6-plans.dgn

USER NAME = Timothy.Sharp	DESIGNED - _____	REVISED - _____
	DRAWN - _____	REVISED - _____
PLOT SCALE = 2.0000' / in.	CHECKED - _____	REVISED - _____
PLOT DATE = 10/26/2023	DATE - _____	REVISED - _____

**STATE OF ILLINOIS
DEPARTMENT OF TRANSPORTATION**

LOCATION MAP

SCALE: _____ SHEET _____ OF _____ SHEETS STA. _____ TO STA. _____

F.A.I. RTE.	SECTION	COUNTY	TOTAL SHEETS	SHEET NO.
55, 72	D6 PATCHING 2024-1	SANGAMON	14	6
ILLINOIS FED. AID PROJECT			CONTRACT NO. 72722	

MODEL: D:\p\h\p\...
 FILE NAME: S:\CONTRACTS\72722\PLAN\55\72722-INT-2-9-24\pcc.txd

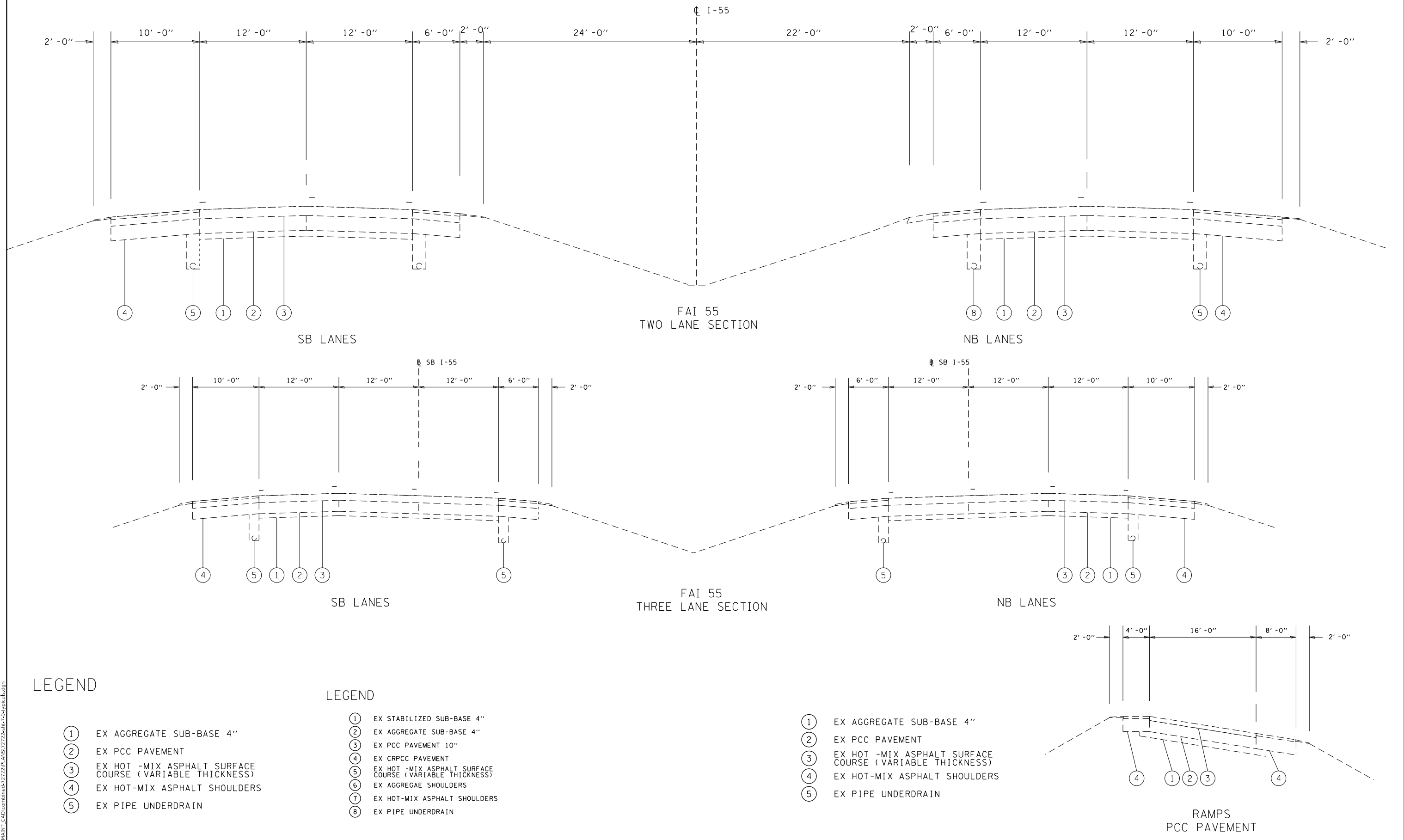

LEGEND

- ① EX AGGREGATE SUB-BASE 4"
- ② EX PCC PAVEMENT
- ③ EX HOT -MIX ASPHALT SURFACE COURSE (VARIABLE THICKNESS)
- ④ EX HOT-MIX ASPHALT SHOULDERS
- ⑤ EX PIPE UNDERDRAIN

LEGEND

- ① EX STABILIZED SUB-BASE 4"
- ② EX AGGREGATE SUB-BASE 4"
- ③ EX PCC PAVEMENT 10"
- ④ EX CRPCC PAVEMENT
- ⑤ EX HOT -MIX ASPHALT SURFACE COURSE (VARIABLE THICKNESS)
- ⑥ EX AGGREGAE SHOULDERS
- ⑦ EX HOT-MIX ASPHALT SHOULDERS
- ⑧ EX PIPE UNDERDRAIN

- ① EX AGGREGATE SUB-BASE 4"
- ② EX PCC PAVEMENT
- ③ EX HOT -MIX ASPHALT SURFACE COURSE (VARIABLE THICKNESS)
- ④ EX HOT-MIX ASPHALT SHOULDERS
- ⑤ EX PIPE UNDERDRAIN

USER NAME = Timothy,Sharp	DESIGNED - _____	REVISED - _____
DRAWN - _____	REVISIONS - _____	REVISIONS - _____
PLOT SCALE = 5,0000' / in.	CHECKED - _____	REVISIONS - _____
PLOT DATE = 10/27/2023	DATE - _____	REVISIONS - _____

**STATE OF ILLINOIS
DEPARTMENT OF TRANSPORTATION**

TYPICALS

SCALE: _____ SHEET _____ OF _____ SHEETS STA. _____ TO STA. _____

F.A.I. RTE.	SECTION	COUNTY	TOTAL SHEETS	SHEET NO.
55, 72	D6 PATCHING 2024-1	SANGAMON	14	7
CONTRACT NO. 72722				
ILLINOIS FED. AID PROJECT				

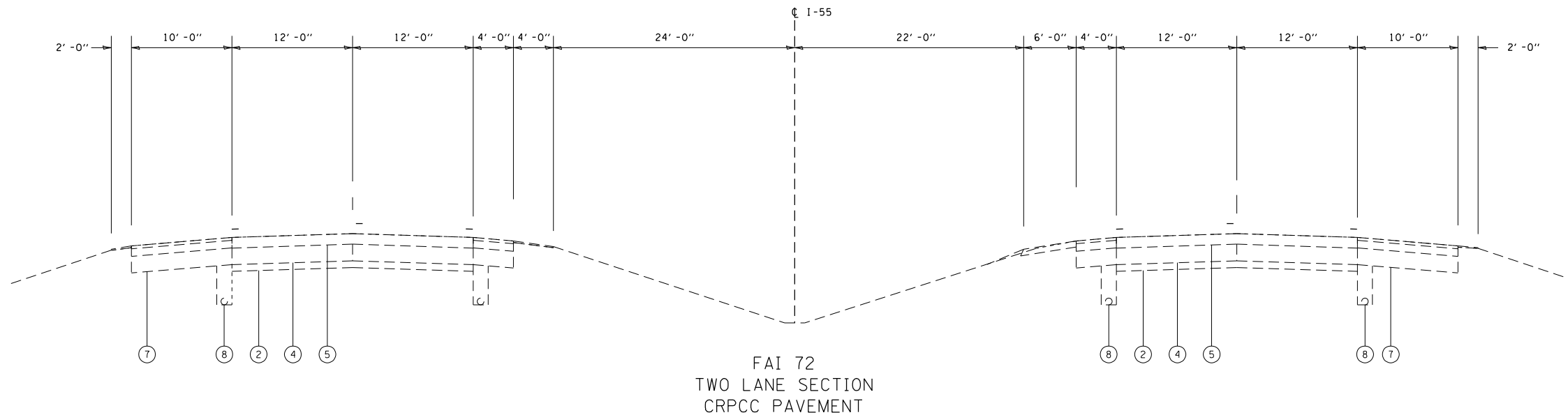

FAI 72
TWO LANE SECTION
CRPCC PAVEMENT

LEGEND

- ① EX STABILIZED SUB-BASE 4"
- ② EX AGGREGATE SUB-BASE 4"
- ③ EX PCC PAVEMENT 10"
- ④ EX CRPCC PAVEMENT
- ⑤ EX HOT -MIX ASPHALT SURFACE COURSE (VARIABLE THICKNESS)
- ⑥ EX AGGREGAE SHOULDERS
- ⑦ EX HOT-MIX ASPHALT SHOULDERS
- ⑧ EX PIPE UNDERDRAIN

FILE NAME =	USER NAME = Timothy.Sharp	DESIGNED - _____	REVISED - _____
S:\CONTRMAINT_CAD\combined-72722\PLANS	72722-sht-7-9-typicals.dgn	DRAWN - _____	REVISED - _____
Default	PLOT SCALE = 5.0000' / in.	CHECKED - _____	REVISED - _____
	PLOT DATE = 10/27/2023	DATE - _____	REVISED - _____

STATE OF ILLINOIS
DEPARTMENT OF TRANSPORTATION

TYPICALS

SCALE: _____ SHEET ____ OF ____ SHEETS STA. _____ TO STA. _____

F.A.I. RTE.	SECTION	COUNTY	TOTAL SHEETS	SHEET NO.
55, 72	D6 PATCHING 2024-1	SANGAMON	14	8
CONTRACT NO. 72722				
ILLINOIS FED. AID PROJECT				

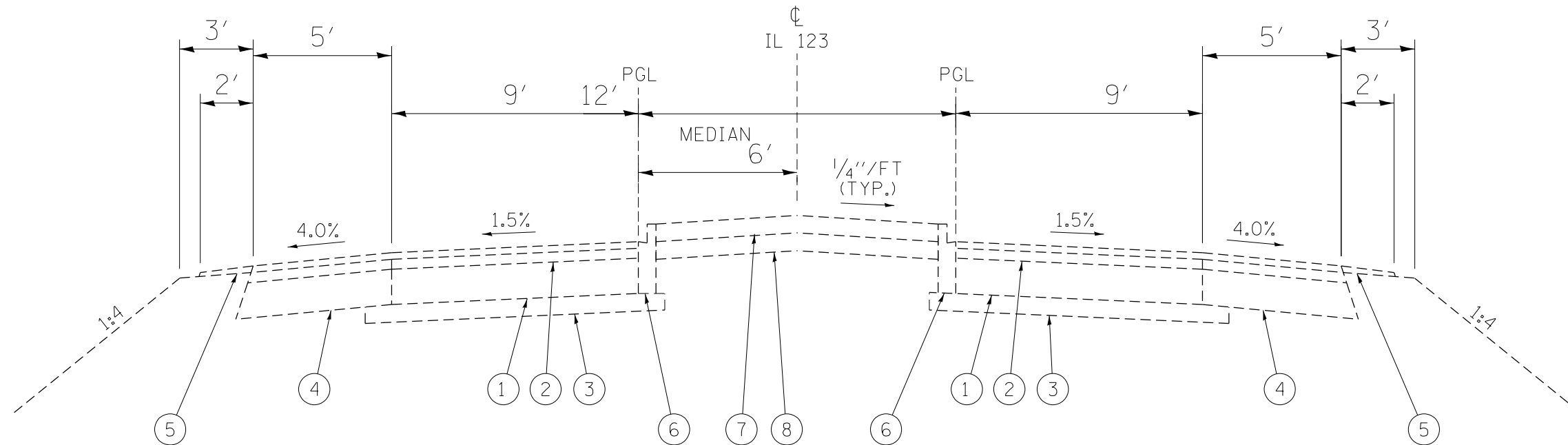

LEGEND

- ① EXISTING JRCP PAVEMENT 8"
- ② EXISTING BITUMINOUS CONCRETE
- ③ EXISTING STABILIZED SUBBASE, 4"
- ④ EXISTING BITUMINOUS SHOULDER, 10 1/2"
- ⑤ EXIST. AGGREGATE SHOULDERS, TYPE B
- ⑥ EXIST. COMBINATION CONCRETE CURB AND GUTTER, TYPE M-6.06
- ⑦ EXIST. CONCRETE MEDIAN SURFACE, 4"
- ⑧ EXIST. SAND BACKFILL, 4"

STA. 46+49.75 TO 56+91.83
 NOTE: BRIDGE OMISSION
 STA. 48+67.02 TO STA. 51+41.22

FILE NAME =	USER NAME = Timothy.Sharp	DESIGNED - _____	REVISED - _____	STATE OF ILLINOIS DEPARTMENT OF TRANSPORTATION	TYPICALS	F.A.I. RTE.	SECTION	COUNTY	TOTAL SHEETS	SHEET NO.	
S:\CONTRMAINT_CAD\combined-72722\PLANS	72722-sht-7-9-typicals.dgn	DRAWN - _____	REVISED - _____			55.72	D6 PATCHING 2024-1	SANGAMON	14	9	
Default	PLOT SCALE = 5.0000' / in.	CHECKED - _____	REVISED - _____			CONTRACT NO. 72722					
	PLOT DATE = 10/27/2023	DATE - _____	REVISED - _____			ILLINOIS FED. AID PROJECT					

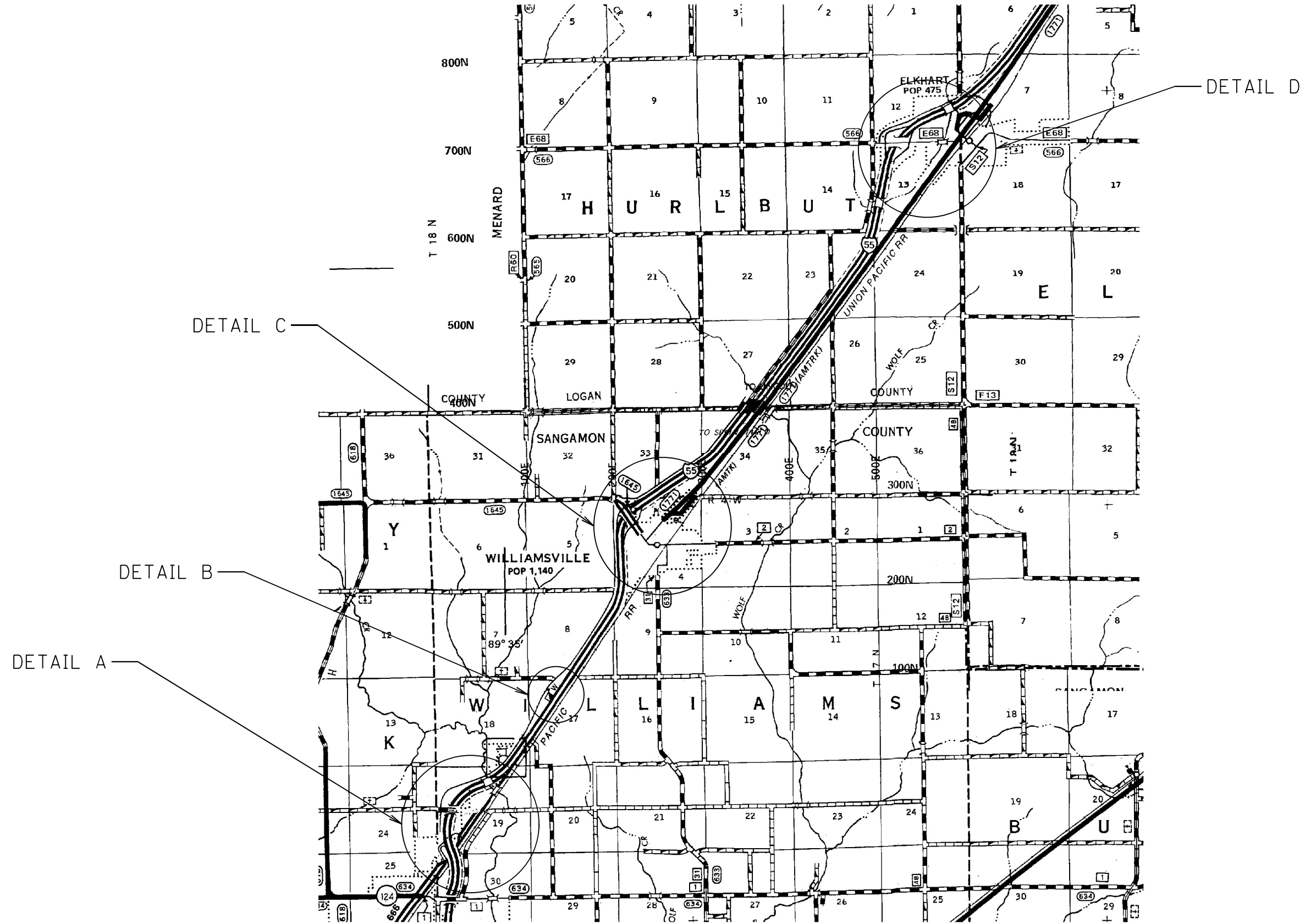

MODEL Path: \\s:\CONTRACTS\72722\PLANS\72722-10.dwg
 FILE NAME: S:\CONTRACTS\72722\PLANS\72722-10.dwg

USER NAME = Timothy,Sharp	DESIGNED - _____	REVISED - _____
	DRAWN - _____	REVISED - _____
PLOT SCALE = 2,000' / in.	CHECKED - _____	REVISED - _____
PLOT DATE = 10/27/2023	DATE - _____	REVISED - _____

STATE OF ILLINOIS
DEPARTMENT OF TRANSPORTATION

DETOUR LOCATION MAP
 SCALE: _____ SHEET _____ OF _____ SHEETS STA. _____ TO STA. _____

F.A.I. RTE.	SECTION	COUNTY	TOTAL SHEETS	SHEET NO.
55, 72	D6 PATCHING 2024-1	SANGAMON	14	10
CONTRACT NO. 72722			ILLINOIS FED. AID PROJECT	



DETAIL A

MODEL Path: \\S:\CONTRACTS\72722\CAD\combined\72722\PLAN\5\72722-abc-11-14-detour_detail.dgn

USER NAME = Timothy,Sharp	DESIGNED - _____	REVISED - _____
	DRAWN - _____	REVISED - _____
PLOT SCALE = 60,0000 * / in.	CHECKED - _____	REVISED - _____
PLOT DATE = 10/27/2023	DATE - _____	REVISED - _____

STATE OF ILLINOIS
DEPARTMENT OF TRANSPORTATION

DETOUR ROUTE PLAN

SCALE: _____ SHEET ____ OF ____ SHEETS STA. _____ TO STA. _____

F.A.I. RTE.	SECTION	COUNTY	TOTAL SHEETS	SHEET NO.
55, 72	D6 PATCHING 2024-1	SANGAMON	14	11
CONTRACT NO. 72722				
ILLINOIS FED. AID PROJECT				



DETOUR
NORTH
INTERSTATE
55
↑
M4-8 (2412) (O)
M3-2(O) (2412)
M1-1 (2424)
M6-3

DETOUR
NORTH
123
↑
M4-8 (2412) (O)
M3-4(O) (2412)
M1-5 (2424)
M6-3

DETAIL B

MODEL: Default
FILE NAME: S:\CONTRACTS\72722\PLAN\572722-Sub-11-14-detour_detail.dgn

USER NAME = Timothy,Sharp	DESIGNED - _____	REVISED - _____
	DRAWN - _____	REVISED - _____
PLOT SCALE = 60,0000 * / in.	CHECKED - _____	REVISED - _____
PLOT DATE = 10/27/2023	DATE - _____	REVISED - _____

STATE OF ILLINOIS
DEPARTMENT OF TRANSPORTATION

SCALE: _____		SHEET _____	OF _____	SHEETS	STA. _____	TO STA. _____
--------------	--	-------------	----------	--------	------------	---------------

DETOUR ROUTE PLAN

F.A.I. RTE.	SECTION	COUNTY	TOTAL SHEETS	SHEET NO.
55, 72	D6 PATCHING 2024-1	SANGAMON	14	12
CONTRACT NO. 72722				
ILLINOIS FED. AID PROJECT				

NB I-55 RAMP
CLOSED
FOLLOW DETOUR

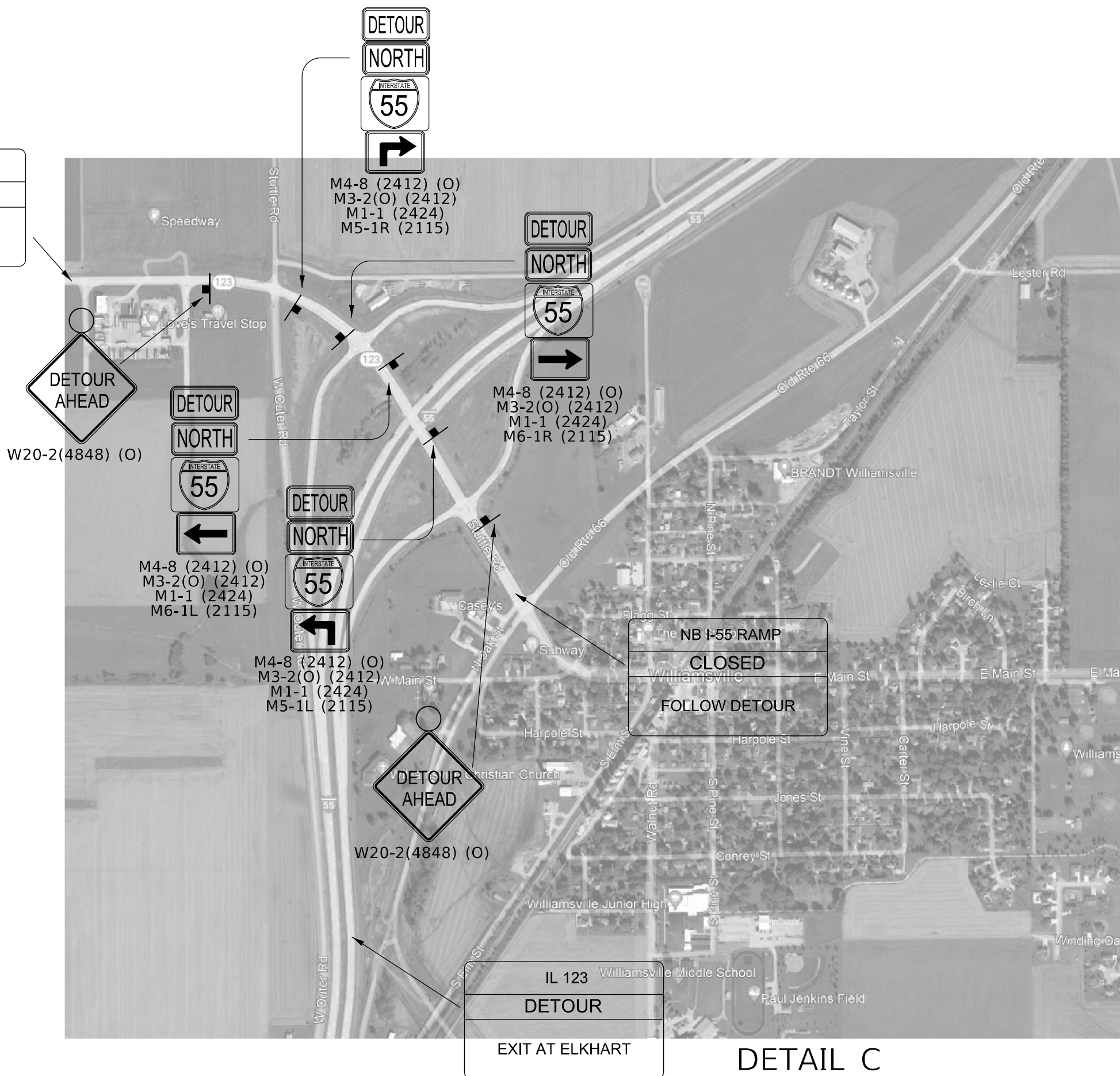

IL 123
DETOUR
EXIT AT ELKHART

DETAIL C

MODEL: Default
FILE NAME: S:\CONTRACTS\72722\PLAN\72722-01c-11-14-detour_detail.dgn

USER NAME = Timothy,Sharp	DESIGNED - _____	REVISED - _____
DRAWN - _____	REVISED - _____	REVISED - _____
PLOT SCALE = 60,0000 * / in.	CHECKED - _____	REVISED - _____
PLOT DATE = 10/27/2023	DATE - _____	REVISED - _____

STATE OF ILLINOIS
DEPARTMENT OF TRANSPORTATION

DETOUR ROUTE PLAN

SCALE: _____ SHEET ____ OF ____ SHEETS STA. _____ TO STA. _____

F.A.I. RTE.	SECTION	COUNTY	TOTAL SHEETS	SHEET NO.
55, 72	D6 PATCHING 2024-1	SANGAMON	14	13
CONTRACT NO. 72722				
ILLINOIS FED. AID PROJECT				

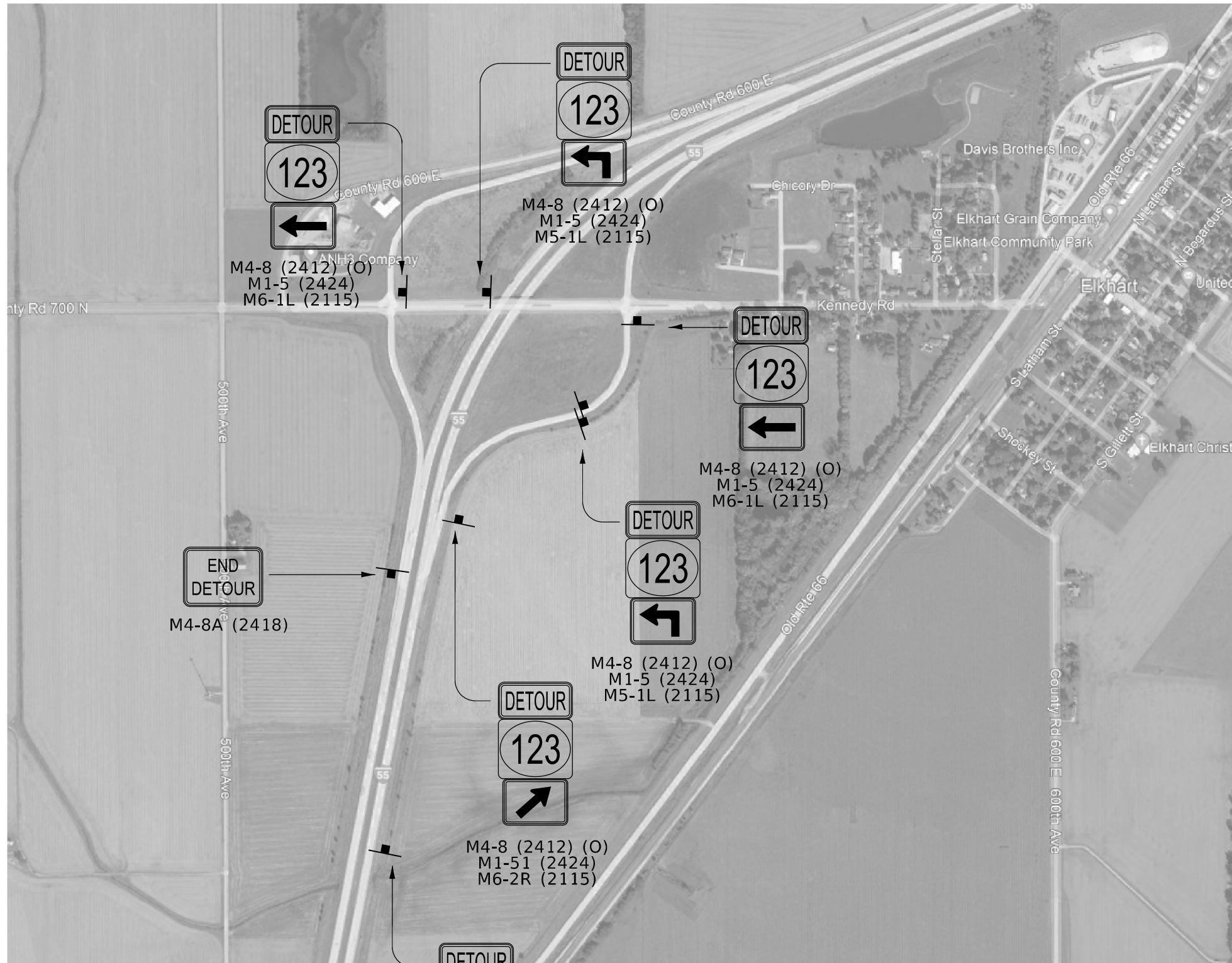

DETAIL D

DETOUR
123
↑
M4-8 (2412) (O)
M1-5 (2424)
M6-3

MODEL: D:\dtd\h\... FILE NAME: S:\CONTRACTS\... CAD:\combined\72722\p\ANSI\72722-dtbl-11-14-detour_detail.dgn

USER NAME = Timothy,Sharp	DESIGNED - _____	REVISED - _____
DRAWN - _____	REVISED - _____	
PLOT SCALE = 60,0000 * / in.	CHECKED - _____	REVISED - _____
PLOT DATE = 10/27/2023	DATE - _____	REVISED - _____

**STATE OF ILLINOIS
DEPARTMENT OF TRANSPORTATION**

DETOUR ROUTE PLAN	
SCALE: _____	SHEET ____ OF ____ SHEETS STA. _____ TO STA. _____

F.A.I. RTE.	SECTION	COUNTY	TOTAL SHEETS	SHEET NO.
55, 72	D6 PATCHING 2024-1	SANGAMON	14	14
CONTRACT NO. 72722				
ILLINOIS FED. AID PROJECT				