

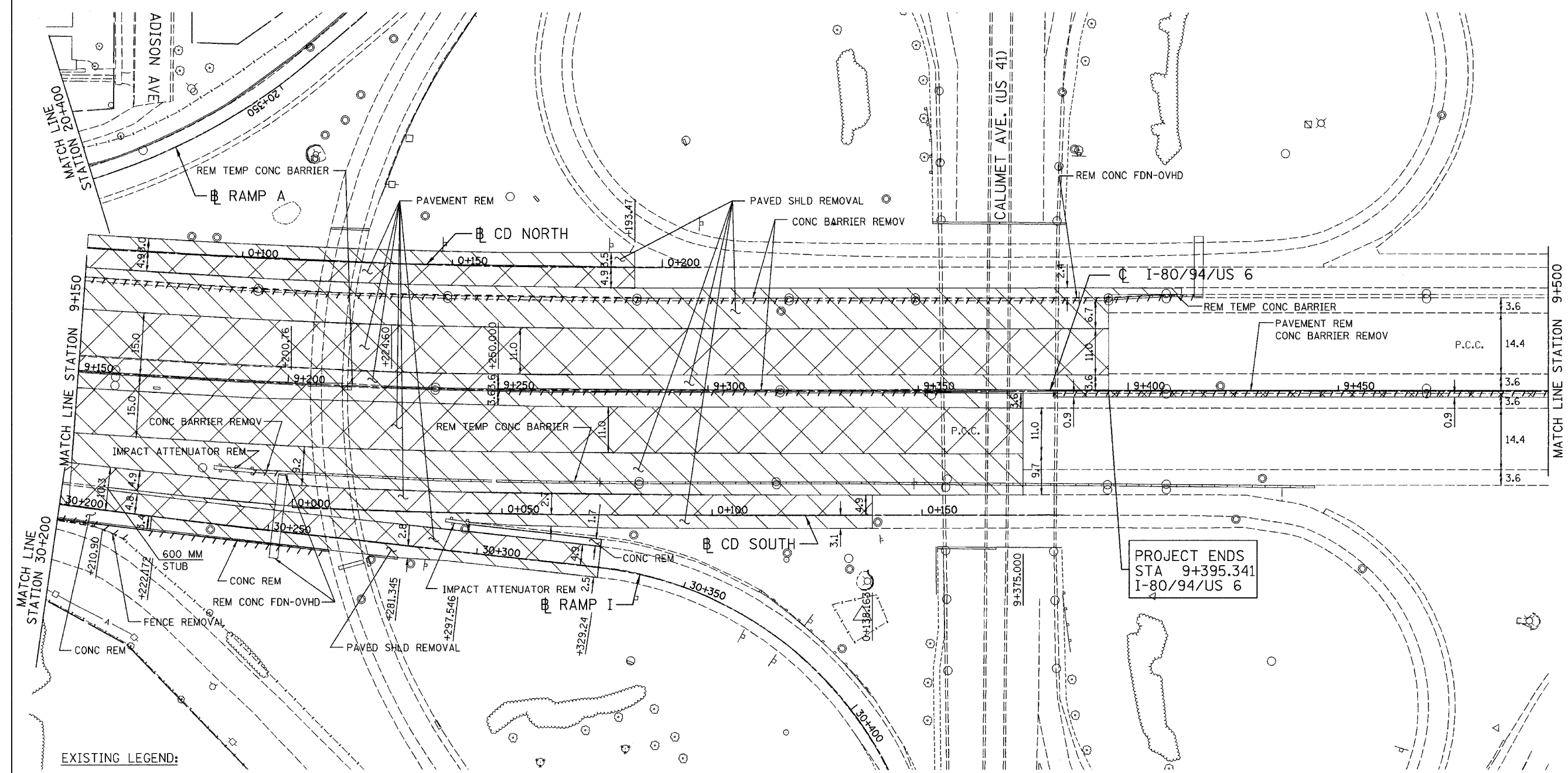



ALL DIMENSIONS IN METERS EXCEPT PAVEMENT ITEMS AND UNLESS NOTED OTHERWISE

F.A.I. RTE.	SECTION	COUNTY	TOTAL SHEETS	SHEET NO.
80/94	2626.2-R-2	COOK/LAKE	1207	62
STA.		TO STA.		
FED. ROAD DIST. NO.		ILLINOIS FED. AID PROJECT		
CONTRACT NO. 62114		INDOT DES. NO. 0100987		

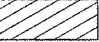

EXISTING LEGEND:

-  LIGHT POLE REMOVAL (BY CONTRACT 62664)
-  PAVEMENT REMOVAL
-  PAVED SHOULDER REMOVAL
-  APPROACH SLAB REMOVAL

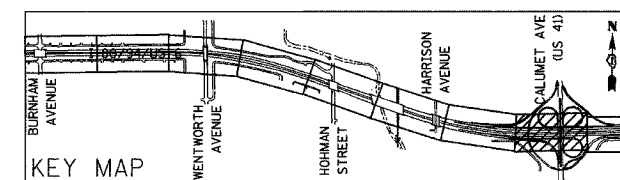

REVISIONS	
NAME	DATE

ILLINOIS DEPARTMENT OF TRANSPORTATION  
 I-80/94/US 6  
 KINGERY-BORMAN EXPRESSWAY  
 BURNHAM ROAD TO US 41  
**EXISTING PLAN**

**STA. 9+150 TO STA. 9+500**  
 SCALE 1:500 DRAWN BY ACE/CAD  
 DATE 07/05 CHECKED BY TAE

**AMERICAN**  
 CONSULTING ENGINEERS

