

F.A.I. RTE. 80/94	SECTION 2626.2-R-1	COUNTY COOK/LAKE	TOTAL SHEETS 1207	SHEET NO. 76
STA. 8+450		TO STA. 8+800		
FED. ROAD DIST. NO.		ILLINOIS FED. AID PROJECT		
CONTRACT NO. 62114		INDOT DES. NO. 0100987		

VPI Sta. 8+545.000  
 EL.: 195.668  
 K = 100  
 516.000 m V.C.

+2.23%      -2.93%

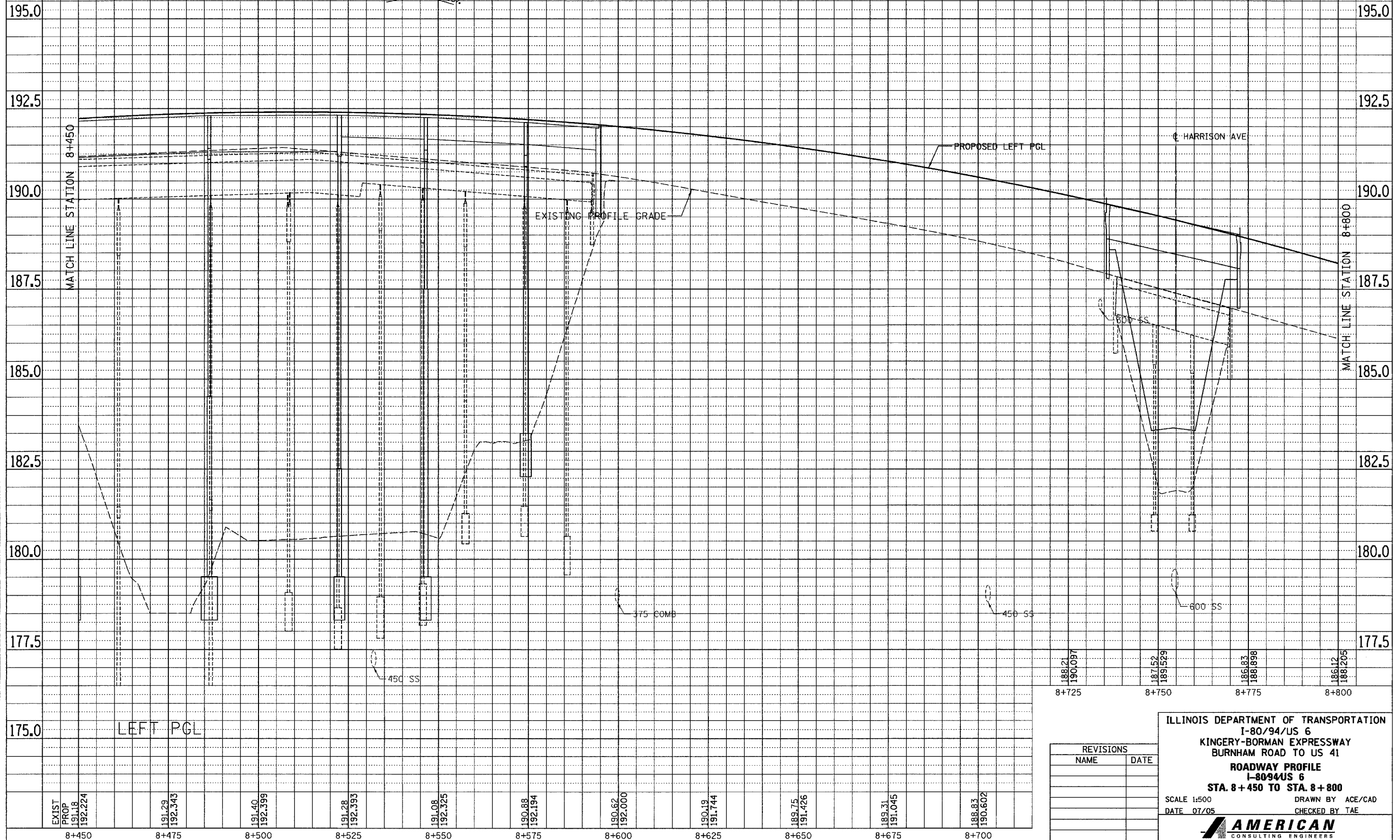

FINAL SURVEY PLOTTED	BY	DATE
NOTE BOOK TEMPLATE		
AREAS CHECKED		
NO.		

ORIGINAL SURVEY PLOTTED	BY	DATE
NOTE BOOK TEMPLATE		
AREAS CHECKED		
NO.		

188.21 190.097	8+725
187.152 189.129	8+750
186.83 188.898	8+775
186.12 188.205	8+800

REVISIONS	
NAME	DATE

ILLINOIS DEPARTMENT OF TRANSPORTATION  
 I-80/94/US 6  
 KINGERY-BORMAN EXPRESSWAY  
 BURNHAM ROAD TO US 41  
**ROADWAY PROFILE**  
 I-80/94/US 6  
**STA. 8+450 TO STA. 8+800**  
 SCALE 1:500      DRAWN BY ACE/CAD  
 DATE 07/05      CHECKED BY TAE

**AMERICAN**  
 CONSULTING ENGINEERS