

F.A.I. RTE.	SECTION	COUNTY	TOTAL SHEETS	SHEET NO.
80/94	2626.2-R-2	COOK/LAKE	1207	111
STA.	TO STA.			
FED. ROAD DIST. NO.	ILLINOIS	FED. AID PROJECT		
CONTRACT NO. 62114	INDOT DES. NO. 0100987			

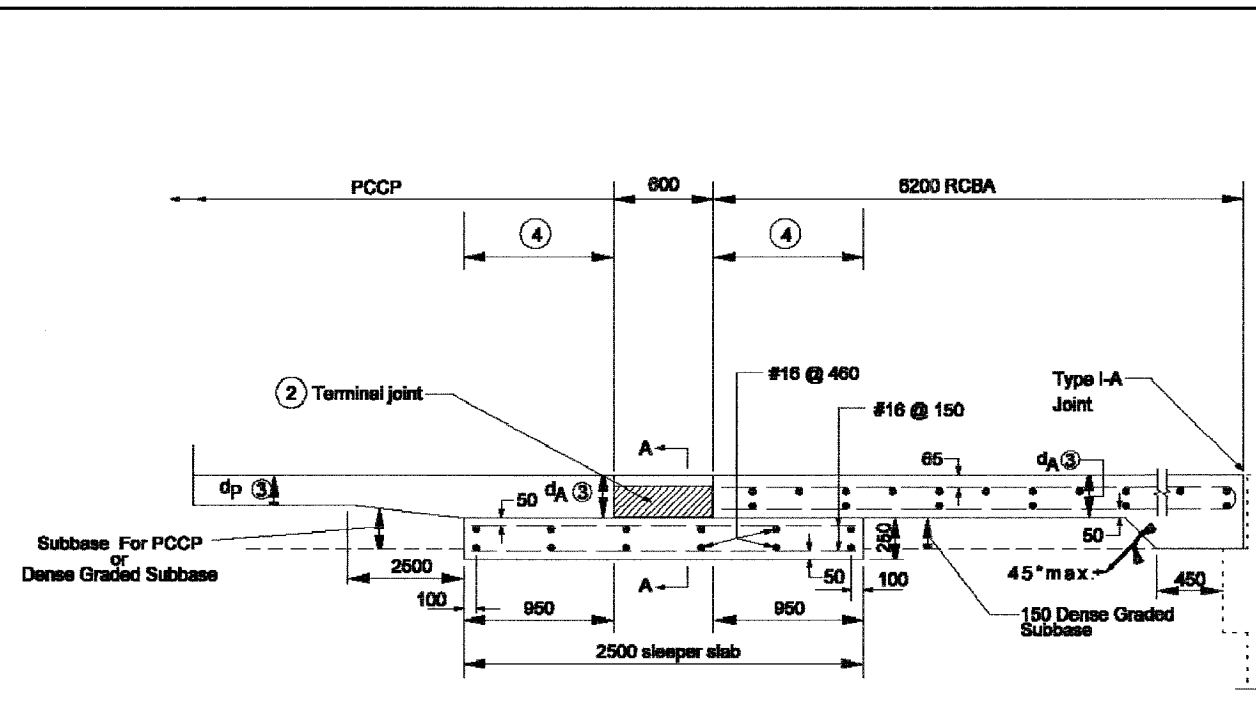

- GENERAL NOTES**
- For reinforcement details, see Standard Drawing 609-RCBA-03 for square RCBA's and Standard Drawing 609-RCBA-04 for skewed RCBA's.
 - Terminal joint elevation shall match elevation of adjacent PCCP and RCBA.
 - Depth d_A must equal d_p . However, if d_p is less than 300, d_A must be 300.
 - Limits of polyethylene bond breaker.
 - All reinforcing bars in the reinforced concrete bridge approach shall be epoxy coated.
 - See Standard Drawing 609-RCBA-07 and 609-BRJT-01 for details of Type I-A Joint

TERMINAL JOINT FOR PCCP AT BRIDGE STRUCTURE

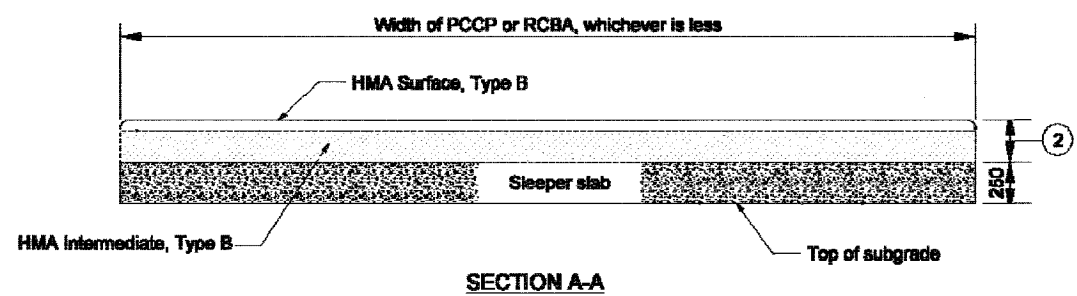

SECTION A-A

All Dimension are in mm unless otherwise specified

INDIANA DEPARTMENT OF TRANSPORTATION
**REINFORCED CONCRETE BRIDGE
 APPROACH AND TERMINAL JOINT
 FOR USE WITH PCCP
 SEPTEMBER 2005**

STANDARD DRAWING NO. 609-RCBA-02

	/s/ Richard L. VanCleave	9-07-05
	DESIGN STANDARDS ENGINEER	DATE
	/s/ Richard K. Smutzer	9-07-05
	CHIEF HIGHWAY ENGINEER	DATE