

F.A.I. 80/94 (KINGERY EXPRESSWAY) BORING LOCATION
 ILLINOIS DEPARTMENT OF TRANSPORTATION, COOK COUNTY
 HORIZ. SCALE: 1/8" = 10' VERT. SCALE: 1/4" = 10'
 Wanda Engineering, Inc. 145 Main Street Lombard, IL 60148 630-953-9926
 Geo-Environmental Engineers
 BASED ON DRAWINGS PREPARED BY AMERICAN CONSULTING ENGINEERS 255-08-04

DATE: _____ BY: _____
 ORIGINAL SURVEYED: _____
 SURVEYED: _____
 CHECKED: _____
 DRAWN: _____
 NO. _____

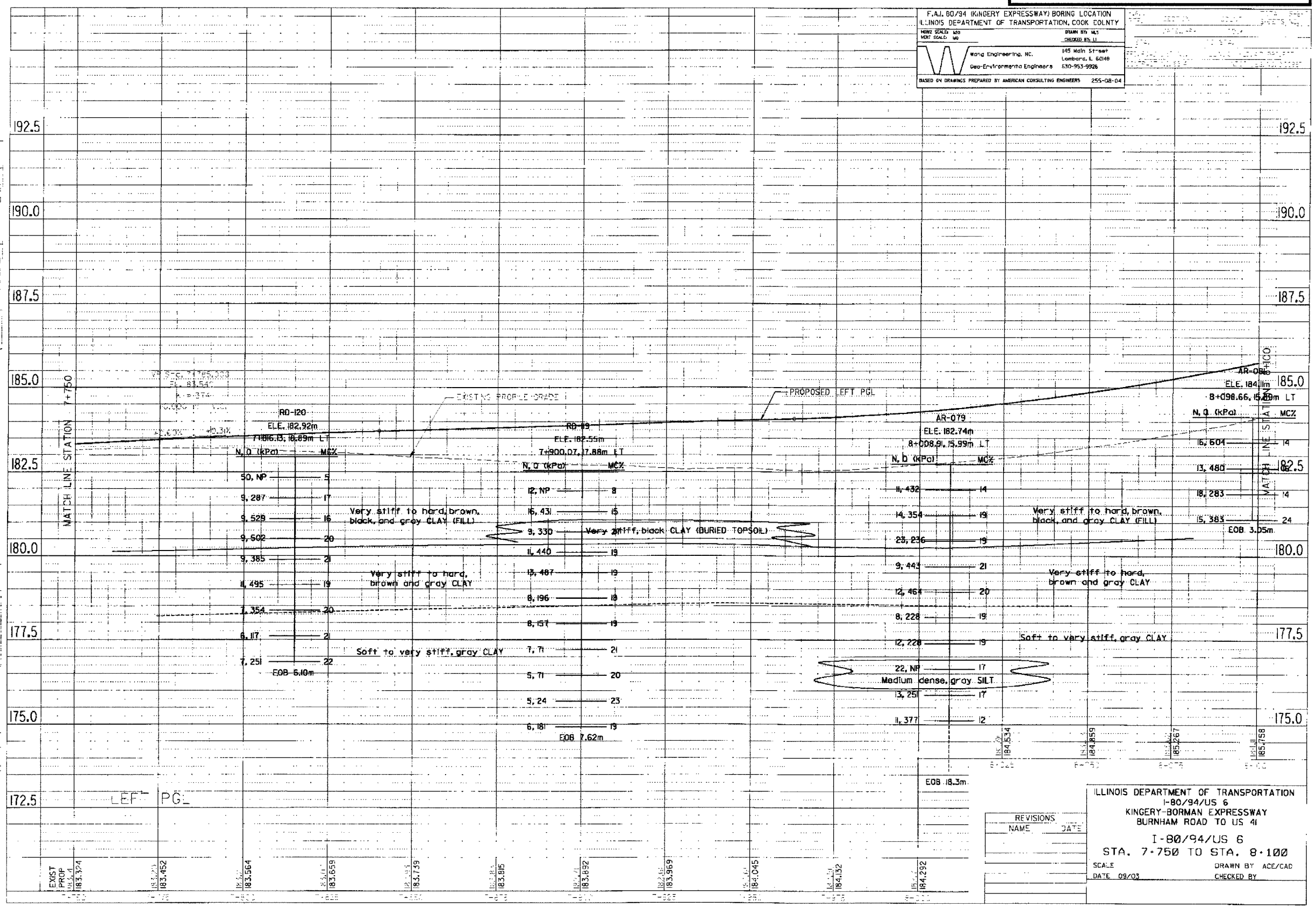

REVISIONS	NAME	DATE

ILLINOIS DEPARTMENT OF TRANSPORTATION
 I-80/94/US 6
 KINGERY-BORMAN EXPRESSWAY
 BURNHAM ROAD TO US 41
 I-80/94/US 6
 STA. 7-750 TO STA. 8-100
 SCALE: _____ DRAWN BY ACE/CAD
 DATE 09/03 CHECKED BY _____