

F.A. 80/94 (KINGERY EXPRESSWAY) BORING LOCATION
 ILLINOIS DEPARTMENT OF TRANSPORTATION, COOK COUNTY

 Wanda Engineering, Inc.
 Geo-Environmental Engineers
 145 Main Street
 Lombard, IL 60148
 630-953-9928

DRAWN BY: MJS
 CHECKED BY: JLU
 BASED ON DRAWINGS PREPARED BY AMERICAN CONSULTING ENGINEERS 255-08-04

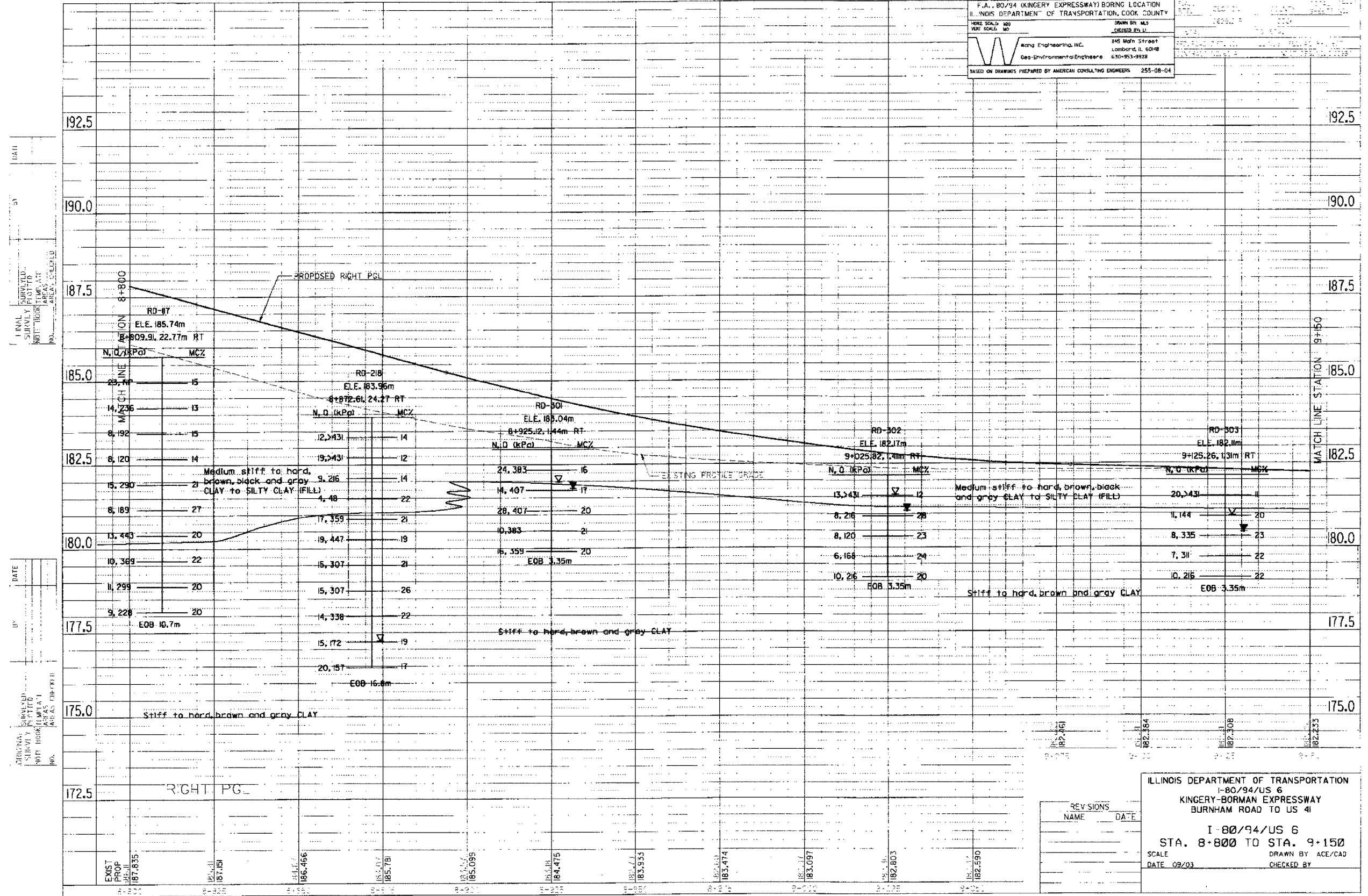

DATE: _____

BY: _____

DATE: _____

BY: _____

DATE: _____

BY: _____

ILLINOIS DEPARTMENT OF TRANSPORTATION
 I-80/94/US 6
 KINGERY-BORMAN EXPRESSWAY
 BURNHAM ROAD TO US 41

I-80/94/US 6
 STA. 8+800 TO STA. 9+150

SCALE: _____ DRAWN BY: ACE/CAD
 DATE: 09/03 CHECKED BY: _____

REVISIONS	NAME	DATE