

ALL DIMENSIONS IN METERS EXCEPT PAY ITEMS AND UNLESS NOTED OTHERWISE

F.A.I. RTE.	SECTION	COUNTY	TOTAL SHEETS	SHEET NO.
80/94	2626.2-R-2	COOK/LAKE	1207	196
STA. TO STA.		FED. ROAD DIST. NO.		
8+100 TO STA.		ILLINOIS FED. AID PROJECT		
		CONTRACT NO. 62114		
		INDOT DES. NO. 0100987		

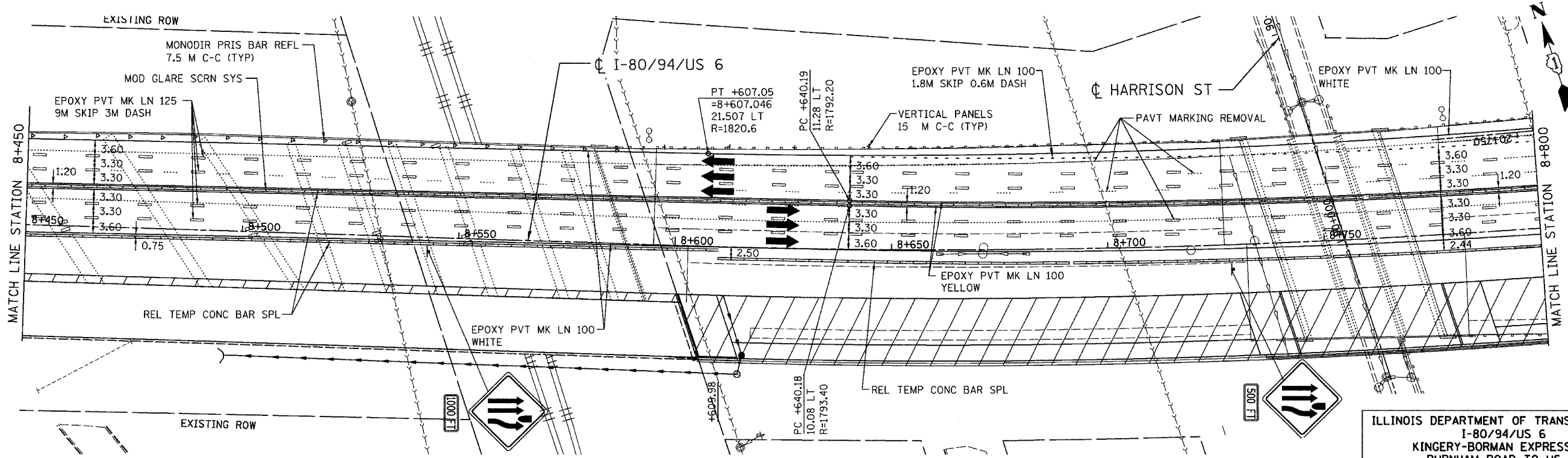

NOTE:  
TEMPORARY STORM SEWER CONNECTION TO EXISTING STRUCTURES PERFORM IN PRE-STAGE 2.

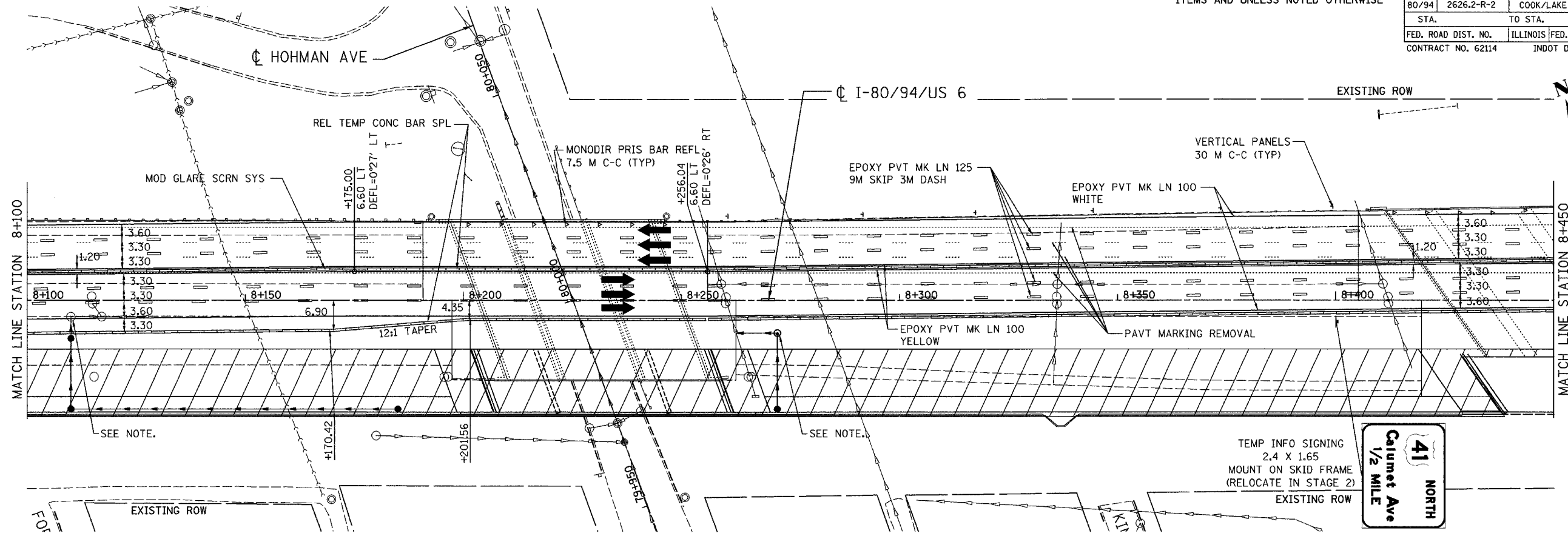
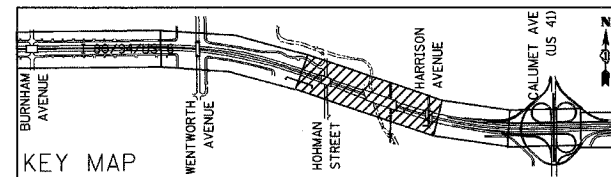

REVISIONS	
NAME	DATE

ILLINOIS DEPARTMENT OF TRANSPORTATION  
I-80/94/US 6  
KINGERY-BORMAN EXPRESSWAY  
BURNHAM ROAD TO US 41  
MAINTENANCE OF TRAFFIC  
STAGE 1  
STA. 8+100 TO STA. 8+800  
SCALE 1:500 DRAWN BY ACE/CAD  
DATE 07/05 CHECKED BY TAE



I:\Projects\011310310\05\_08\151\2005\_10\_03\_21.dwg