

ALL DIMENSIONS IN METERS EXCEPT PAVT ITEMS AND UNLESS NOTED OTHERWISE

F.A.I. RTE.	SECTION	COUNTY	TOTAL SHEETS	SHEET NO.
80/94	2626.2-R-2	COOK/LAKE	1207	197
STA.		TO STA.		
FED. ROAD DIST. NO.		ILLINOIS FED. AID PROJECT		
CONTRACT NO. 62114		INDOT DES. NO. 0100987		

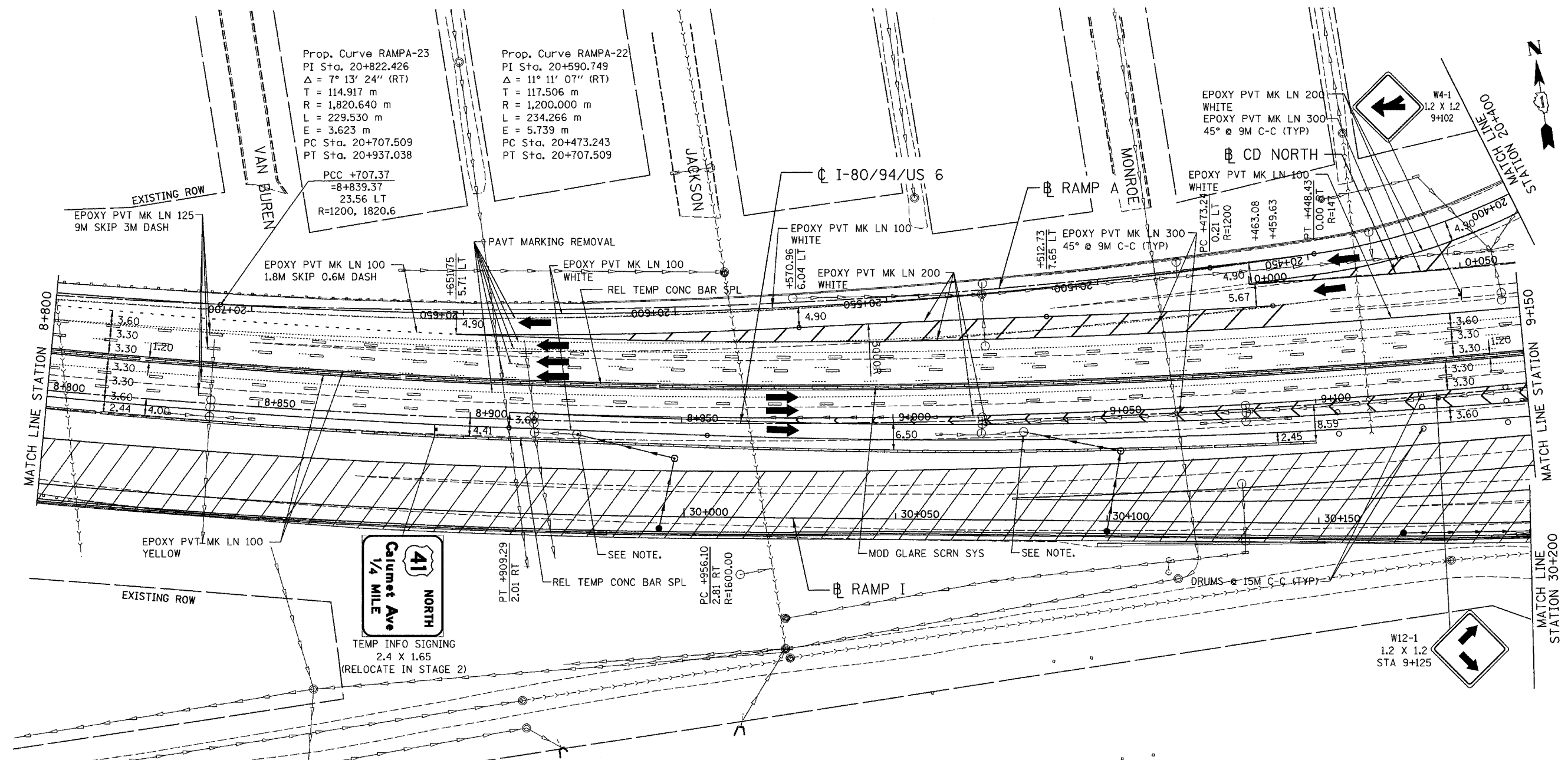

NOTE:  
 TEMPORARY STORM SEWER CONNECTION TO EXISTING STRUCTURES PERFORM IN PRE-STAGE 2.

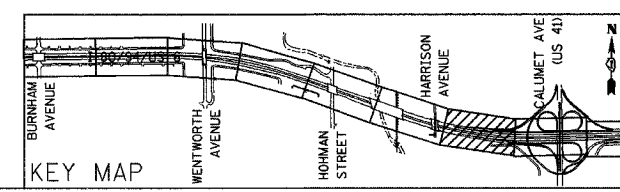

REVISIONS	
NAME	DATE

ILLINOIS DEPARTMENT OF TRANSPORTATION  
 I-80/94/US 6  
 KINGERY-BORMAN EXPRESSWAY  
 BURNHAM ROAD TO US 41  
**MAINTENANCE OF TRAFFIC  
 STAGE 1**  
**STA. 8 + 800 TO STA. 9 + 150**  
 SCALE 1:500  
 DATE 07/05  
 DRAWN BY ACE/CAD  
 CHECKED BY TAE

**AMERICAN**  
 CONSULTING ENGINEERS