

BAR h 308 (E)

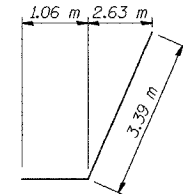

BAR h 309 (E)

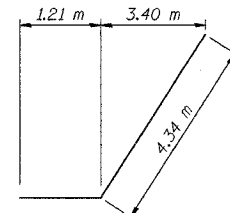

BAR h 310 (E)

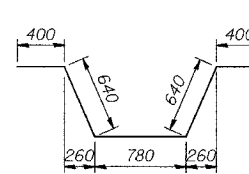

BAR h 311 (E)

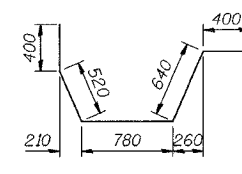

BAR h 312 (E)

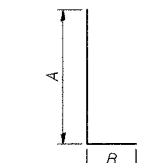

BARS n 300 (E) thru n 303 (E) or n 304 (E) thru n 306 (E)

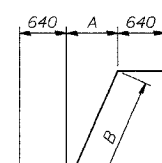

BARS w 303 (E), w 305 (E), w 307 (E) or w 309 (E)

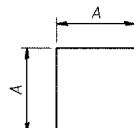

BARS w 304 (E), w 306 (E), w 308 (E) or w 310 (E)

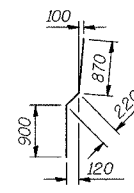

BARS v 306 (E) or v 312 (E)

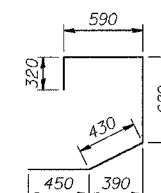

BAR v 307 (E)

PHASE 2 BAR DIMENSIONS

Bar	A	B
n 300 (E)	3.51 m	260
n 301 (E)	3.51 m	400
n 302 (E)	3.57 m	500
n 303 (E)	1.22 m	260
w 303 (E)	1.46 m	2.06 m
w 304 (E)	1.46 m	-
w 305 (E)	1.36 m	1.92 m
w 306 (E)	1.36 m	-
w 307 (E)	1.06 m	1.50 m
w 308 (E)	1.06 m	-
w 309 (E)	1.66 m	2.35 m
w 310 (E)	1.66 m	-

PHASE 3 BAR DIMENSIONS

Bar	A	B
n 304 (E)	3.51 m	260
n 305 (E)	3.51 m	500
n 306 (E)	1.21 m	260

PHASE 2 BILL OF MATERIAL

Bar	No.	Size	Length (m)	Shape
h 308 (E)	704	#15	7.84	—
h 309 (E)	408	#15	7.10	—
h 310 (E)	51	#15	4.28	—
h 311 (E)	2	#15	1.49	—
h 312 (E)	35	#15	2.30	—
h 305 (E)	16	#15	1.10	—
h 306 (E)	24	#15	7.30	—
h 307 (E)	2	#15	5.50	—
h 308 (E)	104	#15	3.50	—
h 309 (E)	54	#15	4.45	—
h 310 (E)	54	#15	5.55	—
h 311 (E)	180	#20	2.86	—
h 312 (E)	4	#20	2.74	—
h 313 (E)	4	#15	0.90	—
h 314 (E)	8	#15	0.60	—

PHASE 3 BILL OF MATERIAL

Bar	No.	Size	Length (m)	Shape
h 315 (E)	25	#15	7.10	—
h 316 (E)	25	#15	7.80	—
h 317 (E)	32	#15	8.90	—
h 318 (E)	2	#15	6.74	—
n 304 (E)	28	#15	3.77	—
n 305 (E)	49	#20	4.01	—
n 306 (E)	62	#15	1.47	—
t 307 (E)	37	#30	4.50	—
t 308 (E)	29	#20	4.50	—
t 309 (E)	67	#20	2.90	—
v 310 (E)	28	#15	4.67	—
v 311 (E)	49	#20	3.60	—
v 312 (E)	25	#20	1.99	—
v 313 (E)	14	#15	4.25	—
v 314 (E)	24	#15	4.80	—
w 313 (E)	32	#15	7.10	—
w 314 (E)	22	#15	8.90	—

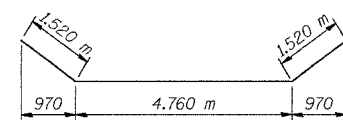

BAR h 316 (E)

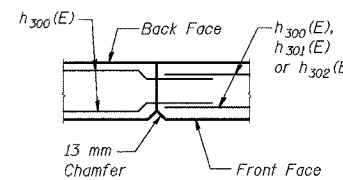

CONSTRUCTION JOINT DETAIL

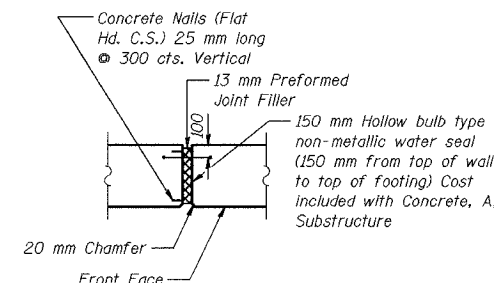

13 MM EXPANSION JOINT DETAIL

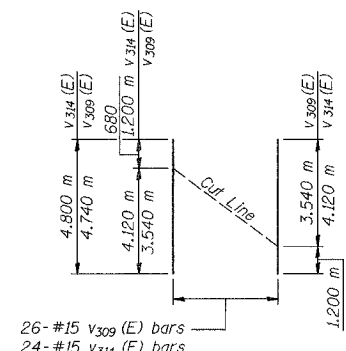

FIELD CUTTING DIAGRAM

Order v 309 (E) or v 314 (E) bars full length. Cut as shown and use remainder of bars in opposite face.

NOTES:

See Sheet S-11 for Wall and Parapet Sections and Anchor Rod Assembly Details

See Sheet S-13 for Rustication details.

Reinforcement bars designated (E) shall be epoxy coated.

All dimensions are in millimeters (mm) except as noted.

See Typical Section on Sheet S-2 for Drainage Details and Surface Seal Limits.

n 300 (E)	603	#15	3.77	—
n 301 (E)	1108	#25	3.91	—
n 302 (E)	53	#30	4.07	—
n 303 (E)	76	#15	1.48	—
t 300 (E)	696	#25	4.00	—
t 301 (E)	617	#20	4.00	—
t 302 (E)	43	#30	5.84	—
t 303 (E)	31	#20	5.84	—
t 304 (E)	54	#25	4.60	—
t 305 (E)	50	#20	4.60	—
t 306 (E)	58	#20	2.80	—

v 300 (E)	250	#15	5.33	—
v 301 (E)	490	#20	4.34	—
v 302 (E)	37	#15	4.98	—
v 303 (E)	53	#25	5.60	—
v 304 (E)	316	#15	4.93	—
v 305 (E)	618	#20	3.93	—
v 306 (E)	566	#20	1.99	—
v 307 (E)	276	#20	2.47	—
v 308 (E)	24	#15	3.44	—
v 309 (E)	26	#15	4.74	—

w 300 (E)	518	#15	7.84	—
w 301 (E)	150	#15	10.01	—
w 302 (E)	12	#15	7.10	—
w 303 (E)	15	#15	3.34	—
w 304 (E)	15	#15	2.92	—
w 305 (E)	15	#15	3.20	—
w 306 (E)	15	#15	2.72	—
w 307 (E)	45	#15	2.78	—
w 308 (E)	45	#15	2.12	—
w 309 (E)	15	#15	3.63	—
w 310 (E)	15	#15	3.32	—
w 311 (E)	44	#15	3.97	—

Test Pile, 356 mm	Each	4		
Excavation, Foundation, Unclassified	m ³	3.336		
Concrete, A, Substructure	m ³	1261.8		
Reinforcing Bars, Epoxy Coated	kg	90,300		
Surface Seal	L Sum	0.08		

Pile, Concrete, Steel Shell Encased, 6.35 mm, 356 mm	m	5,776.0		
Geocomposite Wall Drain	m ²	935		
Pipe, Underdrain, Perf. 1.63 mm, 150 mm	m	189.0		
Noise Abatement Wall Anchor Rod Assembly	Each	52		

The estimated Phase 2 Surface Seal area is 268 m²

Excavation, Foundation, Unclassified	m ³	377.4		
Concrete, A, Substructure	m ³	123.0		
Reinforcing Bars, Epoxy Coated	kg	5,390		
Surface Seal	L Sum	0.01		
Pile, Concrete, Steel Shell Encased, 6.35 mm, 356 mm	m	384.0		
Geocomposite Wall Drain	m ²	59		
Pipe, Underdrain, Perf. 1.63 mm, 150 mm	m	16.2		
Noise Abatement Wall Anchor Rod Assembly	Each	3		
Overhead Sign Structure-Span Anchor Rod Assembly	Each	2		
B Borrow	m ³	48.6		
Structural Backfill	m ³	354.7		
Masonry Coating	L Sum	0.04		

The estimated Phase 3 Surface Seal area is 17.9 m²
The estimated Phase 3 Masonry Coating area is 285.9 m²

DESIGNED	KFA
CHECKED	BPS
DRAWN	MJB
CHECKED	GSP

ILLINOIS DEPARTMENT OF TRANSPORTATION
I-80/94/US 6
KINGERY-BORMAN EXPRESSWAY
BURNHAM ROAD TO US 41
WALL SECTIONS AND DETAILS (2 OF 2)
SECTION 2626.2-R-1
LAKE COUNTY, INDIANA
STATION 8+253.769 TO STATION 8+268.572
STRUCTURE NO. 016-W857
DATE 09/05
AMERICAN
CONSULTING ENGINEERS