

F.A.P. RTE.	SECTION	COUNTY	TOTAL SHEETS	SHEET NO.
301		STEPHENSON	290	47
STA.		TO STA.		
FED. ROAD DIST. NO. 2		ILLINOIS FED. AID PROJECT		

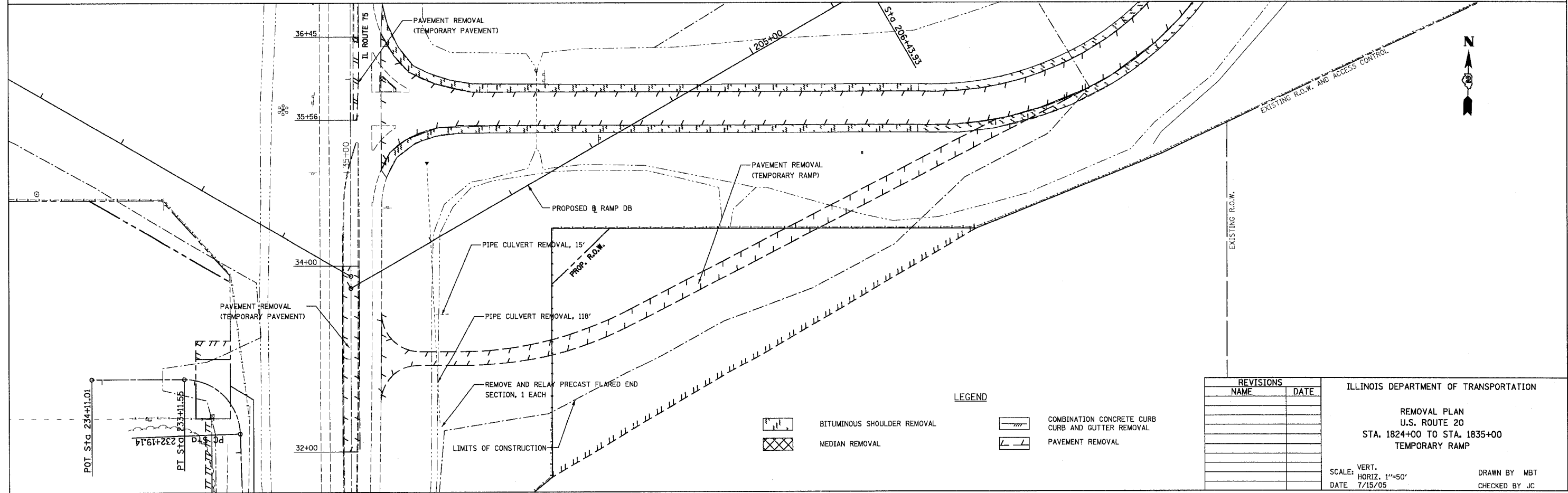
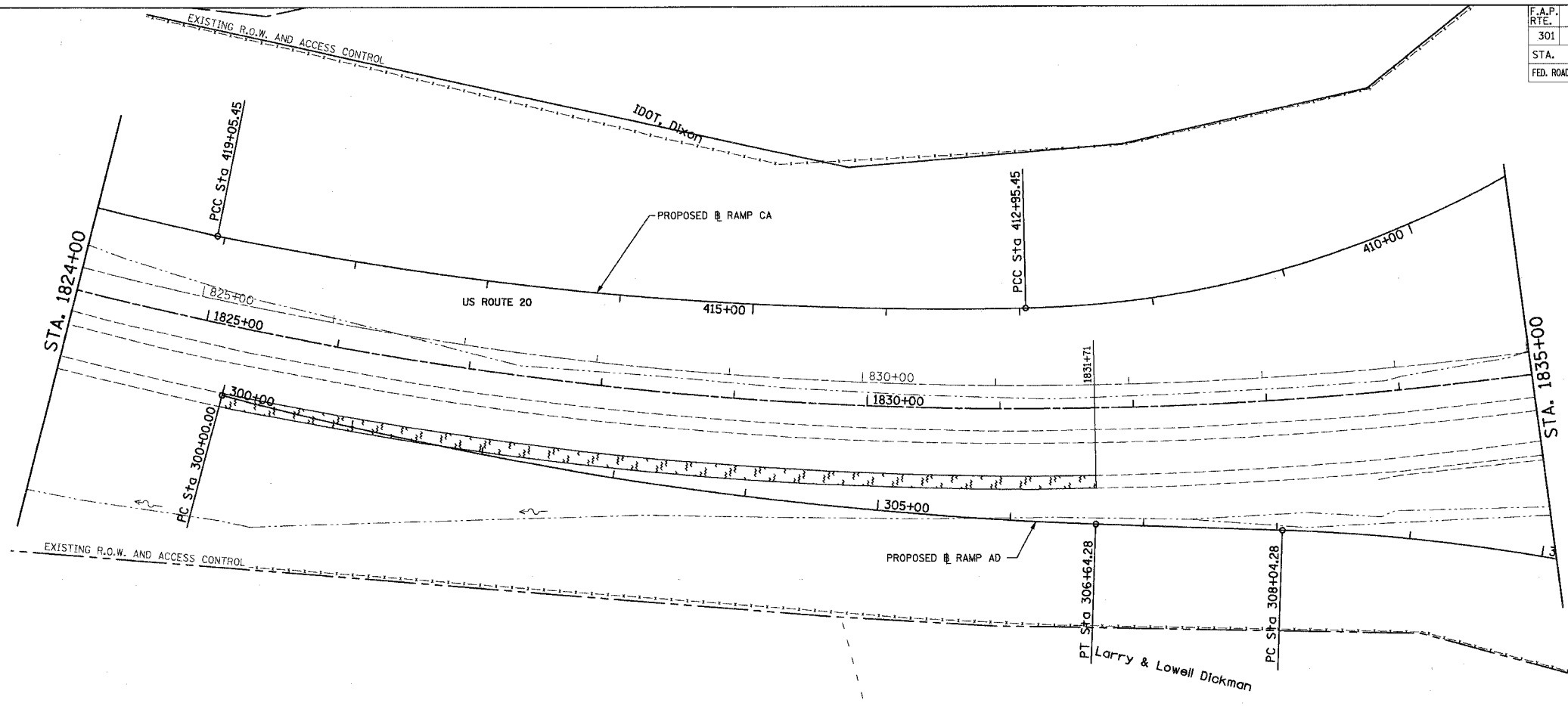

REVISIONS	
NAME	DATE

ILLINOIS DEPARTMENT OF TRANSPORTATION

REMOVAL PLAN
U.S. ROUTE 20
STA. 1824+00 TO STA. 1835+00
TEMPORARY RAMP

SCALE: VERT. 1"=50'
HORIZ. 1"=50'
DATE 7/15/05

DRAWN BY MBT
CHECKED BY JC