

F.A.P. RTE.	SECTION	COUNTY	TOTAL SHEETS	SHEET NO.
301		STEPHENSON	290	80
STA. 100+00		TO STA. 115+00		
FED. ROAD DIST. NO. 2 ILLINOIS FED. AID PROJECT				

PLAN	DATE
BY	
DATE	
BY	
DATE	
BY	
DATE	

PROFILE	DATE
BY	
DATE	
BY	
DATE	
BY	
DATE	

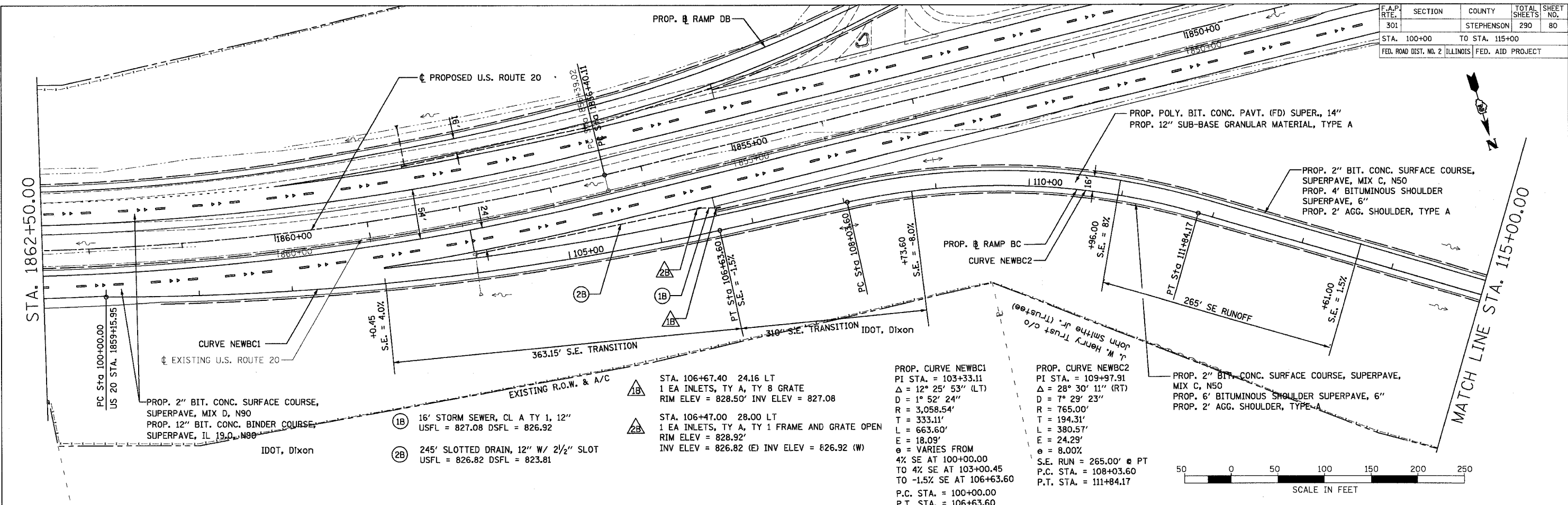

1A STA. 106+67.40 24.16 LT
 1 EA INLETS, TY A, TY B GRATE
 RIM ELEV = 828.50' INV ELEV = 827.08

2A STA. 106+47.00 28.00 LT
 1 EA INLETS, TY A, TY 1 FRAME AND GRATE OPEN
 RIM ELEV = 828.92'
 INV ELEV = 826.82 (E) INV ELEV = 826.92 (W)

1B 16' STORM SEWER, CL A TY 1, 12"
 USFL = 827.08 DSFL = 826.92

2B 245' SLOTTED DRAIN, 12" W/ 2 1/2" SLOT
 USFL = 826.82 DSFL = 823.81

PROP. CURVE NEWBC1
 PI STA. = 103+33.11
 $\Delta = 12^\circ 25' 53''$ (LT)
 $D = 1^\circ 52' 24''$
 $R = 3,058.54'$
 $T = 333.11'$
 $L = 663.60'$
 $E = 18.09'$
 $e = \text{VARIES FROM}$
 4% SE AT 100+00.00
 TO 4% SE AT 103+00.45
 TO -1.5% SE AT 106+63.60
 P.C. STA. = 100+00.00
 P.T. STA. = 106+63.60

PROP. CURVE NEWBC2
 PI STA. = 109+97.91
 $\Delta = 28^\circ 30' 11''$ (RT)
 $D = 7^\circ 29' 23''$
 $R = 765.00'$
 $T = 194.31'$
 $L = 380.57'$
 $E = 24.29'$
 $e = 8.00\%$
 S.E. RUN = 265.00' @ PT
 P.C. STA. = 108+03.60
 P.T. STA. = 111+84.17

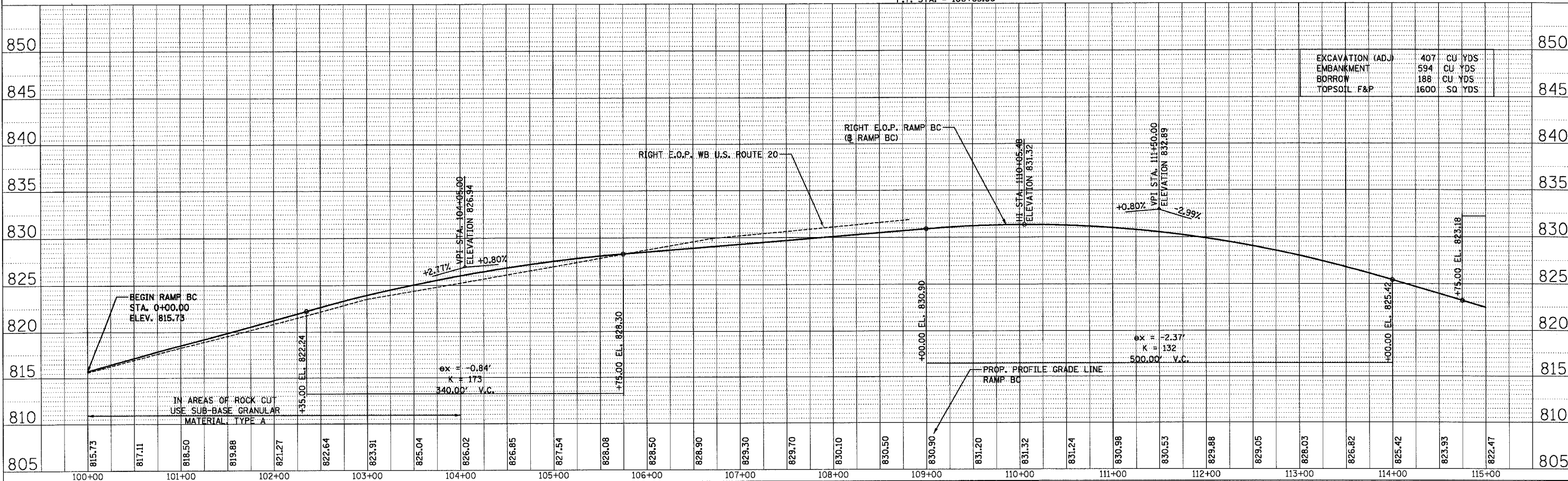
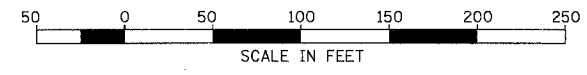

\\gdn\c20_paving\110\00\131.ctb 12/26/2005 11:45:04 AM