

CONTRACT NO. 64577			
F.A.P. RTE.	SECTION	COUNTY	TOTAL SHEET NO.
301		STEPHENSON	290 90
STA.	1675+00	TO STA.	1690+00
FED. ROAD DIST. NO. 2	ILLINOIS	FED. AID PROJECT	

TRAFFIC CONTROL AS PER
IDOT STANDARDS 701400 (WB),
701411, 701416, 701422

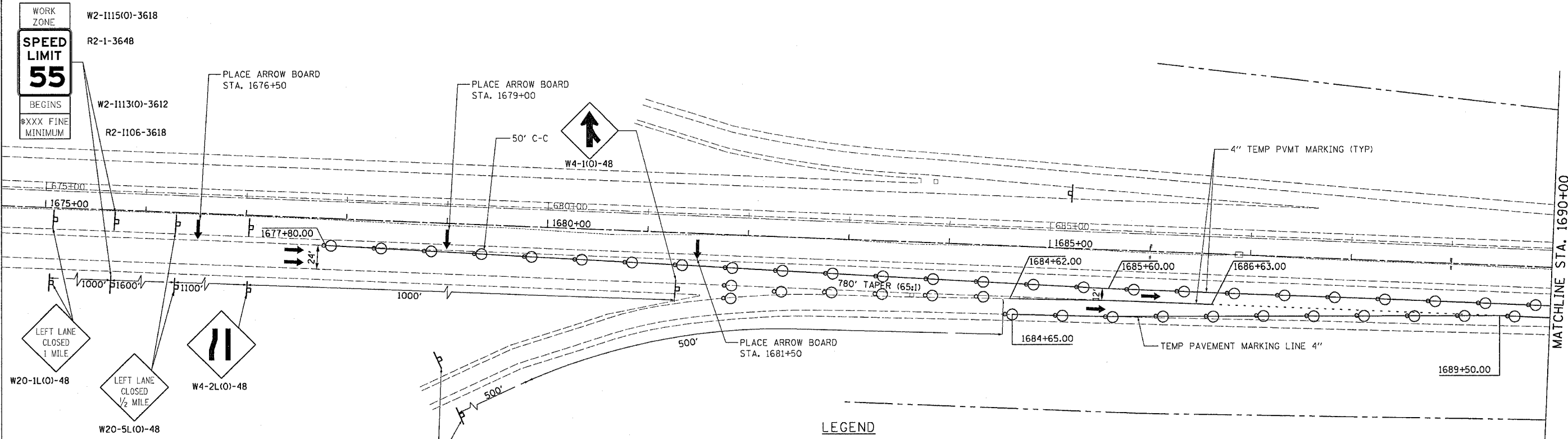

LEGEND

- WORK AREA
- TEMP. PAVEMENT
- BARRICADE TY III WITH FLASHING LIGHTS
- BARRICADE TY II
- SIGN
- VERTICAL PANEL
- BARRICADE OR DRUM WITH STEADY BURN LIGHTS
- TRAFFIC FLOW
- FLASHING LIGHTS
- DIRECTION INDICATOR BARRICADE WITH STEADY BURN MONODIRECTIONAL LIGHT
- IMPACT ATTENUATOR
- TEMPORARY CONCRETE BARRIER
- ARROW BOARD

REVISIONS	
NAME	DATE

ILLINOIS DEPARTMENT OF TRANSPORTATION
CONSTRUCTION STAGING
STAGE I
U.S. ROUTE 20
STA. 1675+00 TO STA. 1690+00
SCALE: VERT. 1" = 50'
DATE 7/15/05
DRAWN BY MVT
CHECKED BY JC