

CONTRACT NO. 64577

F.A.P. RTE.	SECTION	COUNTY	TOTAL SHEETS	SHEET NO.
301		STEPHENSON	290	117
STA.		TO STA.		
FED. ROAD DIST. NO. 2		ILLINOIS FED. AID PROJECT		

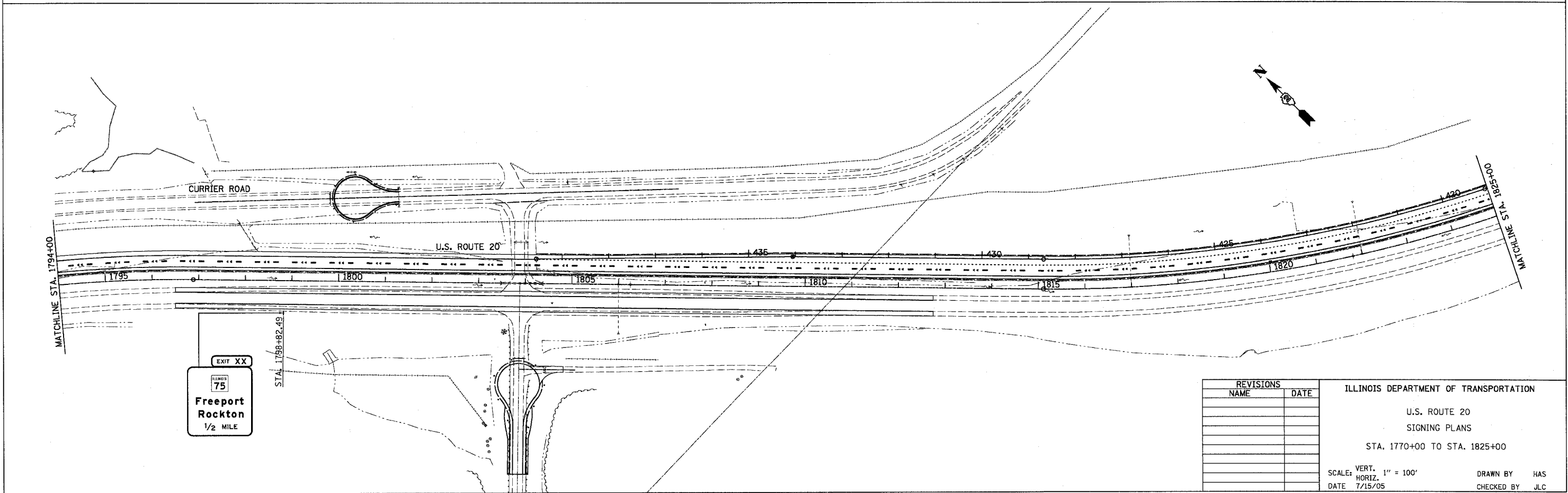
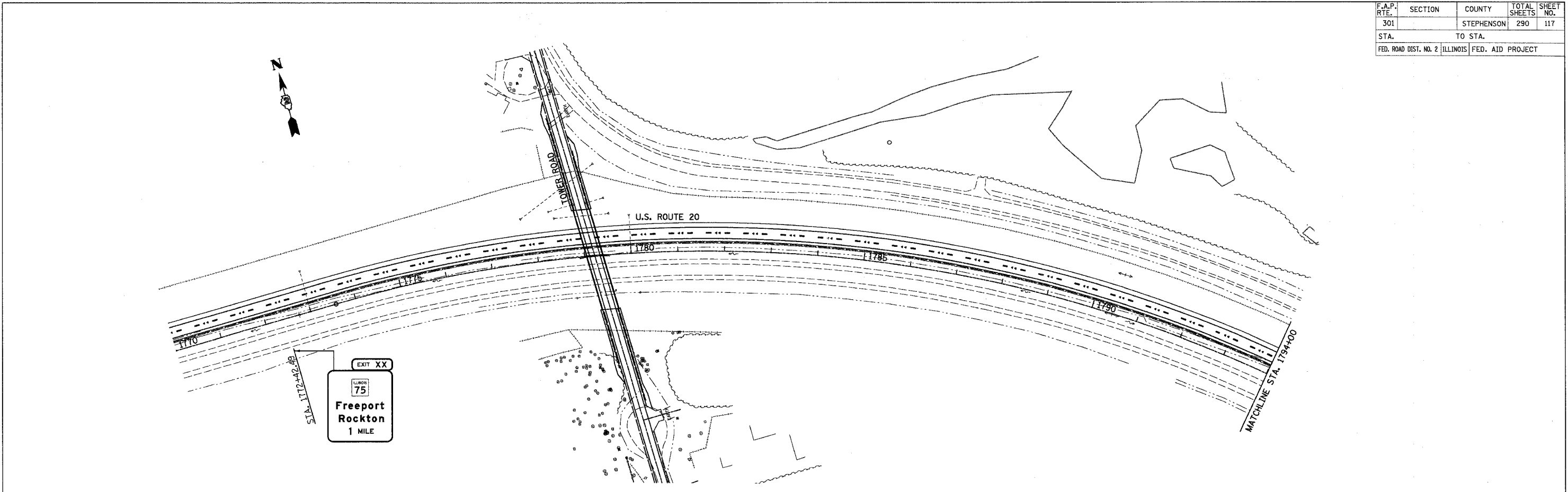

REVISIONS	
NAME	DATE

ILLINOIS DEPARTMENT OF TRANSPORTATION

U.S. ROUTE 20
SIGNING PLANS

STA. 1770+00 TO STA. 1825+00

SCALE: VERT. 1" = 100'
HORIZ. 1" = 100'

DATE 7/15/05

DRAWN BY HAS
CHECKED BY JLC