

F. A. P. NO.	SECTION	COUNTY	TOTAL SHEETS	SHEET NO.
301		**	290	157
STA.		TO STA.		
FED. ROAD DIST. NO.	ILLINOIS	FED. AID PROJECT		

NOTE: REFER TO CONTRACT NO. 64532 PLANS FOR AS-BUILT CROSS SECTION INFORMATION.

FINAL SURVEY	DATE
BY	
NO.	
REVISIONS	
NO.	
DATE	
BY	
NO.	
REVISIONS	
NO.	
DATE	
BY	
NO.	

ORIGINAL SURVEY	DATE
BY	
NO.	
REVISIONS	
NO.	
DATE	
BY	
NO.	
REVISIONS	
NO.	
DATE	
BY	
NO.	

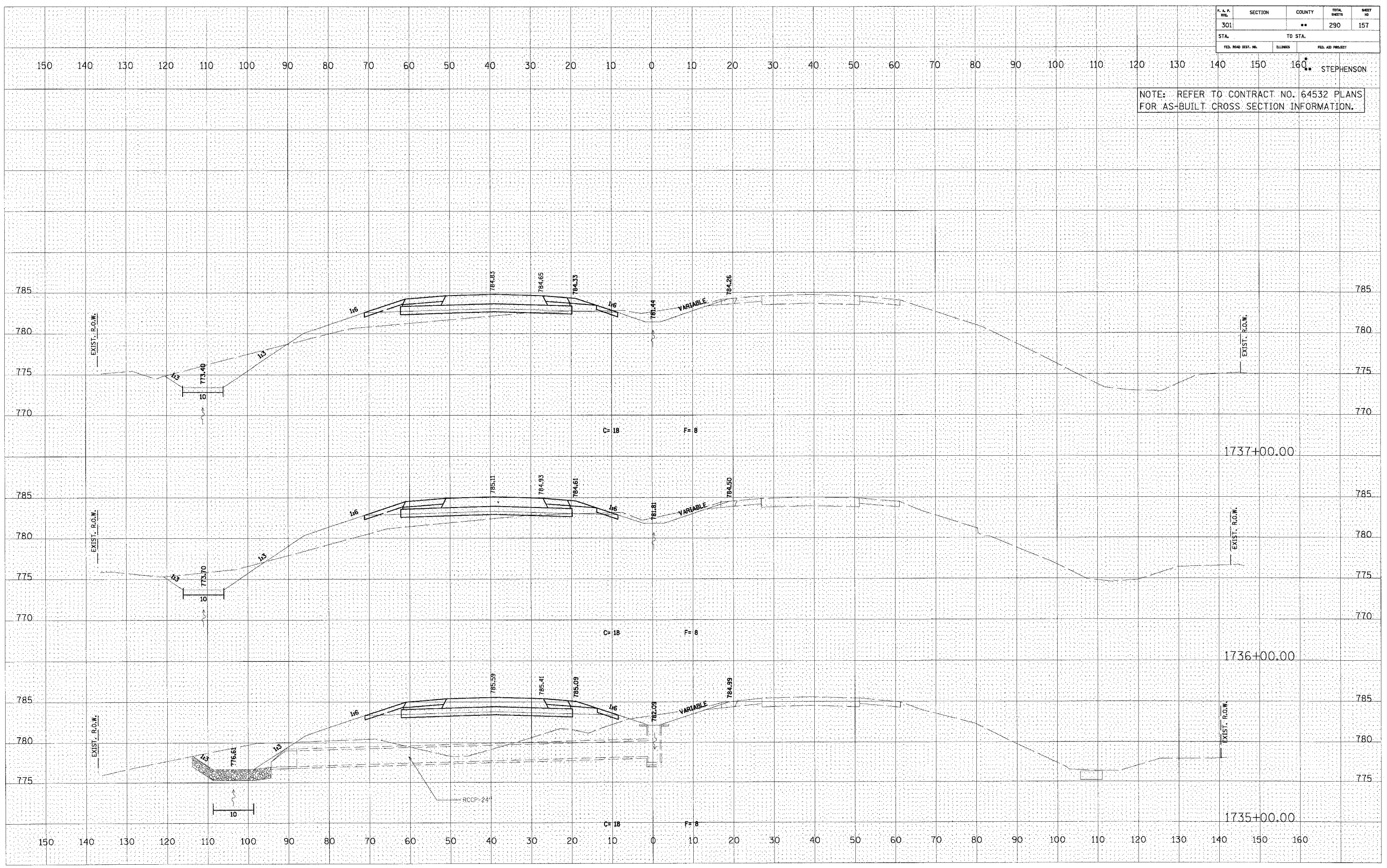

U.S. ROUTE 20