

SECTION		COUNTY	TOTAL SHEETS	SHEET NO.
177(3,4,4-1)-1		STEPHENS	290	228
STA. 120		TO STA.		
FED. ROAD DIST. NO. 2	ILLINOIS	FED. AID PROJECT		

FINAL SURVEY	DATE
NO.	
BY	
APPROVED	
PLOTTED	
TEMPERATURE	
AREAS CHECKED	

ORIGINAL SURVEY	DATE
NO.	
BY	
APPROVED	
PLOTTED	
TEMPERATURE	
AREAS CHECKED	

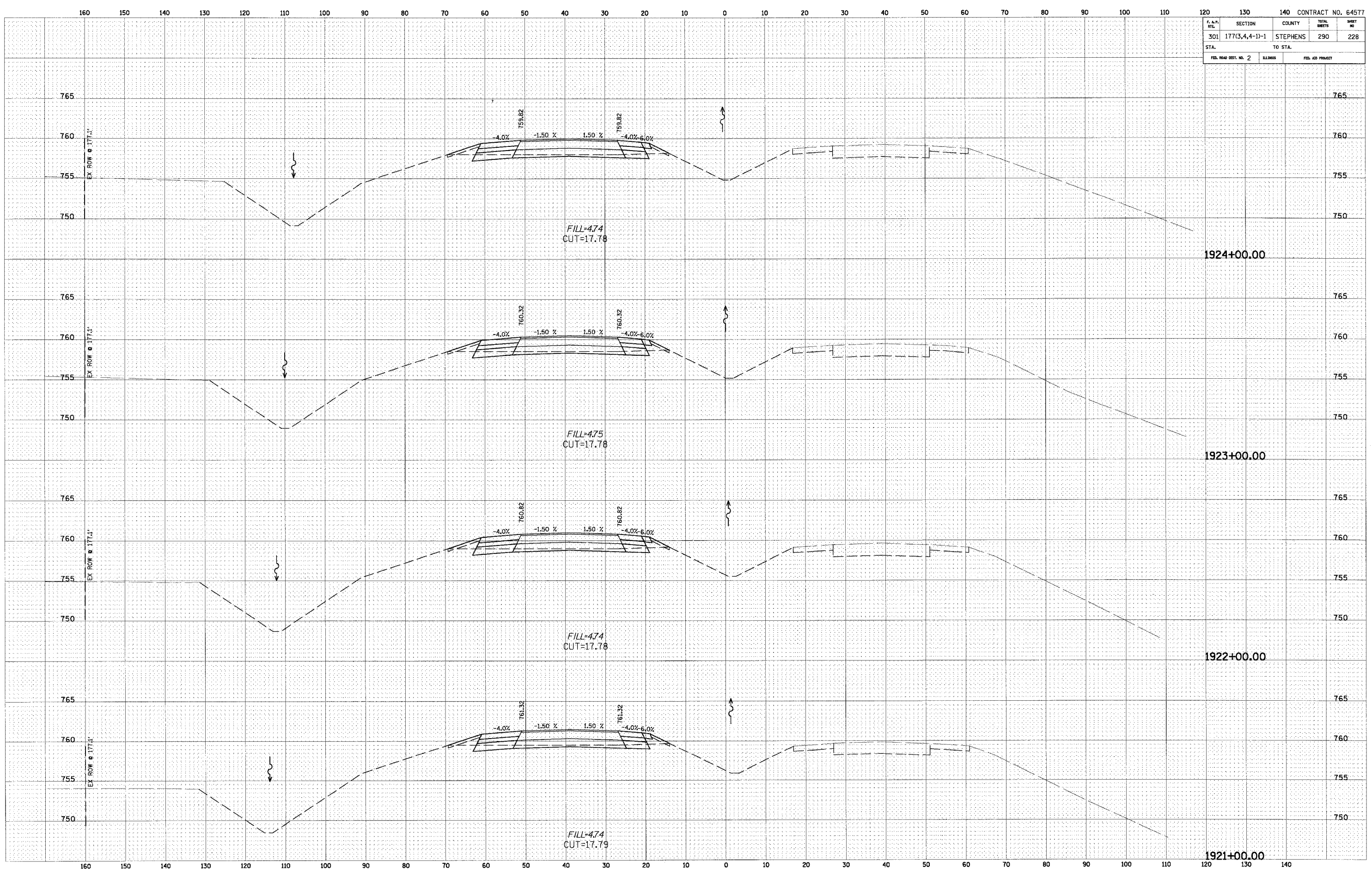

CROSS SECTION - US ROUTE 20

\\02075\FU\ed0\Sheets\W_1620.dgn 12/25/2006 12:07:27 PM