

F.A.P. SITE	SECTION	COUNTY	TOTAL SHEETS	SHEET NO.
301		**	290	284
STA.		TO STA.		
FED. ROAD DIST. NO.	ILLINOIS	FED. AID PROJECT		

NOTE: REFER TO CONTRACT NO. 64532 PLANS FOR AS-BUILT CROSS SECTION INFORMATION.

DATE	BY

DATE	BY

DATE	BY

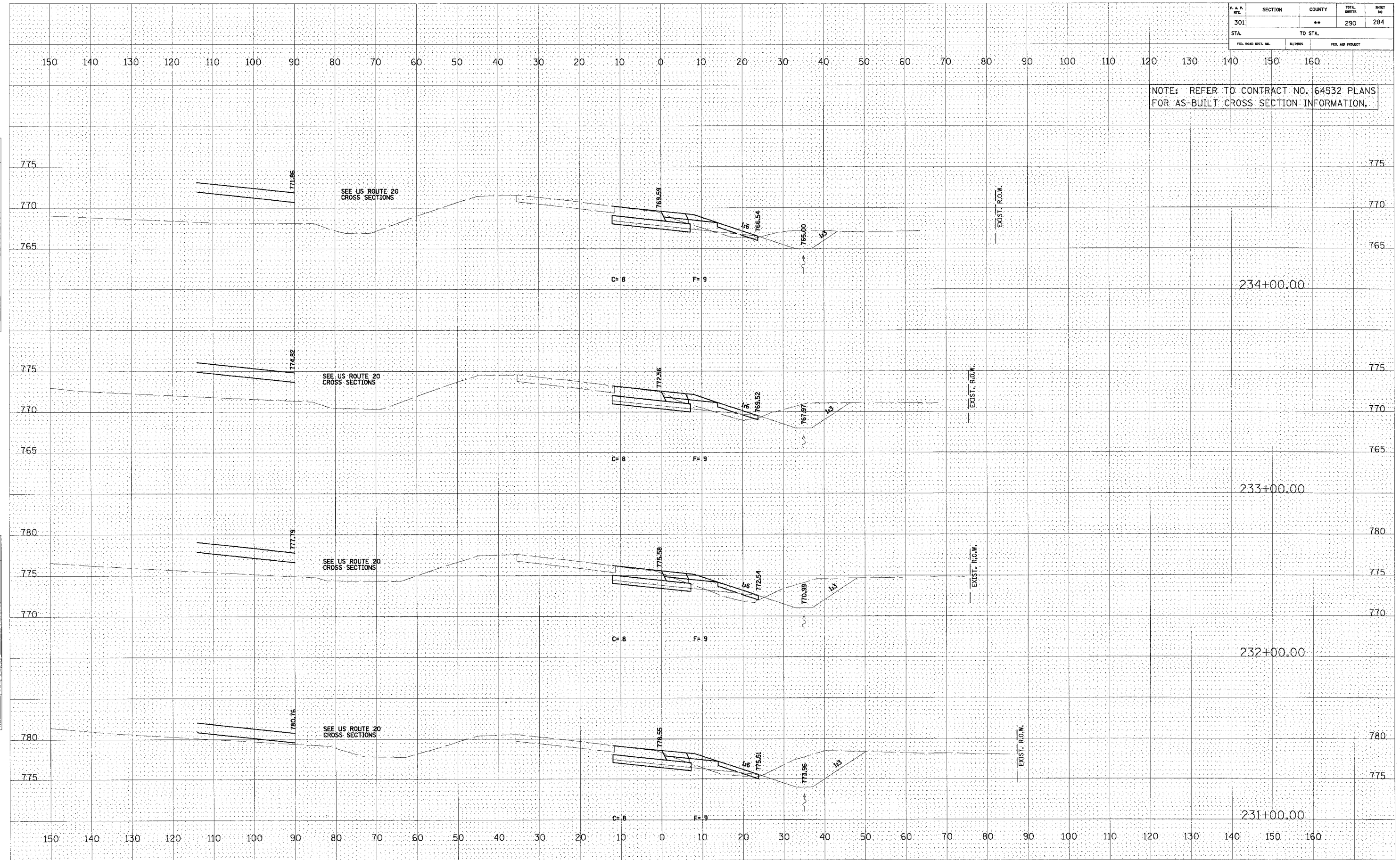

RAMP DB