

P. & P. NO.	SECTION	COUNTY	TOTAL SHEETS	SHEET NO.
301	**	**	290	286
STA.		TO STA.		
FED. ROAD DIST. NO.	BLINDS	FED. AID PROJECT		

NOTE: REFER TO CONTRACT NO. 64532 PLANS FOR AS-BUILT CROSS SECTION INFORMATION.

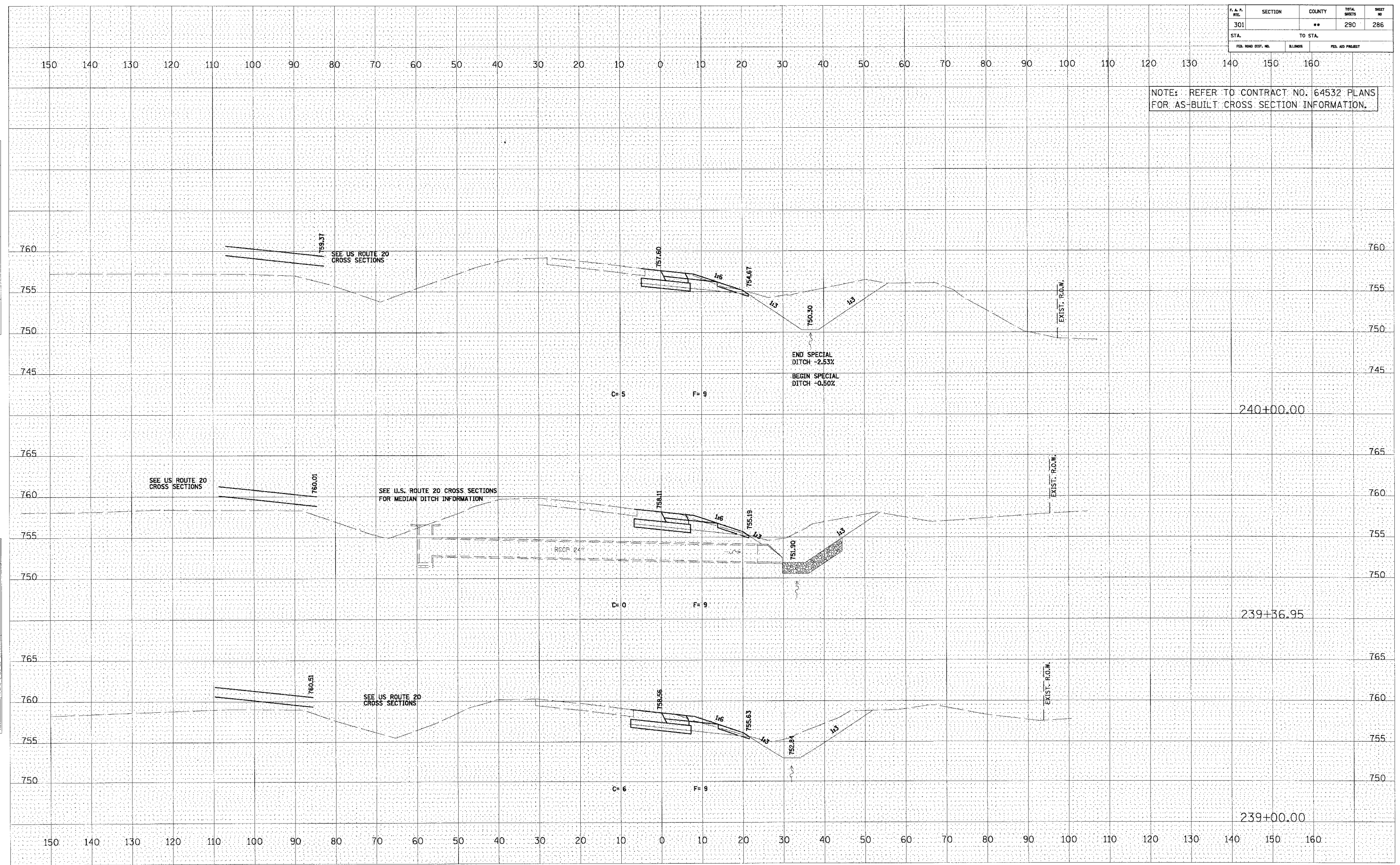

BY: _____ DATE: _____

FINAL SURVEY: _____

NOTED: _____

NO. _____

BY: _____ DATE: _____

ORIGINAL SURVEY: _____

NOTED: _____

NO. _____