

# EXISTING HORIZONTAL & VERTICAL CONTROL

|                     |         |          |                  |           |
|---------------------|---------|----------|------------------|-----------|
| F.A.P. RTE.         | SECTION | COUNTY   | TOTAL SHEETS     | SHEET NO. |
| 22                  | 6M&T5   | HENRY    | 257              | 12        |
| STA.                |         | TO STA.  |                  |           |
| FED. ROAD DIST. NO. |         | ILLINOIS | FED. AID PROJECT |           |

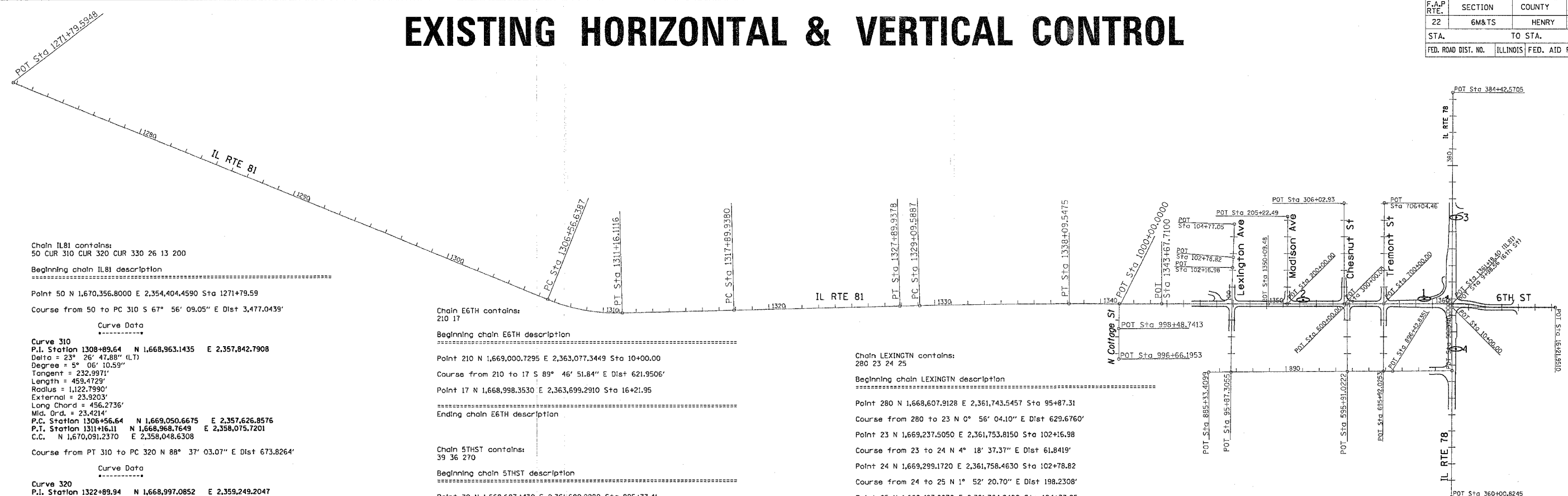

Chain IL81 contains:  
50 CUR 310 CUR 320 CUR 330 26 13 200

Beginning chain IL81 description  
=====

Point 50 N 1,670,356.8000 E 2,354,404.4590 Sta 1271+79.59

Course from 50 to PC 310 S 67° 56' 09.05" E Dist 3,477.0439'

Curve Data  
-----

Curve 310  
P.I. Station 1308+89.64 N 1,668,963.1435 E 2,357,842.7908  
Delta = 23° 26' 47.88" (LT)  
Degree = 5° 06' 10.59"  
Tangent = 232.9971'  
Length = 459.4729'  
Radius = 1,122.7990'  
External = 23.9203'  
Long Chord = 456.2736'  
Mid. Ord. = 23.4214'

P.C. Station 1306+56.64 N 1,669,050.6675 E 2,357,626.8576  
P.T. Station 1311+16.11 N 1,668,968.7649 E 2,358,075.7201  
C.C. N 1,670,091.2370 E 2,358,048.6308

Course from PT 310 to PC 320 N 88° 37' 03.07" E Dist 673.8264'

Curve Data  
-----

Curve 320  
P.I. Station 1322+89.94 N 1,668,997.0852 E 2,359,249.2047  
Delta = 0° 04' 34.88" (RT)  
Degree = 0° 00' 27.49"  
Tangent = 500.0000'  
Length = 999.9999'  
Radius = 750,386.0594'  
External = 0.1666'  
Long Chord = 999.9998'  
Mid. Ord. = 0.1666'

P.C. Station 1317+89.94 N 1,668,985.0219 E 2,358,749.3503  
P.T. Station 1327+89.94 N 1,669,008.4823 E 2,359,749.0748  
C.C. N 918,817.3899 E 2,376,853.5477

Course from PT 320 to PC 330 N 88° 41' 37.95" E Dist 119.6508'

Curve Data  
-----

Curve 330  
P.I. Station 1333+59.59 N 1,669,021.4671 E 2,360,318.5777  
Delta = 1° 20' 33.83" (RT)  
Degree = 0° 08' 57.12"  
Tangent = 450.0000'  
Length = 899.9598'  
Radius = 38,402.2387'  
External = 2.6365'  
Long Chord = 899.9382'  
Mid. Ord. = 2.6363'

P.C. Station 1329+09.59 N 1,669,011.2097 E 2,359,868.6946  
P.T. Station 1338+09.55 N 1,669,021.1796 E 2,360,768.5776  
C.C. N 1,630,618.9487 E 2,360,744.0441

Course from PT 330 to 26 S 89° 57' 48.23" E Dist 558.1625'

Point 26 N 1,669,020.8230 E 2,361,326.7400 Sta 1343+67.71

Course from 26 to 13 S 89° 57' 48.23" E Dist 641.7721'

Point 13 N 1,669,020.4130 E 2,361,968.5120 Sta 1350+09.48

Course from 13 to 200 N 89° 56' 24.44" E Dist 1,108.9178'

Point 200 N 1,669,021.5719 E 2,363,077.4292 Sta 1361+18.40

Ending chain IL81 description  
=====

Chain IL78 contains:  
12 10

Beginning chain IL78 description  
=====

Point 12 N 1,667,851.2060 E 2,363,072.6950 Sta 360+00.82

Course from 12 to 10 N 0° 13' 54.36" E Dist 2,441.7460'

Point 10 N 1,670,292.9320 E 2,363,082.5720 Sta 384+42.57

Ending chain IL78 description  
=====

Chain E6TH contains:  
210 17

Beginning chain E6TH description  
=====

Point 210 N 1,669,000.7295 E 2,363,077.3449 Sta 10+00.00

Course from 210 to 17 S 89° 46' 51.84" E Dist 621.9506'

Point 17 N 1,668,998.3530 E 2,363,699.2910 Sta 16+21.95

Ending chain E6TH description  
=====

Chain 5THST contains:  
39 36 270

Beginning chain 5THST description  
=====

Point 39 N 1,668,607.1430 E 2,361,609.2280 Sta 885+33.41

Course from 39 to 36 N 89° 40' 17.91" E Dist 1,109.4252'

Point 36 N 1,668,613.5010 E 2,362,718.6350 Sta 896+42.84

Course from 36 to 270 N 89° 33' 51.03" E Dist 357.1649'

Point 270 N 1,668,616.2178 E 2,363,075.7895 Sta 900+00.00

Ending chain 5THST description  
=====

Chain E7TH contains:  
70200 70001

Beginning chain E7TH description  
=====

Point 70200 N 1,669,580.3910 E 2,363,073.6897 Sta 20+00.00

Course from 70200 to 70001 N 89° 52' 39.84" E Dist 87.6535'

Point 70001 N 1,669,580.5780 E 2,363,167.3430 Sta 20+87.65

Ending chain E7TH description  
=====

Chain COTTAGE contains:  
53 52 340

Beginning chain COTTAGE description  
=====

Point 53 N 1,668,687.2600 E 2,361,068.1980 Sta 996+66.20

Course from 53 to 52 N 0° 11' 38.30" W Dist 182.5460'

Point 52 N 1,668,869.8050 E 2,361,067.5800 Sta 998+48.74

Course from 52 to 340 N 1° 50' 32.09" E Dist 151.2586'

Point 340 N 1,669,020.9855 E 2,361,072.4426 Sta 1000+00.00

Ending chain COTTAGE description  
=====

Chain MADISON contains:  
230 19

Beginning chain MADISON description  
=====

Point 230 N 1,669,020.5332 E 2,362,083.5154 Sta 200+00.00

Course from 230 to 19 N 0° 18' 51.65" E Dist 522.4907'

Point 19 N 1,669,543.0160 E 2,362,086.3820 Sta 205+22.49

Ending chain MADISON description  
=====

Chain LEXINGTON contains:  
280 23 24 25

Beginning chain LEXINGTON description  
=====

Point 280 N 1,668,607.9128 E 2,361,743.5457 Sta 95+87.31

Course from 280 to 23 N 0° 56' 04.10" E Dist 629.6760'

Point 23 N 1,669,237.5050 E 2,361,753.8150 Sta 102+16.98

Course from 23 to 24 N 4° 18' 37.37" E Dist 61.8419'

Point 24 N 1,669,299.1720 E 2,361,758.4630 Sta 102+78.82

Course from 24 to 25 N 1° 52' 20.70" E Dist 198.2308'

Point 25 N 1,669,497.2970 E 2,361,764.9400 Sta 104+77.05

Ending chain LEXINGTON description  
=====

Chain NCHESTNT contains:  
240 34

Beginning chain NCHESTNT description  
=====

Point 240 N 1,669,020.8925 E 2,362,427.3329 Sta 300+00.00

Course from 240 to 34 N 0° 08' 14.31" W Dist 602.9312'

Point 34 N 1,669,623.8220 E 2,362,425.8880 Sta 306+02.93

Ending chain NCHESTNT description  
=====

Chain SCHESTNT contains:  
290 250

Beginning chain SCHESTNT description  
=====

Point 290 N 1,668,611.9330 E 2,362,445.0298 Sta 595+91.02

Course from 290 to 250 N 0° 04' 04.17" W Dist 408.9778'

Point 250 N 1,669,020.9105 E 2,362,444.5456 Sta 600+00.00

Ending chain SCHESTNT description  
=====

Chain TREMONT contains:  
300 30

Beginning chain TREMONT description  
=====

Point 300 N 1,668,613.1770 E 2,362,662.1016 Sta 695+92.03

Course from 300 to 30 N 0° 24' 59.76" E Dist 1,012.4328'

Point 30 N 1,669,625.5830 E 2,362,669.4630 Sta 706+04.46

Ending chain TREMONT description  
=====

DATE-TIME  
DON-SPEC  
REF01  
REF04  
REF05  
REF