

PROPOSED HORIZONTAL CONTROL

F.A.P. RTE.	SECTION	COUNTY	TOTAL SHEETS	SHEET NO.
22	6M&TS	HENRY	257	14
STA.		TO STA.		
FED. ROAD DIST. NO.		ILLINOIS FED. AID PROJECT		



Chain P6TH contains:
G200 CUR 70260 CUR 70270 G17

Beginning chain P6TH description

Point G200 N 1,669,021.5719 E 2,363,077.4292 Sta 9+98.56

Course from G200 to PC 70260 S 89° 46' 05.79" E Dist 49.9998'

Curve Data

Curve 70260
P.I. Station 10+99.17 N 1,669,021.1650 E 2,363,178.0376
Delta = 11° 51' 02.79" (RT)
Degree = 11° 45' 00.00"
Tangent = 50.6094'
Length = 100.8577'
Radius = 487.6237'
External = 2.6193'
Long Chord = 100.6780'
Mid. Ord. = 2.6053'
P.C. Station 10+48.56 N 1,669,021.3697 E 2,363,127.4286
P.T. Station 11+49.42 N 1,669,010.5715 E 2,363,227.5258
C.C. N 1,668,533.7500 E 2,363,125.4565

Curve Data

Curve 70270
P.I. Station 12+00.09 N 1,668,999.9665 E 2,363,277.0676
Degree = 11° 45' 00.37"
Tangent = 50.6641'
Length = 100.9659'
Radius = 487.6194'
External = 2.6250'
Long Chord = 100.7856'
Mid. Ord. = 2.6109'
P.C. Station 11+49.42 N 1,669,010.5715 E 2,363,227.5258
P.T. Station 12+50.39 N 1,668,999.7729 E 2,363,327.7313
C.C. N 1,669,487.3887 E 2,363,329.5943

Course from PT 70270 to G17 S 89° 46' 51.94" E Dist 371.5628'

Point G17 N 1,668,998.3533 E 2,363,699.2914 Sta 16+21.95

Ending chain P6TH description

CURVE	PI	CC	PC	PT
70260	70260	70261	70262	70263
70270	70270	70271	70272	70273

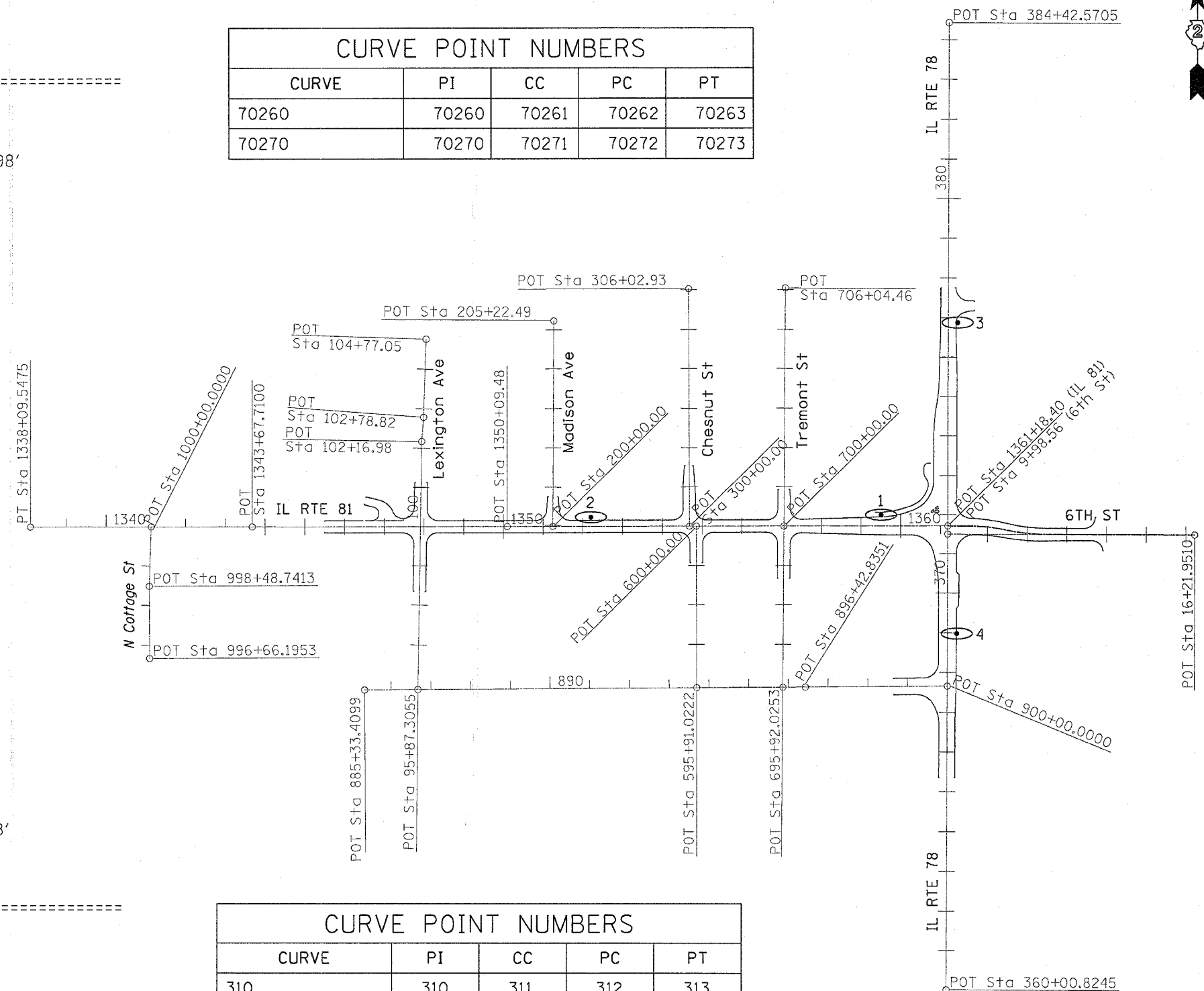

CURVE	PI	CC	PC	PT
310	310	311	312	313
320	320	321	322	323
330	330	331	332	333

DATE-TIME
DGN-SPEC
REF01
REF04
REF05
REF