

F.A. RTE.	SECTION	COUNTY	TOTAL SHEETS	SHEET NO.
22	6M & T5	HENRY	257	40
STA.		TO STA.		
FED. ROAD DIST. NO.	ILLINOIS	FED. AID PROJECT		

# STAGE 1

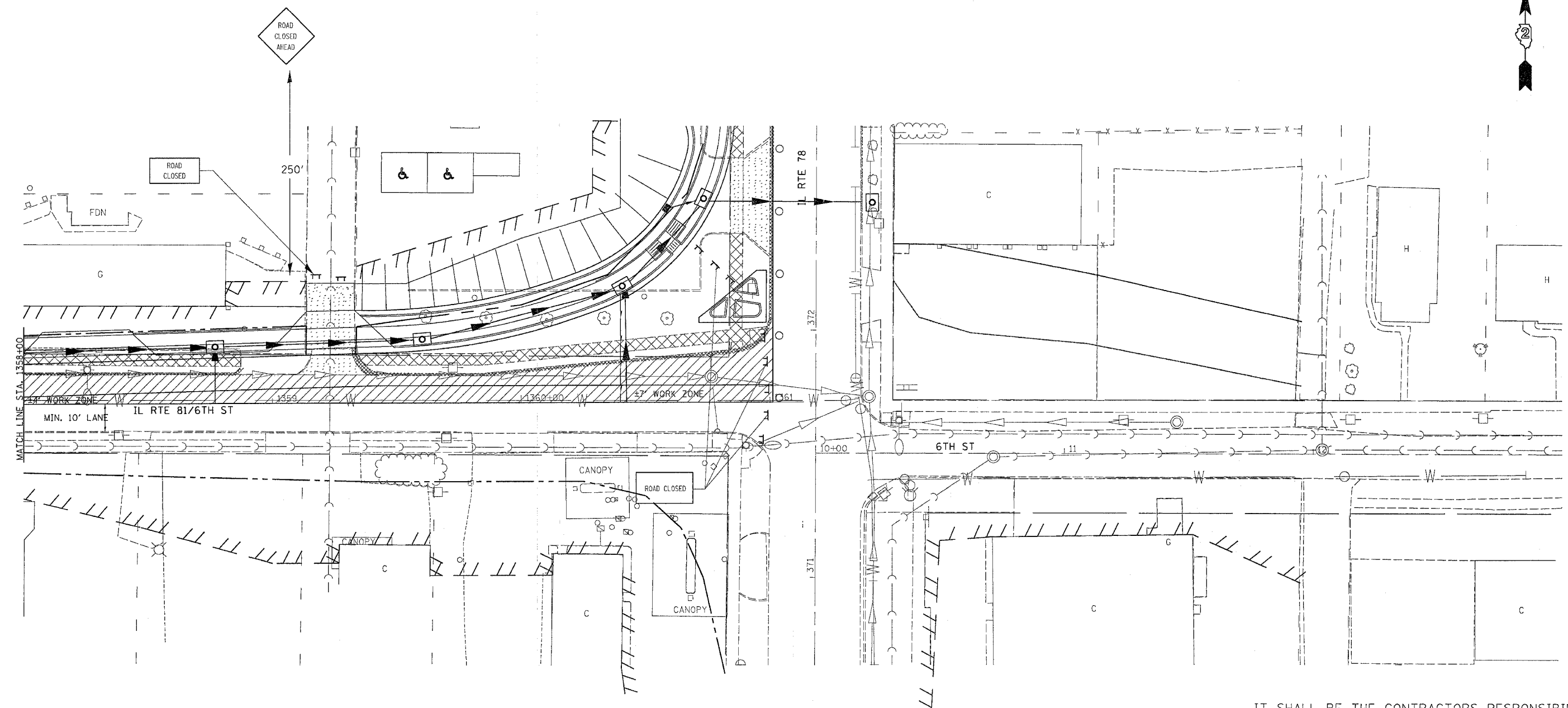

### LEGEND

	CLASS B PATCH
	PAVEMENT REMOVAL
	DRIVEWAY PAVEMENT REMOVAL
	COMB. CURB & GUTTER REMOVAL
	SIDEWALK REMOVAL
	TREE REMOVAL

### TRAFFIC CONTROL LEGEND

	DRUM WITH LIGHT
	TYPE III BARRICADE WITH FLASHERS

### FOR IL 78 (SOUTH LEG)

SIGNS SUPPLIED AND INSTALLED BY STATE	SIGNS SUPPLIED AND INSTALLED BY STATE	SIGNS SUPPLIED AND INSTALLED BY STATE
STA 366+50	STA 364+00	STA 361+50
STA 366+50	STA 364+00	STA 359+00
		STA 356+50

IT SHALL BE THE CONTRACTORS RESPONSIBILITY TO PROVIDE STOP SIGNS AT ALL INTERSECTIONS WHERE APPLICABLE.

ALL DROPOFFS EXCEEDING 3" SHALL CONFORM TO ARTICLE 701.04(B)(1).

REVISIONS	
NAME	DATE

ILLINOIS DEPARTMENT OF TRANSPORTATION

SCALE: VERT. HORIZ. DATE  
DRAWN BY CHECKED BY

SEE TYPICAL APPLICATION FOR ROAD CLOSURE (DISTRICT STANDARD 40.1)

### STAGING, TRAFFIC CONTROL, AND EROSION CONTROL DETAILS

PLOT DATE = Thu Oct 27 16:38:39 2005  
FILE NAME = c:\projects\64640\p166801.dgn  
PLOT SCALE = 1/8" = 1'-0"  
REFERENCE = 64640