

F.A. PI. RTE.	SECTION	COUNTY	TOTAL SHEETS	SHEET NO.
22	6M & TS	HENRY	257	46
STA.		TO STA.		
FED. ROAD DIST. NO.		ILLINOIS	FED. AID PROJECT	

# STAGE 3A

SEE STANDARD 701316 FOR SIGNING AND ADDITIONAL DETAILS

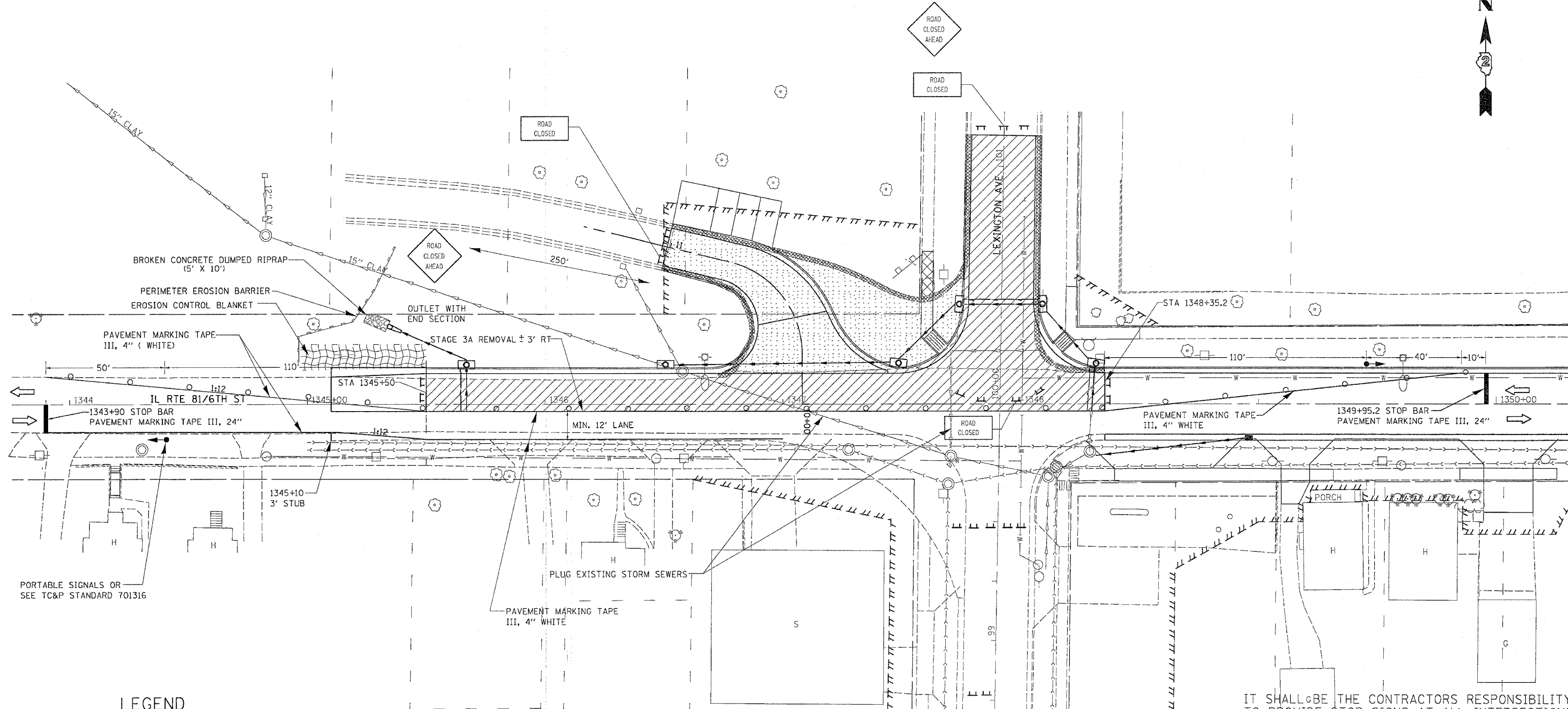

### LEGEND

	CLASS B PATCH
	PAVEMENT REMOVAL
	DRIVEWAY PAVEMENT REMOVAL
	COMB. CURB & GUTTER REMOVAL
	SIDEWALK REMOVAL
	TREE REMOVAL

### TRAFFIC CONTROL LEGEND

	DRUM WITH LIGHT
	TYPE III BARRICADE WITH FLASHERS

IT SHALL BE THE CONTRACTORS RESPONSIBILITY TO PROVIDE STOP SIGNS AT ALL INTERSECTIONS WHERE APPLICABLE.

ALL DROPOFFS EXCEEDING 3" SHALL CONFORM TO ARTICLE 701.04(B)(1).

REVISIONS	
NAME	DATE

ILLINOIS DEPARTMENT OF TRANSPORTATION

SCALE: VERT. DATE: HORIZ.

DRAWN BY: CHECKED BY:

TEMPORARY RUMBLE STRIPS SHALL BE PLACED ON WEST END OF PROJECT FOR EAST BOUND TRAFFIC, SEE STANDARD 701316 FOR DETAILS.

## STAGING, TRAFFIC CONTROL, AND EROSION CONTROL DETAILS

PLOT DATE = Thu Oct 27 18:32:32 2005  
 PLOT SCALE = 50' / IN.  
 PLOT REFERENCE = #REF#