

F.A. PROJECT NO.	SECTION	COUNTY	TOTAL SHEETS	SHEET NO.
22	6M & TS	HENRY	257	52
STA.		TO STA.		
FED. ROAD DIST. NO.	ILLINOIS	FED. AID PROJECT		

STAGE 4

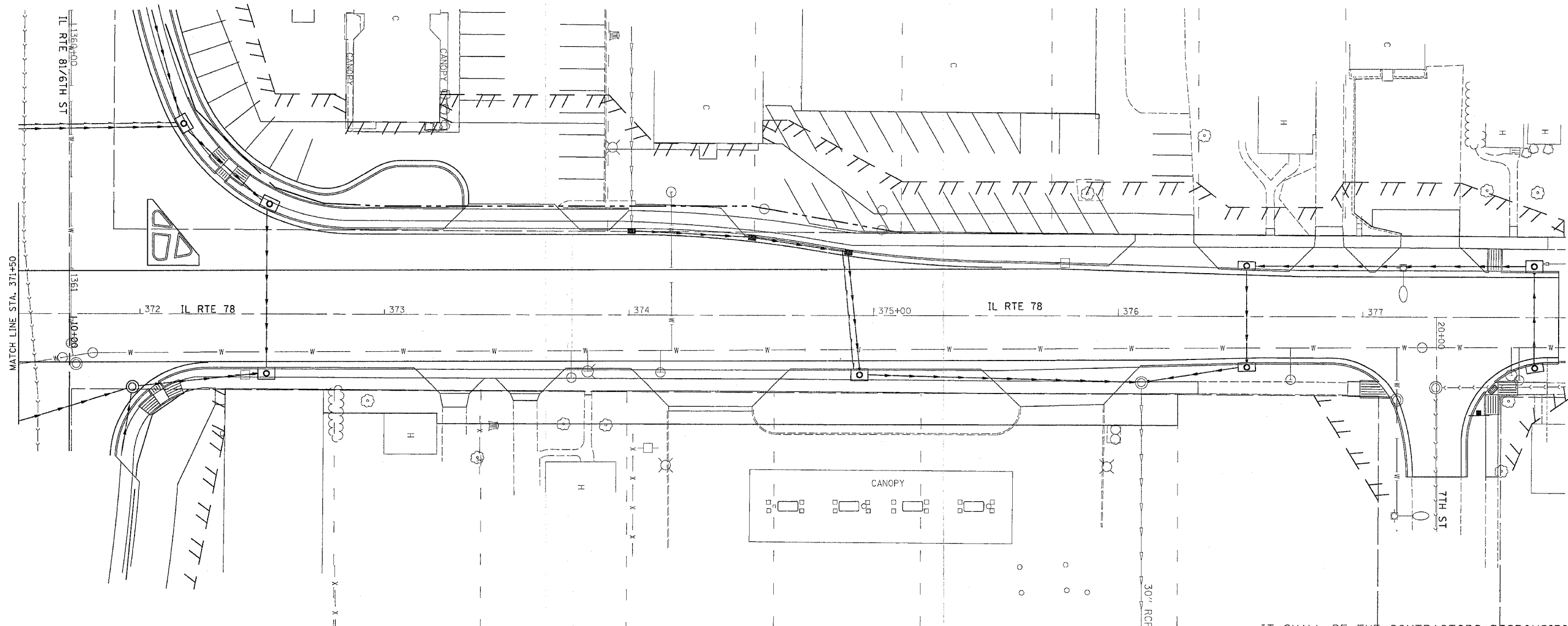

LEGEND

	CLASS B PATCH
	PAVEMENT REMOVAL
	DRIVEWAY PAVEMENT REMOVAL
	COMB. CURB & GUTTER REMOVAL
	SIDEWALK REMOVAL
	TREE REMOVAL

TRAFFIC CONTROL LEGEND

	DRUM WITH LIGHT
	TYPE III BARRICADE WITH FLASHERS

SEQUENCE OF WORK

1. BITUMINOUS SURFACE REMOVAL 2 3/4" (MILLING)
2. 1 1/4" POLYMERIZED LEVEL BINDER (MACHINE METHOD) SUPERPAVE
3. STRIP CRACK CONTROL, IF NECESSARY.
4. 1 1/2" POLYMERIZED BIT. CONCRETE SURFACE COURSE
5. PLACE BITUMINOUS OVERLAYS ON 6TH AND 7TH ST
6. PAVEMENT MARKINGS & RAISED REFLECTIVE PAVEMENT MARKERS

IT SHALL BE THE CONTRACTORS RESPONSIBILITY TO PROVIDE STOP SIGNS AT ALL INTERSECTIONS WHERE APPLICABLE.

ALL DROPOFFS EXCEEDING 3" SHALL CONFORM TO ARTICLE 701.04(b)(1).

REVISIONS		ILLINOIS DEPARTMENT OF TRANSPORTATION
NAME	DATE	
		SCALE: VERT. HORIZ. DATE
DRAWN BY		CHECKED BY

STAGING, TRAFFIC CONTROL, AND EROSION CONTROL DETAILS

PLOT DATE = Thu Dec 27 10:08:33 2005
 FILE NAME = S:\pav\stage4\stage4.dwg
 PLOT SCALE = 1/8" = 1'-0"
 REFERENCE = #REF#